

MCS-1



**Discount
Equipment**

www.discount-equipment.com

Discount Equipment

Discount-Equipment.com is your online resource for commercial and industrial quality parts and equipment sales.

Locations:

Florida (West Palm Beach): [561-964-4949](tel:561-964-4949)

Outside Florida TOLL FREE: [877-690-3101](tel:877-690-3101)

Need parts? Check out our website at www.discount-equipment.com

Can't find what you need?

Click on this link: <http://www.discount-equipment.com/category/5443-parts/> and fill out the request form.

Please have the machine model and serial number available in order to help us get you the correct parts. One of our experienced staff members will get back to you with a quote for the right part that your machine needs.

We sell worldwide for the brands: Genie, Terex, JLG, MultiQuip, Mayco, Toro/Stone, Diamond Products, Magnum, Airman, Mustang, Power Blanket, Nifty Lift, Atlas Copco, Chicago Pneumatic, Allmand Brothers, Essick, Miller Spreader, Skyjack, Lull, Skytrak, Tsurumi, Husquyarna/Target, Whiteman-Concrete/Mortar, Stow-Concrete/Mortar, Baldor, Wacker, Sakai, Snorkel, Upright, Mi-T-M, Sullair, Neal, Basic, Dynapac, MBW, Weber, Bartell, Bennar Newman, Haulotte, Ditch Runner, Blaw-Knox, Himoina, Best, Buddy, Crown, Edco, Wyco, Bomag, Laymor, Terremite, Barreto, EZ Trench, Takeuchi, Basic, Bil-Jax, Curtis, Gehl, Heli, Honda, ICS/PowerGrit, Puckett, Waldon, ASV, IHI, Partner, Imer, Clipper, MMD, Koshin, Rice, Gorman Rupp, CH&E, Cat Pumps, Comet, General Pump, Giant, AMida, Coleman, NAC, Gradall, Square Shooter, Kent, Stanley, Tamco, Toku, Hatz, Kohler, Robin, Wisconsin, Northrock, Oztec, Toker TK, Rol-Air, Small Line, Wanco, Yanmar

PARTS BREAK-DOWN MCS-1

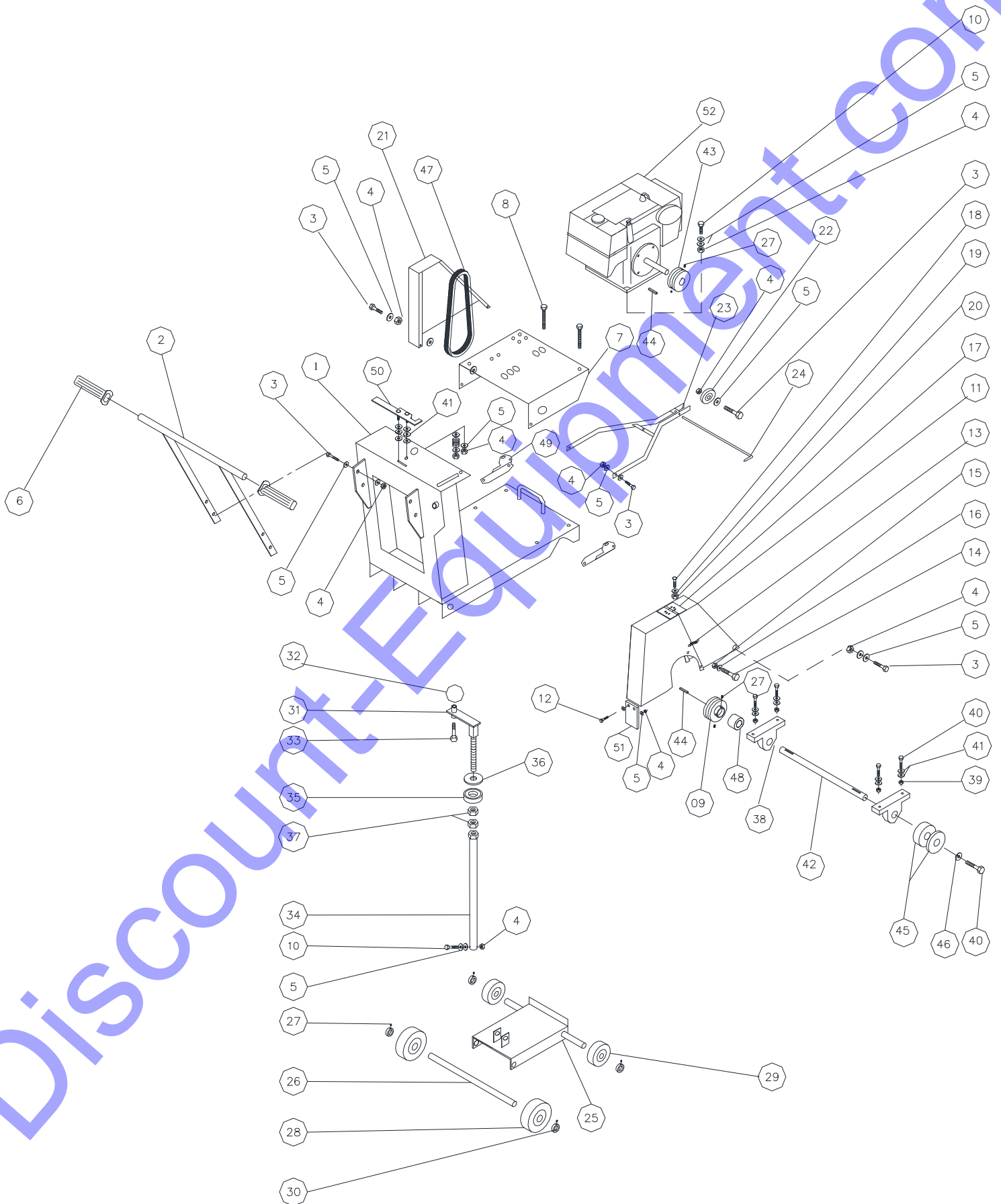

SAW CONCRETE

No.	# PART	DESCRIPTION	QTY
1	0405CO01CH	FRAME	1
2	0405CO01MA	HANDLE	1
3	TOCD038114	BOLT 3/8x1 ¼	10
4	TCCS038GAL	LOCK NUT 3/8"	19
5	RNPX038GAL	PLAIN WASHER 3/8	45
6	0000RF01MA	HANDLE GRIP	2
7	0405CO01BM	POWER BASE	1
8	TOCD038312	BOLT 3/8 X 3 1/2	2
9	POFG3121143R	PULLEY 3 1/2 CAL 1-1/4	1
10	TOCD038200	BOLT 3/8 x 2	4
11	0405CO01GD	BLADE GUARD	1
12	TOCD038100	BOLT 3/8 x 1	2
13	0405RE01GD	SPRING GUARD LOCK	1
14	TOCD014100	BOLT 1/4 X 1	2
15	TCCS014GAL	LOK NUT 1/4	2
16	RNPX014GAL	PLAIN WASHER 1/4	4
17	0405MI02GD	BOOK HINGE	1
18	TOCMR036GAL	BOLT GOUTHEAD 3/16 X 1	6
19	RNPX036GAL	PLAIN WASHER 3/16	6
20	TCCS036GAL	LOCK NUT 3/16	6
21	0405CO01GB	BELT GUARD	1
22	0405MI01GC	WHEEL GUIDE	1
23	0405CO01GC	CUTTING GUIDE	1
24	0405CR01GC	POINTER ROD	1
25	0405CO01RD	AXLE BASE	1
26	0405CR01RD	REAR AXLE	1
27	OPCR056056	ALLEN SCERW 5/16	8
28	0000RD08RD	WHEEL 8	2
29	0000RD04RD	WHEEL 4	2
30	0405CR02RD	WHEEL BUSHING	4
31	0405CO01TE	RAISE SCREW	1
32	238202	BALL KNOB	1
33	TOCD012212	BOLT 1/2 X 2 1/2	1
34	0405CO02TE	DEPTH SCREW TUBE	1
35	0000BA0602	NICE BEARING 602	1
36	RNPX034GAL	PLAIN WASHER 3/4	1
37	TCCN034MAQ	LOCK NUT 3/4	1
38	00CHPI2114	PILLOW BLOCK BEARING	2
39	TCCS012GAL	LOCK NUT 1/2	4
40	TOCDR012200	BOLT 1/2 X 2	5
41	RNPX012GAL	PLAIN WASHER 1/2	4
42	0405CR01CO	BLADE SHAFT	1

Discovered by [DiscoveryElement.com](http://www.DiscoveryElement.com)

43	POFG3121003R	PULLEY 3 1/2 CAL 1	1
44	0405CC01CO	KEY 1/4	2
45	0405CO01GC	LOOSE COLLAR	2
46	RNRX012GAL	WASHER SPRING 1/2	1
47	0000BN3VX315	BELT 3V X 315	3
48	0405CR02RD	COLLAR SPACE	1
49	0405LA01GC	BRACKETS	2
50	0405CO01FR	HANDLE BRACKETS	1
51	0405MI01GD	FENDER	1
52		MOTOR	1

Discount-Equipment.com