

DIAMANT-KERNBOHRMASCHINE TYP DK 12/14/16/18

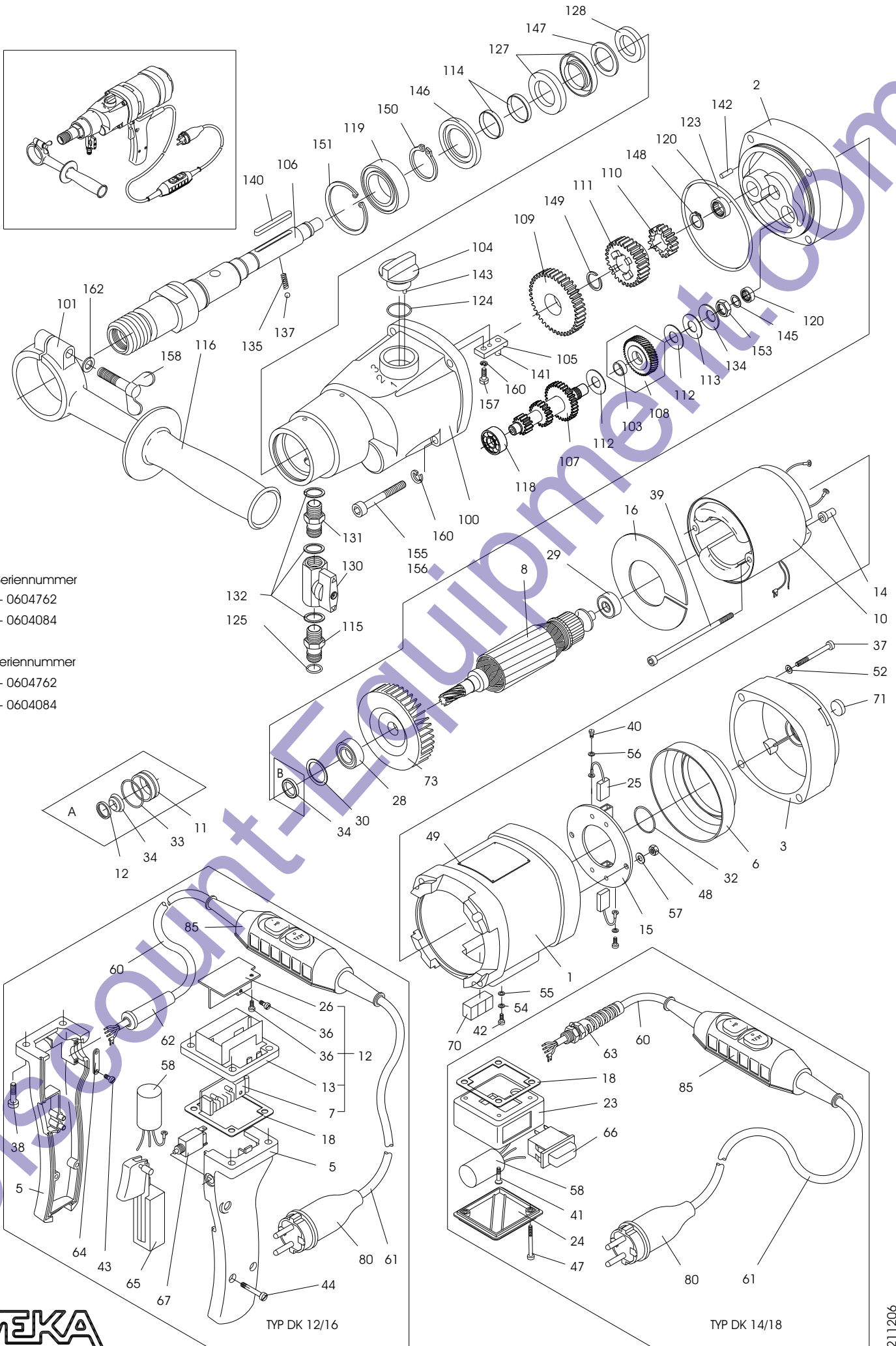
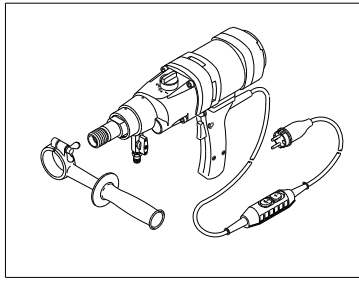

A: < Seriennummer
DK12 - 0604762
DK14 - 0604084

B: > Seriennummer
DK12 - 0604762
DK14 - 0604084

TYP DK 12/16

TYP DK 14/18

Fig	Req.	Type	Description	Weka Part	DP Part	Fig	Req.	Description	Weka Part	DP Part
1	1		Motorcase	DK10101	2700650	62	1	Cord Sleeve	8701000	2700685
2	1		Intermediate Flange "New" <i>New type for use w/improved seal fig34b</i>	DK10102-1	2703238	64	1	Cord Clamping Piece	8800010	2700686
3	1		Motor Top Hood w/ insulation ring	DK10103	2700652	65	1	Motor Switch 110V/230V	8015212	2701454
5a	1		Switch Handle <i>used w/fig 7 (230V or 110V)</i>	DK12105	2701453	67	1	Motor Protective Switch 110V <i>with Knurled Nut</i>	8010615	2700688
5b	1		Switch Handle <i>used w/fig 67 (110V only)</i>	DK12105.11	2701452	70	1	Tube Water-Level	7510029	2700690
6	1		Insulating Ring	DK10106	2701197	71	1	Tin Water-Level	7500015	2700691
7	1	DK12	Electronic Module 230V	DK10510	2701383	73	1	Fan	DK20105	2700692
	1	DK12	Electronic Module 110V	DK10510/116	2701427	100	1	Gear Box	DK10201	2700936
	1	DK16	Electronic Module 230V	DK16510	2703455	101	1	Clamp Ring <i>includes #158-#162</i>	DK12202	2700693
	1	DK16	Electronic Module 110V	DK16510/1	2704187	104	1	Gear Change Grip	DK10203	2700694
8	1	DK12	Armature w/Fan & Bearings 230V <i>New type for use w/improved seal fig34b</i>	DK10108-1	2703239	105	1	Gear Change Lever <i>includes #141</i>	DK20205	2700695
	1	DK12	Armature w/Fan & Bearings 110V <i>New type for use w/improved seal fig34b</i>	DK10108/11-1	2703240	106	1	Drill Spindle cpl. w. Pos 114,135,137 Tool Thread 1-1/4 + G 1/2"	DK10206.3	2701395
	1	DK16	Armature w/Fan & Bearings 230V	DK16108	2705205	107	1	Pinion Shaft	DK10208	2700697
	1	DK16	Armature w/Fan & Bearings 110V	DK16108/11	2705206	108	1	Clutch Wheel <i>includes #103</i>	DK12209	2700698
10	1	DK12	Field compl. 230V	DK10109	2701335	103	1	Bearing Socket(for clutch wheel)	DK10221	2700699
	1	DK12	Field compl. 110V	DK10109/11	2700656	109	1	Gear Wheel 1	DK10212	2700700
	1	DK16	Field compl. 230V	DK16109	2705207	110	1	Gear Wheel 3	DK10213	2700701
	1	DK16	Field compl. 110V	DK16109/11	2705208	111	1	Slide Gear Wheel	DK10214	2700702
11	1		Seal Bush <i>Old type for v-seal #34a</i>	DK10113	2700657	112	2	Brake Disk	DK10218	2700703
12	1	DK12	Electronic module complete 230V	DK10520	2705209	113	1	Pressure Disk	DK10219	2700704
	1	DK12	Electronic module complete 110V	DK10520/11	2705210	114	2	Protective Sleeve	DK10220	2700643
	1	DK16	Electronic module complete 230V	DK16520	2705211	115	1	Quick Connect Nipple	DK20225	2700706
	1	DK16	Electronic module complete 110V	DK16520/11	2705212	116	1	Handle	8900014	2700707
13	1		Electronic Case 110V & 230V	DK10135	2701354	118	1	Ball Bearing 629	6062900	2700948
14	2		Fieldscrew Insulating Sleeve	DK10116	2700659	119	1	Ball Bearing 6005 2RS	6060052	2700708
15	1		Brush Holder Disc	DK10117/11	2700660	120	2	Needle Bush HK1010	6310100	2700709
			Brush Holder Disc (230V)	DK10117		123	1	O-Ring RDR78x2	5578002	2700710
16	1		Air Conducting Disk	DK10118	2700662	124	1	O-Ring RDR20x3	5520003	2700711
18	1		Terminal Case Packing	DK10122	2701567	125	1	O-Ring RDR11x2.5	5511025	2700712
25	2		Carbon Brush 230V	DK10125	2701336	127	2	Rotary Shaft Seal "water" AD24x40x7	5024407	2700713
	2		Carbon Brush 110V	DK10125.11	2700663	128	1	Rotary Shaft Seal "oil" AD22x35x7	5022357	2700714
26	1		Cooling Profile 110V & 230V	DK10140	2701385	130	1	Ball Valve with Grip G1/4"	7014001	2700715
28	1		Ball Bearing	6060011	2700664		1	Grip	7014005	2700925
29	1		Ball Bearing	6060002	2700665	131	1	Double Nipple G1/4"a	7014002	2700716
30	1		Compensation Washer	2628171	2700666	132	3	Sealing Ring G1/4"	7014003	2700717
32	1		O-Ring RDR26x2.5	4526025	2700667	134	1	Disk Spring	4028142	2700718
33	1		O-Ring RDR24x1.5	4524015	2700668	135	1	Pressure Spring 0.5x3.2x16	4305016	2700719
34a	1		V-Seal <i>Old type</i>	5112000	2700669	137	1	Ball RB-4	2204000	2700720
34b			Rotary Shaft Seal "New" <i>used only w/8c,8d,2b</i>	5012247	2703241	140	1	Parallel Key A5x5x40	3005040	2701087
34c			Modified Sealing Bushing <i>retrofit when using w/fig 2a,8c,8d,34b</i>	DK10113-1	2703242	141	1	Parallel Pin 5m6x15	2505016	2701065
36	1		Thread Roll. Head Screw M4X6	504006	2701386	142	1	Parallel Pin 4m6x10	2504010	2700722
37	4		Hex. Soc. Head Screw M5x35	105035	2700670	143	1	Parallel Pin 3m6x16	2503016	2700723
38a	*4		Raised Head Screw M5x25 <i>for handle w/ electronic overload</i>	205025	2701203	145	1	Shim Ring PS10x16x1	1910161	2700724
38b	*4		Raised Head Screw M5x20 <i>for handle w/ thermal overload</i>	205020	2700671	146	1	Supporting Ring	DK10204	2700992
39	2		Fill. Head Screw M4x100	204100	2700672	147	1	Shim Ring PS25x40x0.3	1925403	2701088
40	2		Fill. Head Screw M3x5	203005	2700673	148	1	Retaining Ring AV14	3514001	2700726
42	2		Sl. Pan Head Screw M4x6	304006	2700674	149	1	Retaining Ring SW18	3618000	2700727
43	2		Pan Head Tapping Screw	539095	2700675	150	1	Retaining Ring 25x1.2	3525012	2700728
44	2		Pan Head Tapping Screw	539019	2700676	151	1	Retaining Ring 47x1.75	2547175	2700729
48	2		Hexagon Nut M4	1004000	2700677	153	1	Hexagon Nut BM12x1.5	1012015	2700730
49	4		Round Head Grooved Pin 2.3x4	2223004	2700678	155	1	Hex. Soc. Head Screw M5x80	0105080	2700731
52	4		Locking Washer SM5	1805000	2700735	156	3	Hex. Soc. Head Screw M5x50	0105050	2700732
54	3		Curved Spring Washer A4	1804137	2700680	157	1	Hex. Soc. Head Screw M5x12	0105012	2700733
55	1		Medium Washer 4.3	1804433	2700681	158	1	Wing Screw M6x40	0506040	2700734
56	2		Medium Washer 3.2	1803433	2700682	160	5	Locking Washer SM5	1805000	2700735
58	1		Int. Suppr. Capacitor	DK10130	2700683	162	1	Medium Washer A 6	1806125	2700736
61			Cord 110V/230V AWG 14 w/o plug <i>Cord with Molded plug</i>		2700684		1	Pointing Sticker	DK20620	2700737
	1				2704244		1	Gear Oil 80W-90 4 oz	9012001	2700738
							1	Ball Valve Assembly(water shut-off)	7014000	2700806

NOTES: *Fig. 38a. Used on all 110V & 230V drills with electronic overload module.

*Fig. 38b. Used on all 110V drills with thermal motor protective switch.

**Slip torque of clutch(pinion shaft out of drill mounted in bench vise) 12-14NM(8.8-10.3 ft-lbs)

**Overall drill length w/drill spindle G 1/2"(old style DK10206) w/5/8"-11 adapt. = 15.750"
w/1-1/4"-7 adapt. = 16.750"

**Overall drill length w/drill spindle 1-1/4" + G 1/2"(new style DK10206.3) = 16.000"
w/ 5/8"-11 adapt. = 18.000"