

99840-002

ITEM NO.	PartNo	DESCRIPTION	QTY
1	100047-603	CARTON	1
2	100047-747	CARTON PARTS BOX	1
3	15209-000	DECAL SET	1
4	15209-003	UL-DECAL ELECTRICAL SHOCK CAN KILL	1
5	15750-001	GROUND DECAL	1
6	21698-001	SELF TAP SCREW, TORX	14
7	300077-6	BASE WELDMENT	1
8	300086-1	DRIVE SHAFT GUARD	1
9	300137	PLUG, NEMA 14-60P, 125/250V	1
10	300160-6	RECEPTACLE BOX ASSY	1
11	481-000	LOCK .375 SPLIT	7
12	53113-001	WINCO DECAL	1
13	55440-000	.25-02X.5 SELF TAP	4
14	60706-180	OPERATION MANUAL	1
15	63966-009	KIT, NAMEPLATE WINCO PTO	1
16	91369-003	UL-DECAL-515 RPM	1
17	91658-001	.375 - 16 X1 HHB	7
18	92914-000	.375-16	7
19	96002-020	M8-1.25X20MM	4
20	97436-008	.325IN LOCKWASHER	4
21	98479-000	WINCO #1 WORLDWIDE DECAL	1
22	99839-001	GEN END, 15KW, PTO W/GEARCASE	1
23	99841-002	GEAR CASE SUPPORT	1
24	Z2516	UL-DECAL-WARNING	1
25	Z2553	DECAL-OPERATOR INSTRUCTIONS	1
26	Z2568	DECAL-DANGER PTO	1
27	Z9941	DECAL-OIL FILL HOLE	1
28	300080-2	TOP COVER	1
29	526-000	ID.375 OD.890 TH.057	5

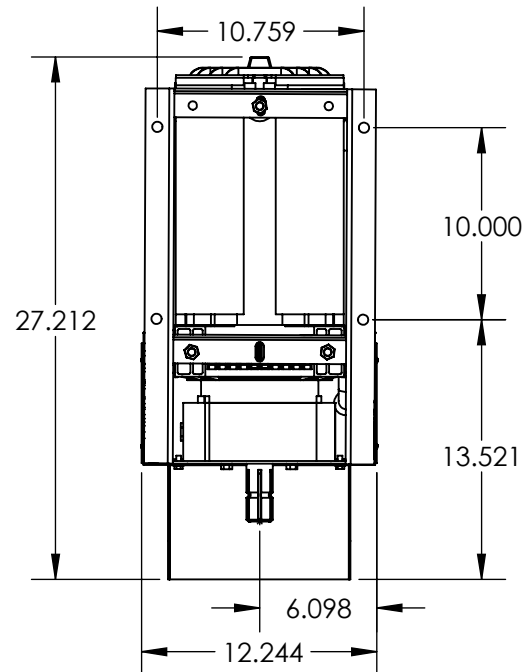
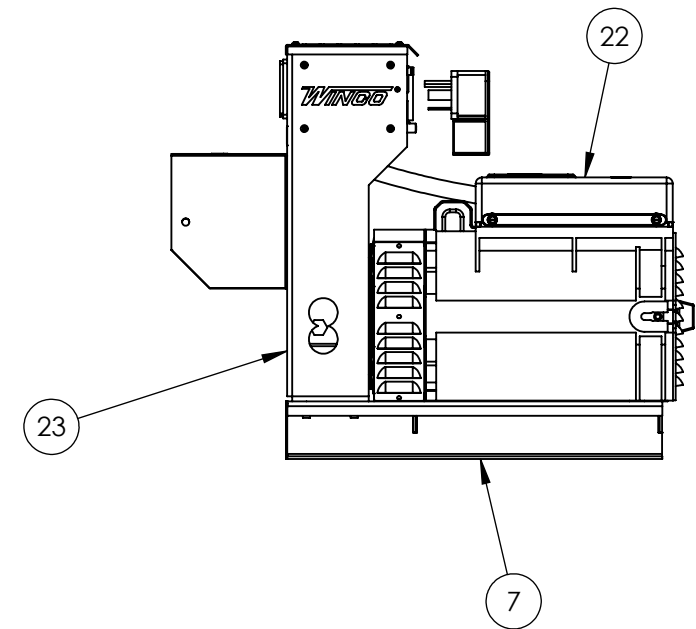
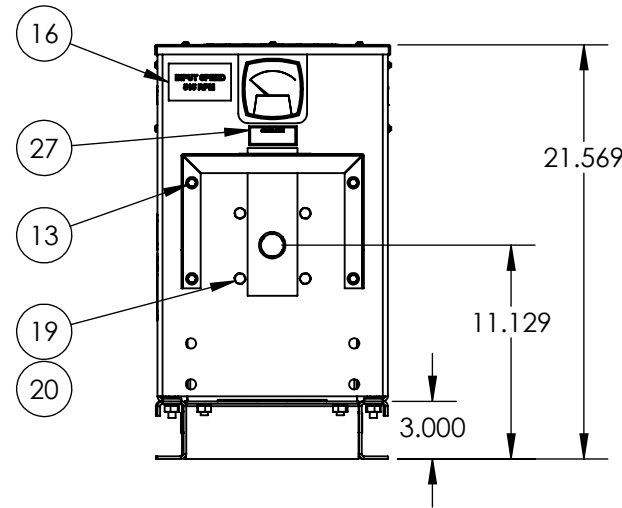
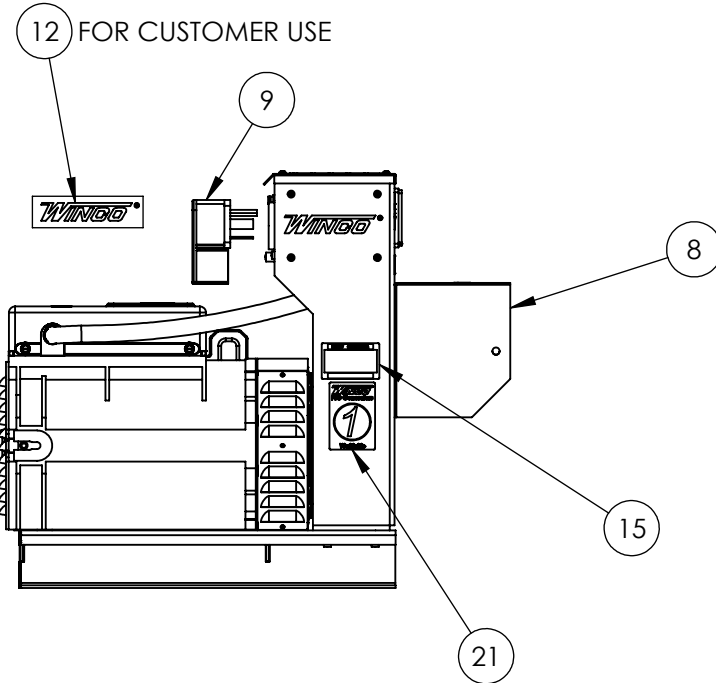
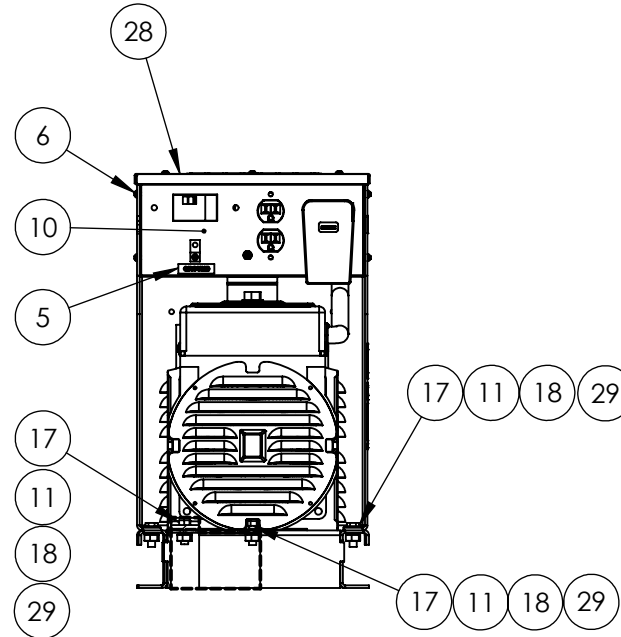
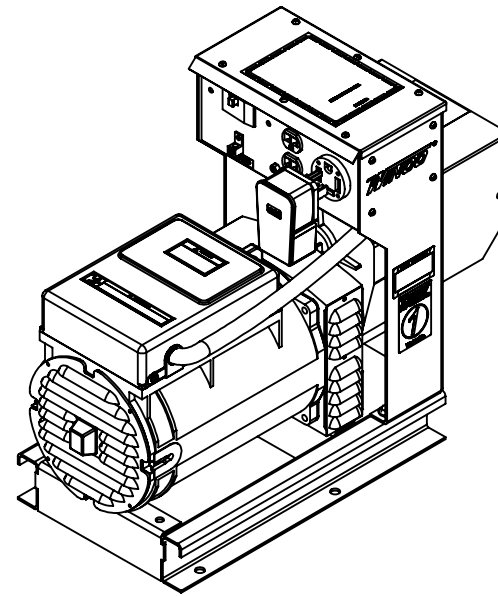
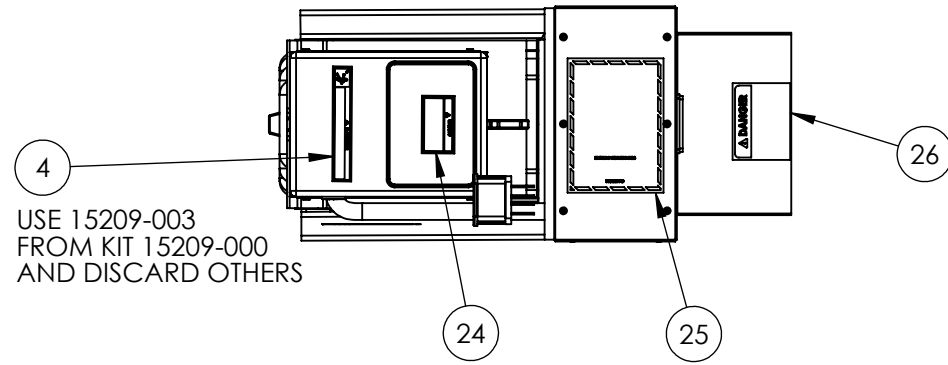

NOTE:

PLACE THE FOLLOWING INTO THE PARTS BOX CARTON

- DRIVE SHAFT GUARD 300086-1, ITEM (9)
- SELF TAPPING SCREWS 55440-000, ITEM (4)
- 14-60P RECEPTACLE PLUG 300137, ITEM (10)
- OPERATORS MANUAL 60706-180, ITEM (15)
- WINCO DECAL 53113-001, ITEM (13)

REVISION RECORD					
ISSUE	E.C.O. NO.	DESCRIPTION	DATE	BY	APPR.
1		ORIGINAL	10/19/2010	RLC	CLR
2	1593	DEL 480-000,458-000, 1116-000; 92914-000, 481-000, 91658-001 WAS QTY 3	6/19/2012	MVW	
3	3124	ADDED 526-000 WASHERS TO BOM	9/18/2014	PJY	DRC
A	3780	CORRECTED TOP COVER SHOWN	4/24/2015	SJM	DRC

UNLESS OTHERWISE SPECIFIED				MACHINED SURFACE TEXTURE		ALL DIMENSIONS GIVEN IN INCHES WORK TO DIMENSIONS FLAT OUTSIDE VIEW SHOWN UNLESS NOTED -DO NOT SCALE-		
FRACTIONS	ANGULAR							
1 PLACE DEC. .1	1.5							
2 PLACE DEC. .015								
3 PLACE DEC. .005								
	DRAWN BY	DATE	CHK'D BY	DATE	ENG APPR.	DATE	SCALE	
	RLC	10/19/2010			CLR	2/2/2011		
THIS DRAWING CONTAINS PROPRIETARY INFORMATION BELONGING TO WINCO. UNAUTHORIZED USE IS PROHIBITED	MATERIAL:						TITLE:	
	FINISH:						COMPLETE ASSEMBLY W15PTOS/E	
	ASSY:						PART NO.	
	MODEL:	W15PTOS/E					99840-002	