



Service Bulletin

WT5C/WTE5C/WT5CSG Series Water Trailers

| | | |
|---|--|--|
| Product Group: Water Trailer | Date Issued: 04/26/17 | Service Bulletin No.: WT20170209 |
| Bulletin Type <input checked="" type="checkbox"/> Mandatory <input type="checkbox"/> Information Only <input type="checkbox"/> Recommended Change | Models/Series Affected: W5TC S/N 30509 — 40868 WTE5C S/N 32308 — 40311 WT5CSG S/N 38609 — 40378 | |

Details

Problem:

- a. Improve existing trailer design.

Solution:

- a. Install trailer reinforcement brace.

Parts Information

| Table 1. Reinforcement Kit Parts | | | | |
|----------------------------------|----------|-------------------------------|------|--------------------|
| Item No. | Part No. | Description | QTY. | Remarks |
| 1 | 59182-SK | Brace Kit, Tow Bar | 1 | Includes items 2-3 |
| 2 | 59182 | Brace, Hitch Mount | 1 | |
| 3 | 59183 | Instruction Sheet, WT5 Series | 1 | |

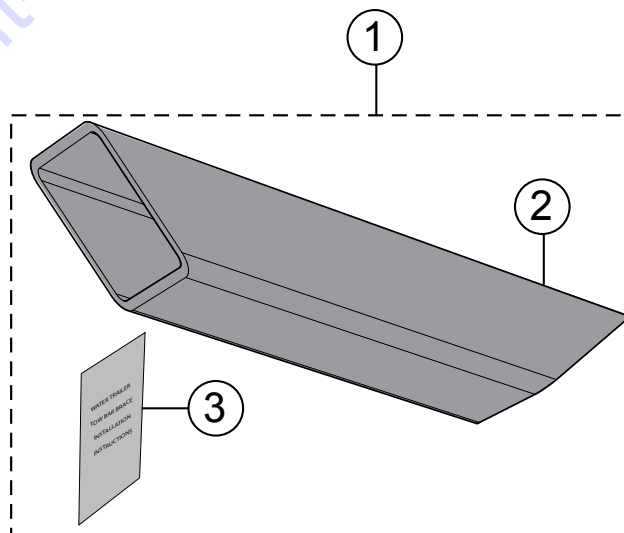

Figure 1. Brace Kit, Tow Bar

PARTS FINDER

**Search Website
by Part Number**



**Search Manual
Library For Parts
Manual & Lookup Part
Numbers – Purchase
or Request Quote**

Search Manuals

Enter your information to help us find the right parts manual for your machine.

* Brand:

* Model:

* Serial:

* Part Number:

SEARCH

**Can't Find Part or
Manual? Request Help
by Manufacturer,
Model & Description**

Parts Order Form

Please fill in the following information to help us find the right part for your machine.

| | |
|---------------|----------------------|
| Manufacturer: | <input type="text"/> |
| Model: | <input type="text"/> |
| Description: | <input type="text"/> |
| Part Number: | <input type="text"/> |
| Quantity: | <input type="text"/> |
| Notes: | <input type="text"/> |

Submit

Discount-Equipment.com is your online resource for quality parts & equipment.

Florida: **561-964-4949** Outside Florida TOLL FREE: **877-690-3101**

Need parts?

Click on this link: <http://www.discount-equipment.com/category/5443-parts/> and choose one of the options to help get the right parts and equipment you are looking for. Please have the machine model and serial number available in order to help us get you the correct parts. If you don't find the part on the website or on one of the online manuals, please fill out the request form and one of our experienced staff members will get back to you with a quote for the right part that your machine needs.

We sell worldwide for the brands: Genie, Terex, JLG, MultiQuip, Mikasa, Essick, Whiteman, Mayco, Toro Stone, Diamond Products, Generac Magnum, Airman, Haulotte, Barreto, Power Blanket, Nifty Lift, Atlas Copco, Chicago Pneumatic, Allmand, Miller Curber, Skyjack, Lull, Skytrak, Tsurumi, Husquvarna Target, Stow, Wacker, Sakai, Mi-T-M, Sullair, Basic, Dynapac, MBW, Weber, Bartell, Bennar Newman, Haulotte, Ditch Runner, Menegotti, Morrison, Contec, Buddy, Crown, Edco, Wyco, Bomag, Laymor, EZ Trench, Bil-Jax, F.S. Curtis, Gehl Pavers, Heli, Honda, ICS/PowerGrit, IHI, Partner, Imer, Clipper, MMD, Koshin, Rice, CH&E, General Equipment, Amida, Coleman, NAC, Gradall, Square Shooter, Kent, Stanley, Tamco, Toku, Hatz, Kohler, Robin, Wisconsin, Northrock, Oztec, Toker TK, Rol-Air, APT, Wylie, Ingersoll Rand / Doosan, Innovatech, Con X, Ammann, Mecalac, Makinex, Smith Surface Prep, Small Line, Wanco, Yanmar

WORK SAFELY!

NOTICE

If hitch mount brace is already installed on your trailer frame, please disregard this bulletin.

NOTICE

Failure to repair may compromise structural integrity of the trailer frame when unintentionally overloaded.

NOTICE

Only use a **certified welder** with proper training who is qualified to perform this installation. Follow all shop safety rules when performing this installation.

REQUIRED TOOLS

- Welder
- Bar-Clamp
- Approved Respirator
- Welding Face Shield
- Safety Glasses
- Gloves
- Hard Hat
- Grinder
- Black Glossy Paint

SAFETY

- Perform all work in an area that is well ventilated to prevent inhalation of dust and toxic fumes.
- **DO NOT** use chlorinated solvents in areas where welding will take place.
- **ALWAYS** properly dispose of paint and solvents.

PREPARATION

1. Check that the hitch mount brace is accounted for before attempting this installation procedure. Reference Table 1 and Figure 1.
2. Place the water trailer in an area free of dirt and debris. Make sure it is on secure level ground with chock blocks underneath each wheel to prevent the trailer from rolling.

DECAL REMOVAL

NOTICE

Due to **excessive heat** during welding, the possibility exist that the **VIN** and **tire pressure** decals may become damaged during the welding process.

NOTICE

Record the **entire** Vehicle Identification Number (**VIN**) displayed on the decal before removing decal.

Replacement VIN and tire pressure decals will only be sent after a claim has been filed with the MQ Warranty Dept.

1. Record the entire VIN identification number displayed on the VIN decal. Also **record** the last **five** digits of the VIN number that is stamped into the trailer frame (Figure 2).

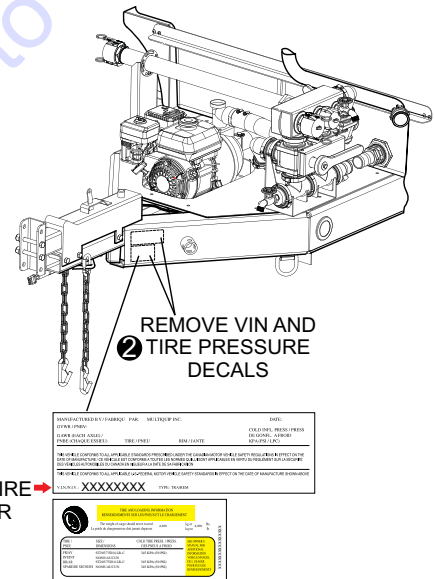

Figure 2. VIN/Tire Pressure Decal Removal

2. Remove the VIN and tire pressure decals as shown in Figure 2.

PROCEDURE

1. Using a grinder (Figure 3), **remove paint** from area to be heated during welding.

NOTICE

Failure to properly remove the Powder Coat prior to welding may cause **excessive porosity** in the welds.

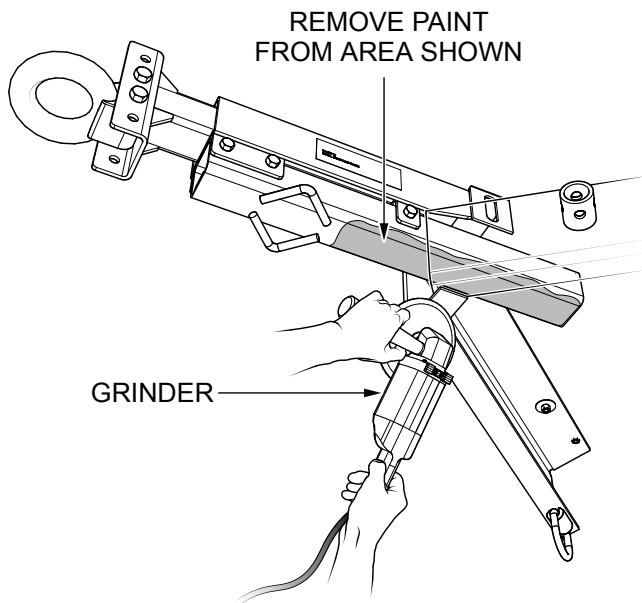

Figure 3. Paint Removal

CAUTION

If the paint cannot be removed, wear an approved respirator before heating or welding to prevent inhalation of hazardous material.

2. Locate the A-frame cavity area (Figure 4) under the tongue side on the trailer frame.
3. Next, slide hitch mount brace (P/N 59182) into the cavity area on the trailer frame as shown in Figure 4.

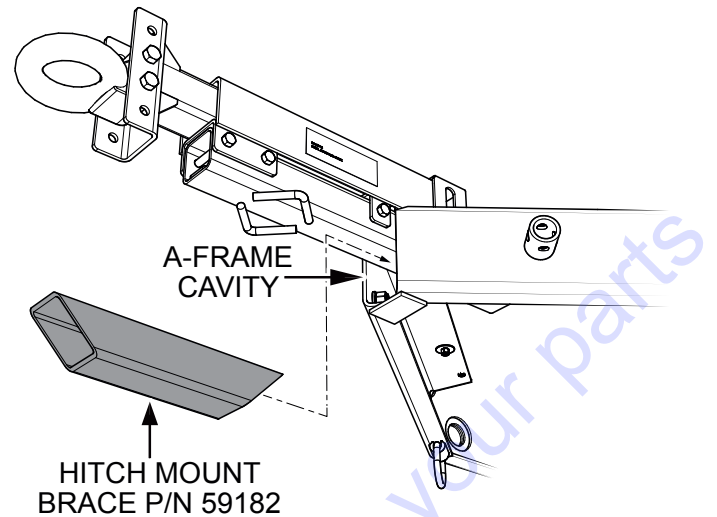

Figure 4. Inserting Hitch Mount Brace

4. Position the brace so that 7/16" clearance exists between the trailer frame and the rear section of the brace as shown in Figure 5.

NOTICE

You may experience that the Hitch Mount Brace will not easily fit inside the A-Frame Cavity prior to the welding operations. Overtime, the build-up of materials inside the cavity may require you to clean and/or grind out the unwanted materials.

Further, you may be caused to do slight grinding of the Hitch Mount Brace to allow it to slide into place within the A-Frame cavity.

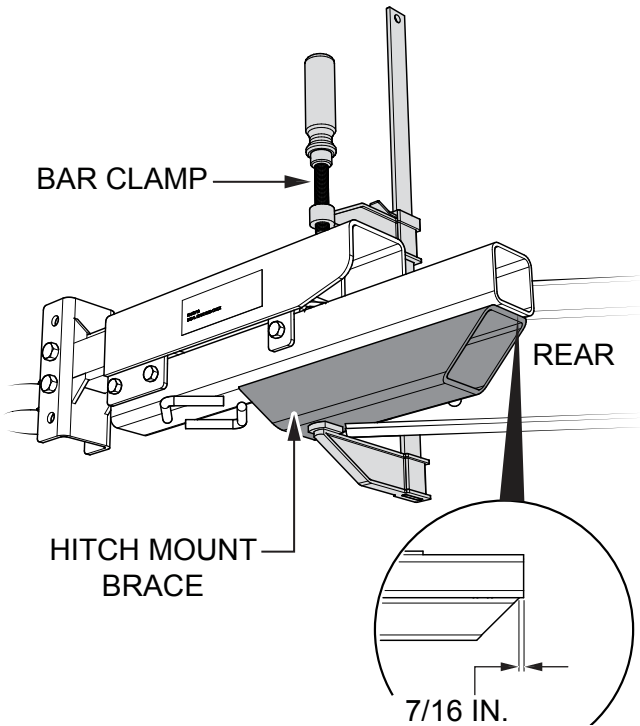

Figure 5. Hitch Mount Brace Placement

- Once the hitch mount brace has been correctly positioned, secure brace in place with bar clamp as shown in Figure 5.

WELDING

- Weld hitch mount brace (Figure 6) onto trailer frame.

NOTICE

When performing longitudinal welds on hitch mount brace, apply 2" welds on 4" centers minimum.

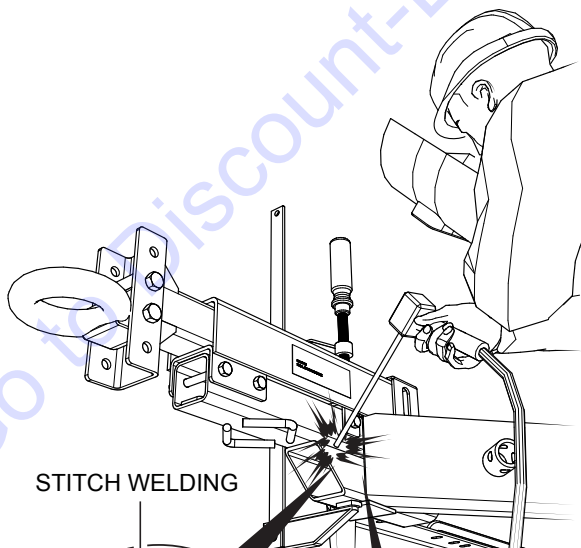

Figure 6. Welding Hitch Mount Brace

- At the completion of the welding process, remove any flux, burrs or rough edges from the welding area.

PAINTING

NOTICE

Let welded area cool before painting.

- Clean all welding areas on the trailer frame with a wire brush, then paint area with **black glossy spray paint** (Figure 7).

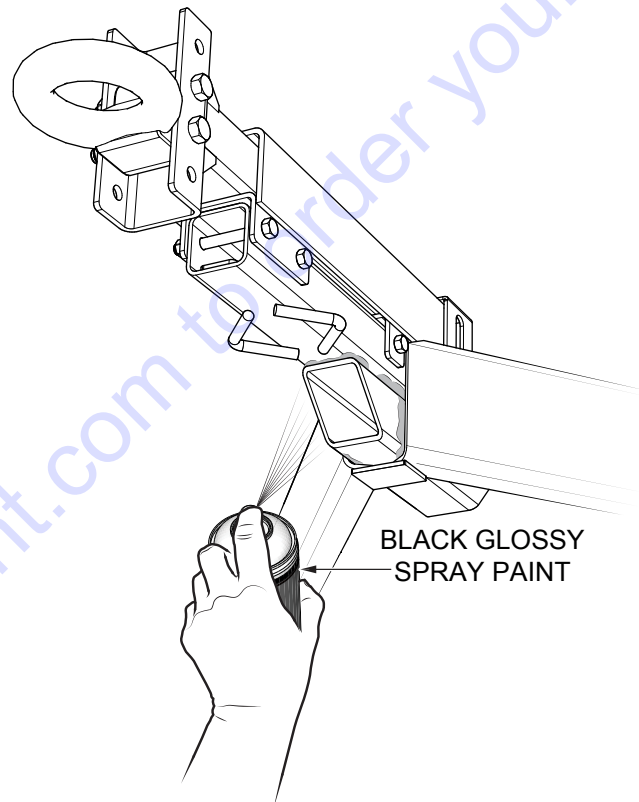

Figure 7. Painting Welding Area

VIN AND TIRE PRESSURE DECAL PLACEMENT

NOTICE

The steps below cannot be completed until your warranty claim has been processed. Once your claim has been processed and your VIN number verified, replacement VIN and tire pressure decals will be sent to you.

1. Compare your new replacement VIN decal identification number with the number that was recorded earlier.
2. If the numbers match proceed to step 3. If the numbers **DO NOT** match, contact Discount-equipment.
3. Clean the decal surface with isopropyl alcohol prior to decal placement.
4. Place the replacement VIN and tire pressure decals as shown in Figure 8.

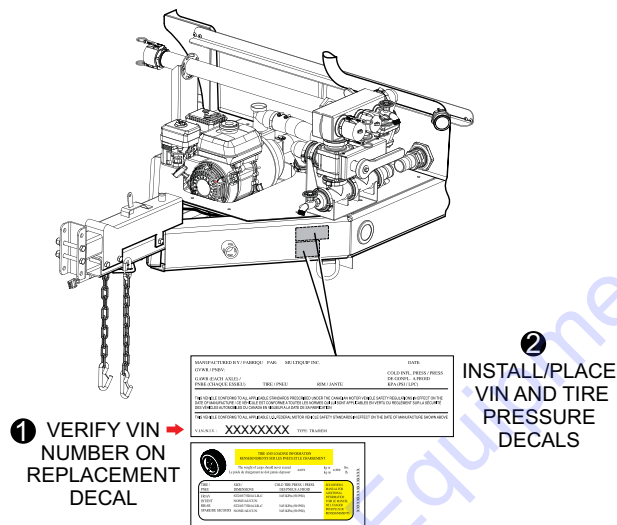

Figure 8. VIN/Tire Pressure Decals (Placement)

PARTS FINDER

**Search Website
by Part Number**



**Search Manual
Library For Parts
Manual & Lookup Part
Numbers – Purchase
or Request Quote**

Search Manuals

Enter your information to help us find the right parts manual for your machine.

* Brand:

* Model:

* Serial:

* Part Number:

SEARCH

**Can't Find Part or
Manual? Request Help
by Manufacturer,
Model & Description**

Parts Order Form

Please fill in the following information to help us find the right part for your machine.

| | |
|---------------|----------------------|
| Manufacturer: | <input type="text"/> |
| Model: | <input type="text"/> |
| Description: | <input type="text"/> |
| Part Number: | <input type="text"/> |
| Quantity: | <input type="text"/> |
| Notes: | <input type="text"/> |

Submit

Discount-Equipment.com is your online resource for quality parts & equipment.

Florida: **561-964-4949** Outside Florida TOLL FREE: **877-690-3101**

Need parts?

Click on this link: <http://www.discount-equipment.com/category/5443-parts/> and choose one of the options to help get the right parts and equipment you are looking for. Please have the machine model and serial number available in order to help us get you the correct parts. If you don't find the part on the website or on one of the online manuals, please fill out the request form and one of our experienced staff members will get back to you with a quote for the right part that your machine needs.

We sell worldwide for the brands: Genie, Terex, JLG, MultiQuip, Mikasa, Essick, Whiteman, Mayco, Toro Stone, Diamond Products, Generac Magnum, Airman, Haulotte, Barreto, Power Blanket, Nifty Lift, Atlas Copco, Chicago Pneumatic, Allmand, Miller Curber, Skyjack, Lull, Skytrak, Tsurumi, Husquvarna Target, Stow, Wacker, Sakai, Mi-T-M, Sullair, Basic, Dynapac, MBW, Weber, Bartell, Bennar Newman, Haulotte, Ditch Runner, Menegotti, Morrison, Contec, Buddy, Crown, Edco, Wyco, Bomag, Laymor, EZ Trench, Bil-Jax, F.S. Curtis, Gehl Pavers, Heli, Honda, ICS/PowerGrit, IHI, Partner, Imer, Clipper, MMD, Koshin, Rice, CH&E, General Equipment, Amida, Coleman, NAC, Gradall, Square Shooter, Kent, Stanley, Tamco, Toku, Hatz, Kohler, Robin, Wisconsin, Northrock, Oztec, Toker TK, Rol-Air, APT, Wylie, Ingersoll Rand / Doosan, Innovatech, Con X, Ammann, Mecalac, Makinex, Smith Surface Prep, Small Line, Wanco, Yanmar