



Service Bulletin No. RT20060915
Subject: Nozzle Studs/Retaining Nuts
Models: MT-76D2/MT-86D2
Product Group: Rammers
Date: September 15, 2006

SERVICE BULLETIN

Group: RT

- Mandatory** **Information** **Recommended Change**

Series/Parts Affected:

Machines Affected:

MT-76D2 and MT-86D2 Diesel Rammers

- MT-76D2..... S/N P4644 AND BELOW**
MT-86D2..... S/N P1488 AND BELOW

SERVICE INFORMATION

CAUSE: The above referenced serial number diesel rammers may experience the following:

1. Breaking of fuel nozzle studs due to incorrect torquing.
2. Loosening of fuel nozzle bolts due to incorrect torquing.

SOLUTION:

1. Replace broken fuel nozzle studs if broken and re-torque retaining nuts to correct specification.
2. Re-torque fuel nozzle retaining nuts (if studs are not broken) to correct specification.

PARTS INFORMATION

Quantity	Part #	Description	Remarks
2	11471811910	Stud Bolt M6X65	
2	26366060002	Nut, M6	



INSTALLATION INSTRUCTIONS

WORK SAFELY!

Only a qualified service technician with proper training should perform this installation.

Required Tools/Materials

- Torque Wrench

Please make sure all parts are accounted for.

Safety Procedures

Perform the following before attempting installation:

1. Place the machine on level secure ground that is free of dirt and debris.
2. Wear safety glasses, steel toed boots and any other safety protection that might be required for the modification.

Nozzle Stud Bolt Replacement (If Required)

Perform the following:

1. Using vise grips, remove the broken nozzle stud bolts from the cylinder head.
2. Apply loctite to the cylinder end (Figure 3) of the nozzle stud bolts (P/N 11471811910) and insert them back into the cylinder head. Tighten securely.
3. Place the retainer nozzle over the two studs.
4. Thread (hand tighten) the two retaining nuts (P/N 26366060002) over the studs to keep the retainer nozzle in place (Figure 1). Remember to only hand-tighten the retaining nuts.
5. Using a 10 mm socket and torque wrench (Figure 2), torque the first nozzle retaining nut to 3 FT-LBS, torque the second retaining nut to 3 FT-LBS.
6. Next, set the torque wrench to 6 FT-LBS.
7. Torque the first nozzle retaining nut to 6 FT-LBS, then torque the second retaining nut to 6 FT-LBS.
8. Next, set the torque wrench to 8 FT-LBS.
9. Torque the first nozzle retaining nut to 8 FT-LBS, then torque the second retaining nut to 8 FT-LBS.

NOTE:

If the nozzle studs are not broken, re-torque the nozzle retaining nuts as specified in steps 4 through 9.

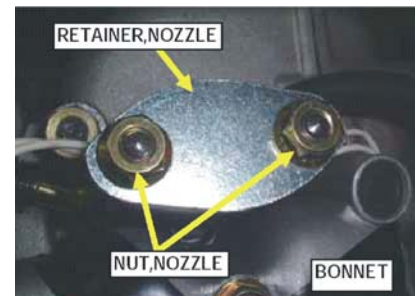

Figure 1. Retainer Nozzle



Figure 2. Torque Wrench

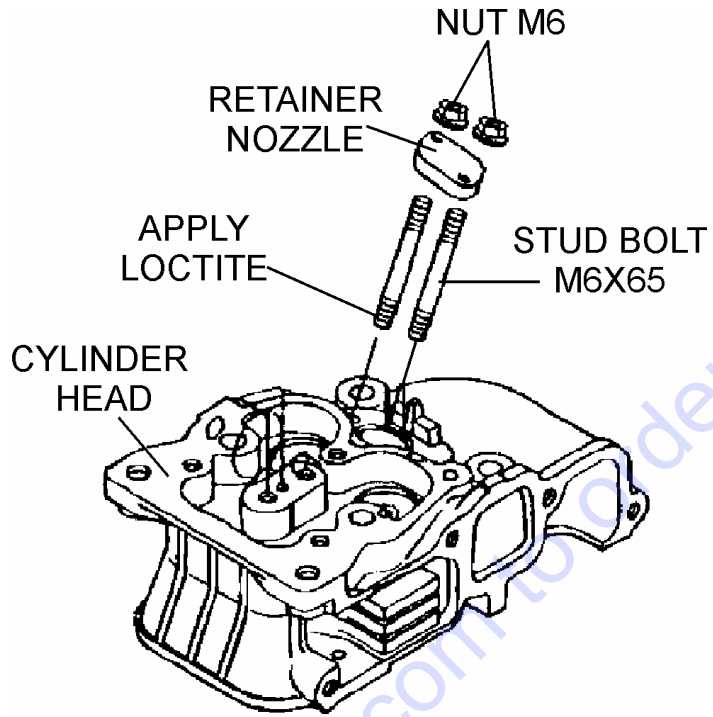

Figure 3. Cylinder Head

PARTS FINDER

**Search Website
by Part Number**



**Search Manual
Library For Parts
Manual & Lookup Part
Numbers – Purchase
or Request Quote**

Search Manuals

Enter your information to help us find the right parts manual for your machine.

* Brand:

* Model:

* Serial:

* Part Number:

SEARCH

**Can't Find Part or
Manual? Request Help
by Manufacturer,
Model & Description**

Parts Order Form

Please fill in the following information to help us find the right part for your machine.

Manufacturer:	<input type="text"/>
Model:	<input type="text"/>
Description:	<input type="text"/>
Part Number:	<input type="text"/>
Quantity:	<input type="text"/>
Notes:	<input type="text"/>

Submit

Discount-Equipment.com is your online resource for quality parts & equipment.

Florida: **561-964-4949** Outside Florida TOLL FREE: **877-690-3101**

Need parts?

Click on this link: <http://www.discount-equipment.com/category/5443-parts/> and choose one of the options to help get the right parts and equipment you are looking for. Please have the machine model and serial number available in order to help us get you the correct parts. If you don't find the part on the website or on one of the online manuals, please fill out the request form and one of our experienced staff members will get back to you with a quote for the right part that your machine needs.

We sell worldwide for the brands: Genie, Terex, JLG, MultiQuip, Mikasa, Essick, Whiteman, Mayco, Toro Stone, Diamond Products, Generac Magnum, Airman, Haulotte, Barreto, Power Blanket, Nifty Lift, Atlas Copco, Chicago Pneumatic, Allmand, Miller Curber, Skyjack, Lull, Skytrak, Tsurumi, Husquvarna Target, Stow, Wacker, Sakai, Mi-T-M, Sullair, Basic, Dynapac, MBW, Weber, Bartell, Bennar Newman, Haulotte, Ditch Runner, Menegotti, Morrison, Contec, Buddy, Crown, Edco, Wyco, Bomag, Laymor, EZ Trench, Bil-Jax, F.S. Curtis, Gehl Pavers, Heli, Honda, ICS/PowerGrit, IHI, Partner, Imer, Clipper, MMD, Koshin, Rice, CH&E, General Equipment, Amida, Coleman, NAC, Gradall, Square Shooter, Kent, Stanley, Tamco, Toku, Hatz, Kohler, Robin, Wisconsin, Northrock, Oztec, Toker TK, Rol-Air, APT, Wylie, Ingersoll Rand / Doosan, Innovatech, Con X, Ammann, Mecalac, Makinex, Smith Surface Prep, Small Line, Wanco, Yanmar