



Service Bulletin

STX6H Relief Valve Cartridge Replacement

Product Group: Ride-On Trowels	Date Issued: 9/5/17	Expiration Date: 9/5/18	Service Bulletin No.: TR20170810
Bulletin Type <input checked="" type="checkbox"/> Mandatory <input type="checkbox"/> Information Only <input type="checkbox"/> Recommended Change		Models/Series Affected: STX6H S/N PK2003364 – NE2003524	

Details
Problem: Existing relief valve cartridges have incorrect pressure settings.
Solution: Install new relief valve cartridges that have correct pressure settings.

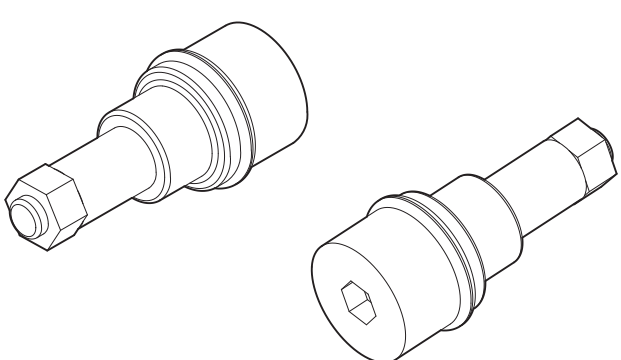
Parts Information										
<table border="1" style="margin: 0 auto; border-collapse: collapse;"> <thead> <tr> <th style="width: 10%;">Item No.</th> <th style="width: 15%;">Part No.</th> <th style="width: 40%;">Description</th> <th style="width: 10%;">QTY.</th> <th style="width: 25%;">Remarks</th> </tr> </thead> <tbody> <tr> <td style="text-align: center;">1</td> <td style="text-align: center;">42611-1</td> <td style="text-align: center;">Cartridge, Relief Valve</td> <td style="text-align: center;">2</td> <td></td> </tr> </tbody> </table>  <p style="text-align: center;">Figure 1. Relief Valve Cartridges</p>	Item No.	Part No.	Description	QTY.	Remarks	1	42611-1	Cartridge, Relief Valve	2	
Item No.	Part No.	Description	QTY.	Remarks						
1	42611-1	Cartridge, Relief Valve	2							

PARTS FINDER

**Search Website
by Part Number**



**Search Manual
Library For Parts
Manual & Lookup Part
Numbers – Purchase
or Request Quote**

Search Manuals

Enter your information to help us find the right parts manual for your machine.

* Brand:

* Model:

* Serial:

* Part Number:

SEARCH

**Can't Find Part or
Manual? Request Help
by Manufacturer,
Model & Description**

Parts Order Form

Please fill in the following information to help us find the right part for your machine.

Manufacturer:	<input type="text"/>
Model:	<input type="text"/>
Description:	<input type="text"/>
Part Number:	<input type="text"/>
Quantity:	<input type="text"/>
Notes:	<input type="text"/>

Submit

Discount-Equipment.com is your online resource for quality parts & equipment.

Florida: **561-964-4949** Outside Florida TOLL FREE: **877-690-3101**

Need parts?

Click on this link: <http://www.discount-equipment.com/category/5443-parts/> and choose one of the options to help get the right parts and equipment you are looking for. Please have the machine model and serial number available in order to help us get you the correct parts. If you don't find the part on the website or on one of the online manuals, please fill out the request form and one of our experienced staff members will get back to you with a quote for the right part that your machine needs.

We sell worldwide for the brands: Genie, Terex, JLG, MultiQuip, Mikasa, Essick, Whiteman, Mayco, Toro Stone, Diamond Products, Generac Magnum, Airman, Haulotte, Barreto, Power Blanket, Nifty Lift, Atlas Copco, Chicago Pneumatic, Allmand, Miller Curber, Skyjack, Lull, Skytrak, Tsurumi, Husquvarna Target, Stow, Wacker, Sakai, Mi-T-M, Sullair, Basic, Dynapac, MBW, Weber, Bartell, Bennar Newman, Haulotte, Ditch Runner, Menegotti, Morrison, Contec, Buddy, Crown, Edco, Wyco, Bomag, Laymor, EZ Trench, Bil-Jax, F.S. Curtis, Gehl Pavers, Heli, Honda, ICS/PowerGrit, IHI, Partner, Imer, Clipper, MMD, Koshin, Rice, CH&E, General Equipment, Amida, Coleman, NAC, Gradall, Square Shooter, Kent, Stanley, Tamco, Toku, Hatz, Kohler, Robin, Wisconsin, Northrock, Oztec, Toker TK, Rol-Air, APT, Wylie, Ingersoll Rand / Doosan, Innovatech, Con X, Ammann, Mecalac, Makinex, Smith Surface Prep, Small Line, Wanco, Yanmar

WORK SAFELY!

Only a qualified service technician with proper training should perform this procedure. Follow all shop safety rules while performing this procedure.

PREPARATION

1. Make sure the trowel is turned off and **the engine is cool**.
2. Place the trowel in an area free of dirt and debris, and make sure it is on secure level ground.

REQUIRED TOOLS

- 5/16" Socket
- 1-1/4" Wrench or Socket

TROWEL SAFETY

⚠ CAUTION

- **NEVER** lubricate components or attempt service on a running machine.

ENGINE SAFETY

⚠ WARNING

- **NEVER** place hands or fingers inside the engine compartment while the engine is running.

⚠ CAUTION

- **NEVER** touch the **hot** exhaust manifold, muffler, or cylinder. Allow these parts to cool before servicing the equipment.



BATTERY SAFETY

⚠ DANGER

- **DO NOT** expose the battery to open flames, sparks, cigarettes, etc. The battery contains combustible fluids. If these fluids come into contact with a flame or spark, an explosion can occur.

⚠ CAUTION

- **ALWAYS** disconnect the **NEGATIVE** battery terminal before servicing the equipment.

BATTERY DISCONNECTION

1. Remove and set aside the **LEFT** grill guard to gain access to the battery (Figure 2).

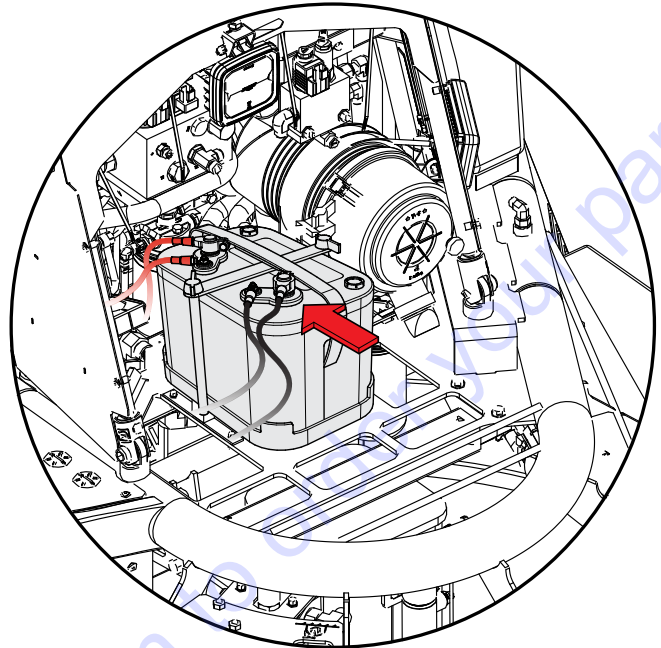

Figure 2. Battery Disconnection

2. Disconnect the two negative (**BLACK**) cables from the negative terminal on the battery. See Figure 2.

FOOT PLATFORM REMOVAL

1. Using a 5/16" socket, remove and set aside the 15 screws securing the foot platform to the frame (Figure 3).

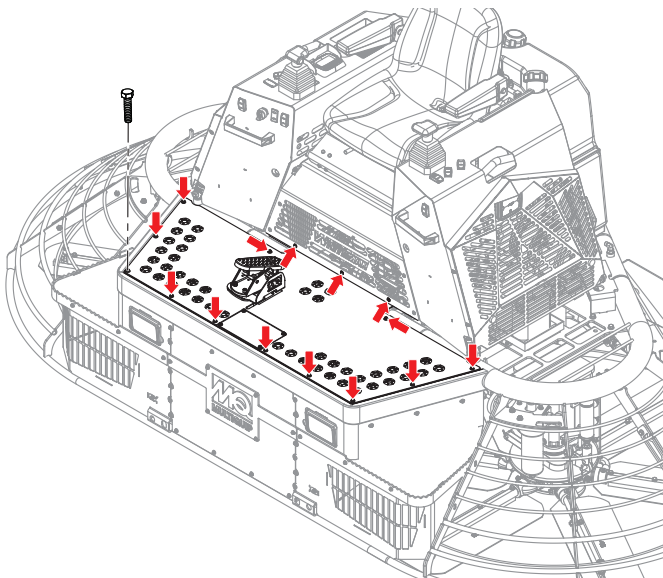

Figure 3. Foot Platform Hardware Removal

2. Remove the foot platform and set it in front of the trowel as shown in Figure 4. **DO NOT** disconnect or remove the foot pedal sensor cable.

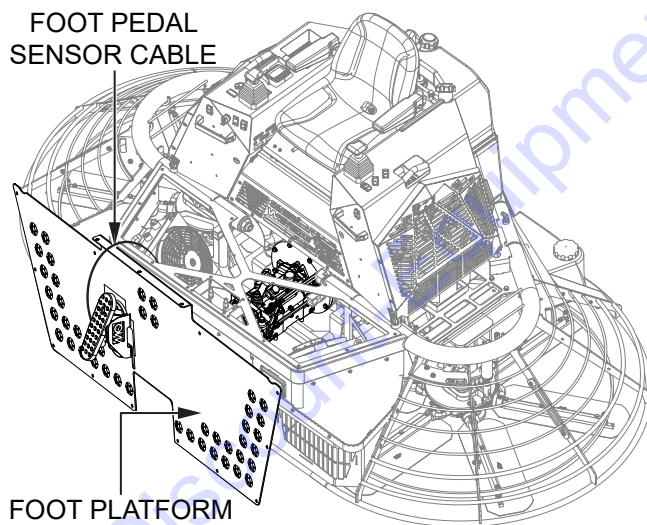

Figure 4. Foot Platform Removal

NOTICE

MAKE SURE the foot pedal sensor cable remains connected. Disconnection of this cable will cause an electrical fault.

RELIEF VALVE CARTRIDGE REPLACEMENT

1. Locate the two relief valve cartridges (Figure 5) on top of the pump assembly.

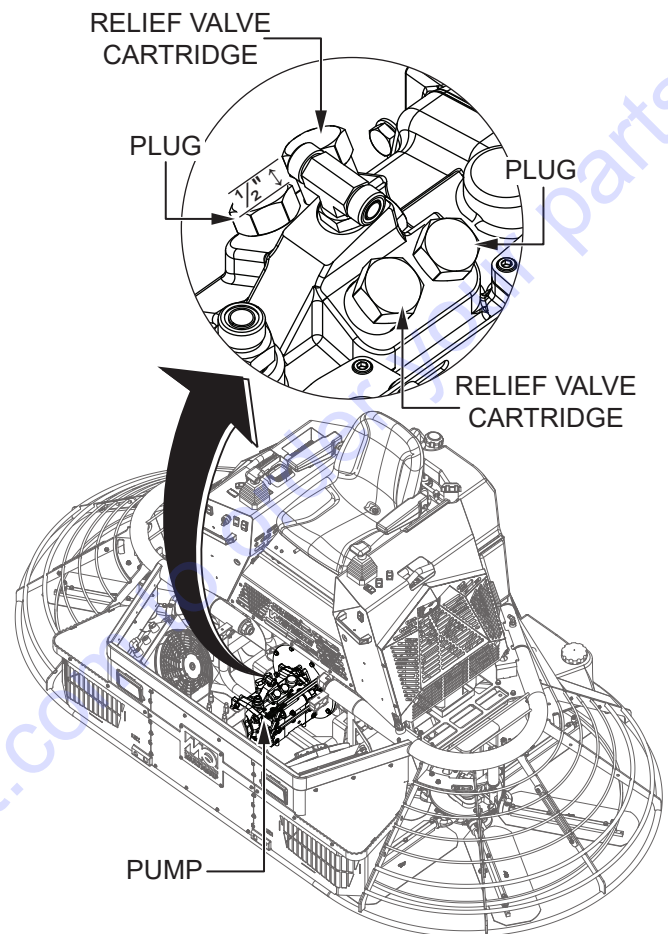

Figure 5. Relief Valve Cartridge Location

NOTICE

Each relief valve cartridge sits next to a plug that is nearly identical to it. **DO NOT remove these plugs!** The relief valve cartridges to be removed are approximately 1/2-inch longer than the plugs sitting next to them. See Figure 5.

- Using a 1-1/4" wrench or socket, remove and discard both relief valve cartridges (Figure 6A).

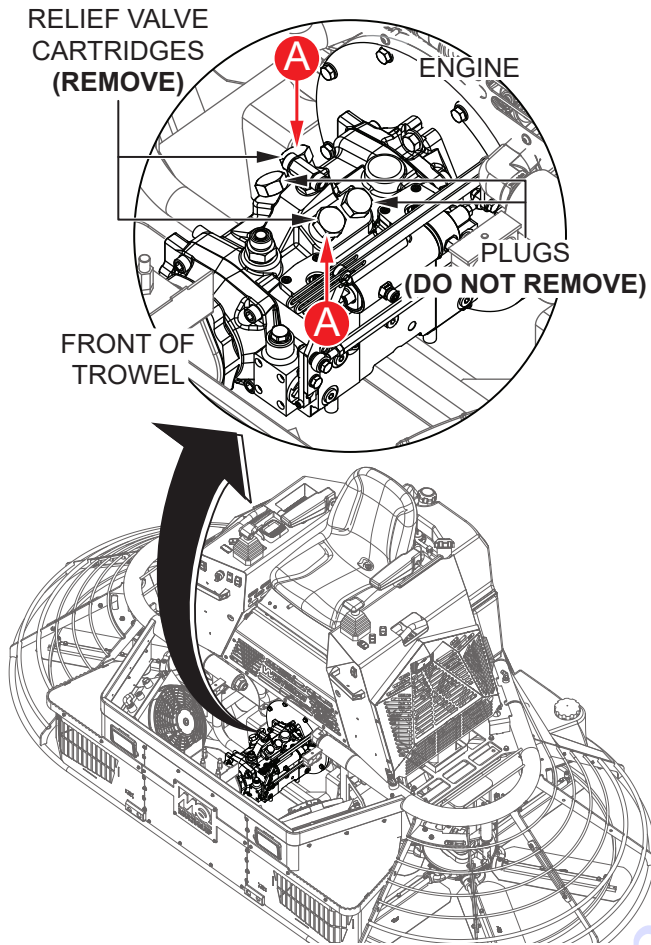

Figure 6. Relief Valve Cartridge Removal

- Insert the two new relief valve cartridges (P/N 42611-1) into the pump and torque them each to 60 ft-lb (81.35 N·m). See Figure 7.

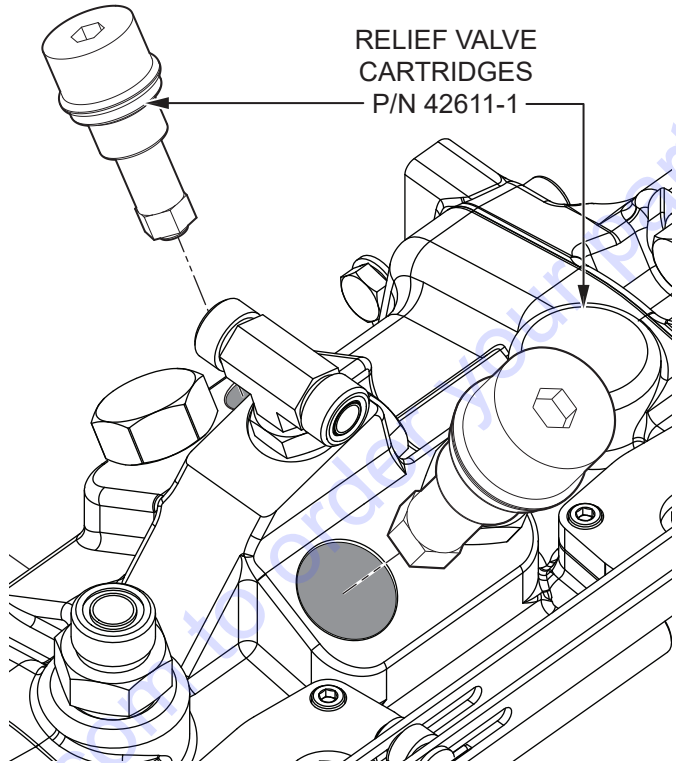

Figure 7. Relief Valve Cartridge Installation

TESTING AND REASSEMBLY

- Reinstall the foot platform with the hardware that was removed earlier.
- Reconnect the negative (**BLACK**) battery cables.
- Start the engine according to the instructions found in the STX6H operation manual. Allow the engine to run for a few minutes, and make sure there are no leaks.

PARTS FINDER

**Search Website
by Part Number**



**Search Manual
Library For Parts
Manual & Lookup Part
Numbers – Purchase
or Request Quote**

Search Manuals

Enter your information to help us find the right parts manual for your machine.

* Brand:

* Model:

* Serial:

* Part Number:

SEARCH

**Can't Find Part or
Manual? Request Help
by Manufacturer,
Model & Description**

Parts Order Form

Please fill in the following information to help us find the right part for your machine.

Manufacturer:	<input type="text"/>
Model:	<input type="text"/>
Description:	<input type="text"/>
Part Number:	<input type="text"/>
Quantity:	<input type="text"/>
Notes:	<input type="text"/>

Discount-Equipment.com is your online resource for quality parts & equipment.

Florida: **561-964-4949** Outside Florida TOLL FREE: **877-690-3101**

Need parts?

Click on this link: <http://www.discount-equipment.com/category/5443-parts/> and choose one of the options to help get the right parts and equipment you are looking for. Please have the machine model and serial number available in order to help us get you the correct parts. If you don't find the part on the website or on one of the online manuals, please fill out the request form and one of our experienced staff members will get back to you with a quote for the right part that your machine needs.

We sell worldwide for the brands: Genie, Terex, JLG, MultiQuip, Mikasa, Essick, Whiteman, Mayco, Toro Stone, Diamond Products, Generac Magnum, Airman, Haulotte, Barreto, Power Blanket, Nifty Lift, Atlas Copco, Chicago Pneumatic, Allmand, Miller Curber, Skyjack, Lull, Skytrak, Tsurumi, Husquvarna Target, Stow, Wacker, Sakai, Mi-T-M, Sullair, Basic, Dynapac, MBW, Weber, Bartell, Bennar Newman, Haulotte, Ditch Runner, Menegotti, Morrison, Contec, Buddy, Crown, Edco, Wyco, Bomag, Laymor, EZ Trench, Bil-Jax, F.S. Curtis, Gehl Pavers, Heli, Honda, ICS/PowerGrit, IHI, Partner, Imer, Clipper, MMD, Koshin, Rice, CH&E, General Equipment, Amida, Coleman, NAC, Gradall, Square Shooter, Kent, Stanley, Tamco, Toku, Hatz, Kohler, Robin, Wisconsin, Northrock, Oztec, Toker TK, Rol-Air, APT, Wylie, Ingersoll Rand / Doosan, Innovatech, Con X, Ammann, Mecalac, Makinex, Smith Surface Prep, Small Line, Wanco, Yanmar