



MANDATORY UPDATE INFORMATION

Date: 03/23/18
To: TRLR45/TRLR70US Trailer Owners
From: Multiquip Product Department
Subject: Trailer Frame Reinforcement — **Mandatory Update**



Dear Multiquip Customer,

Our records indicate that your company purchased one or more TRLR45 or TRLR70US Trailers.

Multiquip deems the design of these trailers to be adequate in their current state to handle the specified GVWR. However, in the interest of public safety, due to unintentional overload as a foreseeable misuse, we are enhancing the safety factor of the trailer design by mandating the installation of this update.

The accompanying bulletin lists the problems and explains the actions required to correct these problems.

Failure to repair may compromise structural integrity of the trailer frame when unintentionally overloaded.

If this trailer has been resold, please forward this bulletin to the new owner.

Your prompt attention to this matter is appreciated. If you have questions, please contact Discount-equipment.

Go to Discount-Equipment.com to order your parts

PARTS FINDER

**Search Website
by Part Number**



**Search Manual
Library For Parts
Manual & Lookup Part
Numbers – Purchase
or Request Quote**

Search Manuals

Enter part number or description to find parts manual or lookup part numbers.

* Part #

* Model

Serial

Part Number

Submit

**Can't Find Part or
Manual? Request Help
by Manufacturer,
Model & Description**

Parts Order Form

Please fill in the following information to request help.

Manufacturer

Model

Description

Part Number

Quantity

Unit Price

Total Price

Submit

Discount-Equipment.com is your online resource for quality parts & equipment.

Florida: **561-964-4949** Outside Florida TOLL FREE: **877-690-3101**

Need parts?

Click on this link: <http://www.discount-equipment.com/category/5443-parts/> and choose one of the options to help get the right parts and equipment you are looking for. Please have the machine model and serial number available in order to help us get you the correct parts. If you don't find the part on the website or on one of the online manuals, please fill out the request form and one of our experienced staff members will get back to you with a quote for the right part that your machine needs.

We sell worldwide for the brands: Genie, Terex, JLG, MultiQuip, Mikasa, Essick, Whiteman, Mayco, Toro Stone, Diamond Products, Generac Magnum, Airman, Haulotte, Barreto, Power Blanket, Nifty Lift, Atlas Copco, Chicago Pneumatic, Allmand, Miller Curber, Skyjack, Lull, Skytrak, Tsurumi, Husquvarna Target, Stow, Wacker, Sakai, Mi-T-M, Sullair, Basic, Dynapac, MBW, Weber, Bartell, Bennar Newman, Haulotte, Ditch Runner, Menegotti, Morrison, Contec, Buddy, Crown, Edco, Wyco, Bomag, Laymor, EZ Trench, Bil-Jax, F.S. Curtis, Gehl Pavers, Heli, Honda, ICS/PowerGrit, IHI, Partner, Imer, Clipper, MMD, Koshin, Rice, CH&E, General Equipment, Amida, Coleman, NAC, Gradall, Square Shooter, Kent, Stanley, Tamco, Toku, Hatz, Kohler, Robin, Wisconsin, Northrock, Oztec, Toker TK, Rol-Air, APT, Wylie, Ingersoll Rand / Doosan, Innovatech, Con X, Ammann, Mecalac, Makinex, Smith Surface Prep, Small Line, Wanco, Yanmar



Service Bulletin

TRLR45/TRLR70US Gusset Installation

Product Group: Trailers	Date Issued: 03/23/18	Expiration Date: 03/23/19	Service Bulletin No. TL20180306
Bulletin Type <input checked="" type="checkbox"/> Mandatory <input type="checkbox"/> Information Only <input type="checkbox"/> Recommended Change		Models/Series Affected: TRLR45 VIN L021853, L021854, L021855, L021856, L021857, L021858, and L021873 TRLR70US VIN L021931, L021932, L021933, L021934, L021936, and L021937	

Details

Problem:

Improve existing trailer design.

Solution:

Install trailer reinforcement gussets.

Parts Information

Table 1. Gusset Installation Kit				
Item No.	Part No.	Description	Qty.	Remarks
1	49941-02	Gusset, Jack Crossmember, TRLR45	2	TRLR45 only
1	49927-02	Gusset, Jack Crossmember, TRLR70	2	TRLR70 only

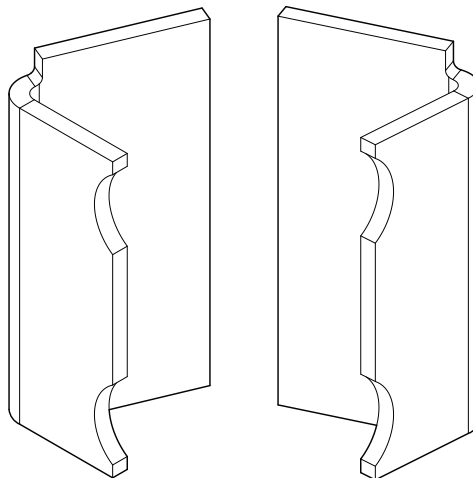

Figure 1. Gussets

WORK SAFELY!

Only a **certified welder** with proper training should perform this installation. Follow all shop safety rules while performing this installation.

NOTICE

If gussets are already installed on the jack crossmember of your trailer frame, please disregard this bulletin.

NOTICE

Failure to repair may compromise structural integrity of the trailer frame when unintentionally overloaded.

SAFETY

- Perform all work in a well-ventilated area to prevent inhalation of dust and toxic fumes.
- **DO NOT** use chlorinated solvents in areas where welding will take place.
- **ALWAYS** properly dispose of paint and solvents.

REQUIRED TOOLS

- Welder
- Locking C-clamp
- Approved respirator
- Welding face shield
- Safety glasses
- Gloves
- Hard hat
- Grinder
- Flat black spray paint

PREPARATION

1. Make sure the gussets are accounted for before beginning this installation procedure. Refer to Table 1 and Figure 1.
2. Place the trailer in an area free of dirt and debris. Make sure it is on secure, level ground with chock blocks underneath each wheel to prevent the trailer from rolling.

DECAL REMOVAL

NOTICE

Due to **excessive heat** during the welding process, the possibility exists that the **Vehicle Identification Number (VIN)** and **tire pressure** decals may become damaged.

NOTICE

Record the **entire** Vehicle Identification Number (VIN) displayed on the decal before removing the decal.

Replacement VIN and tire pressure decals will be provided only after a claim has been filed with the MQ Warranty Department.

1. Record the **entire** Vehicle Identification Number displayed on the VIN decal. Also record the **last five digits** of the VIN number which are stamped into the trailer frame (Figure 2).

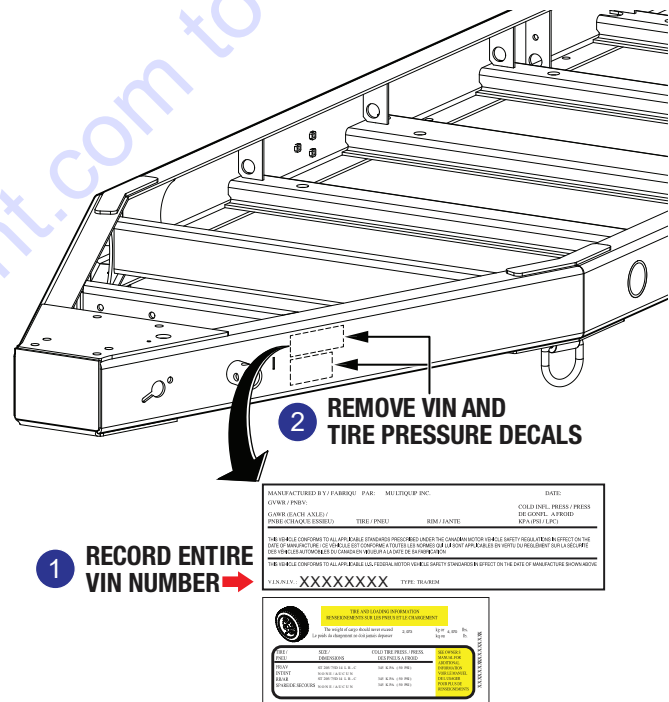

Figure 2. VIN/Tire Pressure Decal Removal

2. Remove the VIN and tire pressure decals (Figure 2).

PAINT REMOVAL

1. Using a grinder, remove the paint from the areas to be heated during welding (Figure 3).

NOTICE

Failure to properly remove the powder coat prior to welding may cause **excessive porosity** in the welds.

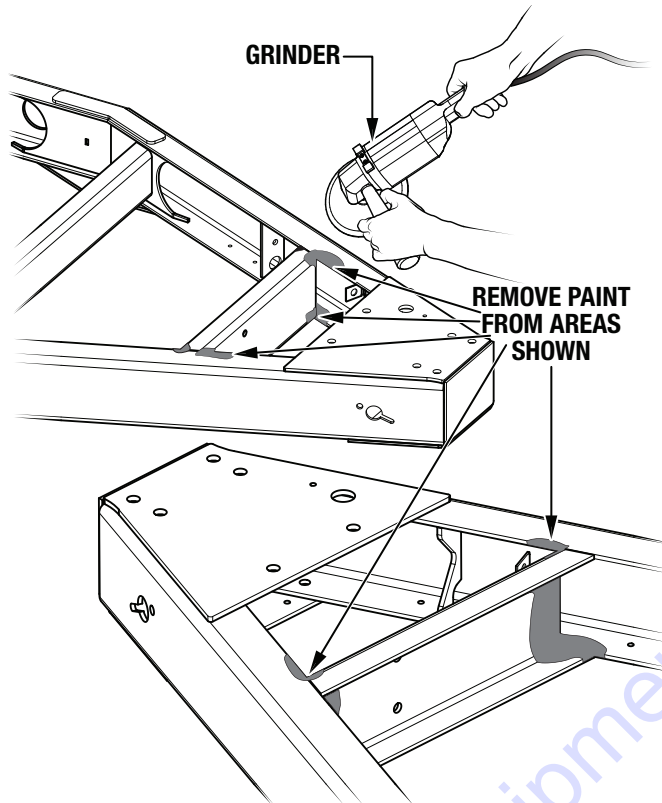

Figure 3. Paint Removal

CAUTION

If the paint cannot be removed, wear an approved respirator before heating or welding to prevent inhalation of hazardous material.

WELDING

1. Place the gusset (P/N 49941-02, P/N 49927-02, or P/N 49867-02) between the jack crossmember and drawbar rail as shown in Figure 4.

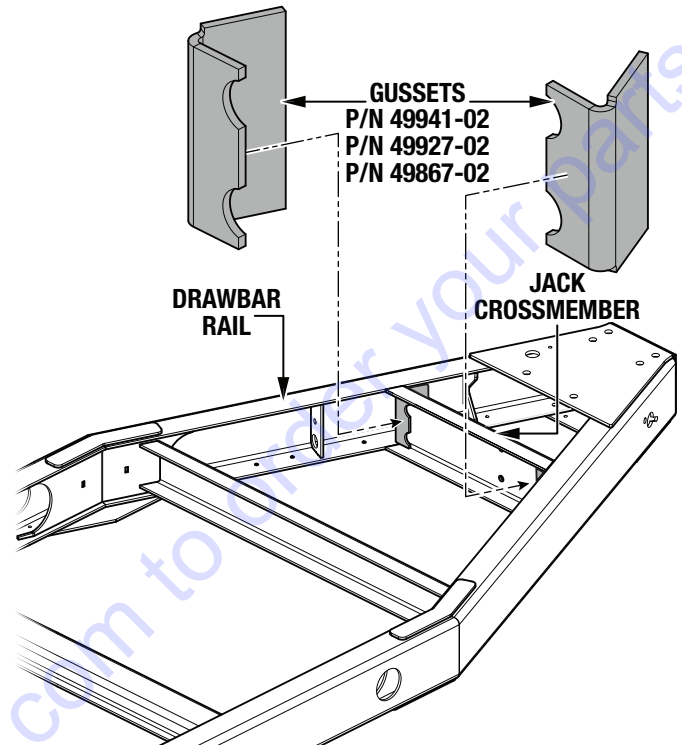

Figure 4. Gusset Placement

2. Once the gusset is correctly positioned, secure it in place with a locking C-clamp as shown in Figure 5.

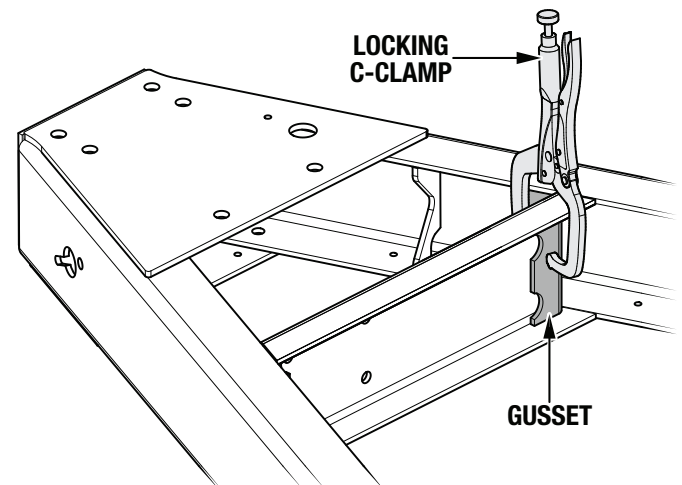

Figure 5. Secure Gusset with Clamp

3. Weld the gusset to the trailer frame (Figure 6).

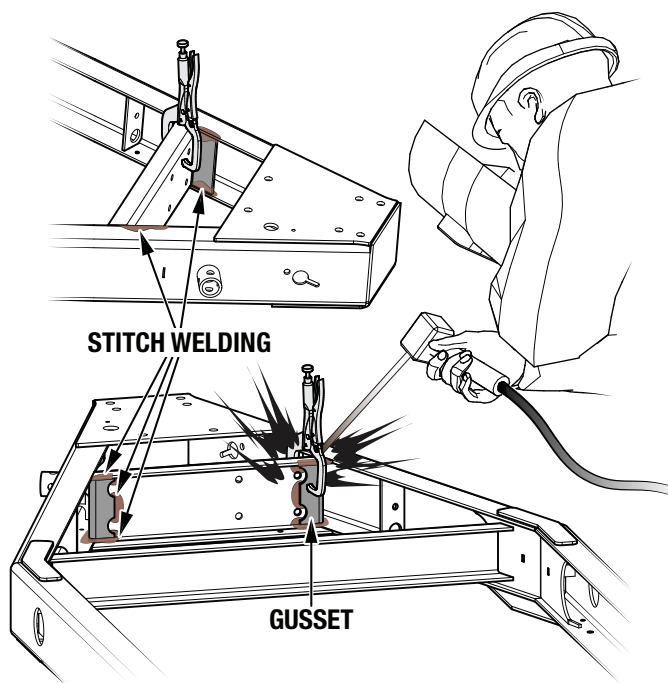

Figure 6. Gusset Welding

4. Repeat steps 1–3 with the second gusset on the opposite side of the trailer frame.
5. At the completion of the welding process, remove any flux, burrs, or rough edges from the welding area.

PAINTING

NOTICE

Allow the welded area to cool before painting.

1. Clean all welded areas on the trailer frame with a wire brush, then paint the welding areas with **flat black spray paint** (Figure 7).

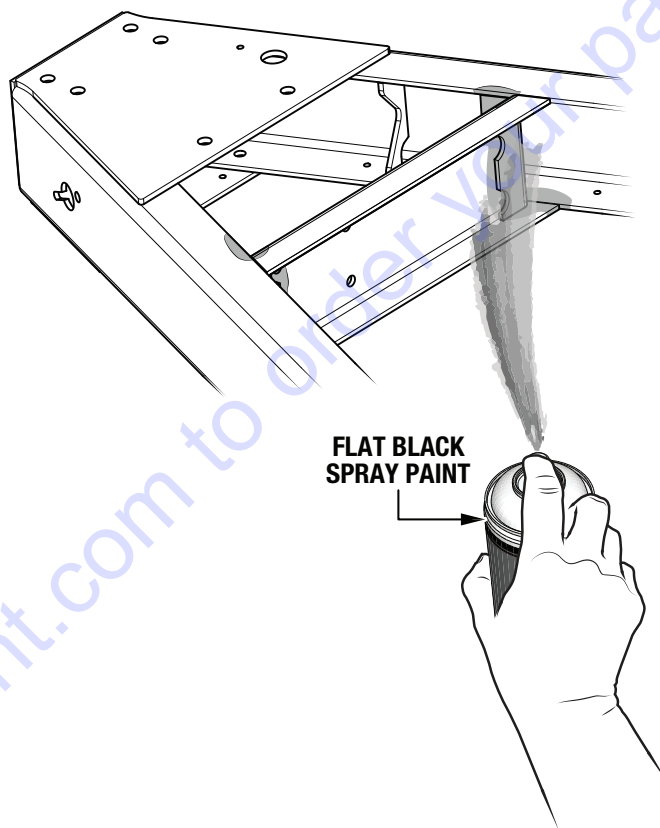

Figure 7. Paint Welding Areas

VIN AND TIRE PRESSURE DECAL REPLACEMENT

NOTICE

The steps below cannot be completed until your warranty claim has been processed. Once your claim has been processed and your VIN number has been verified, replacement VIN and tire pressure decals will be sent to you.

1. Compare your new replacement VIN decal identification number with the number that was recorded earlier. If the numbers match, proceed to step 2. **If the numbers DO NOT match, contact Discount-equipment.**
2. Clean the decal location on the trailer surface with isopropyl alcohol.
3. Place the replacement VIN and tire pressure decals onto the trailer as shown in Figure 8.

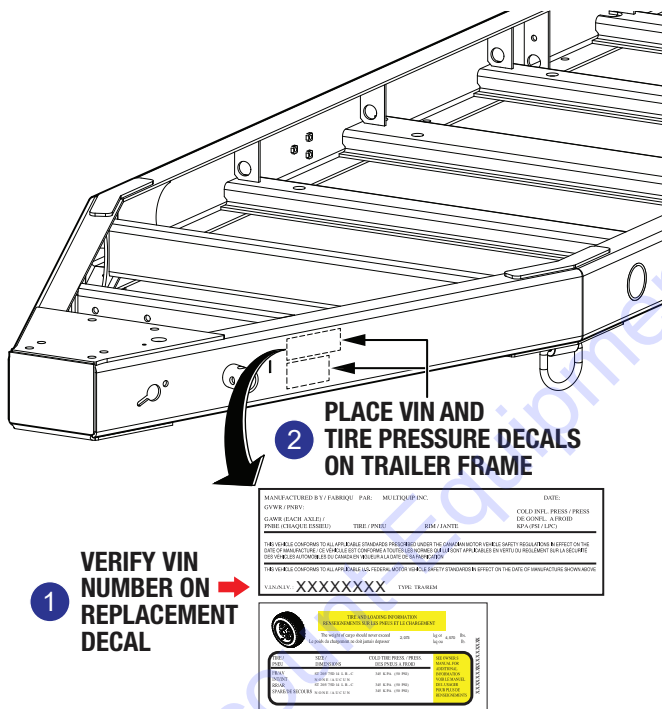

Figure 8. Decal Replacement

PARTS FINDER

**Search Website
by Part Number**



**Search Manual
Library For Parts
Manual & Lookup Part
Numbers – Purchase
or Request Quote**

Search Manuals

Enter part number or description to find parts manual or lookup part numbers

* Part #

* Model

Serial

Part Number

Comments

**Can't Find Part or
Manual? Request Help
by Manufacturer,
Model & Description**

Parts Order Form

Please fill in the following information:

Manufacturer

Model

Description

Quantity

Part Number

Part Name

Part Description

Part Location

Part Condition

Part Status

Part Notes

Discount-Equipment.com is your online resource for quality parts & equipment.

Florida: **561-964-4949** Outside Florida TOLL FREE: **877-690-3101**

Need parts?

Click on this link: <http://www.discount-equipment.com/category/5443-parts/> and choose one of the options to help get the right parts and equipment you are looking for. Please have the machine model and serial number available in order to help us get you the correct parts. If you don't find the part on the website or on one of the online manuals, please fill out the request form and one of our experienced staff members will get back to you with a quote for the right part that your machine needs.

We sell worldwide for the brands: Genie, Terex, JLG, MultiQuip, Mikasa, Essick, Whiteman, Mayco, Toro Stone, Diamond Products, Generac Magnum, Airman, Haulotte, Barreto, Power Blanket, Nifty Lift, Atlas Copco, Chicago Pneumatic, Allmand, Miller Curber, Skyjack, Lull, Skytrak, Tsurumi, Husquvarna Target, Stow, Wacker, Sakai, Mi-T-M, Sullair, Basic, Dynapac, MBW, Weber, Bartell, Bennar Newman, Haulotte, Ditch Runner, Menegotti, Morrison, Contec, Buddy, Crown, Edco, Wyco, Bomag, Laymor, EZ Trench, Bil-Jax, F.S. Curtis, Gehl Pavers, Heli, Honda, ICS/PowerGrit, IHI, Partner, Imer, Clipper, MMD, Koshin, Rice, CH&E, General Equipment, Amida, Coleman, NAC, Gradall, Square Shooter, Kent, Stanley, Tamco, Toku, Hatz, Kohler, Robin, Wisconsin, Northrock, Oztec, Toker TK, Rol-Air, APT, Wylie, Ingersoll Rand / Doosan, Innovatech, Con X, Ammann, Mecalac, Makinex, Smith Surface Prep, Small Line, Wanco, Yanmar