



*The Benchmark of Service*

**Informational Bulletin No. CO20061218**  
**Subject: Pump Casing Cracking**  
**Model: QP4TH**  
**Product Group: Trash Pumps**  
**Date: 02/01/2007**

## INFORMATIONAL BULLETIN

Group: CO

### INFORMATION ONLY!

#### Series/Parts Affected:

**Machines Affected:**  
**QP-4TH S/N 4TH-0653 AND BELOW**

### SERVICE INFORMATION

#### Problem:

- Pump casings are cracking due to loose fitting impeller washers (2).
- Casing cover seal washer has thick rubber causing the casing cover to become loose.

#### Remedy:

- Replace impeller washers with new style washers.
- Replace seal washer with new style washer and apply Loctite (P/N 60098) when casing cover is set to mounting flange of engine.

### PARTS INFORMATION

Quantity	Part #	Description	Remarks
1	0451290070	WASHER, LOCK IMPELLER	
1	1466251240	WASHER, IMPELLER	
4	0458220071	WASHER, SEAL	
1	60098	Loctite #271, RED, HIGH STRENGTH	

## INSTALLATION INSTRUCTIONS

### **WORK SAFELY!**

Only a qualified service technician with proper training should perform this installation.

### **Required Tools/Materials**

- 3/8 Ratchet with 14 mm drive socket
- 8 mm Allen wrench

Please make sure all parts are accounted for.

### **Safety Procedures**

Perform the following before attempting installation:

1. Place the pump on level secure ground that is free of dirt and debris.
2. Wear safety glasses, steel toed boots and any other safety protection that might be required for the modification.

### **Impeller/Seal Washers Installation Procedure (Reference Figure 1)**

1. Remove drain cover from pump casing by turning the locking knobs counterclockwise to loosen. Once the locking knobs have been loosened and folded back, pull the drain cover forward until it clears the pump casing. Set drain cover aside in a safe place.
2. Using a 3/8 ratchet with a 14 mm socket, remove the impeller bolt from the engine shaft.
3. Attached to the impeller bolt are the old style impeller washers. **Discard all washers;** they will not be used again. Retain the impeller bolt, it will be used later.
4. Install the new impeller lock washer (P/N 0451290070) onto the bolt as shown in Figure 1. Next, place the impeller washer (P/N 1466251240) with the key side (raised notch) facing outward onto the impeller bolt.
5. Insert impeller bolt along with associated hardware (Step 4) into engine shaft. Be sure to align the notch on the impeller washer with the key way on the engine shaft. This will lock the impeller washer in place. Tighten impeller bolt to 22 FT-LBS.
6. Remove the 4 bolts (P/N 0131290665) from the inside of the casing cover with an Allen wrench and set aside. Remove and discard the seal washer (P/N 0458220070). Replace the seal washer with the new one (P/N 0458220071).
7. Reinstall the 4 bolts (P/N 0131290665) removed in step 7 and apply Loctite to the threads. Tighten bolts with an Allen wrench to 22 FT-LBS.
8. Reinstall drain cover back into pump casing. Turn locking knobs clockwise to secure drain cover.

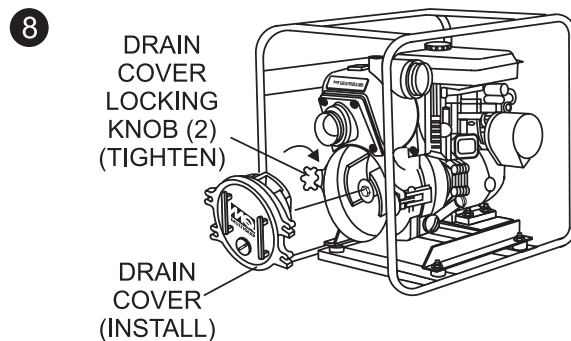
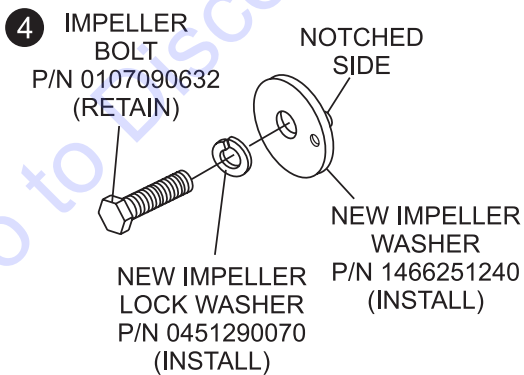
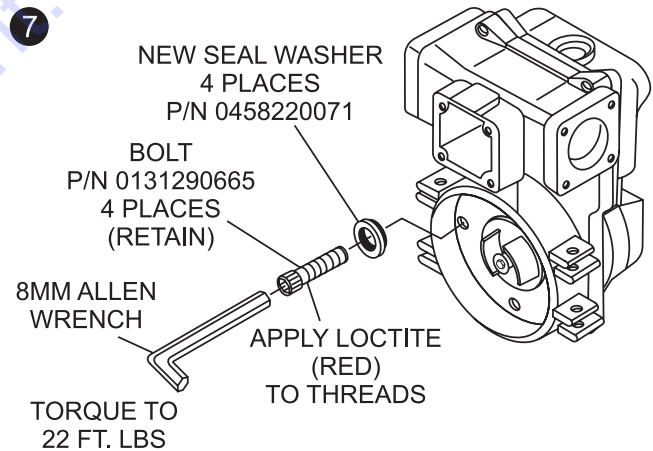
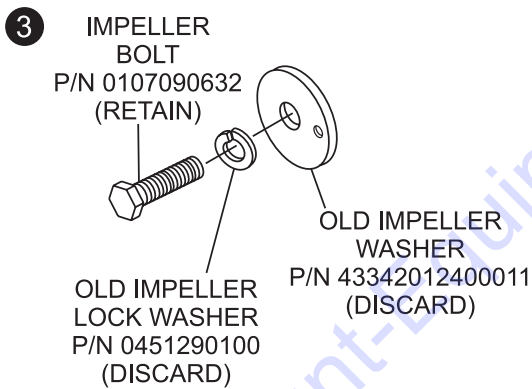
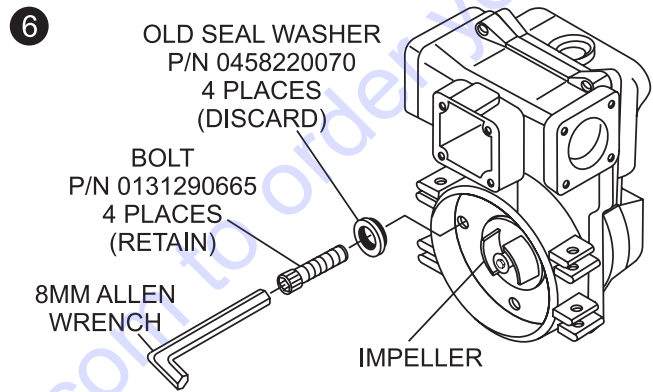
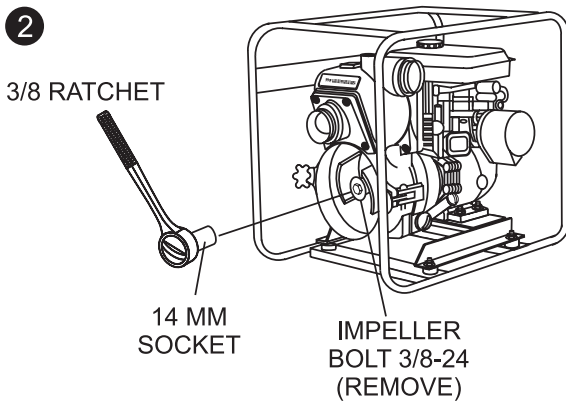
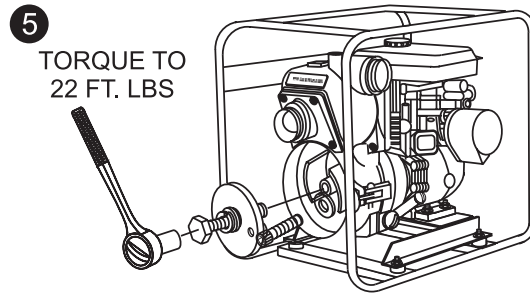
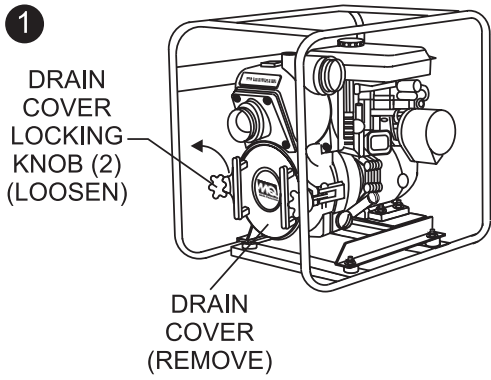

**Figure 1. Impeller/Seal Washer Installation**

# PARTS FINDER

**Search Website  
by Part Number**



**Search Manual  
Library For Parts  
Manual & Lookup Part  
Numbers – Purchase  
or Request Quote**

**Search Manuals**

Enter your information to help us find the right parts manual for your equipment.

\* Brand:

\* Model:

\* Serial:

\* Part Number:

SEARCH

**Can't Find Part or  
Manual? Request Help  
by Manufacturer,  
Model & Description**

**Parts Order Form**

Please fill in the following information to help us find the right part for your equipment.

Manufacturer:	<input type="text"/>
Model:	<input type="text"/>
Description:	<input type="text"/>
Part Number:	<input type="text"/>
Quantity:	<input type="text"/>
Notes:	<input type="text"/>

Submit

Discount-Equipment.com is your online resource for quality parts & equipment.

Florida: **561-964-4949** Outside Florida TOLL FREE: **877-690-3101**

**Need parts?**

Click on this link: <http://www.discount-equipment.com/category/5443-parts/> and choose one of the options to help get the right parts and equipment you are looking for. Please have the machine model and serial number available in order to help us get you the correct parts. If you don't find the part on the website or on one of the online manuals, please fill out the request form and one of our experienced staff members will get back to you with a quote for the right part that your machine needs.

We sell worldwide for the brands: Genie, Terex, JLG, MultiQuip, Mikasa, Essick, Whiteman, Mayco, Toro Stone, Diamond Products, Generac Magnum, Airman, Haulotte, Barreto, Power Blanket, Nifty Lift, Atlas Copco, Chicago Pneumatic, Allmand, Miller Curber, Skyjack, Lull, Skytrak, Tsurumi, Husquvarna Target, Stow, Wacker, Sakai, Mi-T-M, Sullair, Basic, Dynapac, MBW, Weber, Bartell, Bennar Newman, Haulotte, Ditch Runner, Menegotti, Morrison, Contec, Buddy, Crown, Edco, Wyco, Bomag, Laymor, EZ Trench, Bil-Jax, F.S. Curtis, Gehl Pavers, Heli, Honda, ICS/PowerGrit, IHI, Partner, Imer, Clipper, MMD, Koshin, Rice, CH&E, General Equipment, Amida, Coleman, NAC, Gradall, Square Shooter, Kent, Stanley, Tamco, Toku, Hatz, Kohler, Robin, Wisconsin, Northrock, Oztec, Toker TK, Rol-Air, APT, Wylie, Ingersoll Rand / Doosan, Innovatech, Con X, Ammann, Mecalac, Makinex, Smith Surface Prep, Small Line, Wanco, Yanmar