



Date: 04/29/16
To: DA7000SSA2 Owners
From: Multiquip Product Department
Subject: **IMPORTANT SAFETY INFORMATION**



Dear Multiquip Customer,

Our records indicate you have purchased one or more Multiquip model DA7000SSA2/SSA2GH generators. This generator is also used as the power source for MLTDA72/72GH mobile light towers.

When servicing this generator, note the operating relationship between the Full Power Switch and the 120/240V 30 amp receptacle:

While the Full Power switch is in the 240/120V position, setting the auxiliary circuit breaker protecting the 120/240V 30 amp receptacle to the OFF position does not remove all voltage to this receptacle.

With this auxiliary breaker in the OFF position, 120 Volts is present at the receptacle, posing a risk to equipment along with a potential shock hazard causing serious personal injury.

The accompanying bulletin explains the actions required to correct this problem.

Failure to perform this procedure may result in:

RISK OF INJURY OR DEATH, WHEN SERVICING ELECTRICAL COMPONENTS WHILE THE GENERATOR IS IN OPERATION.

If this generator has been resold, please forward this bulletin to the new owner.

Your prompt attention to this matter is appreciated. If you have questions, please contact Discount-equipment.

Go to Discount-Equipment.com to order your parts

PARTS FINDER

**Search Website
by Part Number**



**Search Manual
Library For Parts
Manual & Lookup Part
Numbers – Purchase
or Request Quote**

Search Manuals

Enter your information to help us find the right manual for your machine.

* Brand:

* Model:

* Serial:

* Part Number:

SEARCH

**Can't Find Part or
Manual? Request Help
by Manufacturer,
Model & Description**

Parts Order Form

Please fill in the following information to help us find the right part for your machine.

MANUFACTURER:

MODEL:

DESCRIPTION:

DATE:

TIME:

PHONE:

EMAIL:

ADDRESS:

CITY:

STATE:

ZIP:

COUNTRY:

SEARCH

Discount-Equipment.com is your online resource for quality parts & equipment.

Florida: **561-964-4949** Outside Florida TOLL FREE: **877-690-3101**

Need parts?

Click on this link: <http://www.discount-equipment.com/category/5443-parts/> and choose one of the options to help get the right parts and equipment you are looking for. Please have the machine model and serial number available in order to help us get you the correct parts. If you don't find the part on the website or on one of the online manuals, please fill out the request form and one of our experienced staff members will get back to you with a quote for the right part that your machine needs.

We sell worldwide for the brands: Genie, Terex, JLG, MultiQuip, Mikasa, Essick, Whiteman, Mayco, Toro Stone, Diamond Products, Generac Magnum, Airman, Haulotte, Barreto, Power Blanket, Nifty Lift, Atlas Copco, Chicago Pneumatic, Allmand, Miller Curber, Skyjack, Lull, Skytrak, Tsurumi, Husquvarna Target, Stow, Wacker, Sakai, Mi-T-M, Sullair, Basic, Dynapac, MBW, Weber, Bartell, Bennar Newman, Haulotte, Ditch Runner, Menegotti, Morrison, Contec, Buddy, Crown, Edco, Wyco, Bomag, Laymor, EZ Trench, Bil-Jax, F.S. Curtis, Gehl Pavers, Heli, Honda, ICS/PowerGrit, IHI, Partner, Imer, Clipper, MMD, Koshin, Rice, CH&E, General Equipment, Amida, Coleman, NAC, Gradall, Square Shooter, Kent, Stanley, Tamco, Toku, Hatz, Kohler, Robin, Wisconsin, Northrock, Oztec, Toker TK, Rol-Air, APT, Wylie, Ingersoll Rand / Doosan, Innovatech, Con X, Ammann, Mecalac, Makinex, Smith Surface Prep, Small Line, Wanco, Yanmar

PARTS NEEDED

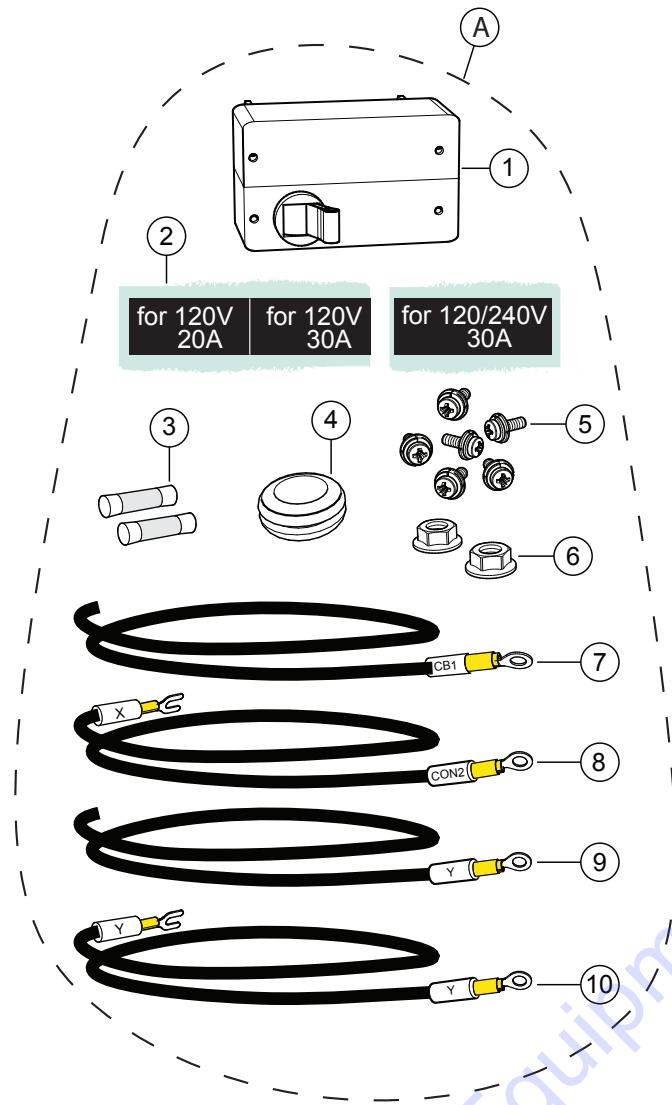

Figure 1. Circuit Breaker Modification Kit

Table 1. Circuit Breaker Modification Kit

Item No.	Part No.	Description	Qty.	Rmks
A	CB1MODIFICATIONKIT	Kit, Circuit Breaker Modification	1	Includes items 1-10
1	Y0601806425	Circuit Breaker	1	
2	A92100350	Decal	1	
3		Butt Splice Connectors	2	
4	Y0601850260	Grommet, Rubber	1	
5	Y0027103006	Screw, M3 x 6 mm	6	
6	Y0038403000	Hex Head Nut, M3	2	
7		Wire A 27.5 in. (700 mm) round terminal on one end, bare on other end	1	
8		Wire B 27 in. (690 mm) round terminal on one end, Y terminal on other end	1	
9		Wire C 25.5 in. (650 mm) round terminal on one end, bare on other end	1	
10		Wire D 25 in. (640 mm) round terminal on one end, Y terminal on other end	1	

TOOLS NEEDED

- Wire Crimper/Cutter
- Drill Set
- Center Punch
- Tie Wraps
- Screwdriver
- Hole Drilling Template (see attached sheet)

WORK SAFELY!

Only a qualified service technician with proper training should perform this installation. Follow all shop safety rules when performing this installation.

PREPARATION

1. Make sure generator is turned off and engine is cool.
2. Place the generator in an area free of dirt and debris. Make sure it is on secure level ground.
3. Open the left and right side doors of the generator to gain access to the circuit breaker.
4. Disconnect the battery cables (negative terminal first) and remove the battery.
5. Inside the generator access door, on the opposite side of the battery, behind the control panel where the new circuit breaker will be installed, push aside the wires and secure with a tie wrap to allow room for installation (Figure 2).

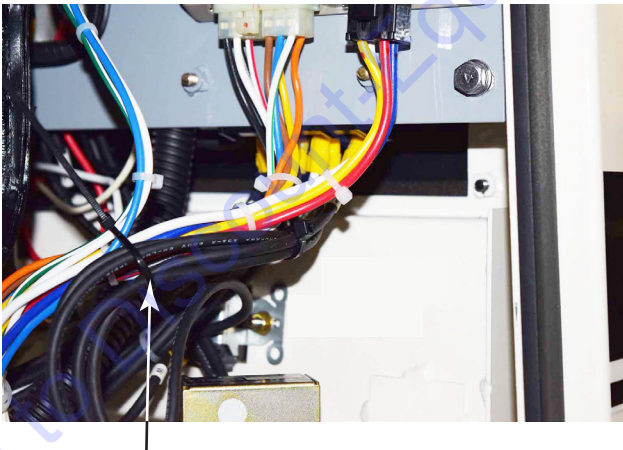

PUSH WIRES BACK AND
SECURE WITH TIE WRAP

Figure 2. Securing Wires

PROCEDURE

Drilling the Holes

1. Cut the template accompanying this document.
2. On the front of the generator below the control panel, measure and mark 1 inch from the left and 1.5 inches from the bottom. Tape the template at this position (Figure 3).

ATTACH TEMPLATE HERE

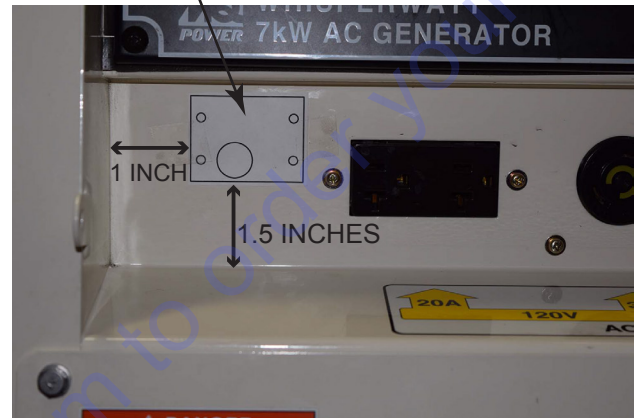

Figure 3. Template Attachment

3. Use a center punch to mark where the holes are to be drilled.
4. Using a 9/64" bit, drill the 4 small holes as marked.
5. Using a 3/4" bit, drill the big hole (drill small pilot hole prior to drilling 3/4" hole).
6. Deburr the holes and wipe off the filings.
7. Remove the template when all holes are drilled.

Disconnecting Existing Circuit Breaker CB1

Refer to Figure 5 for location of connections and Figure 11 for wiring diagram.

1. Locate the wire marked CB1 connected to the circuit breaker CB1 on the generator (Figure 5 ①). Cut the wire as close to the circuit breaker as possible. Strip the wire about 1/4 inch and install a butt splice on the end of the wire.
2. Unscrew the 120/240V Output Receptacle from the front panel and pull out from the rear for better access to connector CON2 (Figure 4).

REMOVE 2 SCREWS TO RELEASE
120/240V OUTPUT RECEPTACLE



Figure 4. Detaching 120/240V Output Receptacle

3. Locate the wire marked CON2 connecting the circuit breaker CB1 to connector CON2 X (Figure 5 ②). Remove and discard this wire and circuit breaker CB1.
4. Locate the wire marked Y connected to connector CON2 Y (Figure 5 ③). Cut the wire as close to the Y connector as possible. Strip wire about 1/4 inch and install a butt splice on the end of this wire. Remove and discard Y connector.

Connecting New CB1 (P/N Y0601806425)

Refer to Figure 5 for location of connections and Figure 11 for wiring diagram.

5. Connect the round terminals of the 4 wires in the kit to the new CB1 (P/N Y0601806425) as follows:

Table 2. Wire Connections to New CB1				
Wire	Terminal Type	Wire Label	CB1 Connection	Figure 5 Reference
A	Round	CB1	Line Side - Bottom	④
B	Round	CON2	Load Side - Bottom	⑤
C	Round	Y	Line Side - Top	⑥
D	Round	Y	Load Side - Top	⑦

6. Connect the other ends of the 4 wires as follows:

Table 3. Wire Connections to CON1 and CON2				
Wire	Terminal Type	Wire Label	Connection	Figure 5 Reference
A	Bare	N/A	Strip and splice w/ wire marked CB1 (CON1 X)	⑧
B	Y	X	CON2 X	⑨
C	Bare	N/A	Strip and splice w/ wire marked CON2 (CON1 Y)	⑩
D	Y	Y	CON2 Y	⑪

NOTE:
 ⚠️ EXISTING WIRE AND CIRCUIT BREAKER TO BE REMOVED/DISCARDED.

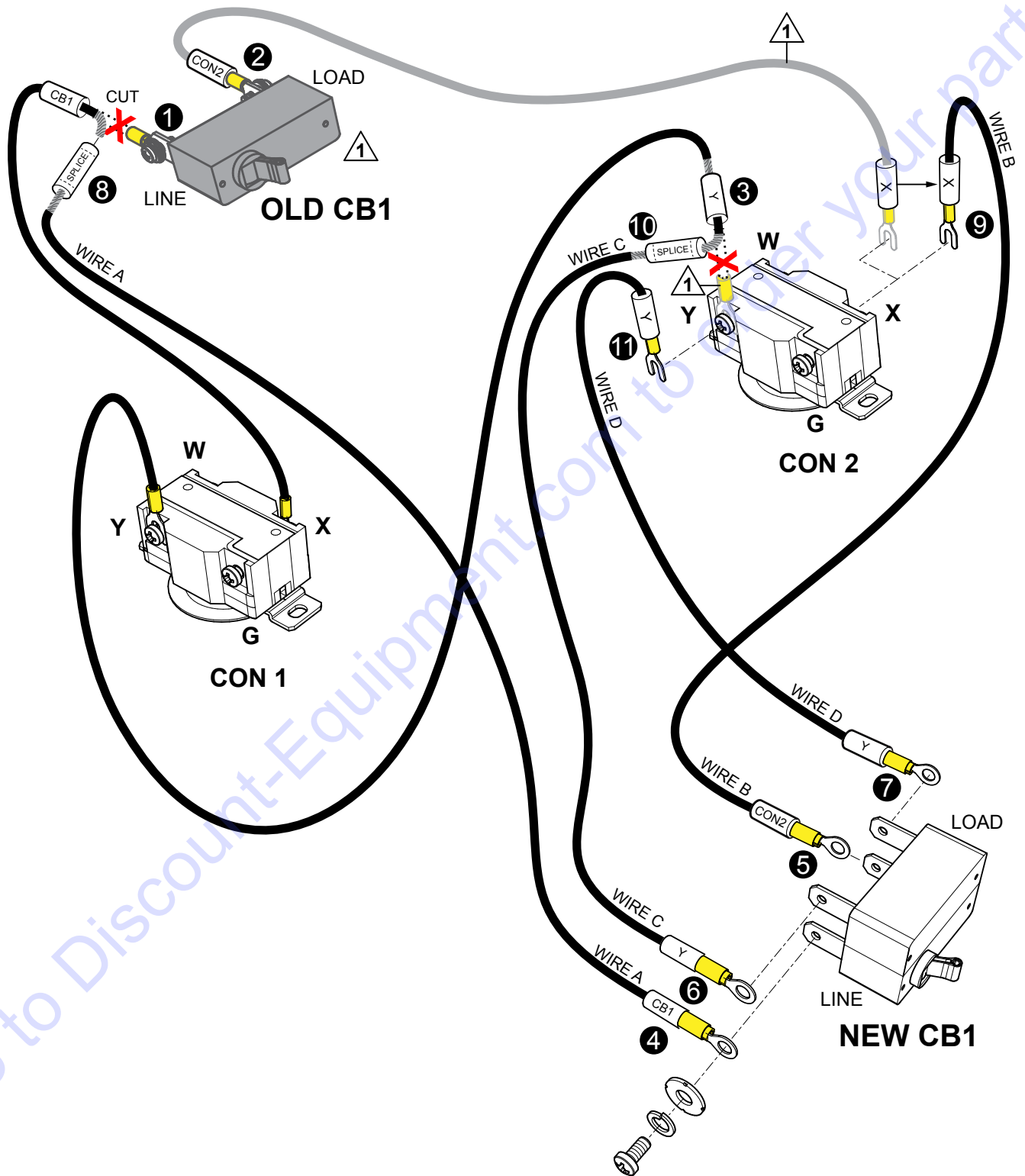

Figure 5. Disconnecting OLD CB1 and Connecting NEW CB1

Installing Wired CB1

7. Orient the wired CB1 and carefully position behind the control panel where the holes were drilled (Figure 6). Push in switch through the large hole.

CB1 ORIENTATION

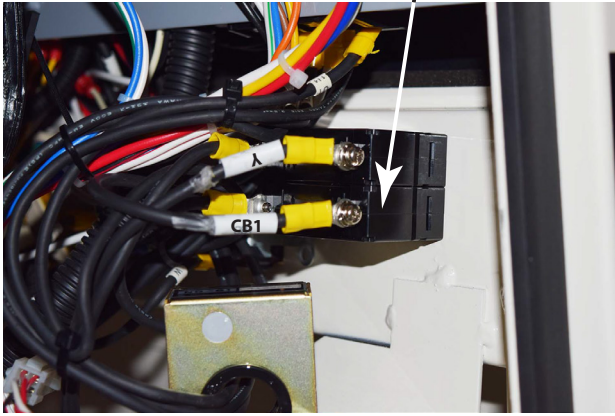

Figure 6. CB1 Installation

8. Secure CB1 with four M3 screws (P/N Y0027103006) on the front of the generator (Figure 7).

SECURE CB1 WITH
4 M3 SCREWS (P/NY0027103006)

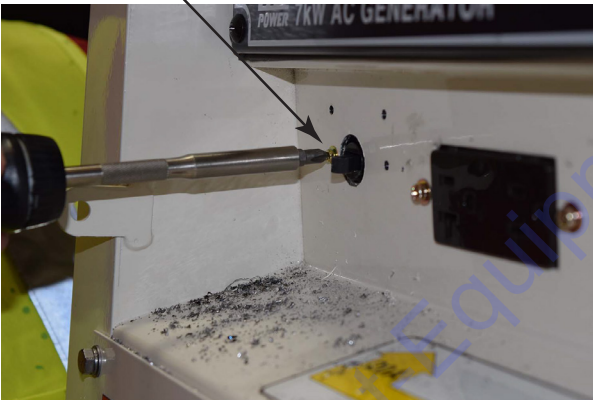

Figure 7. Securing CB1

Installing New Decals, Grommet, and Screws

1. Remove old decal strip from the front panel (see Figure 8).

REMOVE DECAL

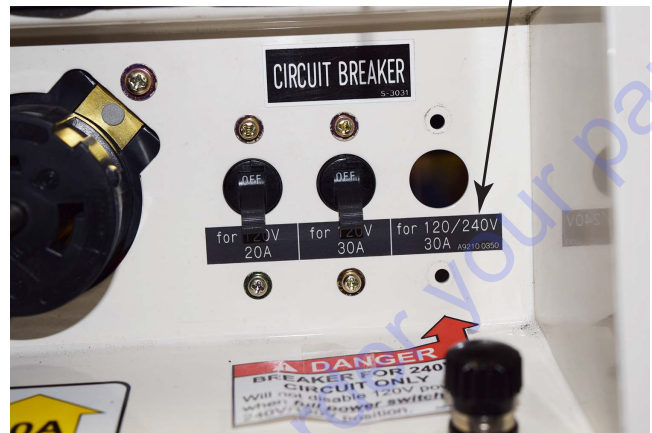

Figure 8. Removing Old Decal

2. Attach the 2 sections of the new decal (P/N A92100350) to the 2 locations shown in Figure 9.



ATTACH NEW DECALS

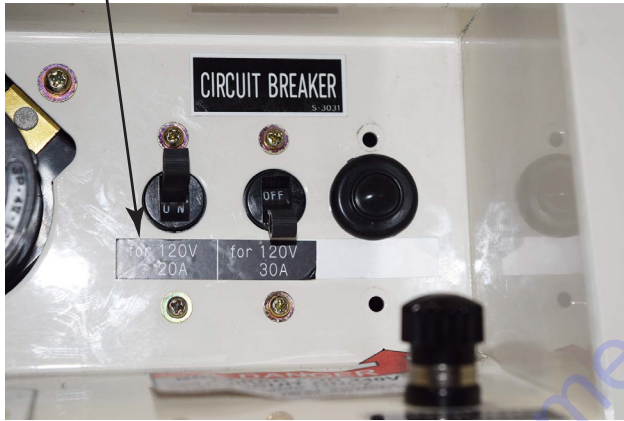

Figure 9. Installation of New Decals

3. Install grommet (P/N Y0601850260) to the hole where the old CB1 was removed (Figure 10).

INSTALL GROMMET AND SCREWS



Figure 10. Grommet and Screws Installation

4. Install 2 M3 screws (P/N Y0027103006) to the smaller holes and secure with 2 M3 Hex nuts (P/N Y0038403000) at the rear of the holes (Figure 10).

Completing Installation

1. Reinstall connector CON 2 and the 120/240V Output Receptacle.
2. Tie wrap cables as necessary for neatness.
3. Reinstall and reconnect battery.
4. Close the side doors of the generator.

TEMPLATE

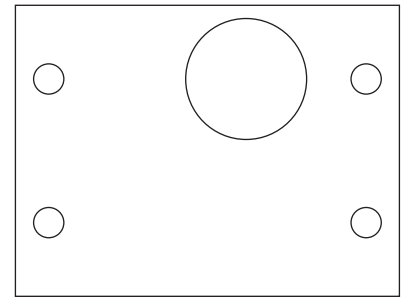
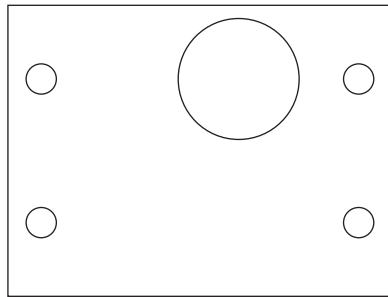
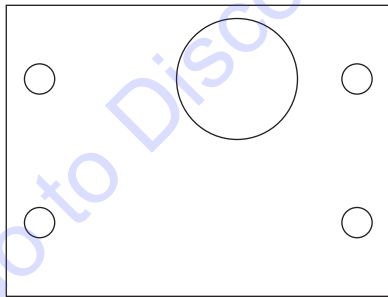
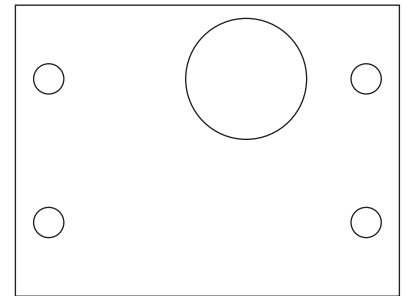
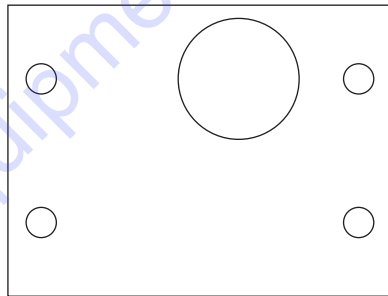
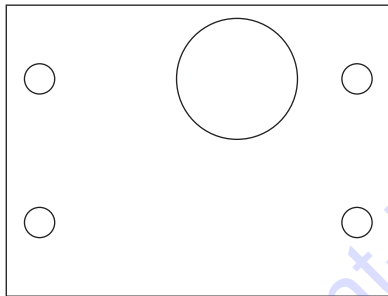
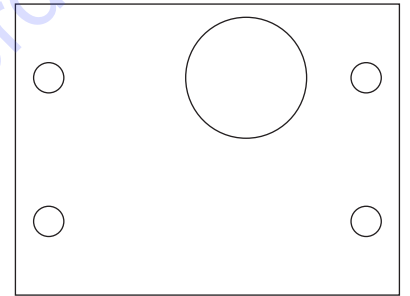
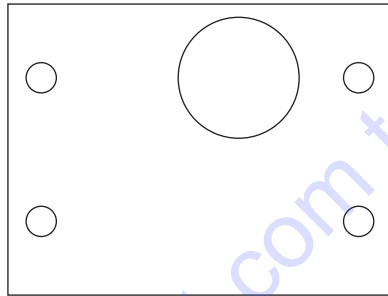
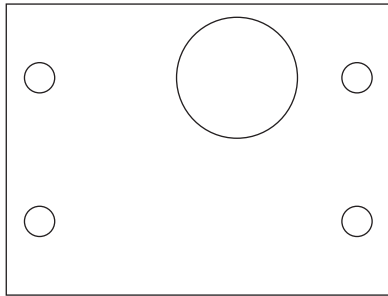
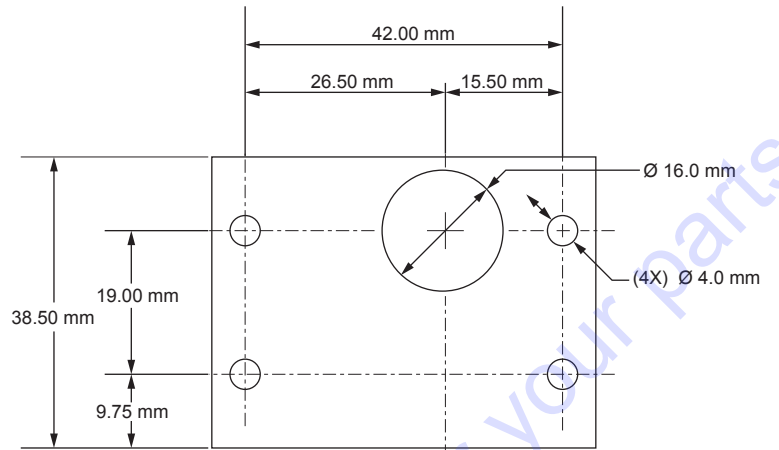
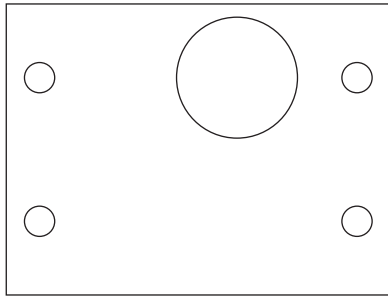

PARTS FINDER

**Search Website
by Part Number**



**Search Manual
Library For Parts
Manual & Lookup Part
Numbers – Purchase
or Request Quote**

Search Manuals

Enter your information to help us find the right parts manual for your machine.

* Brand:

* Model:

* Serial:

* Part Number:

SEARCH

**Can't Find Part or
Manual? Request Help
by Manufacturer,
Model & Description**

Parts Order Form

Please fill in the following information to help us find the right part for your machine.

Manufacturer:	<input type="text"/>
Model:	<input type="text"/>
Description:	<input type="text"/>
Part Number:	<input type="text"/>
Quantity:	<input type="text"/>
Notes:	<input type="text"/>

Submit

Discount-Equipment.com is your online resource for quality parts & equipment.

Florida: **561-964-4949** Outside Florida TOLL FREE: **877-690-3101**

Need parts?

Click on this link: <http://www.discount-equipment.com/category/5443-parts/> and choose one of the options to help get the right parts and equipment you are looking for. Please have the machine model and serial number available in order to help us get you the correct parts. If you don't find the part on the website or on one of the online manuals, please fill out the request form and one of our experienced staff members will get back to you with a quote for the right part that your machine needs.

We sell worldwide for the brands: Genie, Terex, JLG, MultiQuip, Mikasa, Essick, Whiteman, Mayco, Toro Stone, Diamond Products, Generac Magnum, Airman, Haulotte, Barreto, Power Blanket, Nifty Lift, Atlas Copco, Chicago Pneumatic, Allmand, Miller Curber, Skyjack, Lull, Skytrak, Tsurumi, Husquvarna Target, Stow, Wacker, Sakai, Mi-T-M, Sullair, Basic, Dynapac, MBW, Weber, Bartell, Bennar Newman, Haulotte, Ditch Runner, Menegotti, Morrison, Contec, Buddy, Crown, Edco, Wyco, Bomag, Laymor, EZ Trench, Bil-Jax, F.S. Curtis, Gehl Pavers, Heli, Honda, ICS/PowerGrit, IHI, Partner, Imer, Clipper, MMD, Koshin, Rice, CH&E, General Equipment, Amida, Coleman, NAC, Gradall, Square Shooter, Kent, Stanley, Tamco, Toku, Hatz, Kohler, Robin, Wisconsin, Northrock, Oztec, Toker TK, Rol-Air, APT, Wylie, Ingersoll Rand / Doosan, Innovatech, Con X, Ammann, Mecalac, Makinex, Smith Surface Prep, Small Line, Wanco, Yanmar