

IPL, TS 250X, 2006-28, 524 20 11-00

TS 250X

TS 250X SS

Spare parts

Pieces de rechange

Piezas de repuesto



542 20 11-00

PARTS FINDER

**Search Website
by Part Number**



**Search Manual
Library For Parts
Manual & Lookup Part
Numbers – Purchase
or Request Quote**

Search Manuals

Enter your information to help us find the right parts manual for your machine.

* Brand:

* Model:

* Serial:

* Part Number:

SEARCH

**Can't Find Part or
Manual? Request Help
by Manufacturer,
Model & Description**

Parts Order Form

Please fill in the following information to help us find the right part for your machine.

Manufacturer:	<input type="text"/>
Model:	<input type="text"/>
Description:	<input type="text"/>
Part Number:	<input type="text"/>
Quantity:	<input type="text"/>
Notes:	<input type="text"/>

Submit

Discount-Equipment.com is your online resource for quality parts & equipment.

Florida: **561-964-4949** Outside Florida TOLL FREE: **877-690-3101**

Need parts?

Click on this link: <http://www.discount-equipment.com/category/5443-parts/> and choose one of the options to help get the right parts and equipment you are looking for. Please have the machine model and serial number available in order to help us get you the correct parts. If you don't find the part on the website or on one of the online manuals, please fill out the request form and one of our experienced staff members will get back to you with a quote for the right part that your machine needs.

We sell worldwide for the brands: Genie, Terex, JLG, MultiQuip, Mikasa, Essick, Whiteman, Mayco, Toro Stone, Diamond Products, Generac Magnum, Airman, Haulotte, Barreto, Power Blanket, Nifty Lift, Atlas Copco, Chicago Pneumatic, Allmand, Miller Curber, Skyjack, Lull, Skytrak, Tsurumi, Husquvarna Target, Stow, Wacker, Sakai, Mi-T-M, Sullair, Basic, Dynapac, MBW, Weber, Bartell, Bennar Newman, Haulotte, Ditch Runner, Menegotti, Morrison, Contec, Buddy, Crown, Edco, Wyco, Bomag, Laymor, EZ Trench, Bil-Jax, F.S. Curtis, Gehl Pavers, Heli, Honda, ICS/PowerGrit, IHI, Partner, Imer, Clipper, MMD, Koshin, Rice, CH&E, General Equipment, Amida, Coleman, NAC, Gradall, Square Shooter, Kent, Stanley, Tamco, Toku, Hatz, Kohler, Robin, Wisconsin, Northrock, Oztec, Toker TK, Rol-Air, APT, Wylie, Ingersoll Rand / Doosan, Innovatech, Con X, Ammann, Mecalac, Makinex, Smith Surface Prep, Small Line, Wanco, Yanmar

TS 250X

PART NO.	POS.	DESCRIPTION	PART NO.	POS.	DESCRIPTION
501 96 53-01	A,A1,A2	Blade Guard 10" - PC H. Orange	542 16 78-70*	D	Screw, SH Shoulder, 1/2"OD x .50, 3/8"-16
504 04 02-01	A,A1,A2	Decal: Husq Crown H, 25mm	542 16 93-65*	A,A1,A2	Guard, Splash
539 30 00-74	I	Set Collar, 1/2" ID	542 16 93-66*	A,A1,A2	Screw, Self-Tap Pan Hd, #8 x 3/8 "B" ZP
539 30 01-23	C	Set Collar, 1" I.D.	542 16 94-86*	A,A1,A2	Knob, 5/16"-18 x 1 4-Prong
539 99 02-09	D	Screw, Hex Hd 5/16"-18 x 1"	542 16 95-22*	A,A1,A2	Flange, Inner
539 99 05-80	B	Screw, Hex Hd 1/4"-20 x 3/4"	542 16 95-23*	A,A1,A2	Flange, Outer
539 99 06-55	C	Bolt, 3/8"-16 x 1-1/2 ZP	542 16 95-41	A2	Motor: 1HP 1425RPM 240/50/1
541 20 05-60	A2	V-Belt, 3VX300	542 16 95-63*	E	Water Tube Assy: 1/4"Y x 32"
541 20 06-49	I	Set Collar, 5/8" ID	542 16 95-64*	E	Water Tube Assy: 1/4"Y x 72"
541 20 15-69	A1	V-Belt, 3VX280	542 16 95-65*	E	Tube, Clear Vinyl 1/4" ID x 6"
541 20 46-69	A,A1,A2	Washer, Spring Wave .531 ID ZP	542 17 10-65*	G	Cutting Accessories Package
541 20 48-00	E	Fitting, 1/4"NPT x 1/4" Hose	542 17 21-01*	A	Pulley 6GJ2.80 - .626 w/SS
542 00 06-05	A1	Mtr: 1.5HP 3450 115/208-230/60/1	542 17 88-25*	A,A1,A2	Flange Bolt, 5/16"-18 x 1 Gr5 ZP
542 00 07-16	A1	Mtr: 2.0HP 3450 115/208-230/60/1	542 18 08-10*	A1	Switch Box Assy w/ Wiring
542 02 00-11*	G	Carriage Bolt, 1/4"-20 x .625 ZP	542 18 70-43*	A,A1,A2	Decal: Warning
542 02 00-60*	A,A1,A2	Key, .1875 Sq x 1	542 18 91-15*	B	Capscrew, Hex Hd, 1/4"-20 x 5/8", 316SS
542 02 01-27*	A,A1,A2	Carriage Bolt, 5/16"-18 x 3, GR5 ZP	542 18 91-16*	B	Locknut, Fiber 1/4"-20, 316SS
542 02 01-95*	A,A1,A2,B	Locknut, Fiber 1/4"-20 ZP	542 18 92-47*	A,A1,A2	Decal: Water Pump Outlet
542 02 01-97*	A,A1,A2,C	Locknut, Fiber 5/16"-18 ZP	542 18 96-60*	A,A1,A2	Flange Bolt, 1/4"-20 x 1/2" Gr5 ZP
542 02 02-01*	I	Locknut, Fiber 1/2"-13	542 18 96-61*	A,A1,A2	Cap, Bearing
542 02 02-45*	A,A1,A2	Locknut, Wing 5/16"-18 ZP	542 18 97-37*	F,G,H	T-Knob 1/4"-20 x 3/4"
542 02 03-18*	C	Capscrew, Hex Hd, 5/16"-18 x 2.25 GR 5 ZP			
542 02 03-39*	I	Capscrew, Hex Hd 1/2"-13 x 1"	542 19 07-36	F	Decal: HUSQVARNA, 4" Domed
542 02 03-70*	A1	Capscrew, Hex Hd, 1/4"-20 x .75 GR 5 ZP	542 19 07-41	B	Decal: Husq Target TA TS250X
542 02 04-41*	A,A1,A2	Capscrew, Hex Hd, 5/16"-18 x 1.75 GR 5 ZP	542 19 37-94*	C	Decal: Drain Plug
542 02 04-89*	C	Screw, Self-Tap Hex WH, 1/4"-20 x .75 "F"	542 19 38-30*	A,A1,A2	Flange Bolt, 1/4"-20 x 3/4" Gr5 ZP
542 02 05-40*	A1	Set Screw, Soc Hd, 1/4"-20 x 1/4" Cup	542 19 38-33*	A,A1,A2	Shaft, Blade
542 02 05-41*	A,A1	Set Screw, Soc Hd, 1/4"-20 x 3/8 Cup	542 19 38-66	B	Pan, Tile Saw, Galv
542 02 05-41*	A	Set Screw, Soc Hd, 1/4"-20 x 3/8 Cup	542 19 38-70	A,A1,A2	Adjustment Cam, ZP
542 02 05-50*	A1,A2	Screw, Socket Hd, 5/16"-18 x 3/8	542 19 39-16	D	Extension, Cart
542 02 06-43*	C	Pin, Roll 1/4" x 1.25	542 19 39-19	A,A1	Pin, Roll .156 x 1.00
542 02 07-39*	A,A1,A2	Washer, Flat #10 (3/16") ZP	542 19 39-20	A,A1	Bolt, Blade Latch, ZP
542 02 07-41*	A1	Washer, Flat 1/4" ZP	542 19 39-37	D	Cart w/ V-Top
542 02 07-42*	A,A1,A2,C,D	Washer, Flat 5/16" ZP	542 19 39-40	D	Roller, Cart Stabilizer
542 02 07-62*	B,C	Washer, Flat SAE 1/4" ZP	542 19 39-41	C	Spring, Torsion
542 02 07-63*	A,A1,A2,D	Washer, Flat SAE 5/16" ZP	542 19 39-44	C	Anchor, Spring
542 02 07-66*	A,A1	Washer, Flat SAE 1/2" ZP	542 19 39-46	C	Lock Bar, ZP
542 02 07-85*	A,A1,A2	Lockwasher, Split 5/16" (M8)	542 19 39-48	B	Rail Support
542 02 07-86*	C	Lockwasher, Split 3/8"	542 19 39-49	B	Rail, Tile Saw, Galv
542 02 14-16*	D	Capscrew, Hex Hd, 5/16"-18 x 1" GR 5 ZP	542 19 39-51	D	Cart Stop
542 03 03-86*	B	Drain Plug Assy	542 20 30-02	B	Pan, Tile Saw - TS 250X SS
542 03 08-22*	D	Wheel, Cart	542 20 30-11	A,A1	Torsion Spring, ZP
542 03 09-06*	A1	Pulley 2G3V2.25 - .875 w/ SS	542 20 30-37	D	Extension Assy, Cart (Optional)
542 03 23-66*	D	Nut, KEPS 5/16"-18 ZP	542 20 30-51	A1	Pulley 2G3V2.0 - .625 w/ SS
542 04 01-26*	I	Wheel, 6.0" OD x .625" B	542 20 30-52	B	Rail, Tile Saw SS
542 04 63-26*	A,A1,A2	Decal, 3-Wire Grounded Plug	542 20 30-56	D	Conveyor Cart Assy
542 04 63-27*	A,A1,A2	Decal, Cord Usages	542 20 30-60	A	Pulley 6GJ1.75 - .626 w/ SS
542 05 01-03*	H	Knob, Adjustment	542 20 30-62	I	Wheel, 4.0" OD x .503" B
542 05 01-05*	H	Stop, Friction	542 20 30-74	I	Axle, 1/2"OD x 14.4"
542 05 01-06*	H	Spring	542 20 30-83	F	Rip Guide Assy
542 05 01-07*	H	Bolt, Locking - B/O	542 20 31-19	D	Wheel, Eccentric, Yellow Zinc
542 05 02-16*	E	Water Pump & Valve, 230V/50-60	542 20 31-22	I	Pin, Clevis 3/8" x 2.50"
542 05 02-18*	E	Water Pump & Valve, 115V/60	542 20 31-80	A,A1	Pad, Resilient, Self Adhesive
542 05 10-10*	G	Protractor Assy, Adj 90 Deg	542 20 31-81	A,A1	Blade Shaft Stop, ZP
542 05 10-20*	G	Guide Assy, Dual 45 Deg	542 20 31-93	A	V-Belt, Poly, 280J6
542 05 10-30*	G	Bullnose Guide Assy, 45 Deg	542 20 32-18	A,A1,A2	Nut, Flange, 5/16"-18 Tensilock
542 05 10-61*	C	Pan Stop ZP	542 20 32-52	I	Stand, Tile Saw - PC H. Gray
542 05 10-64*	C	Assy, Pan Stop	542 20 32-53	I	Stand, Adj Rolling - H. Gray
542 05 10-65*	C	Tab, Plastic	542 20 53-85	A,A1,A2	Bracket, TS Belt Guard Mtg, Z/P
542 05 80-02*	A2	Pulley 1G3V1.9 - .625 w/ SS	542 20 53-87	A,A1,A2	Belt Guard - PC H. Orange
542 05 80-52*	A2	Pulley 1G3V3.67 - .625 w/ SS	542 20 53-91	C	Frame Weld, TS250X - PC H. Gray
542 07 10-81*	A,A1,A2	Bearing, .669 BB	542 20 53-92	A,A1,A2	Head Platform - PC H. Gray
542 07 11-10*	A,A1,A2	Washer, Spring	542 20 54-45	A,A1,A2	Blade Guard Assy - TS 250
542 13 95-68*	I	Grip, Handle	542 20 54-46	A,A1,A2	Platform w/Bladeshaft -compl TS 250
542 13 95-81*	I	Spring, Stand	542 20 54-47	A	Cutting Head - compl 1.5HP 115V/60
542 16 10-19*	E	Connector, "Y" 1/4"	542 20 54-48	A	Cutting Head - compl 1.5HP-HT 115V/60
542 16 10-21*	E	Nozzle, Plastic 1/4" x 1.5	542 20 54-49	A1	Cutting Head - compl 1.5HP- 115V/230/60
542 16 10-26*	E	Tube, Clear Vinyl 1/4" ID x 32"	542 20 54-50	B	Water Pan, Galv - compl TS 250X
542 16 11-34*	E	Valve, Flow Control	542 20 54-51	B	Water Pan, SS - compl TS 250X
542 16 13-16*	E	Water Pump & Valve, G300 115V/60			
542 16 14-79*	H	Support Assy, 45 Deg - Blk			
542 16 14-80*	H	Miter Guide, 45 Deg Mighty			
542 16 16-41*	F	Wrench, 15/16", ZP			
542 16 17-19*	E	Tube, Clear Vinyl 1/4" ID x 72"			
542 16 17-30*	A,A1,A2	Bearing Cap W/ Mounting Screws			
542 16 32-48*	A,A1,A2	Strip, Rubber Sponge			
542 16 70-35*	I	Pin, Cotter Hair			

NOTE: Part No's. that have an ASTERISK (*) suffix may not be active 9-digit numbers. The '542' prefix has been added to current 6-digit part numbers and '0' to 7 and 8-digit numbers.

TS 250X

PART NO.	POS.	DESCRIPTION	PART NO.	POS.	DESCRIPTION
*** Kits ***					
542 03 21-24*	E	Kit, Water Pump - G300			
542 04 00-49*	D	Kit, Cart Wheel			
542 05 20-04*	A	Kit, Blade Shaft Replacement			
542 16 10-49*	E	Kit, Water Pump - G100 / G150			
542 20 40-33	I	Kit, Wheel - Optional			
-- ITEMS NOT SHOWN --					
542 20 10-99	NS	OM Op Instr: TS 250X			
542 20 11-00	NS	IPL Parts List: TS 250X			
PARTS		For	542 20 30-79 Motor (S.V.)		
			1.5HP 1725 RPM 115V/60/1		
542 20 30-93	NS	Switch, On-Off			
542 20 30-95	NS	Overload, Manual Reset Thermal			
542 20 30-94	NS	Capacitor, 50 Mfd / 240V (Run)			
542 20 30-96	NS	Capacitor, 189-227 Mfd / 125V (Start)			
PARTS		For	542 19 30-42 Motor (SF 1.15)		
			1.5HP 1725 RPM 115V/60/1		
542 19 38-85	NS	Switch, On-Off DPST			
542 03 01-41*	NS	Switch, Dual Voltage Toggle			
542 00 08-73*	NS	Overload, Manual Reset Thermal			
542 16 94-94*	NS	Capacitor, 40 Mfd / 370V (Run)			
542 16 94-93*	NS	Capacitor, 270-324 Mfd / 125V (Start)			
PARTS		For	542 00 06-05 Motor (D.V.)		
			1.5HP 3450 RPM 115V-230/60/1		
542 16 15-81*	NS	Switch, On-Off DPST			
542 03 01-41*	NS	Switch, Dual Voltage Toggle			
542 00 08-73*	NS	Overload, Manual Reset Thermal			
None	NS	Capacitor, (Run)			
542 18 91-17*	NS	Capacitor, 485 Mfd / 110V (Start)			
PARTS		For	542 16 95-41 Motor (S.V.)		
			1.0HP 1425 RPM 220V/50/1		
542 20 30-93	NS	Switch, On-Off			
542 16 97-50*	NS	Overload, Manual Reset Thermal			
None	NS	Capacitor, (Run)			
542 11 00-58*	NS	Capacitor, 400-480 Mfd / 165V (Start)			
See 542 20 10-99 Operator's Manual for Wiring Diagrams					

NOTE: Part No's. that have an ASTERISK (*) suffix may not be active 9-digit numbers. The '542' prefix has been added to current 6-digit part numbers and '0' to 7 and 8-digit numbers.

Reference Diagram

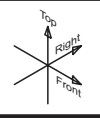

A,A1,A2

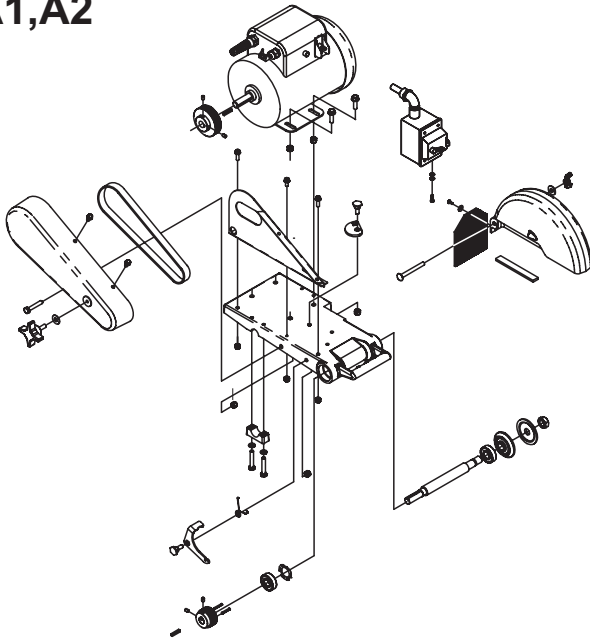

B

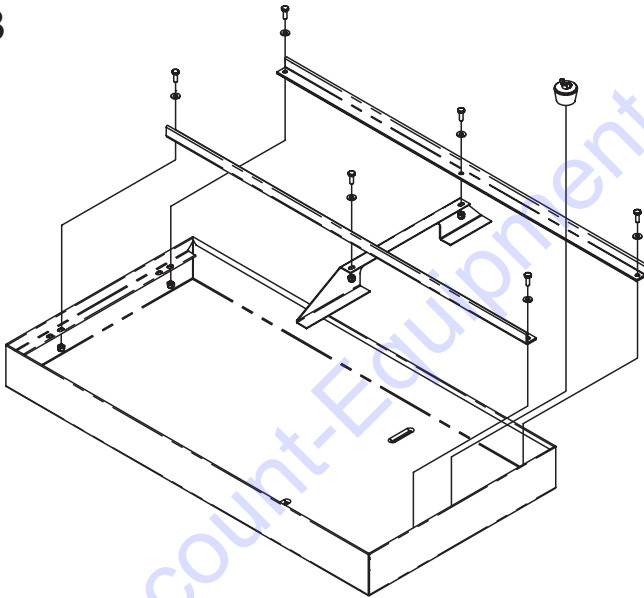

C

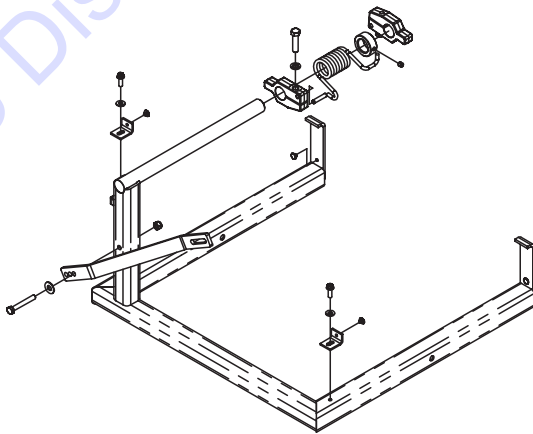

D

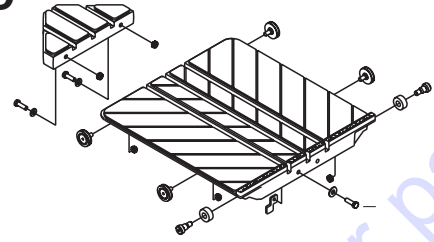

E

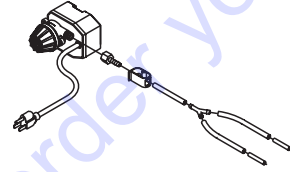

F

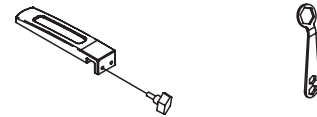

G

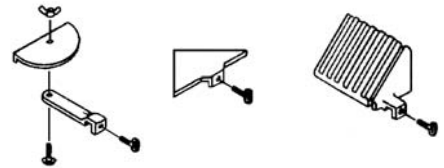

H

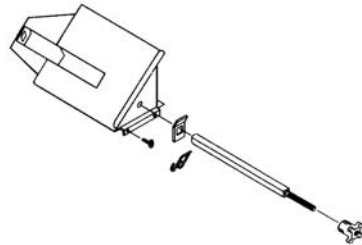

I

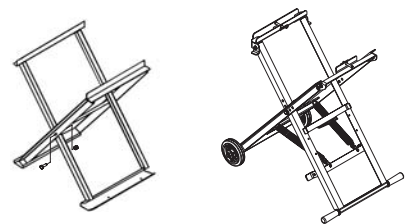

A Cutting Head Assy

- * Compl 542 20 54-47 1.5HP (115V/60/1)
- ** Compl 542 20 54-48 1.5HP-HT (115V/60/1)

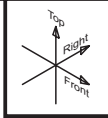

12.06.06

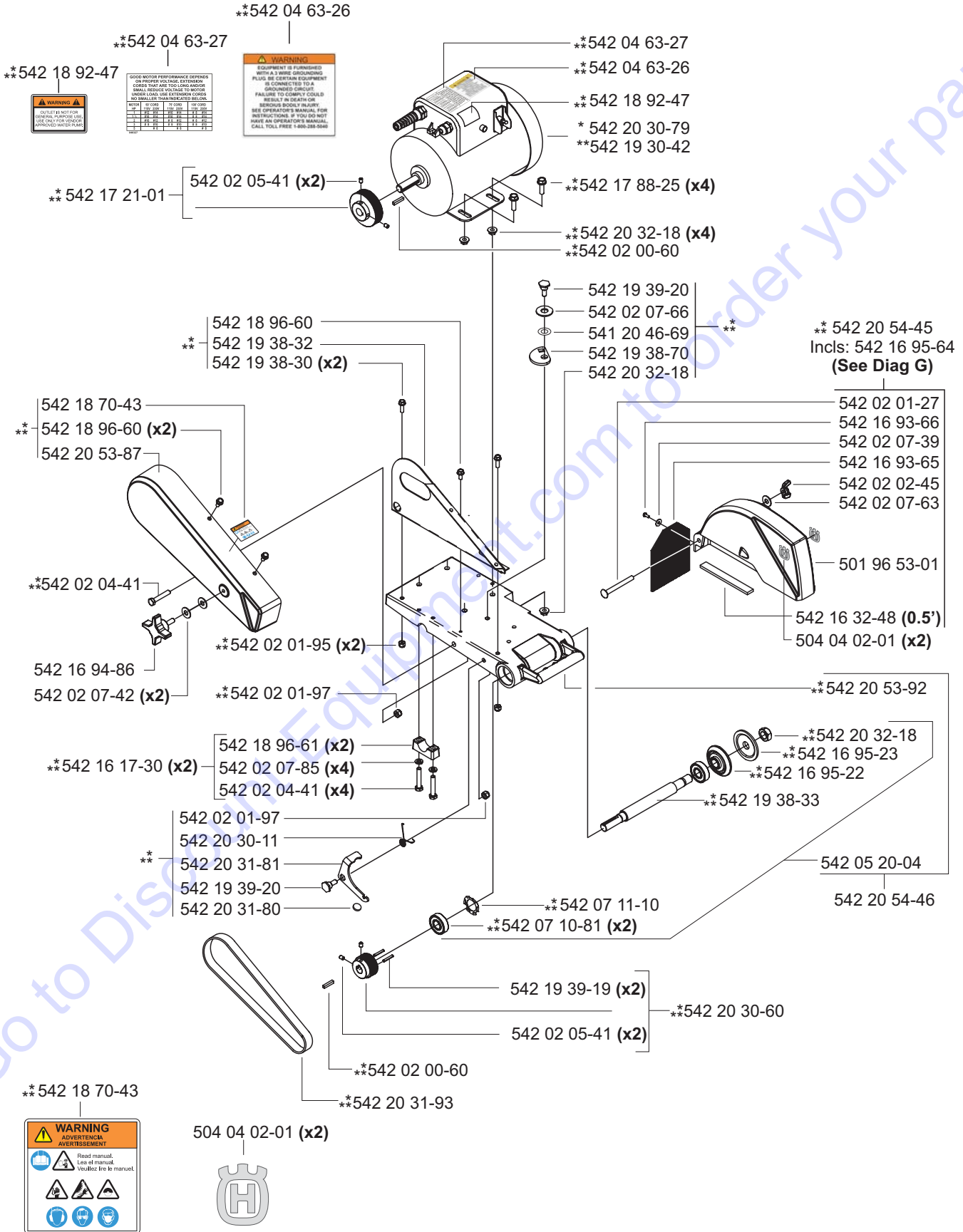

A1 Cutting Head Assy - 1.5HP Dual Voltage

* Compl 542 20 54-49 1.5HP-DV (115V/208-230/60/1)

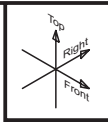

12.06.06

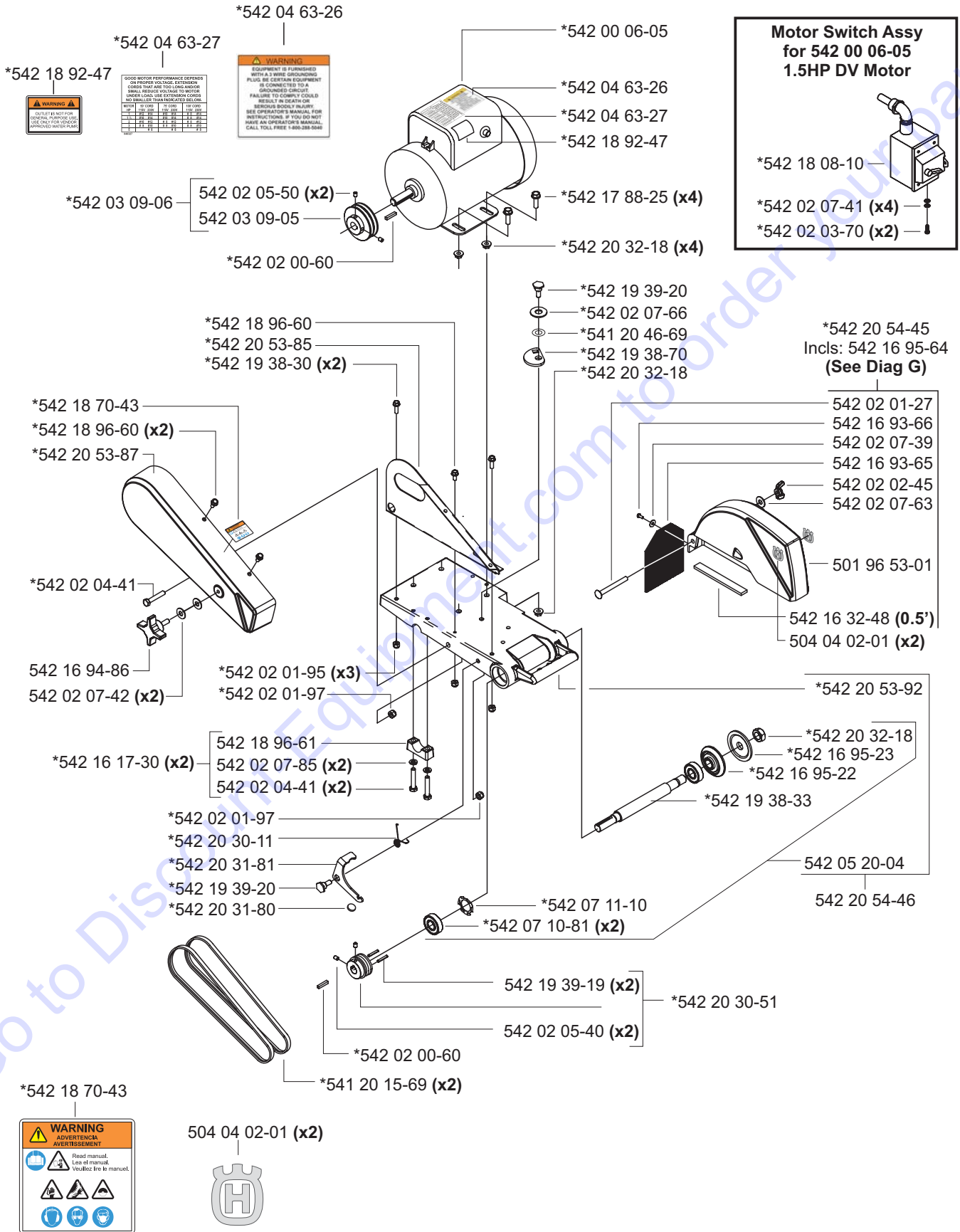

A2 Cutting Head Assy - 1HP (240V/50/1)

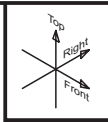

12.06.06

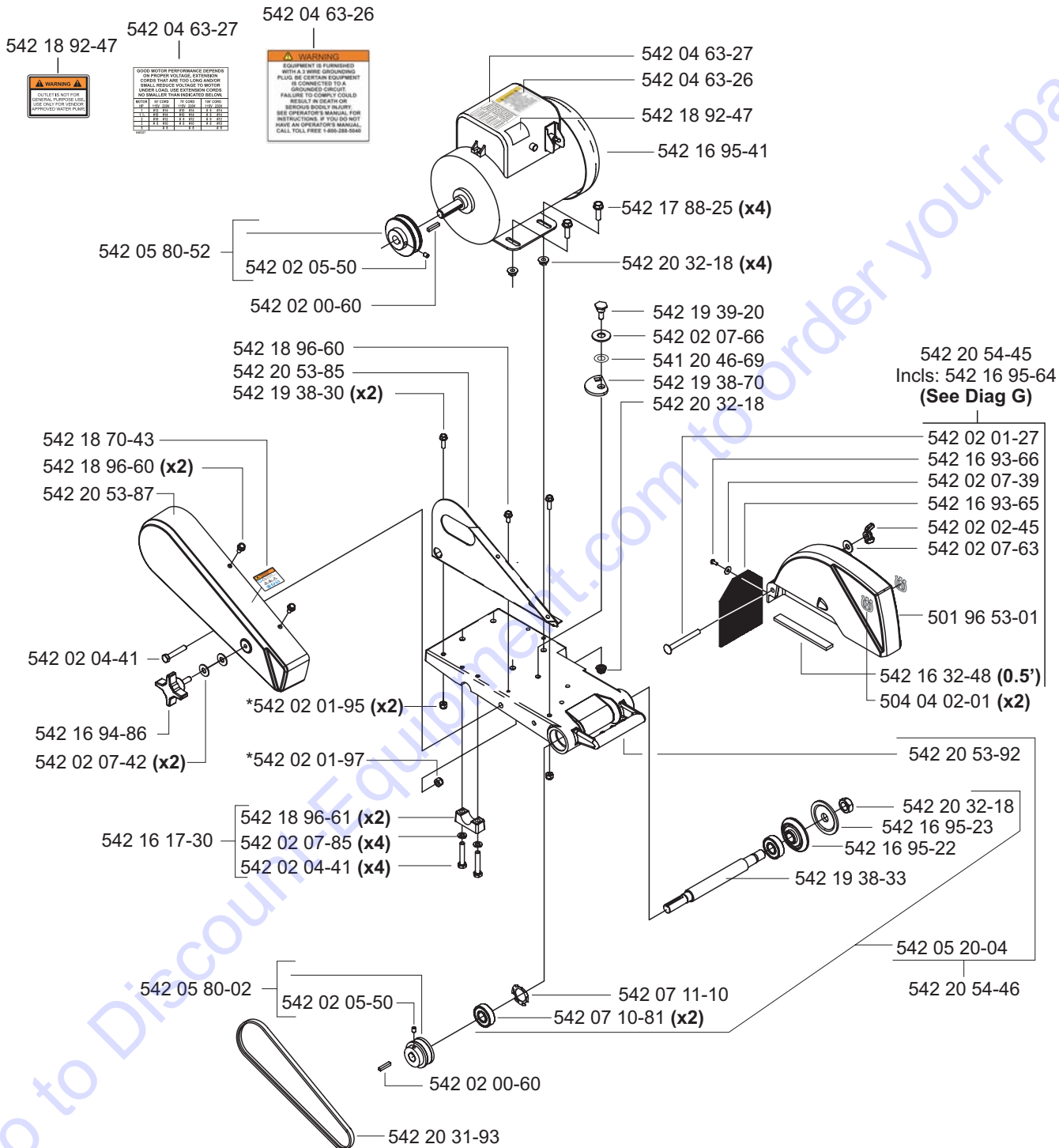

GOOD MOTOR PERFORMANCE DEPENDS ON PROPER TOOL AND EXTENSION CORDS THAT ARE TOO LONG AND/OR SMALL GAUGE WILL CAUSE TO MOTOR UNDER LOAD. USE EXTENSION CORDS AND SMALLER THAN MANUFACTURER'S RECOMMENDATION.

WIRE SIZE	100 FT.	150 FT.	200 FT.
14	10	15	20
12	15	20	25
10	20	25	30
8	25	30	35
6	30	35	40
4	35	40	45
3	40	45	50
2	45	50	55
1	50	55	60



B Water Pan Assy

*Compl 542 20 54-50

**Compl 542 20 54-51(SS)

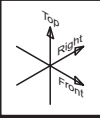

11.21.06

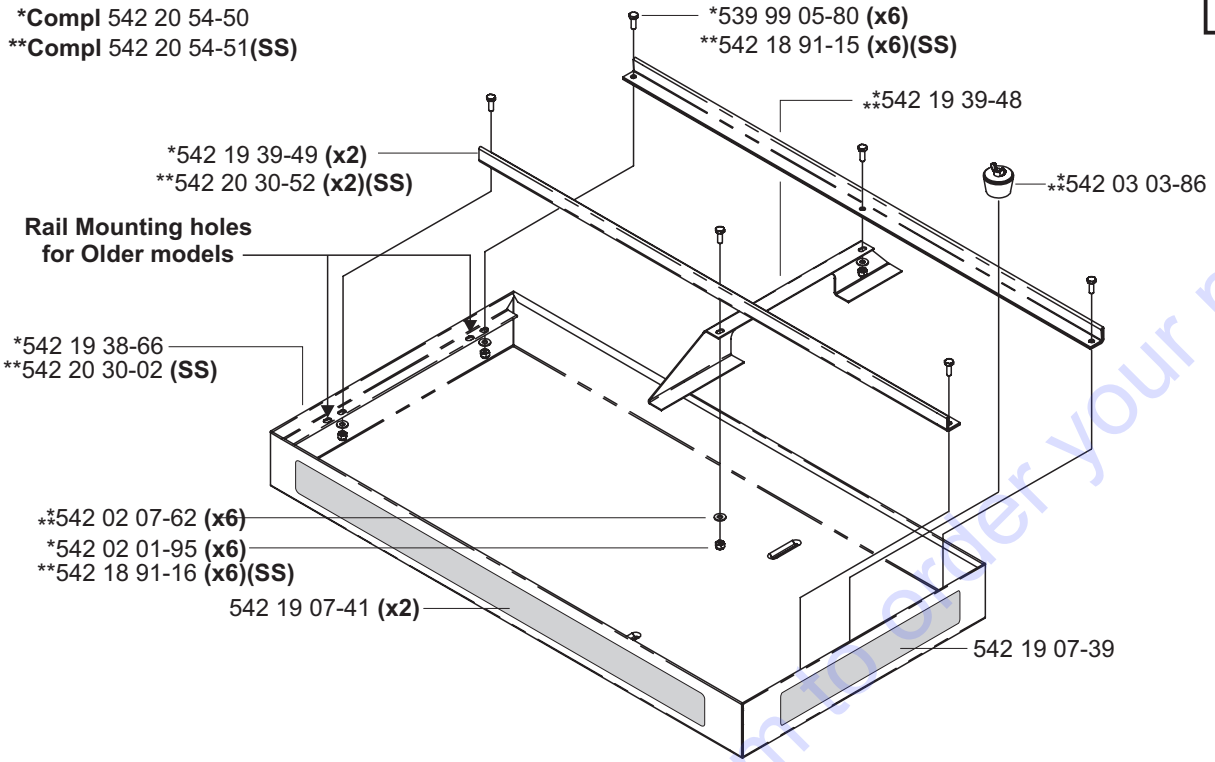

— 542 19 07-39



TARGET **TILEMATIC TS250X**

— 542 19 07-41

C Frame Assy - H. Gray

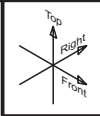

08.02.06

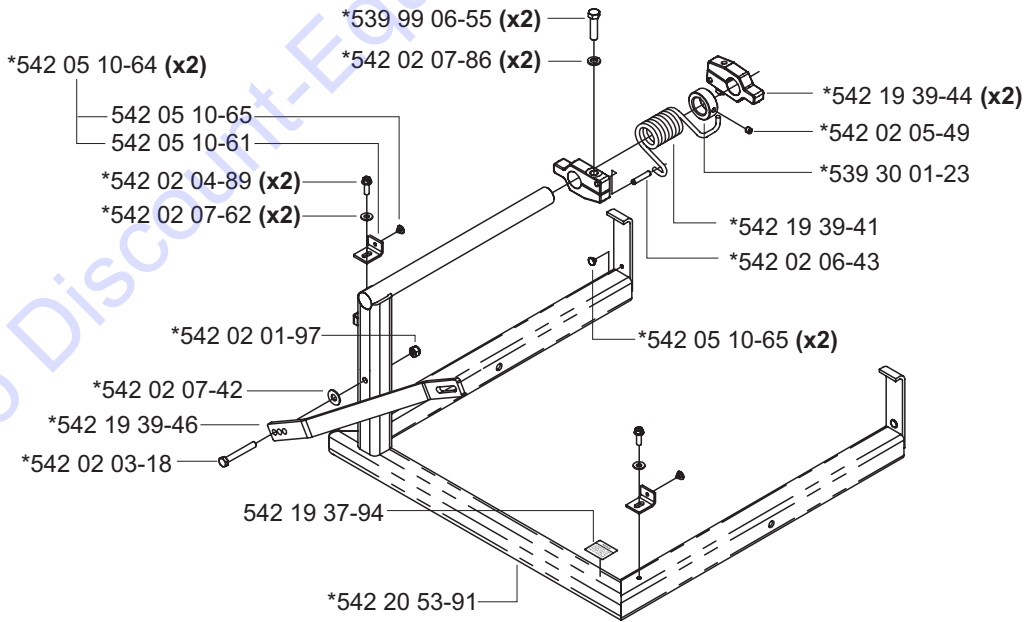

NOTICE

LOCATION FOR DRAIN HOLE OF WATER PAN TO BE AT THIS END
EN 10276

— 542 19 37-94

D Conveyor Cart Assy and Extension

*Compl 542 20 30-56

**Compl 542 20 30-37 (Optional Extension)

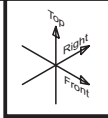

12.06.06

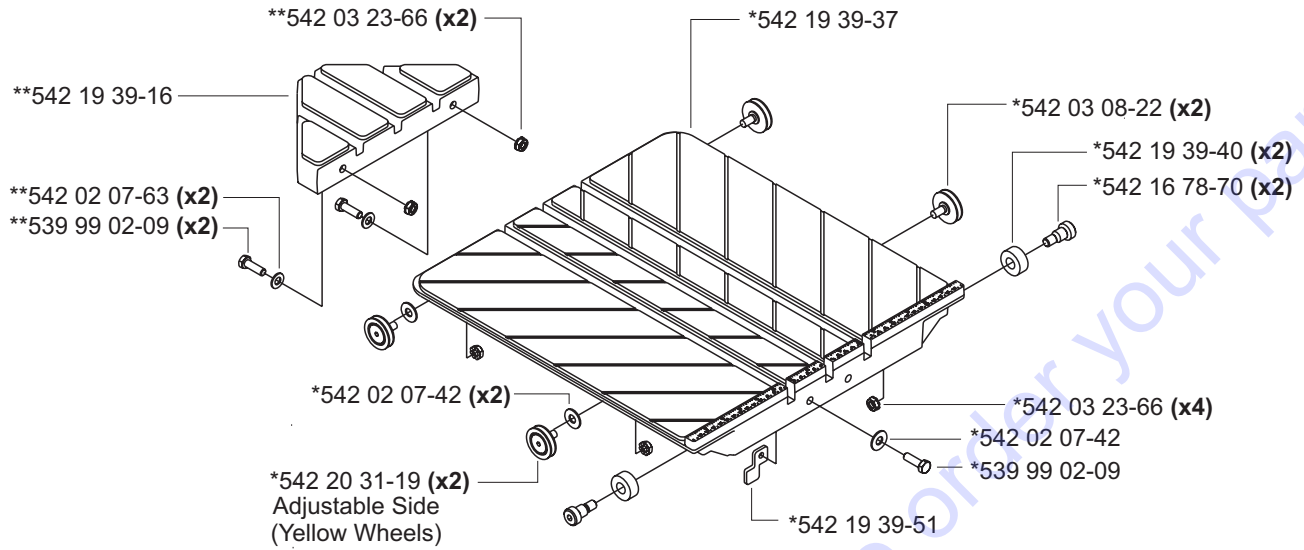

542 03 00-49 Wheel Kit

E Water Pump & Tube Assy

*Compl 542 05 02-18 (Standard 115V 60Hz)

*Compl 542 16 13-16 (Heavy Duty 115V 60Hz)

*Compl 542 05 02-16 (Heavy Duty 230V 50Hz)

**Compl 542 16 95-63 (32" Tube Assy)

***Compl 542 16 95-64 (72" Tube Assy)

Repair Kits:

542 16 10-49 (G100 Pump - 542 05 02-18)

542 16 10-49 (G100 Pump - 542 16 13-16)
 542 05 02-16)

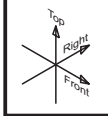

01.13.06

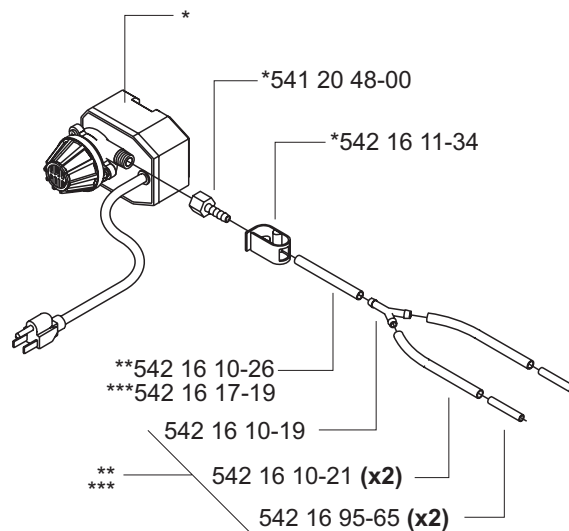

F Tile Saw Accessories and Tools (Standard)

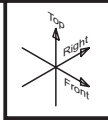

09.13.06

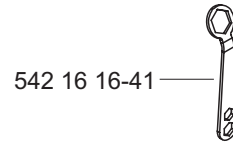
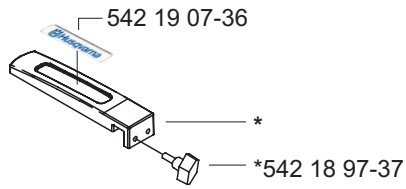

542 19 07-36

*542 20 30-83
Rip Guide Assy

542 16 16-41
Wrench: 15/16 x 9/16 x 1/2



G Tile Saw Accessory Group (Optional)

*Compl 542 17 10-65

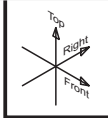

01.28.05

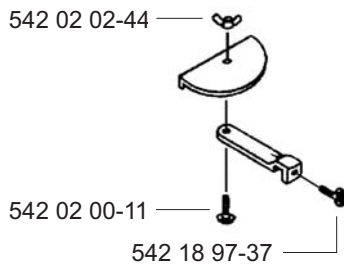

*542 05 10-10
90° Protractor

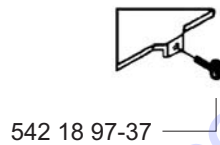

*542 05 10-20
Dual 45° Angle Guide

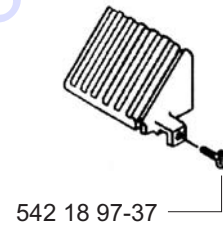

*542 05 10-30
45° Bull Nose Miter

H Tile Saw Accessory (Optional)

Compl 542 16 14-80
45° Mighty Miter

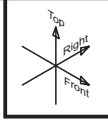

01.28.05

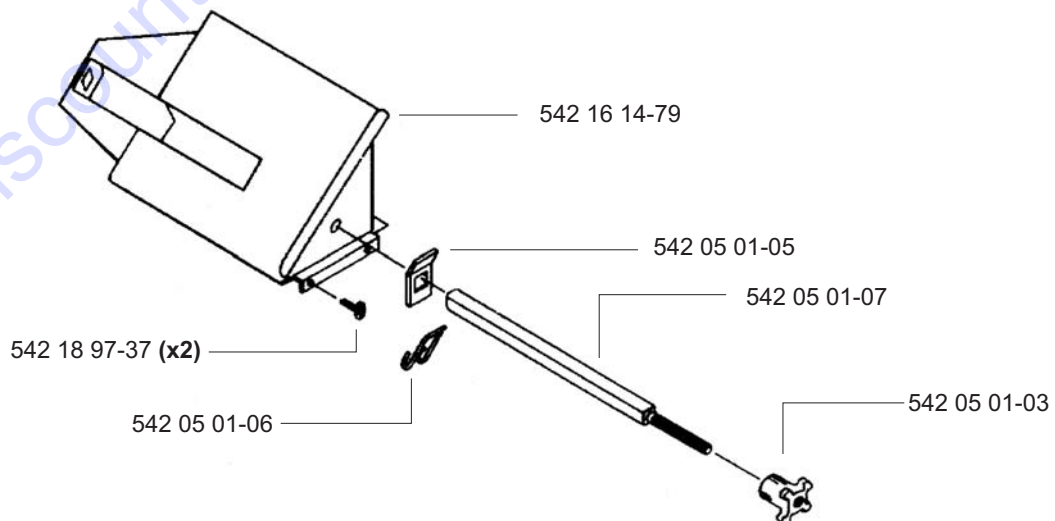

Tile Saw Stands (Optional)

Compl 542 20 32-52
Folding Steel Stand

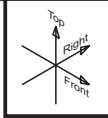

10.25.06

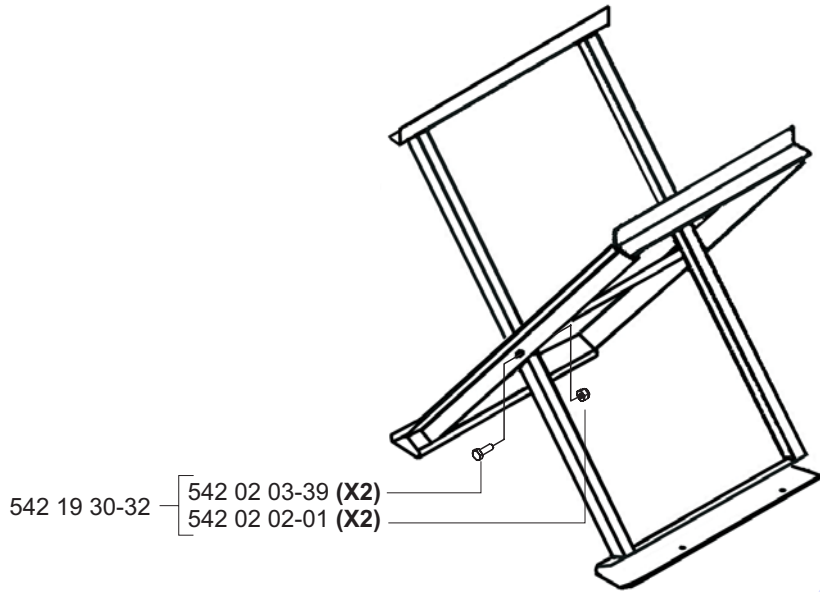

Compl 542 20 32-53
Adjustable Rolling Stand

10.25.06

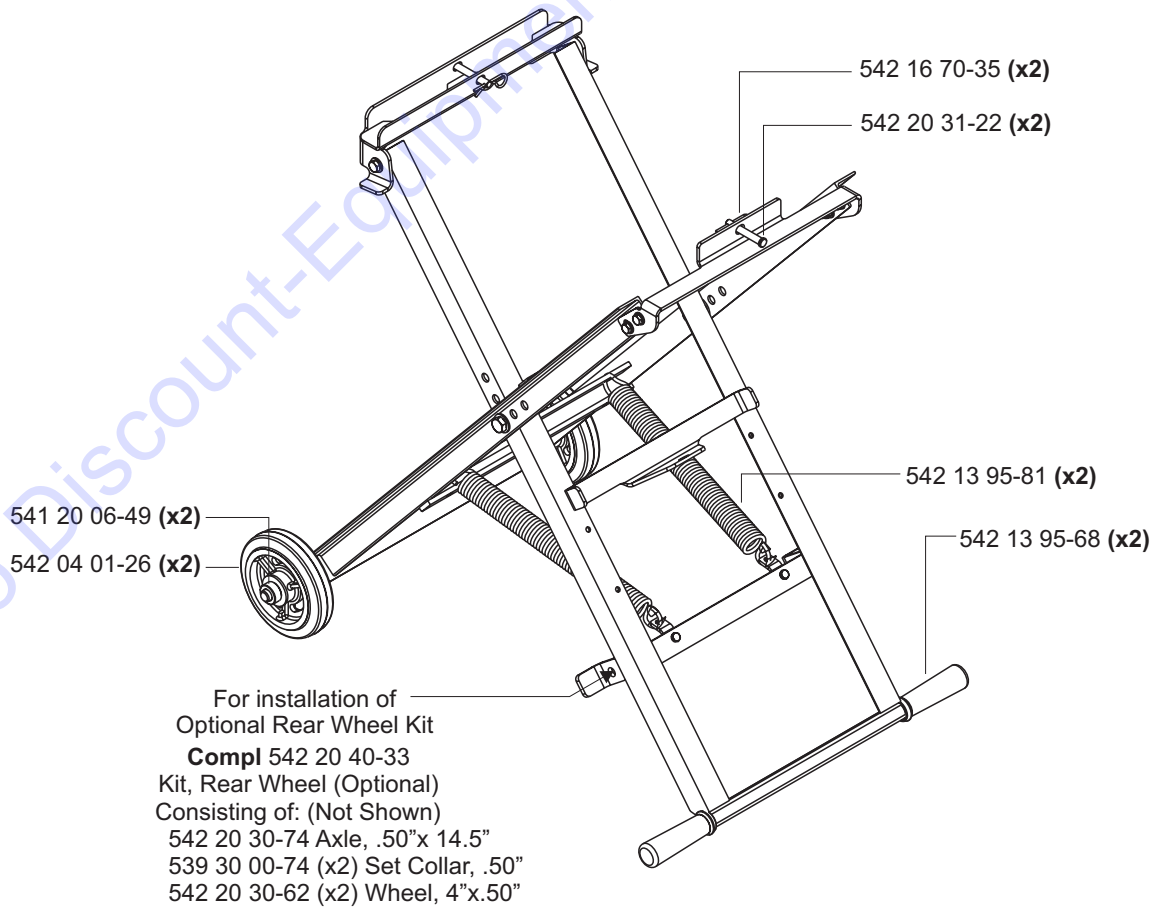

PARTS FINDER

**Search Website
by Part Number**



**Search Manual
Library For Parts
Manual & Lookup Part
Numbers – Purchase
or Request Quote**

Search Manuals

Enter your information to help us find the right parts manual for your machine.

* Brand:

* Model:

* Serial:

* Part Number:

SEARCH

**Can't Find Part or
Manual? Request Help
by Manufacturer,
Model & Description**

Parts Order Form

Please fill in the following information to help us find the right part for your machine.

Manufacturer:	<input type="text"/>
Model:	<input type="text"/>
Description:	<input type="text"/>
Part Number:	<input type="text"/>
Quantity:	<input type="text"/>
Notes:	<input type="text"/>

Submit

Discount-Equipment.com is your online resource for quality parts & equipment.

Florida: **561-964-4949** Outside Florida TOLL FREE: **877-690-3101**

Need parts?

Click on this link: <http://www.discount-equipment.com/category/5443-parts/> and choose one of the options to help get the right parts and equipment you are looking for. Please have the machine model and serial number available in order to help us get you the correct parts. If you don't find the part on the website or on one of the online manuals, please fill out the request form and one of our experienced staff members will get back to you with a quote for the right part that your machine needs.

We sell worldwide for the brands: Genie, Terex, JLG, MultiQuip, Mikasa, Essick, Whiteman, Mayco, Toro Stone, Diamond Products, Generac Magnum, Airman, Haulotte, Barreto, Power Blanket, Nifty Lift, Atlas Copco, Chicago Pneumatic, Allmand, Miller Curber, Skyjack, Lull, Skytrak, Tsurumi, Husquvarna Target, Stow, Wacker, Sakai, Mi-T-M, Sullair, Basic, Dynapac, MBW, Weber, Bartell, Bennar Newman, Haulotte, Ditch Runner, Menegotti, Morrison, Contec, Buddy, Crown, Edco, Wyco, Bomag, Laymor, EZ Trench, Bil-Jax, F.S. Curtis, Gehl Pavers, Heli, Honda, ICS/PowerGrit, IHI, Partner, Imer, Clipper, MMD, Koshin, Rice, CH&E, General Equipment, Amida, Coleman, NAC, Gradall, Square Shooter, Kent, Stanley, Tamco, Toku, Hatz, Kohler, Robin, Wisconsin, Northrock, Oztec, Toker TK, Rol-Air, APT, Wylie, Ingersoll Rand / Doosan, Innovatech, Con X, Ammann, Mecalac, Makinex, Smith Surface Prep, Small Line, Wanco, Yanmar