

PP 440 HF

Reservdelar

Spare parts

Ersatzteile

Pieces de rechange

Piezas de repuesto

Ricambi

Peças sobresselente



# PARTS FINDER

**Search Website  
by Part Number**



**Search Manual  
Library For Parts  
Manual & Lookup Part  
Numbers – Purchase  
or Request Quote**

**Search Manuals**

Enter your information to help us find the right parts manual for your machine.

\* Brand:

\* Model:

\* Serial:

\* Part Number:

SEARCH

**Can't Find Part or  
Manual? Request Help  
by Manufacturer,  
Model & Description**

**Parts Order Form**

Please fill in the following information to help us find the right part for your machine.

Manufacturer:	<input type="text"/>
Model:	<input type="text"/>
Description:	<input type="text"/>
Part Number:	<input type="text"/>
Quantity:	<input type="text"/>
Notes:	<input type="text"/>

Submit

Discount-Equipment.com is your online resource for quality parts & equipment.

Florida: **561-964-4949** Outside Florida TOLL FREE: **877-690-3101**

**Need parts?**

Click on this link: <http://www.discount-equipment.com/category/5443-parts/> and choose one of the options to help get the right parts and equipment you are looking for. Please have the machine model and serial number available in order to help us get you the correct parts. If you don't find the part on the website or on one of the online manuals, please fill out the request form and one of our experienced staff members will get back to you with a quote for the right part that your machine needs.

We sell worldwide for the brands: Genie, Terex, JLG, MultiQuip, Mikasa, Essick, Whiteman, Mayco, Toro Stone, Diamond Products, Generac Magnum, Airman, Haulotte, Barreto, Power Blanket, Nifty Lift, Atlas Copco, Chicago Pneumatic, Allmand, Miller Curber, Skyjack, Lull, Skytrak, Tsurumi, Husquvarna Target, Stow, Wacker, Sakai, Mi-T-M, Sullair, Basic, Dynapac, MBW, Weber, Bartell, Bennar Newman, Haulotte, Ditch Runner, Menegotti, Morrison, Contec, Buddy, Crown, Edco, Wyco, Bomag, Laymor, EZ Trench, Bil-Jax, F.S. Curtis, Gehl Pavers, Heli, Honda, ICS/PowerGrit, IHI, Partner, Imer, Clipper, MMD, Koshin, Rice, CH&E, General Equipment, Amida, Coleman, NAC, Gradall, Square Shooter, Kent, Stanley, Tamco, Toku, Hatz, Kohler, Robin, Wisconsin, Northrock, Oztec, Toker TK, Rol-Air, APT, Wylie, Ingersoll Rand / Doosan, Innovatech, Con X, Ammann, Mecalac, Makinex, Smith Surface Prep, Small Line, Wanco, Yanmar

No.	Pos.	Description	No.	Pos.	Description
504 00 40-01	FF1	Type plate	531 11 72-51	FF1	Emergency stop
504 05 50-01	FF1	Display label	531 11 72-52	FF1	Circuite breaker
505 24 70-01	B	Shackle	531 11 80-03	C	Quick coupling, female 1800 uv
505 25 71-01	E	Cable	531 11 80-05	C	Nipple 1812
505 26 61-01	A	O-ring	531 11 80-18	C	Ball valve 3/8
505 32 70-01	E	Cover	531 11 82-19	C	Quick coupling, female 1300 UV
505 40 74-01	C	Nipple 3/8"	531 11 83-54	C	Nipple 18110 with net
505 46 11-01	B	Emergency stop	531 11 90-14	C	Hose clamp 13-20
505 46 12-01	B	Adapter	531 11 90-18	B	Distance
505 46 13-01	B	Contact	531 11 91-26	FF1	Strap
505 52 62-01	B	Gasket kit	531 11 92-08	B	Screw
505 52 64-01	B	Switch	531 11 92-60	B	Washer
505 52 65-01	B	Lamp	531 11 92-85	F1	Distance
505 52 66-01	B	Screw	531 11 93-37	A	Plug
505 52 66-02	B	Screw	531 11 93-89	B	Screw MLC6S 5x10
505 52 66-03	ABD	Screw	531 11 95-86	B	Screw MRX M3x5
505 52 67-01	B	Protctive shutter	531 12 32-48	E	Cable
505 52 68-01	B	Socket	531 12 33-61	D	Bumper
505 52 69-01	B	Cable grommet M16	531 12 33-62	B	Attachment plate
505 52 69-02	B	Cable grommet M20	531 12 34-00	A	End cover inlet side
505 52 69-03	B	Cable grommet M25	531 12 34-01	A	End cover outlet side 5-pin
505 52 72-01	D	Handle	531 12 34-02	A	Partition
505 52 73-01	C	Water valve	531 12 34-03	A	Base plate
505 52 74-01	B	Transformer 400-480V	531 12 34-04	A	Upper support
505 52 75-01	B	Angle bracket	531 12 34-05	D	Cover strip upper
505 52 76-01	E	Cable kit	531 12 34-06	A	Cover strip lower
505 52 77-01	E	Cable kit	531 12 34-09	B	Conduit entry
505 52 78-01	E	Cable kit	531 12 34-10	C	Water inlet connection
505 52 79-01	A	Printed circuit assembly	531 12 34-11	C	Distance coupling
505 52 80-01	B	Printed circuit assembly	531 12 34-12	C	Clamping washer
505 52 82-01	B	Distance	531 12 34-13	C	Water connection
505 52 83-01	B	Screw MC6S 4x5	531 12 34-15	D	Box side
505 52 84-01	B	Ventilating valve	531 12 34-16	D	Foot
505 52 85-01	A	Sealing strip	531 12 34-17	A	Locking sleeve
505 52 87-01	B	Consol 6-pole	531 14 20-11	FF1	Control plate
505 52 88-01	B	Consol 3-pole	531 14 20-13	FF1	Potentiometer nut
505 52 89-01	B	Frame	531 14 20-62	FF1	Remote box
505 52 92-01	B	Contact housing	531 14 20-92	F1	Charger cable
505 53 84-01	B	Cover	574 02 85-01	BF1	Radio card
505 56 87-01	C	Water connection	574 19 69-01	F	Control board
506 00 36-01	F	Remote control complete	574 19 71-01	F1	Radio remote control
506 60 03-01	B	Attachment plate	723 12 20-01	B	Screw MCS 3x6
506 74 83-01	C	Valve Assembled	723 12 24-01	FF1	Screw MCS 3x10
510 03 83-01	A	End cover outlet side 5-pin 4-pin	723 12 91-01	B	Screw MCS 4x12
522 52 50-01	B	Plate	723 52 28-01	FF1	Screw MFS 3x16
522 61 52-01	A	Base plate	725 52 20-01	B	Screw MC6S 3x6
522 61 53-01	A	Upper support	725 53 29-01	C	Screw MC6S M5x16
522 61 59-01	D	Gable top	725 53 31-01	B	Screw MC6S 5x20
522 61 60-01	A	Cover strip lower	725 53 33-01	C	Screw MC6S 5x25
522 61 61-01	D	Box side	725 53 78-01	D	Screw MC6S 6x40
522 92 82-01	A	Printed circuit assy 400-480V	725 54 63-01	D	Screw MC6S 8x60
522 92 82-02	A	Printed circuit assy 200-280V	725 54 69-51	D	Screw MC6S 8x90
523 04 59-01	B	Adapter	725 63 74-51	A	Screw MF6S 6x30 10.9
523 04 60-01	A	Printed circuit assy 200-280V	725 64 91-01	D	Screw MF6S 10x20
523 04 61-01	B	Transformer 200-280V	728 73 70-05	A	Stop screw S6SS 6x20
525 58 22-01	D	Distance	731 23 10-01	FF1	Nut M3
531 11 50-12	FF1	Can bus cable 6m	732 25 16-01	A	Nut M6 Nylock
531 11 51-83	FF1	Potentiometer knob compl.	732 25 18-01	D	Nut M8 Nylock
531 11 52-38	F1	Battery charger	734 11 23-71	B	Washer 3.2x6
531 11 70-34	FF1	Cannon connector	734 11 35-71	B	Washer 4.3x8
531 11 70-67	FF1	Connection block NO	734 11 46-01	BC	Washer 5,3x10x1
531 11 70-68	B	Contactora 200-280V	734 11 52-01	AD	Washer 6.4x12
531 11 70-96	FF1	Potentiometer remote control	734 11 63-01	D	Washer 8.4x16
531 11 71-44	FF1	Push-button	740 38 27-01	C	Sealing ring 1/4
531 11 71-52	B	Electric inlet 32A 400V	740 42 08-00	C	O-ring 10,1x1,6
531 11 71-53	B	Electric inlet 63A 200-280V	740 42 17-00	FF1	O-ring 19,1x1,6
531 11 71-59	FF1	Gasket	740 43 09-00	B	O-ring 11,3x2,4
531 11 72-08	B	Personal Safety Guard	740 43 13-00	C	O-ring 15,3x2,4
531 11 72-35	B	Contactora 400-480V			
531 11 72-40	FF1	Gasket			

**A** PP 440 HF

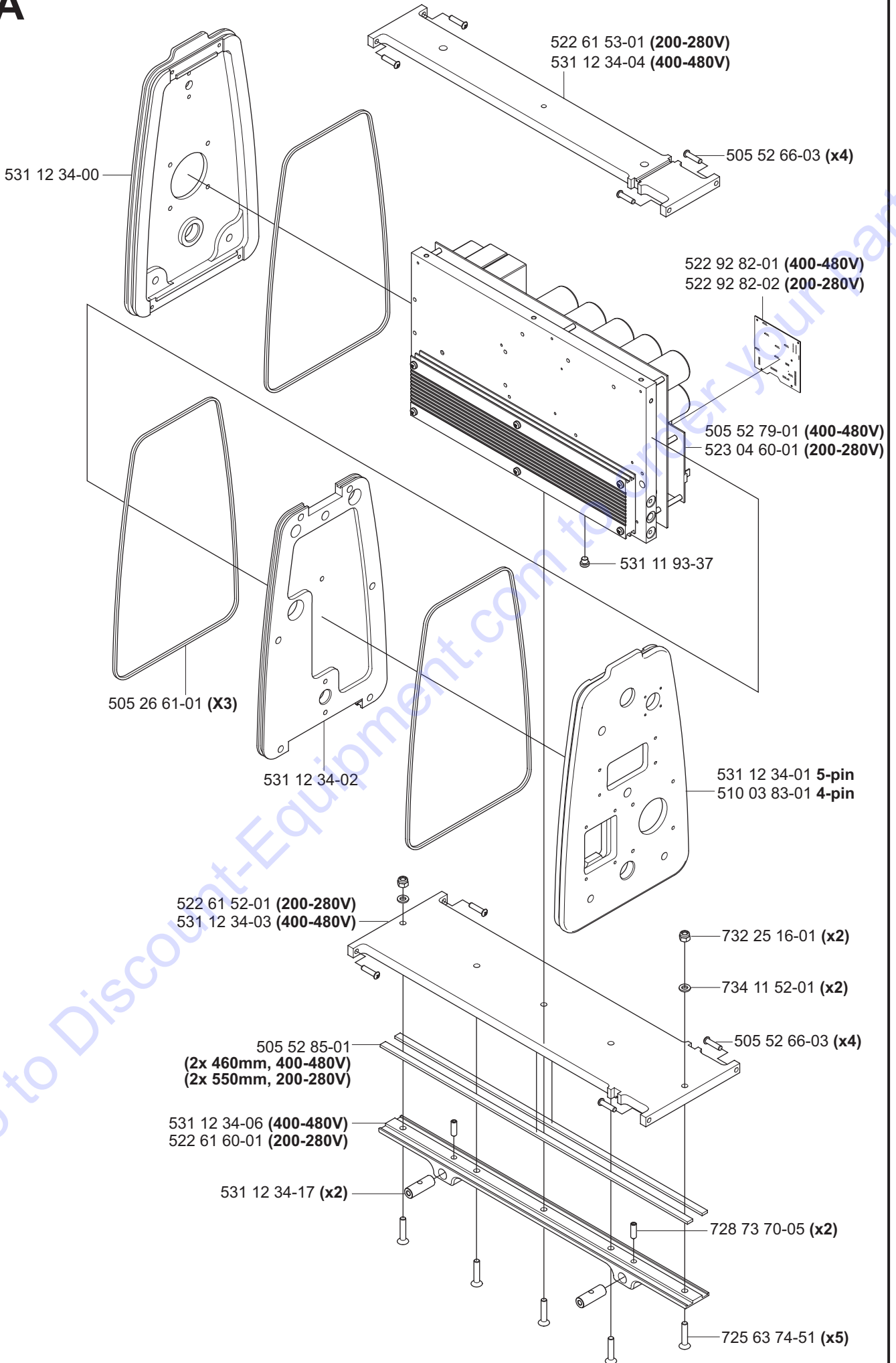

# B PP 440 HF

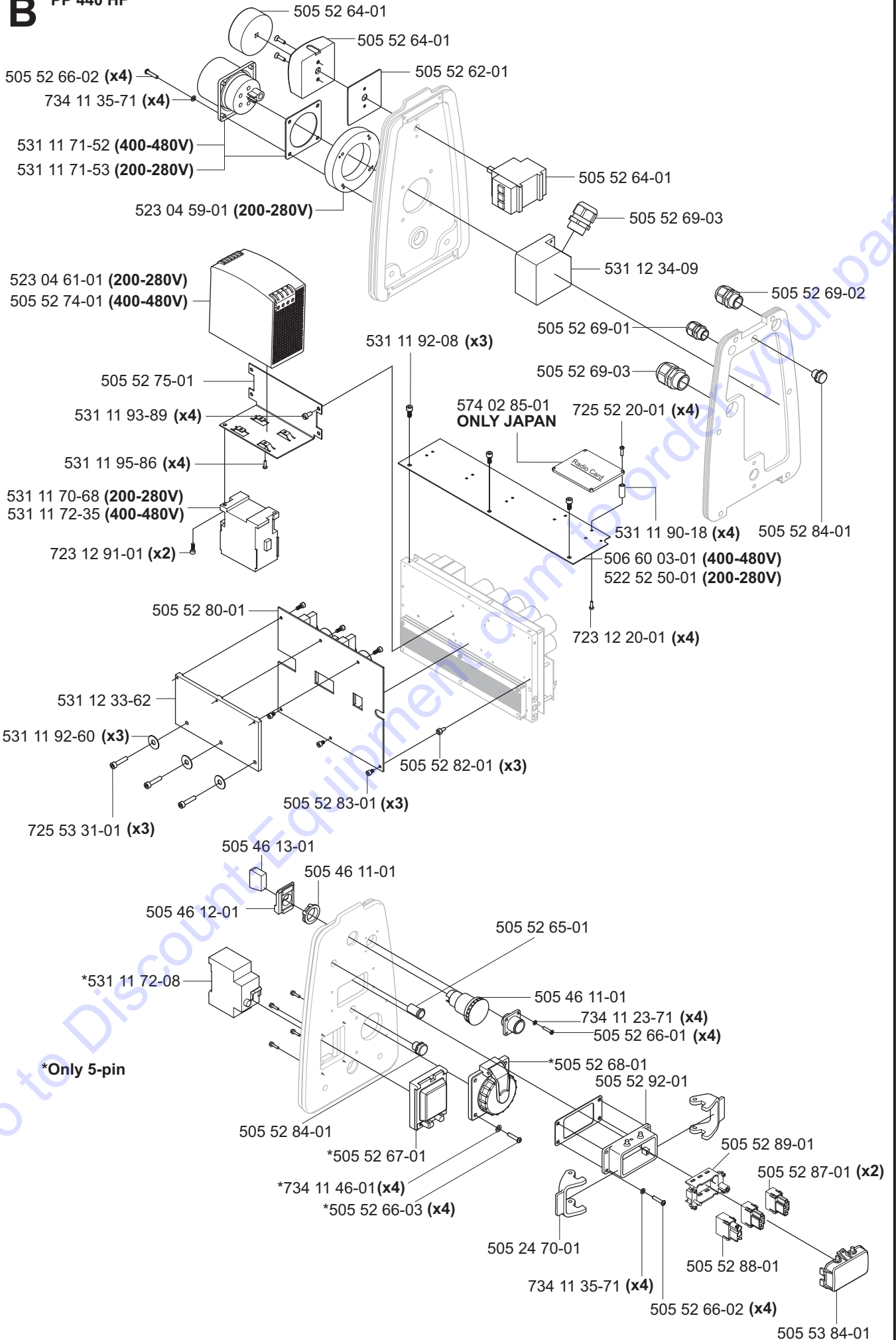

**C**

PP 440 HF

**\*Complete**  
505 42 42-01

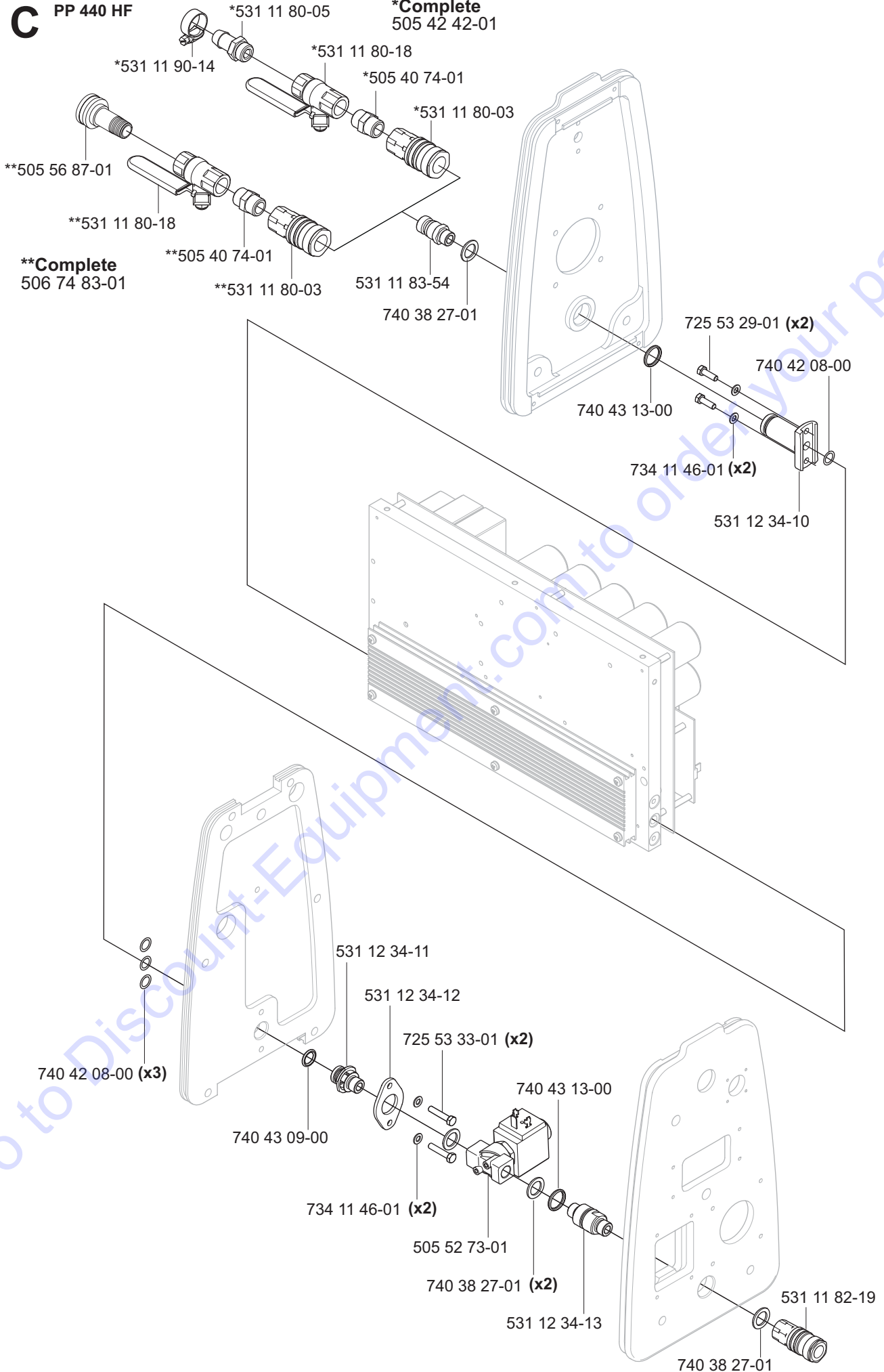

**D** PP 440 HF

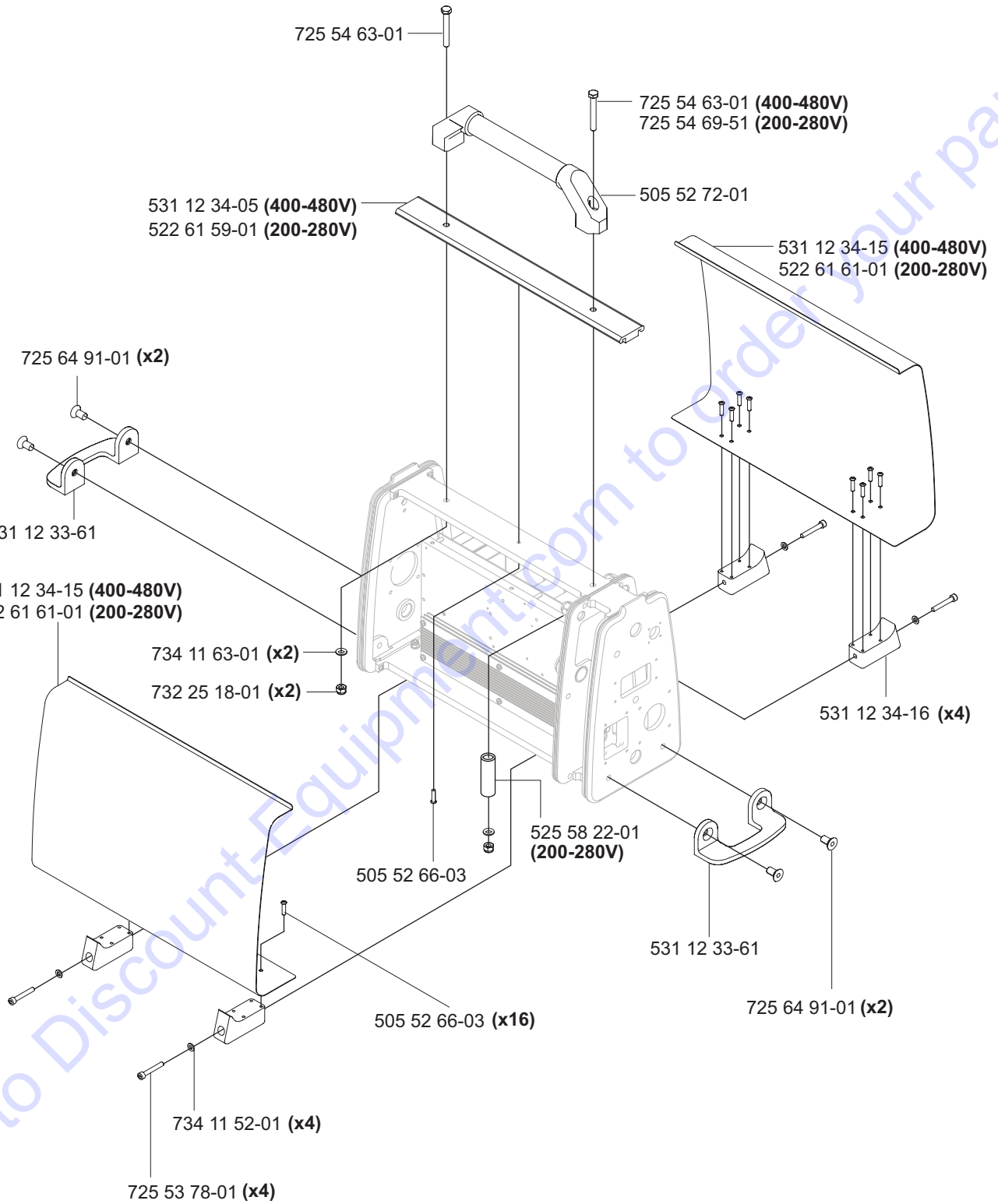

**E** PP 440 HF

505 25 71-01

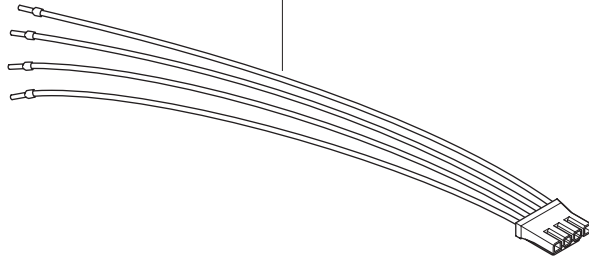

505 52 76-01

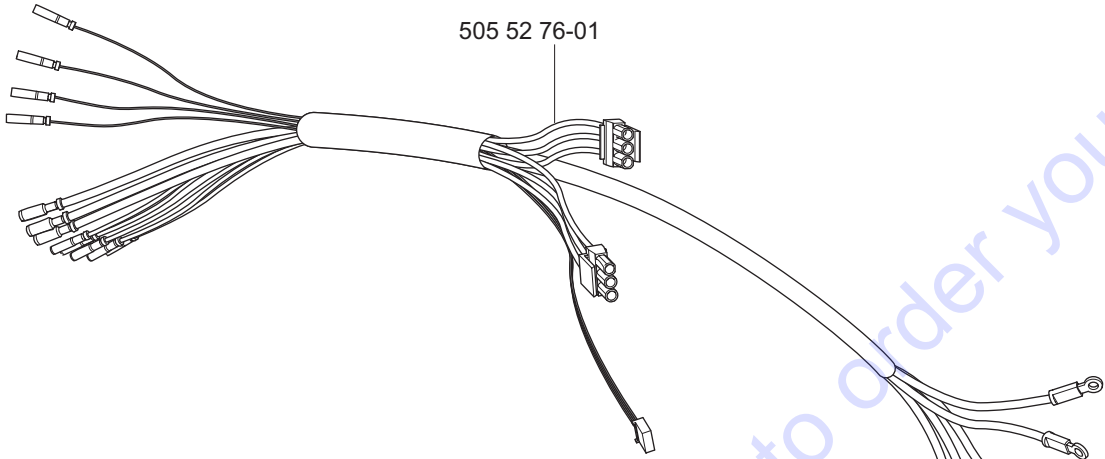

505 52 77-01

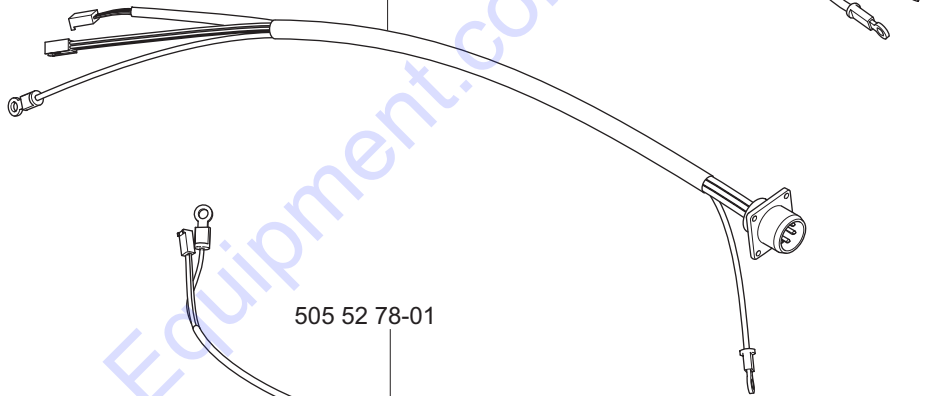

505 52 78-01

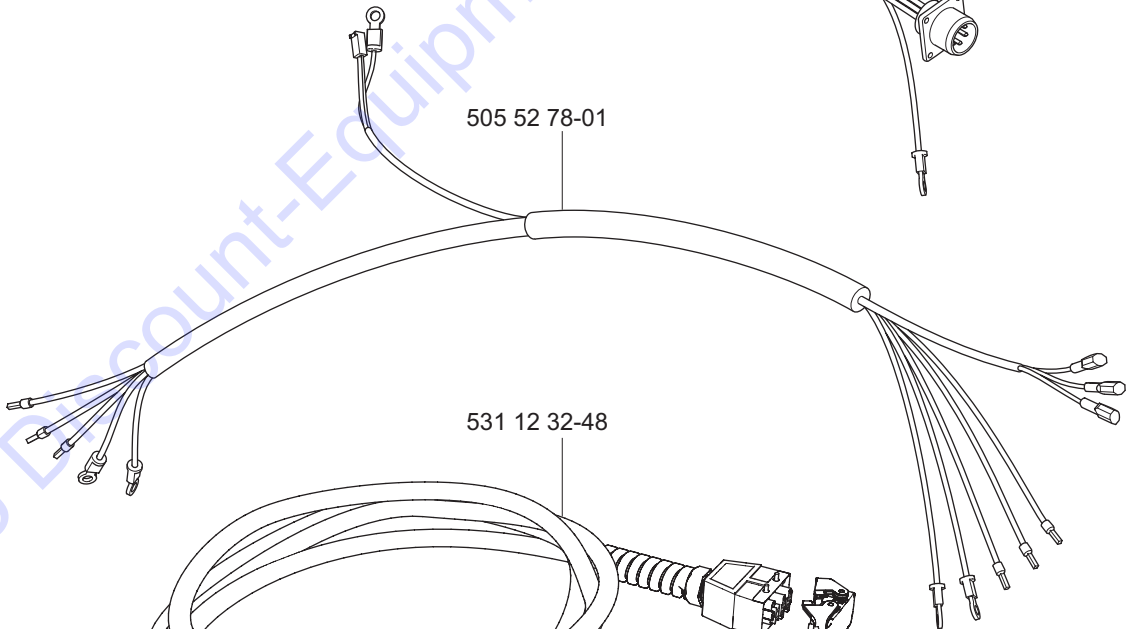

531 12 32-48

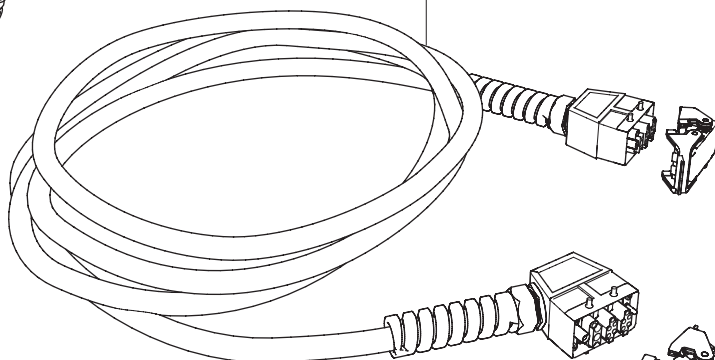

505 32 70-01 (x2)

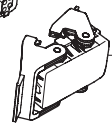

Go to Discount-Equipment.com to order your parts



**F** PP 440 HF

Remote control compl.  
506 00 36-01

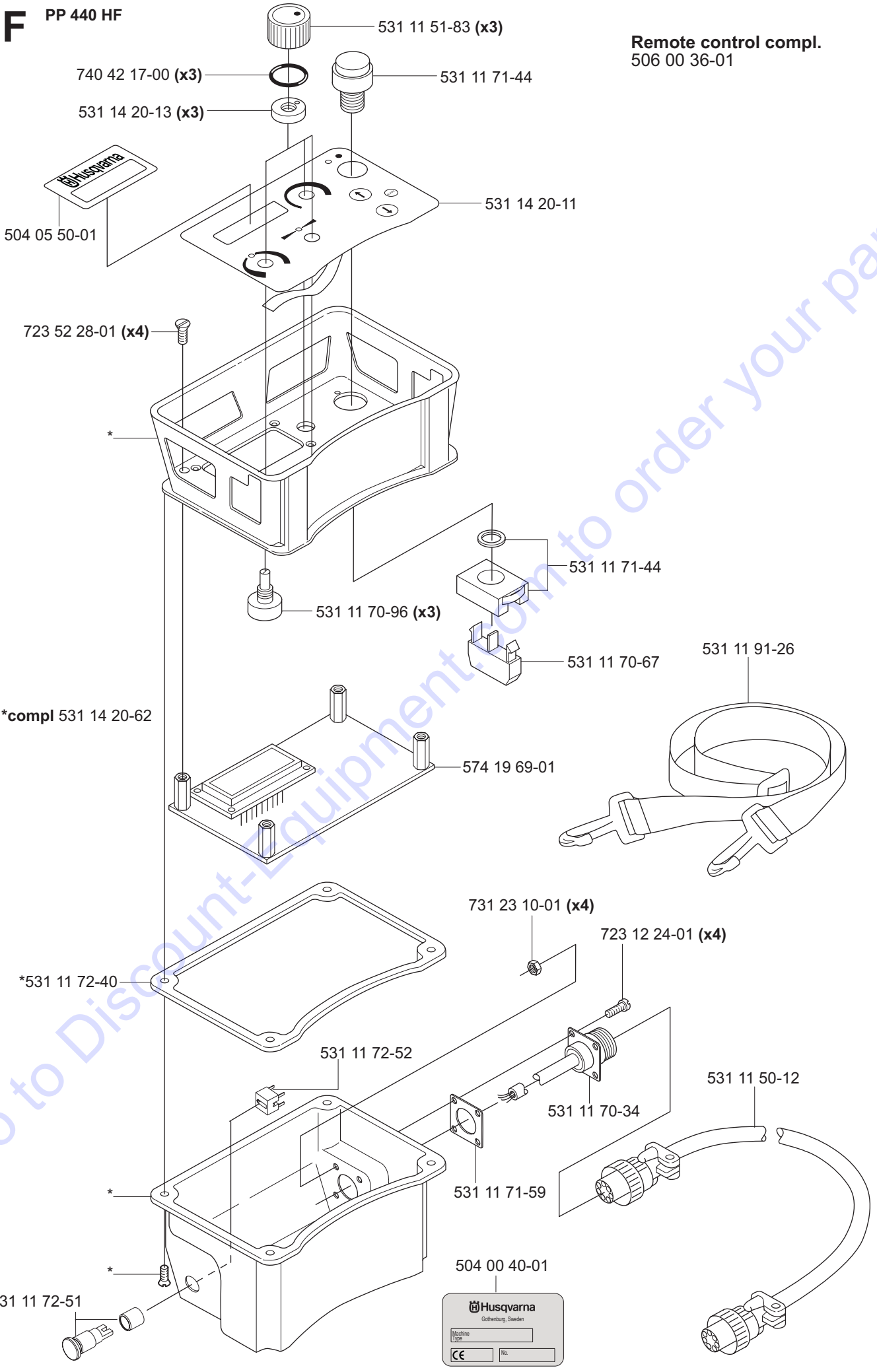

# F1 PP 440 HF

Radio remote control  
compl. 574 19 71-01  
**ONLY JAPAN**

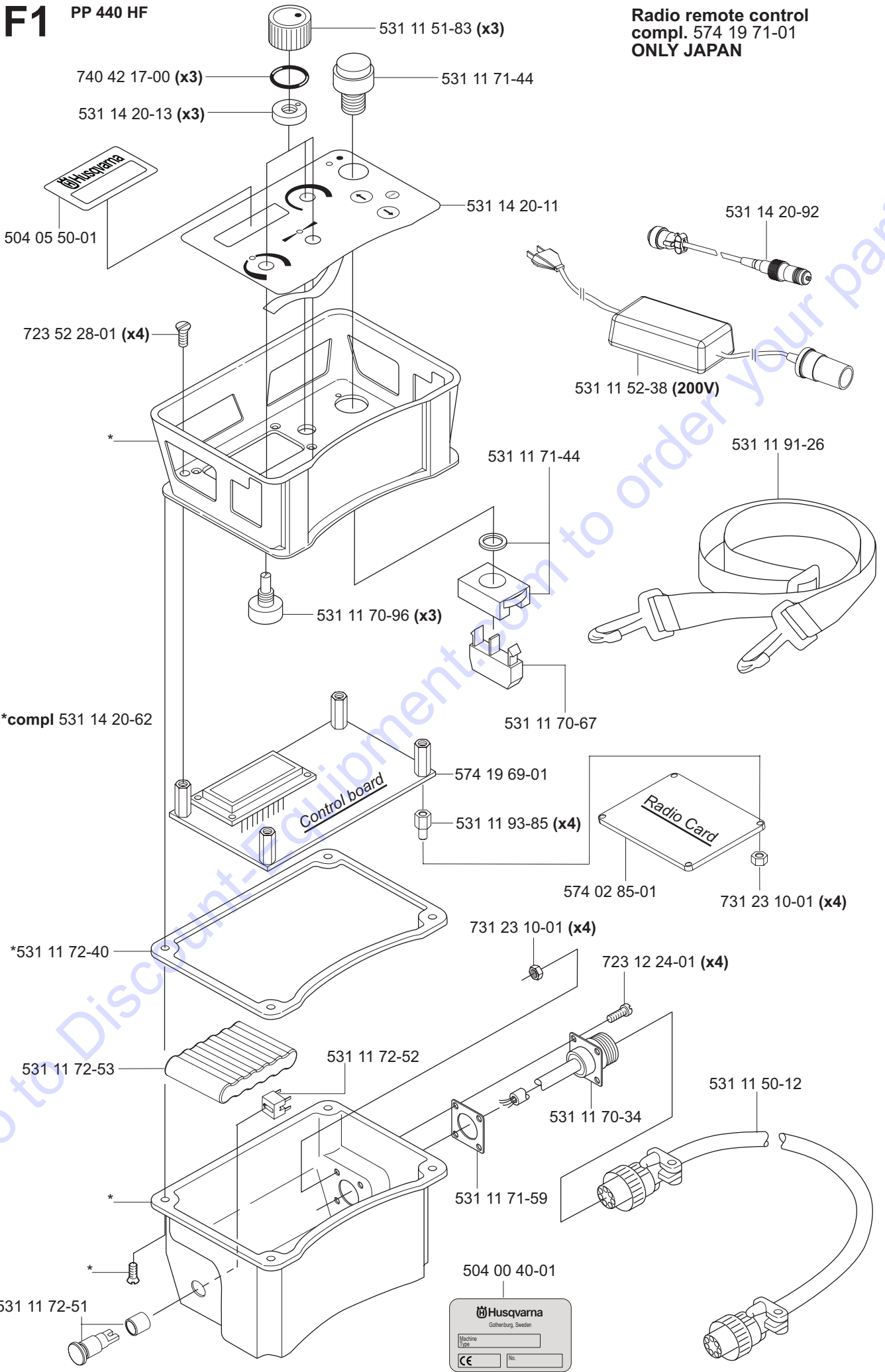

# PARTS FINDER

**Search Website  
by Part Number**



**Search Manual  
Library For Parts  
Manual & Lookup Part  
Numbers – Purchase  
or Request Quote**

**Search Manuals**

Enter your information to help us find the right parts manual for your machine.

\* Brand:

\* Model:

\* Serial:

\* Part Number:

SEARCH

**Can't Find Part or  
Manual? Request Help  
by Manufacturer,  
Model & Description**

**Parts Order Form**

Please fill in the following information to help us find the right part for your machine.

Manufacturer:	<input type="text"/>
Model:	<input type="text"/>
Description:	<input type="text"/>
Part Number:	<input type="text"/>
Quantity:	<input type="text"/>
Notes:	<input type="text"/>

Submit

Discount-Equipment.com is your online resource for quality parts & equipment.

Florida: **561-964-4949** Outside Florida TOLL FREE: **877-690-3101**

**Need parts?**

Click on this link: <http://www.discount-equipment.com/category/5443-parts/> and choose one of the options to help get the right parts and equipment you are looking for. Please have the machine model and serial number available in order to help us get you the correct parts. If you don't find the part on the website or on one of the online manuals, please fill out the request form and one of our experienced staff members will get back to you with a quote for the right part that your machine needs.

We sell worldwide for the brands: Genie, Terex, JLG, MultiQuip, Mikasa, Essick, Whiteman, Mayco, Toro Stone, Diamond Products, Generac Magnum, Airman, Haulotte, Barreto, Power Blanket, Nifty Lift, Atlas Copco, Chicago Pneumatic, Allmand, Miller Curber, Skyjack, Lull, Skytrak, Tsurumi, Husquvarna Target, Stow, Wacker, Sakai, Mi-T-M, Sullair, Basic, Dynapac, MBW, Weber, Bartell, Bennar Newman, Haulotte, Ditch Runner, Menegotti, Morrison, Contec, Buddy, Crown, Edco, Wyco, Bomag, Laymor, EZ Trench, Bil-Jax, F.S. Curtis, Gehl Pavers, Heli, Honda, ICS/PowerGrit, IHI, Partner, Imer, Clipper, MMD, Koshin, Rice, CH&E, General Equipment, Amida, Coleman, NAC, Gradall, Square Shooter, Kent, Stanley, Tamco, Toku, Hatz, Kohler, Robin, Wisconsin, Northrock, Oztec, Toker TK, Rol-Air, APT, Wylie, Ingersoll Rand / Doosan, Innovatech, Con X, Ammann, Mecalac, Makinex, Smith Surface Prep, Small Line, Wanco, Yanmar