



SPARE PARTS LIST

WALL SAWS

WS482 HF, Valid from machine no. 1275,
2012-07

Go to Discount-Equipment.com to order your parts



PARTS FINDER

**Search Website
by Part Number**



**Search Manual
Library For Parts
Manual & Lookup Part
Numbers – Purchase
or Request Quote**

Search Manuals

Enter your information to help us find the right parts manual for your machine.

* Brand:

* Model:

* Serial:

* Part Number:

SEARCH

**Can't Find Part or
Manual? Request Help
by Manufacturer,
Model & Description**

Parts Order Form

Please fill in the following information to help us find the right part for your machine.

Manufacturer:	<input type="text"/>
Model:	<input type="text"/>
Description:	<input type="text"/>
Part Number:	<input type="text"/>
Quantity:	<input type="text"/>
Notes:	<input type="text"/>

Submit

Discount-Equipment.com is your online resource for quality parts & equipment.

Florida: **561-964-4949** Outside Florida TOLL FREE: **877-690-3101**

Need parts?

Click on this link: <http://www.discount-equipment.com/category/5443-parts/> and choose one of the options to help get the right parts and equipment you are looking for. Please have the machine model and serial number available in order to help us get you the correct parts. If you don't find the part on the website or on one of the online manuals, please fill out the request form and one of our experienced staff members will get back to you with a quote for the right part that your machine needs.

We sell worldwide for the brands: Genie, Terex, JLG, MultiQuip, Mikasa, Essick, Whiteman, Mayco, Toro Stone, Diamond Products, Generac Magnum, Airman, Haulotte, Barreto, Power Blanket, Nifty Lift, Atlas Copco, Chicago Pneumatic, Allmand, Miller Curber, Skyjack, Lull, Skytrak, Tsurumi, Husquvarna Target, Stow, Wacker, Sakai, Mi-T-M, Sullair, Basic, Dynapac, MBW, Weber, Bartell, Bennar Newman, Haulotte, Ditch Runner, Menegotti, Morrison, Contec, Buddy, Crown, Edco, Wyco, Bomag, Laymor, EZ Trench, Bil-Jax, F.S. Curtis, Gehl Pavers, Heli, Honda, ICS/PowerGrit, IHI, Partner, Imer, Clipper, MMD, Koshin, Rice, CH&E, General Equipment, Amida, Coleman, NAC, Gradall, Square Shooter, Kent, Stanley, Tamco, Toku, Hatz, Kohler, Robin, Wisconsin, Northrock, Oztec, Toker TK, Rol-Air, APT, Wylie, Ingersoll Rand / Doosan, Innovatech, Con X, Ammann, Mecalac, Makinex, Smith Surface Prep, Small Line, Wanco, Yanmar

J WS 482 HF

Tillbehör
Accessories
Zubehöre
Accessoires
Accesorios

Mounting bracket Universal
compl. 531 11 32-00

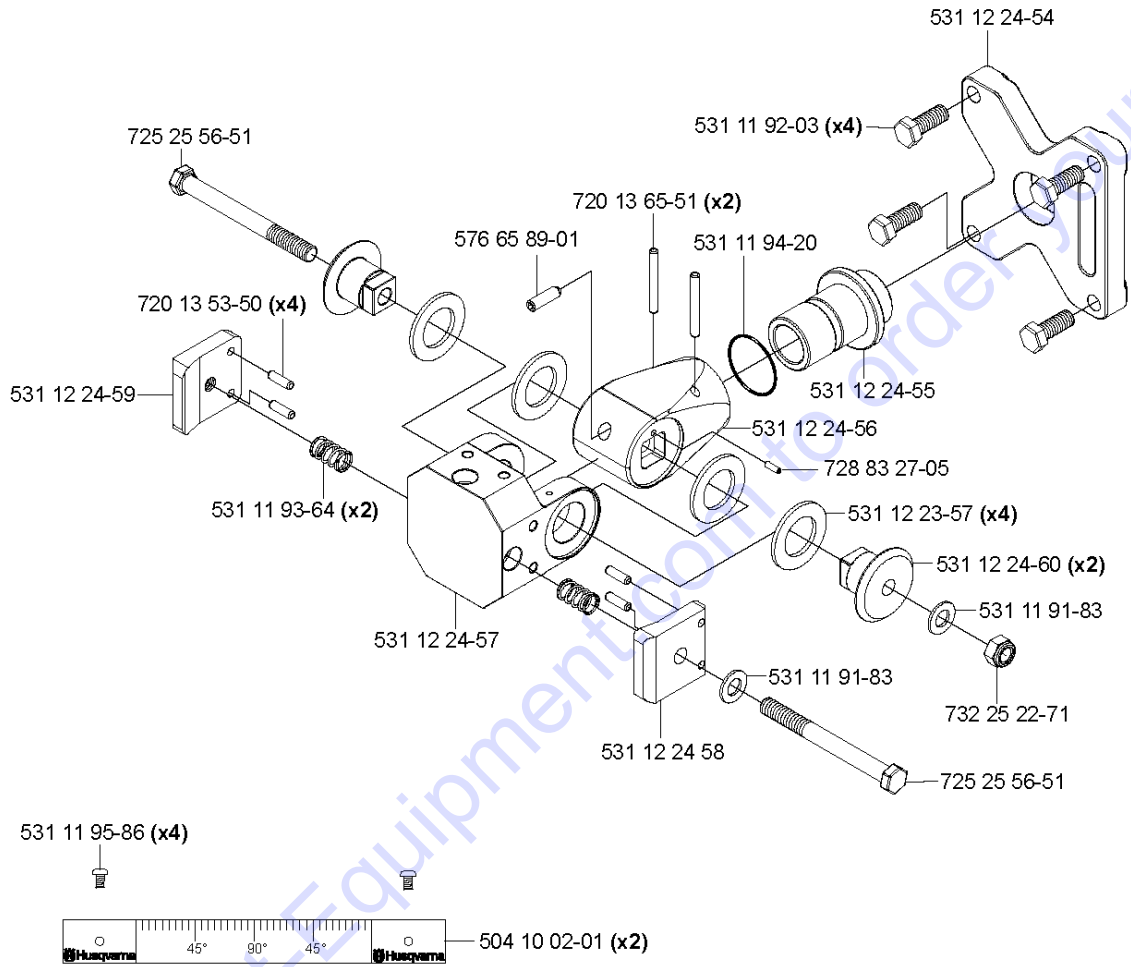

Measure rod complete 531 11 32-65

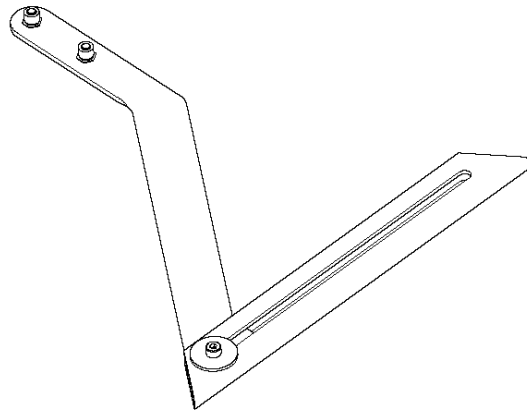

ACCESSORIES

WS482 HF, Valid from machine no. 1275, 2012-07

Part No	Description	Remark	QTY KIT
504 10 02-01	SCALE		
531 11 32-00	BRACKET		
531 11 32-65	POINTER		
531 11 91-83	WASHER		
531 11 92-03	SCREW		
531 11 93-64	SPRING		
531 11 94-20	O-RING		
531 11 95-86	SCREW		
531 12 23-57	CLUTCH		
531 12 24-54	CONSOLE		
531 12 24-55	AXLE		
531 12 24-56	MOUNT		
531 12 24-57	BRACKET		
531 12 24-58	WASHER		
531 12 24-59	NUT		
531 12 24-60	CLUTCH		
576 65 89-01	SCREW		
720 13 53-50	PARALLEL PIN		
720 13 65-51	PARALLEL PIN		
725 25 56-51	SCREW EHHM		
728 83 27-05	SCREW IHSETM		
732 25 22-71	HEXAGON LOCKING NUT		

Go to Discount-Equipment.com to order your parts

F WS 482 HF

- Flange 1" complete 574 82 95-01
- Flange 60mm complete 574 82 95-02
- Flange 130 complete 574 82 95-03

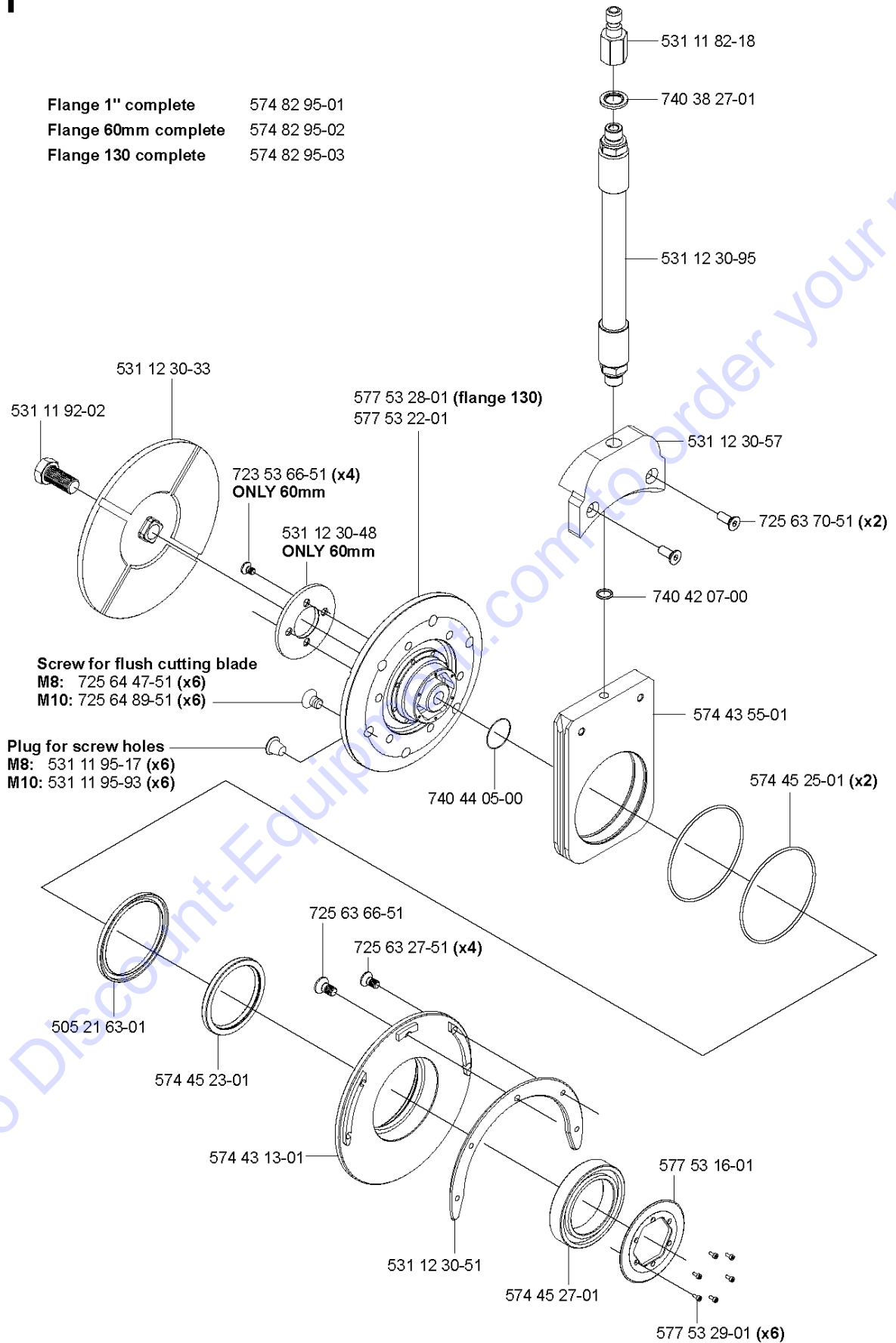

BLADE FLANGE

WS482 HF, Valid from machine no. 1275, 2012-07

Ref	Part No	Description	Remark	QTY KIT
505 21 63-01	505 21 63-01	RADIAL SEAL		
531 11 82-18	531 11 82-18	QUICK COUPLING		
531 11 92-02	531 11 92-02	SCREW		
531 11 95-17	531 11 95-17	PLUG		
531 11 95-93	531 11 95-93	PLUG		
531 12 30-33	531 12 30-33	FLANGE		
531 12 30-48	531 12 30-48	SPACER		
531 12 30-51	531 12 30-51	PLATE		
531 12 30-57	531 12 30-57	WASSERANSCHLUSS		
531 12 30-95	531 12 30-95	HOSE		
574 43 13-01	574 43 13-01	HUB		
574 43 55-01	574 43 55-01	BLOCK		
574 45 23-01	574 45 23-01	SEAL		
574 45 25-01	574 45 25-01	O-RING		
574 45 27-01	574 45 27-01	BEARING		
574 82 95-01	574 82 95-01	FLANGE		
574 82 95-02	574 82 95-02	FLANGE		
574 82 95-03	574 82 95-03	FLANGE		
577 53 16-01	577 53 16-02	STOP WASHER		
577 53 22-01	577 53 22-01	FLANGE		
577 53 28-01	577 53 28-01	FLANGE		
577 53 29-01	577 53 29-01	SCREW		
723 53 66-51	723 53 66-51	SCREW		
725 63 27-51	725 63 27-51	SCREW IHCSFM		
725 63 70-51	725 63 70-51	SCREW IHCSFM		
725 64 47-51	725 64 47-51	SCREW IHCSFM		
725 64 89-51	725 64 89-51	SCREW IHCSFM		
740 44 05-00	740 44 05-00	O-RING		
740 42 07-00	740 42 07-00	O-RING		
740 38 27-01	740 38 27-01	SEALING WASHER		
725 63 66-51	725 63 66-51	SCREW IHCSFM		1

Go to Discount-Equipment.com to order your parts

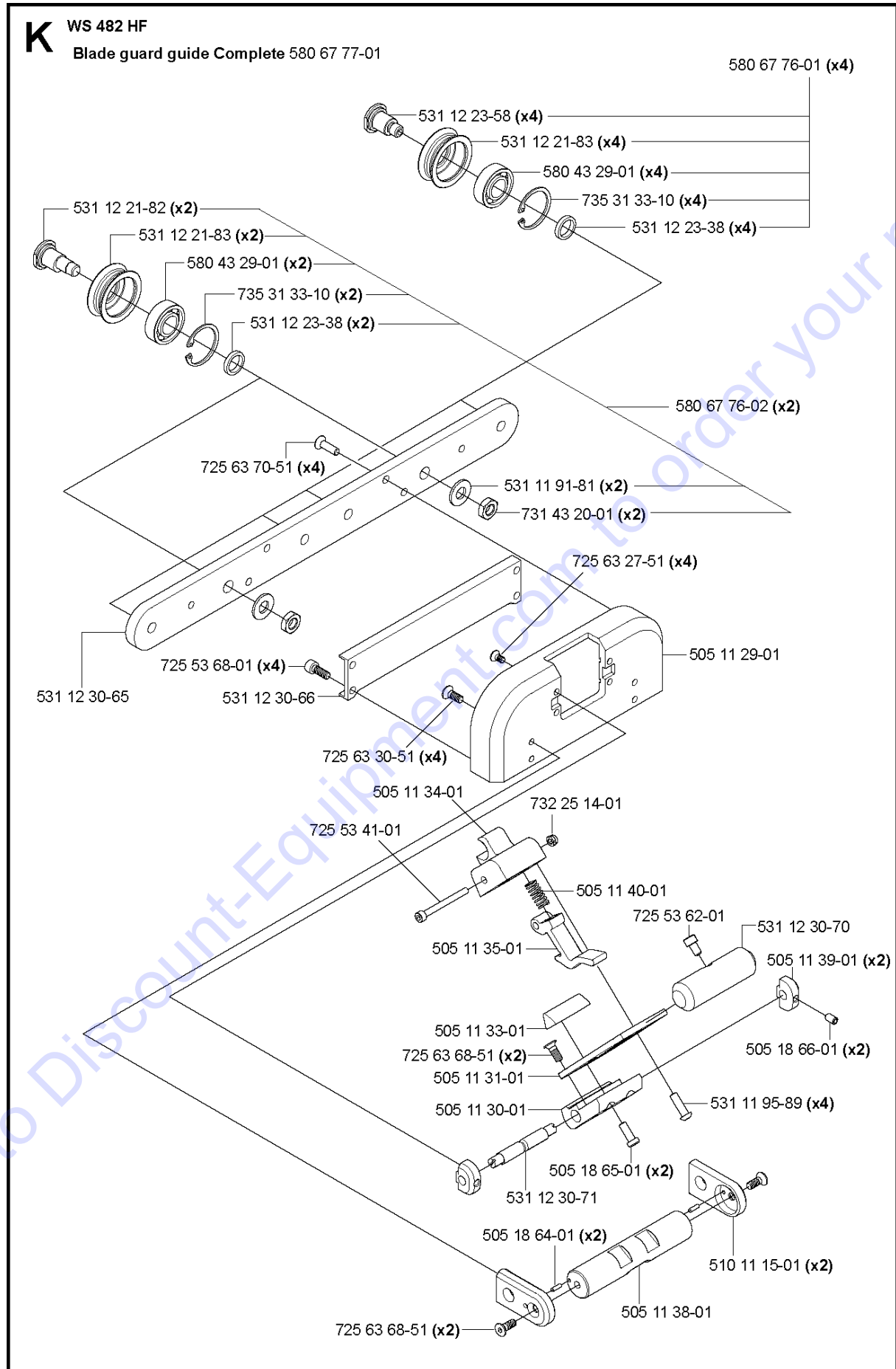

Part No	Description	Remark	QTY KIT
505 11 29-01	HOLDER		
505 11 30-01	ECCENTRIC		
505 11 31-01	HANDLE BRACKET		
505 11 33-01	BEAM		
505 11 34-01	SNAP LOCKING		
505 11 35-01	HOOK		
505 11 38-01	HANDLE		
505 11 39-01	SHAFT SEAT		
505 11 40-01	SPRING		
505 18 64-01	PARALLEL PIN		
505 18 65-01	SCREW		
505 18 66-01	SCREW		
510 11 15-01	HANDLE HOLDER		
531 11 91-81	WASHER		
531 11 95-89	SCREW		
531 12 21-82	WHEEL		
531 12 21-83	WHEEL		
531 12 23-38	SPACER RING		
531 12 23-58	WHEEL		
531 12 30-65	GUIDE RAIL		
531 12 30-66	COVER		
531 12 30-70	HANDLE		
531 12 30-71	SHAFT		
580 43 29-01	BEARING		
580 67 76-01	WHEEL ASSY		
580 67 76-02	WHEEL ASSY		
580 67 77-01	BLADE GUARD		
725 53 41-01	SCREW IHSCM		
725 53 62-01	SCREW IHSCM		
725 53 68-01	SCREW IHSCM		
725 63 27-51	SCREW IHCSFM		
725 63 30-51	SCREW IHCSFM		
725 63 68-51	SCREW IHCSFM		
725 63 70-51	SCREW IHCSFM		
731 43 20-01	HEXAGON THIN NUT		
732 25 14-01	HEXAGON LOCKING NUT		
735 31 33-10	CIRCLIP		

Go to Discount-Equipment.com to order your parts

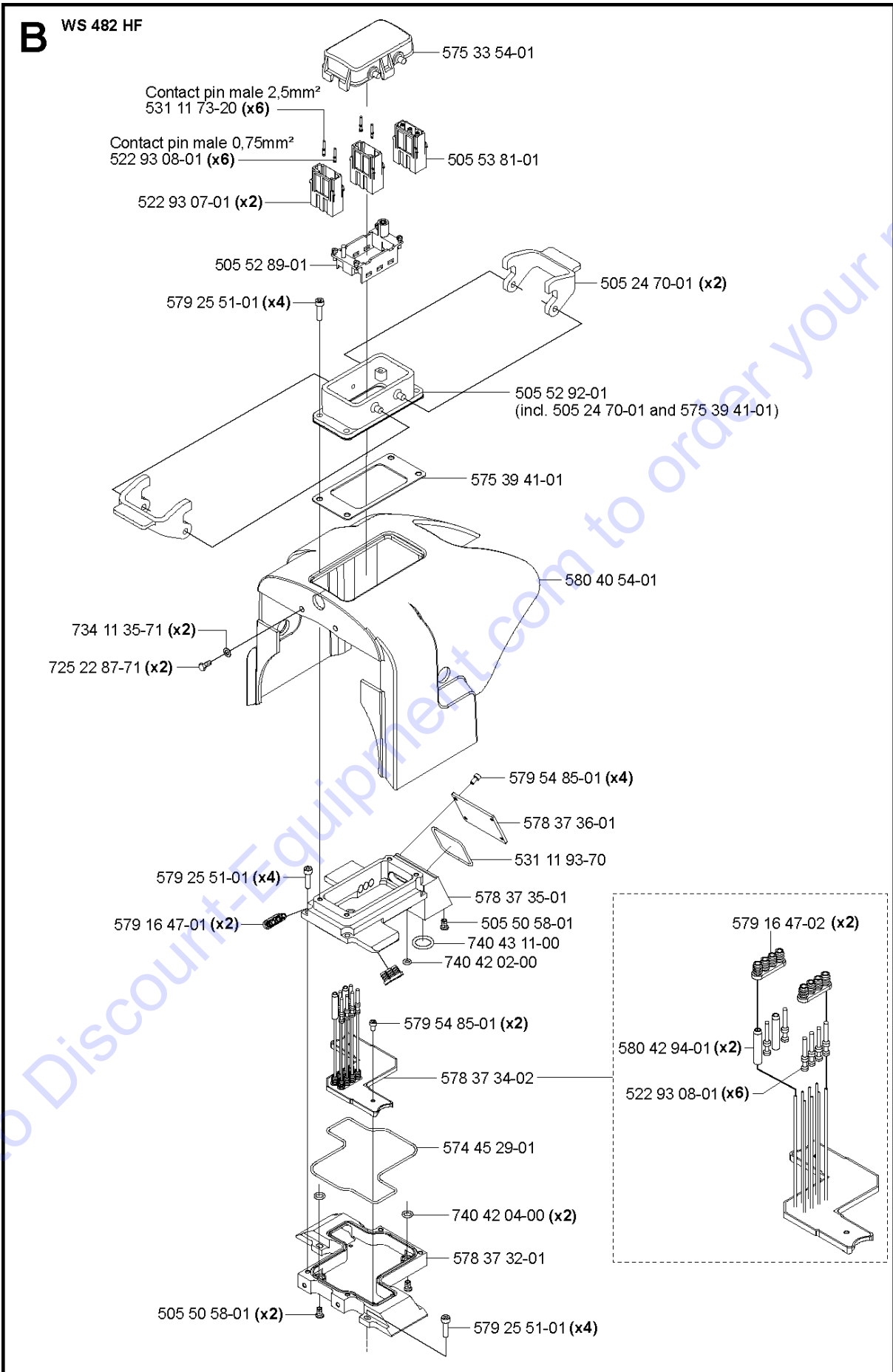

ELECTRICAL

WS482 HF, Valid from machine no. 1275, 2012-07

Ref	Part No	Description	Remark	QTY KIT
505 24 70-01	505 24 70-01	SHACKLE		
505 50 58-01	505 50 58-01	PLUG		
505 52 89-01	505 52 89-01	FRAME		
505 52 92-01	505 52 92-01	CONTACT		
505 53 81-01	505 53 81-01	CONSOLE		
522 93 07-01	522 93 07-01	CONSOLE		
522 93 08-01	522 93 08-01	TERMINAL		
531 11 73-20	531 11 73-20	TERMINAL		
531 11 93-70	531 11 93-70	O-RING		
574 45 29-01	574 45 29-01	O-RING		
575 33 54-01	575 33 54-01	COVER		
575 39 41-01	575 39 41-01	GASKET		
578 37 32-01	578 37 32-01	ELECTRONIC BOX		
578 37 34-02	578 37 34-04	PRINTED CIRCUIT BOARD		
578 37 35-01	578 37 35-01	SEALING PLATE		
578 37 36-01	578 37 36-01	CABLE COVER		
579 16 47-01	579 16 47-01	SEALING PLUG		
579 16 47-02	579 16 47-02	SEALING PLUG		
579 25 51-01	579 25 51-01	SCREW IHSCFMO		
579 54 85-01	579 54 85-01	SCREW		
580 40 54-01	580 40 54-01	COVER		
580 42 94-01	580 42 94-01	CONNECTOR		
725 22 87-71	725 22 87-71	SCREW EHHM		
734 11 35-71	734 11 35-71	WASHER		
740 43 11-00	740 43 11-00	O-RING		
740 42 02-00	740 42 02-00	O-RING		
740 42 04-00	740 42 04-00	O-RING		

Go to Discount-Equipment.com to order your parts

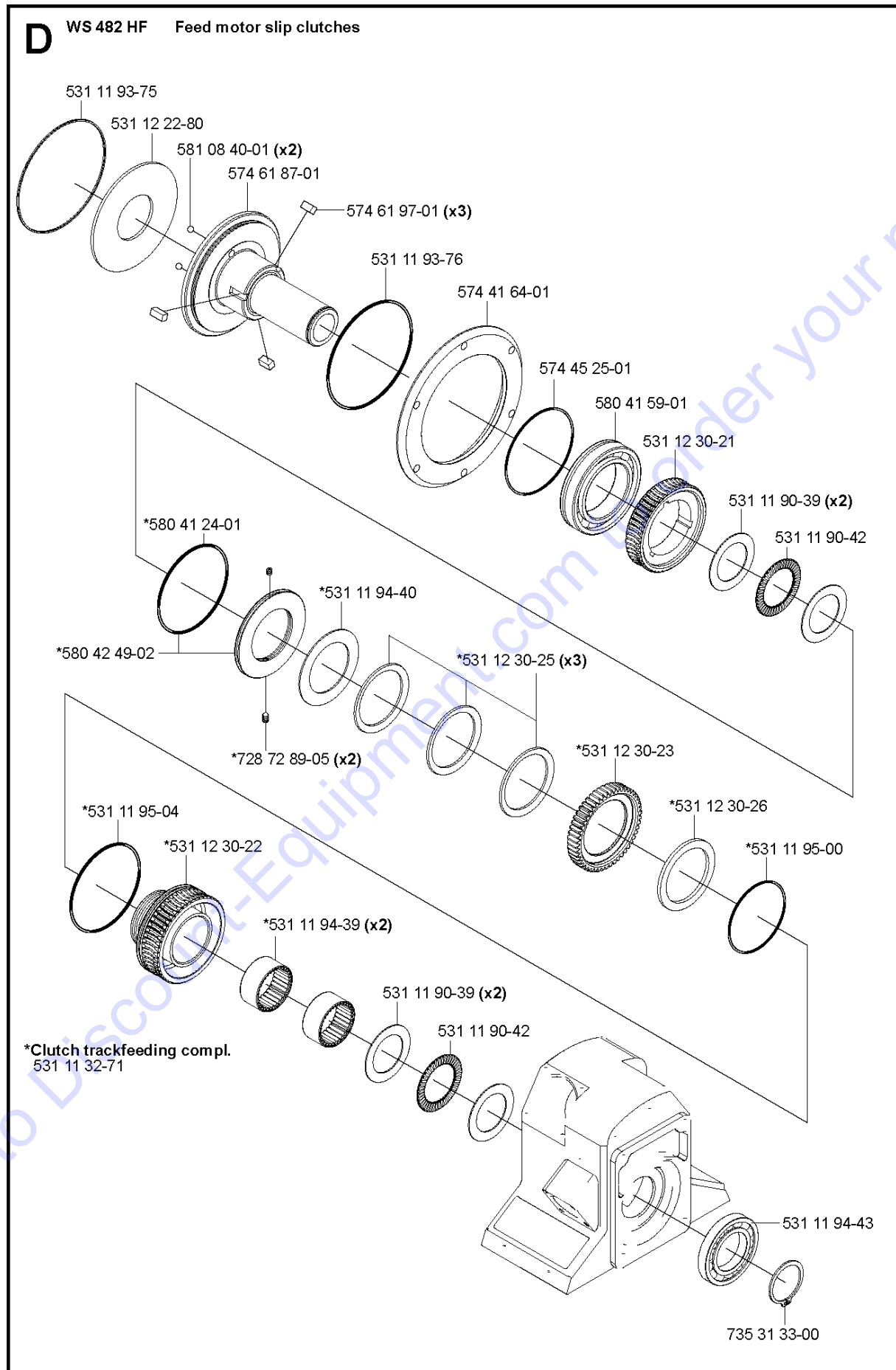

FEEDING GEARS

WS482 HF, Valid from machine no. 1275, 2012-07

Part No	Description	Remark	QTY KIT
522 53 68-01	PLUG		
531 11 32-71	CLUTCH		
531 11 90-39	WASHER		
531 11 90-42	BEARING		
531 11 93-75	O-RING		
531 11 93-76	O-RING		
531 11 94-39	BEARING		
531 11 94-40	BEARING		
531 11 94-43	BEARING		
531 11 95-00	O-RING		
531 11 95-04	O-RING		
531 12 22-80	PLATE		
531 12 30-21	GEAR WHEEL		
531 12 30-22	GEAR WHEEL		
531 12 30-23	GEAR WHEEL		
531 12 30-25	CUP		
531 12 30-26	PLATE		
574 41 64-01	CLUTCH HUB		
574 45 25-01	O-RING		
574 61 87-01	SHAFT		
574 61 97-01	KEY		
580 41 24-01	O-RING		
580 41 59-01	BEARING		
580 42 49-02	NUT		
581 08 40-01	BALL		1
728 72 89-05	SCREW IHSETM		
735 31 33-00	CIRCLIP		

Go to Discount-Equipment.com to order your parts

C WS 482 HF

Track feeding motor compl. 580 62 50-01

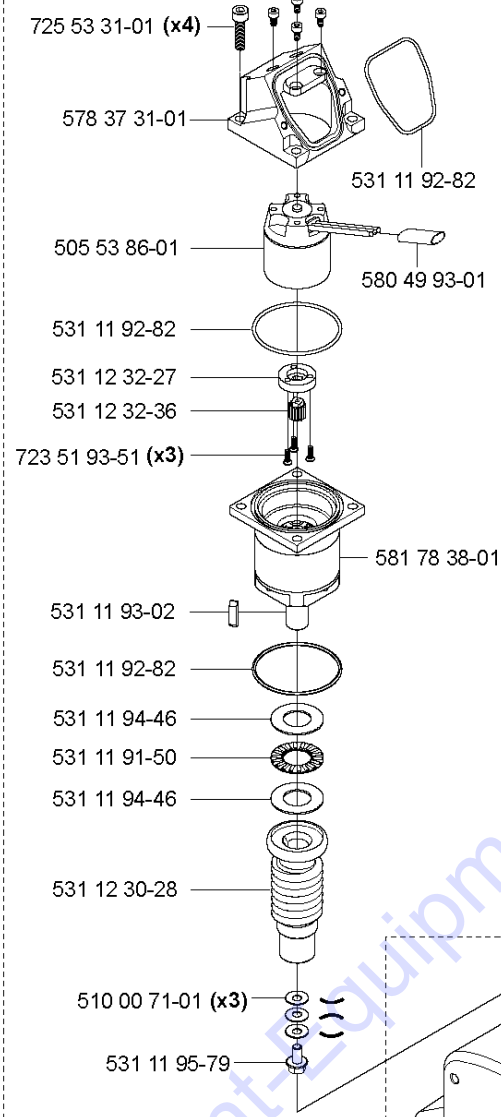

579 54 85-01 (x4) Arm feeding motor compl. 580 62 51-01

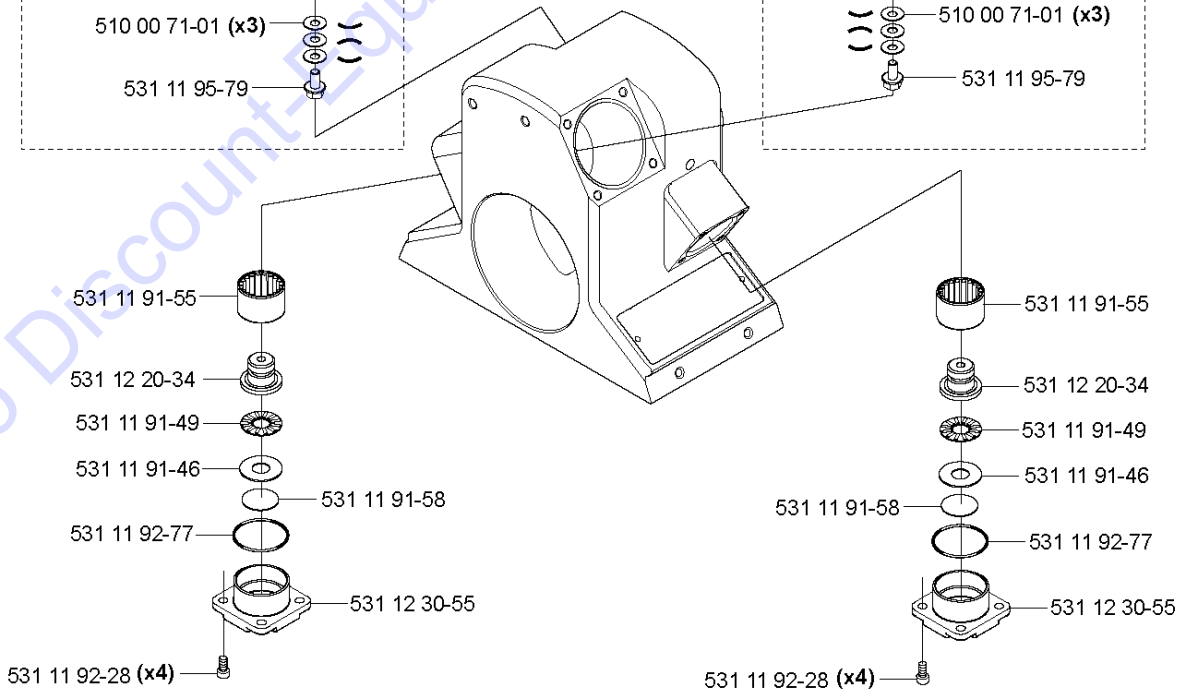
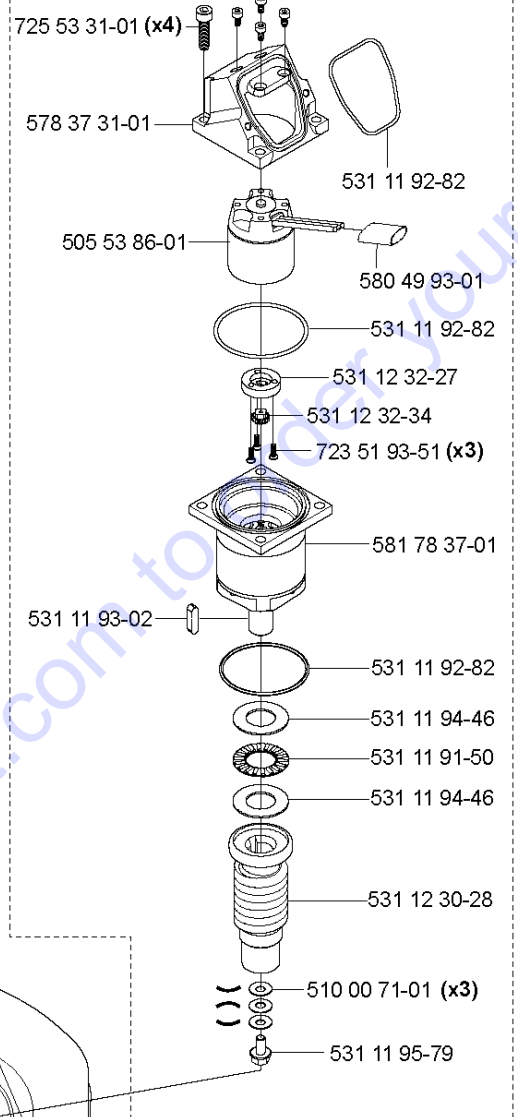

Go to Discount-Equipment.com to buy your parts

FEEDING MOTORS

WS482 HF, Valid from machine no. 1275, 2012-07

Part No	Description	Remark	QTY KIT
505 53 86-01	ELECTRIC BOX		
510 00 71-01	SPRING WASHER		
531 11 91-46	BEARING		
531 11 91-49	BEARING		
531 11 91-50	BEARING		
531 11 91-55	BEARING		
531 11 91-58	SHIM		
531 11 92-28	SCREW		
531 11 92-77	O-RING		
531 11 92-82	O-RING		
531 11 92-82	O-RING		1
531 11 93-02	KEY		
531 11 94-46	WASHER		
531 11 95-79	SCREW		
531 12 20-34	AXLE		
531 12 30-28	AUTOMATIC FEEDING SYSTEM		
531 12 30-55	BLOCK		
531 12 32-27	SHAFT		
531 12 32-34	GEAR WHEEL		
531 12 32-36	GEAR WHEEL		
578 37 31-01	MOTOR HOUSING		
579 54 85-01	SCREW		
580 49 93-01	HOSE KIT		
580 62 50-01	MOTOR ASSY		
580 62 51-01	MOTOR ASSY		
581 78 37-01	GEARBOX		
581 78 38-01	GEARBOX		
723 51 93-51	SCREW		
725 53 31-01	SCREW IHSCM		

Go to Discount-Equipment.com to order your parts

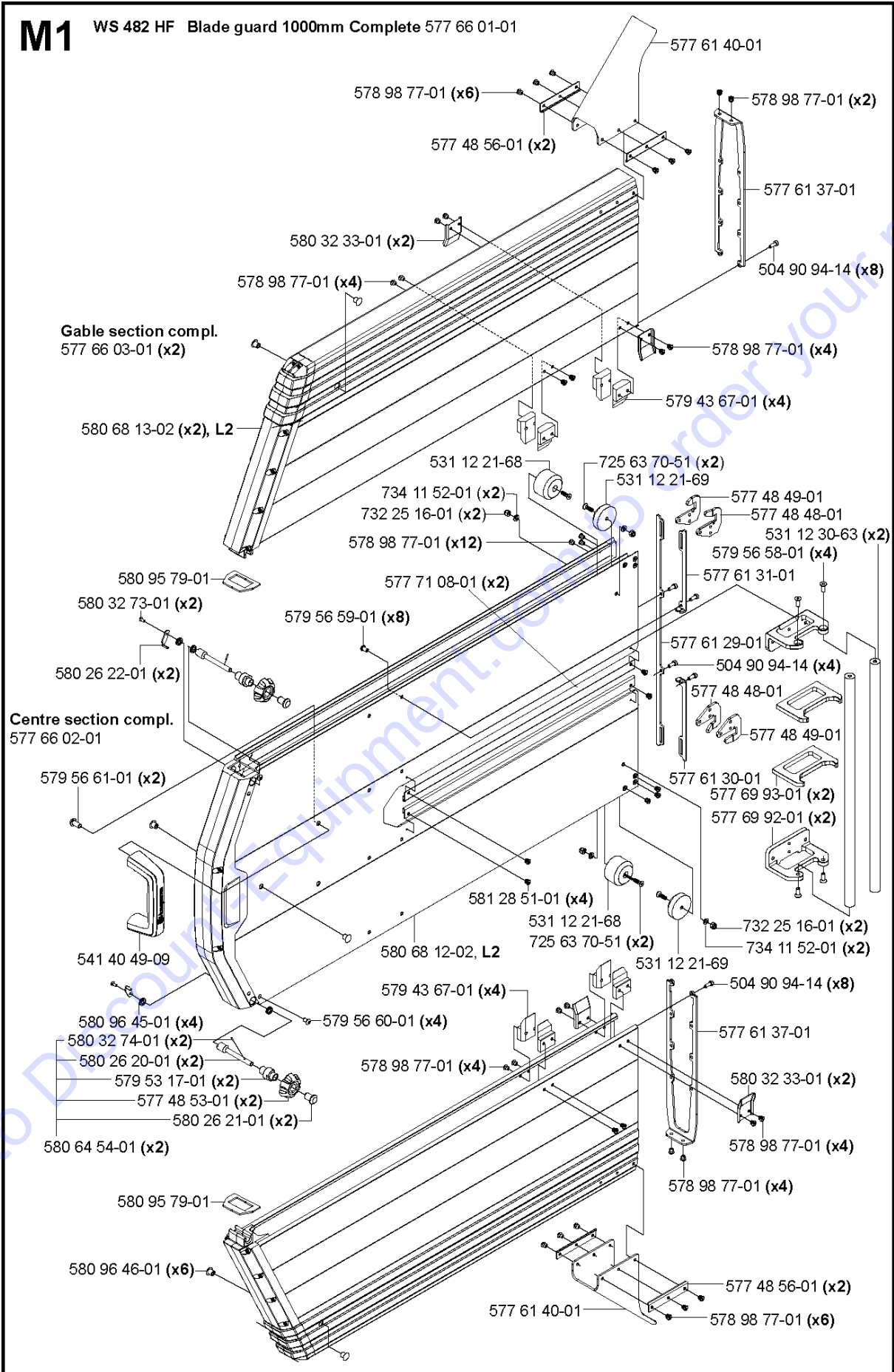

Part No	Description	Remark	QTY KIT
504 90 94-14	SCREW ITXSCT		
531 12 21-68	GUIDE		
531 12 21-69	GUIDE		
531 12 30-63	RAIL		
541 40 49-09	HANDLE		
577 48 48-01	HITCH		
577 48 49-01	HITCH		
577 48 53-01	KNOB		
577 48 56-01	WASHER		
577 61 29-01	LINK		
577 61 30-01	LINK		
577 61 31-01	LINK		
577 61 37-01	END COVER		
577 61 40-01	SPRAY GUARD		
577 66 01-01	BLADE GUARD		
577 66 02-01	BLADE GUARD		
577 66 03-01	GABLE		
577 69 92-01	FIXTURE		
577 69 93-01	FIXTURE		
577 71 08-01	GUIDE BAR		
578 98 77-01	RIVET		
579 43 67-01	GUIDE PLATE		
579 53 17-01	CONE		
579 56 58-01	SCREW		
579 56 59-01	SCREW		
579 56 60-01	SCREW		
579 56 61-01	SCREW		
580 26 20-01	SCREW		
580 26 21-01	NUT		
580 26 22-01	HOOK		
580 32 33-01	GUIDE		
580 32 73-01	SCREW		
580 32 74-01	PEN		
580 64 54-01	KNOB		
580 68 12-02	GUARD		
580 68 13-02	GUARD		
580 95 79-01	GASKET		1
580 96 45-01	V-RING		
580 96 46-01	RUBBER PLUG		
581 28 51-01	RIVET		
725 63 70-51	SCREW IHCSFM		
732 25 16-01	HEXAGON LOCKING NUT		
734 11 52-01	WASHER		

Go to DiscountEquipment.com to order your parts

M2 WS 482 HF Flush blade guard 1000mm complete 577 74 24-01

Gable section flush, RIGHT compl.
577 74 32-01

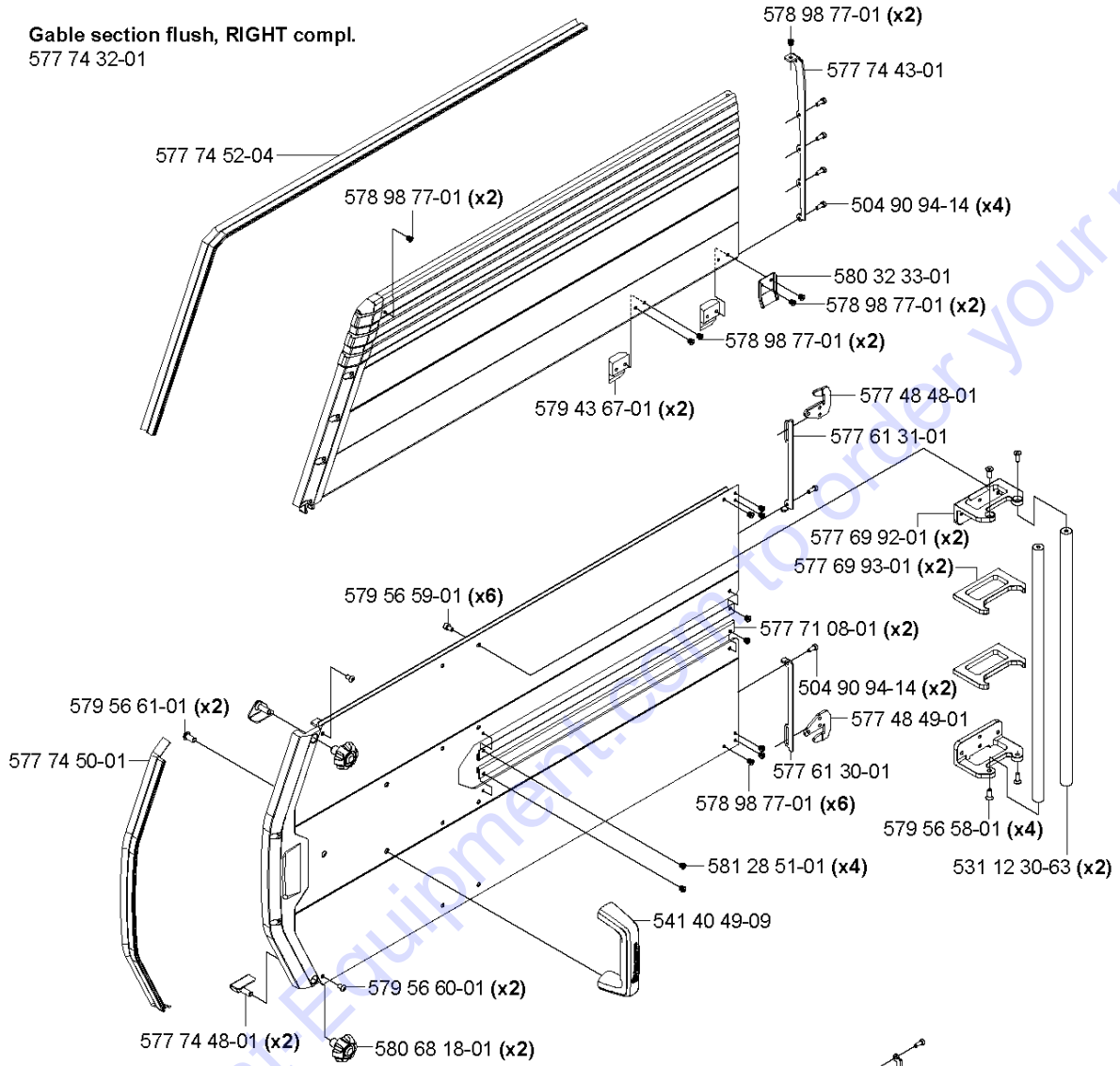

Centre section flush compl.
577 90 30-01

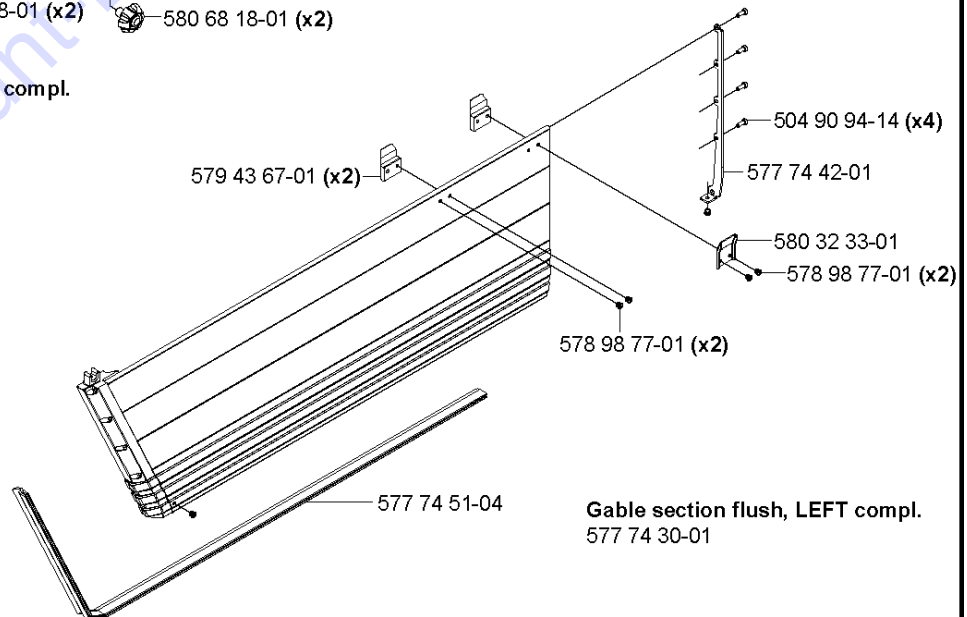

Gable section flush, LEFT compl.
577 74 30-01

Part No	Description	Remark	QTY KIT
504 90 94-14	SCREW ITXSCT		
531 12 30-63	RAIL		
541 40 49-09	HANDLE		
577 48 48-01	HITCH		
577 48 49-01	HITCH		
577 61 30-01	LINK		
577 61 31-01	LINK		
577 69 92-01	FIXTURE		
577 69 93-01	FIXTURE		
577 71 08-01	GUIDE BAR		
577 74 24-01	BLADE GUARD		
577 74 30-01	GABLE		
577 74 32-01	GABLE		
577 74 42-01	COVER		
577 74 43-01	COVER		
577 74 48-01	FRAME		
577 74 50-01	STRIP		
577 74 51-04	COVER		
577 74 52-04	COVER		
577 90 30-01	BLADE GUARD		
578 98 77-01	RIVET		
579 43 67-01	GUIDE PLATE		
579 56 58-01	SCREW		
579 56 59-01	SCREW		
579 56 60-01	SCREW		
579 56 61-01	SCREW		
580 32 33-01	GUIDE		1
580 68 12-02	GUARD		
580 68 18-01	KNOB		
580 95 79-01	GASKET		
581 28 51-01	RIVET		

Go to Discount-Equipment.com to order your parts

N3 WS 482 HF Flush blade guard 1200 mm 577 74 25-01

Gable section flush, RIGHT compl.
577 41 35-01

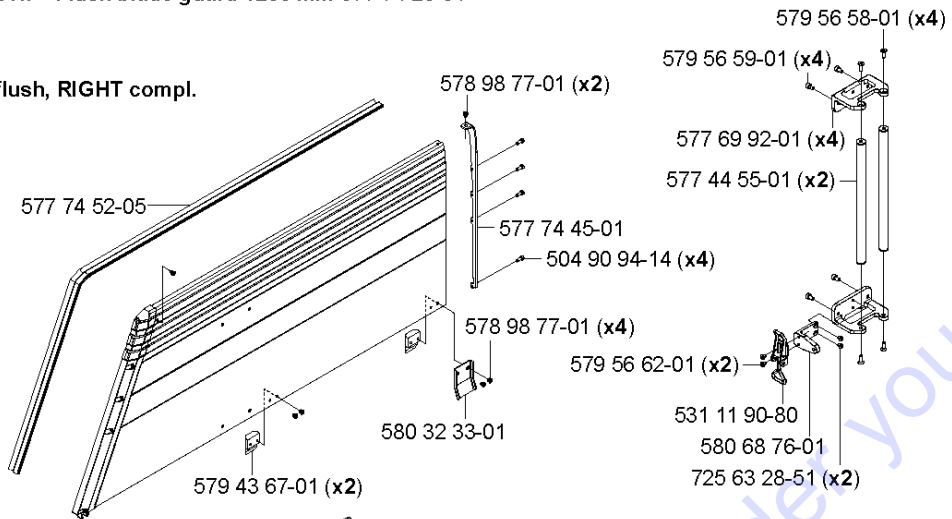

Centre section flush compl.
577 74 33-01

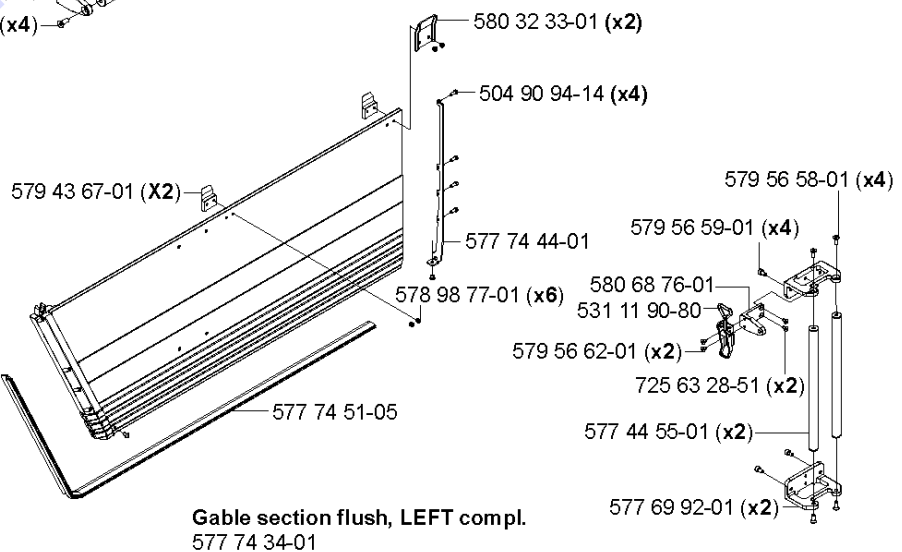
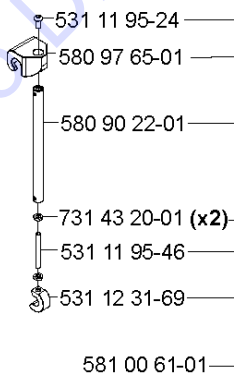
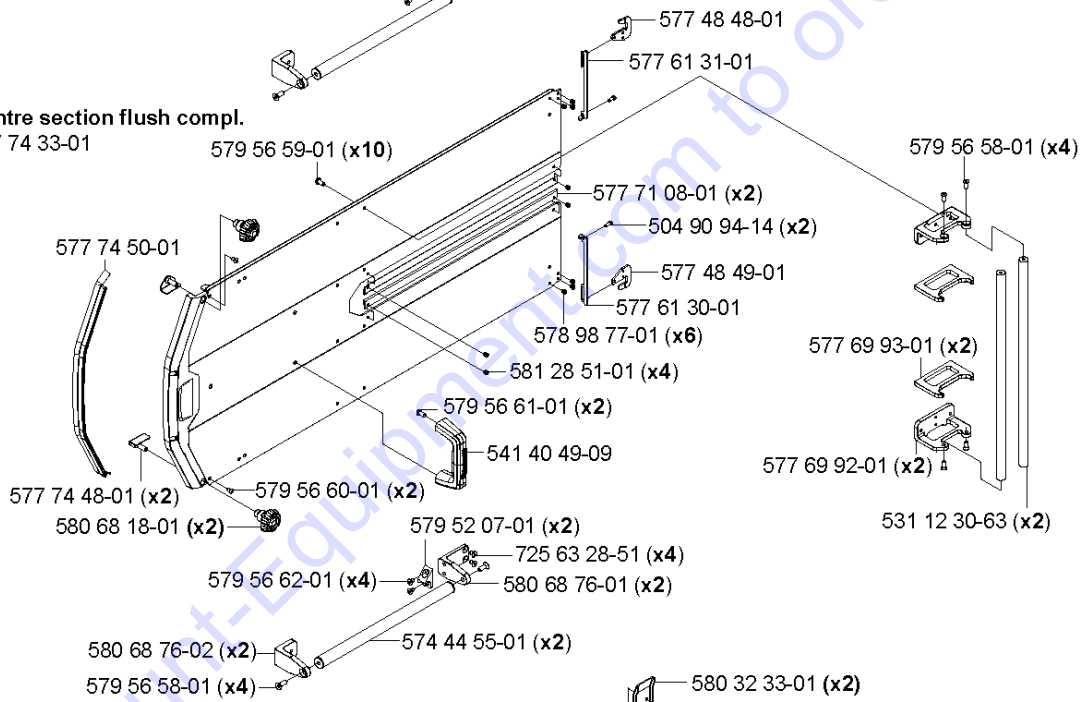

Gable section flush, LEFT compl.
577 74 34-01

Part No	Description	Remark	QTY KIT
504 90 94-14	SCREW ITXSCT		
531 11 90-80	SNAP LOCKING		
531 11 95-24	SCREW		
531 11 95-46	PIN		
531 12 30-63	RAIL		
531 12 31-69	CLAMP		
541 40 49-09	HANDLE		
574445501	MUFFLER ASSY		1
577 41 35-01	CONTROL		
577 44 55-01	GUIDE RAIL		
577 48 48-01	HITCH		
577 48 49-01	HITCH		
577 61 30-01	LINK		
577 61 31-01	LINK		
577 69 92-01	FIXTURE		
577 69 93-01	FIXTURE		
577 71 08-01	GUIDE BAR		
577 74 25-01	BLADE GUARD		
577 74 33-01	BLADE GUARD		
577 74 34-01	GABLE		
577 74 44-01	COVER		
577 74 45-01	COVER		
577 74 48-01	FRAME		
577 74 50-01	STRIP		
577 74 51-05	COVER		
577 74 52-05	COVER		
578 98 77-01	RIVET		
579 43 67-01	GUIDE PLATE		
579 52 07-01	HOOK		
579 56 58-01	SCREW		
579 56 59-01	SCREW		
579 56 60-01	SCREW		
579 56 61-01	SCREW		
579 56 62-01	SCREW		
580 32 33-01	GUIDE		
580 68 18-01	KNOB		
580 68 76-01	ANGLE BRACKET		
580 68 76-02	ANGLE BRACKET		
580 90 22-01	ARBOR SHAFT		
580 97 65-01	HOOK		
581 00 61-01	STRUT		
581 28 51-01	RIVET		
725 63 28-51	SCREW IHCSFM		
731 43 20-01	HEXAGON THIN NUT		

Go to Discount-Equipment.com to order your parts

N2 WS 482 HF Blade guard centre section 1200 mm

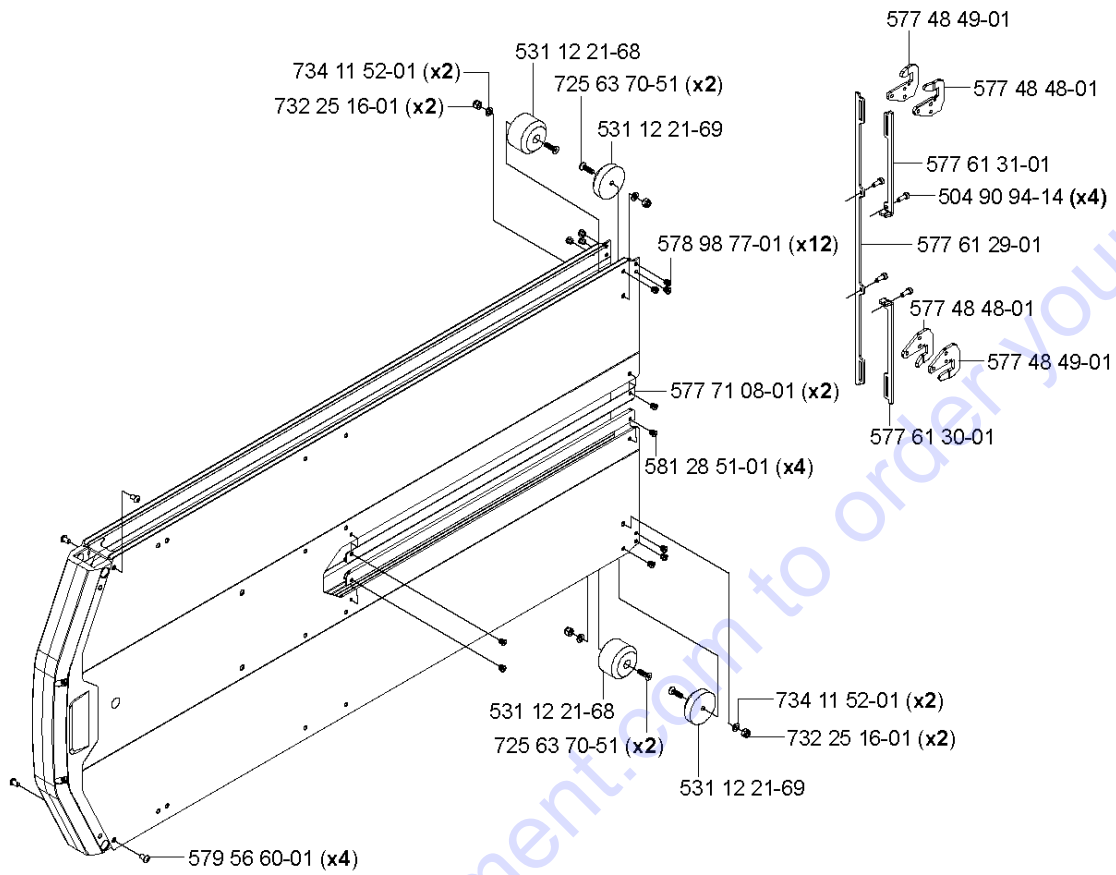

Blade guard gable section 1200 mm

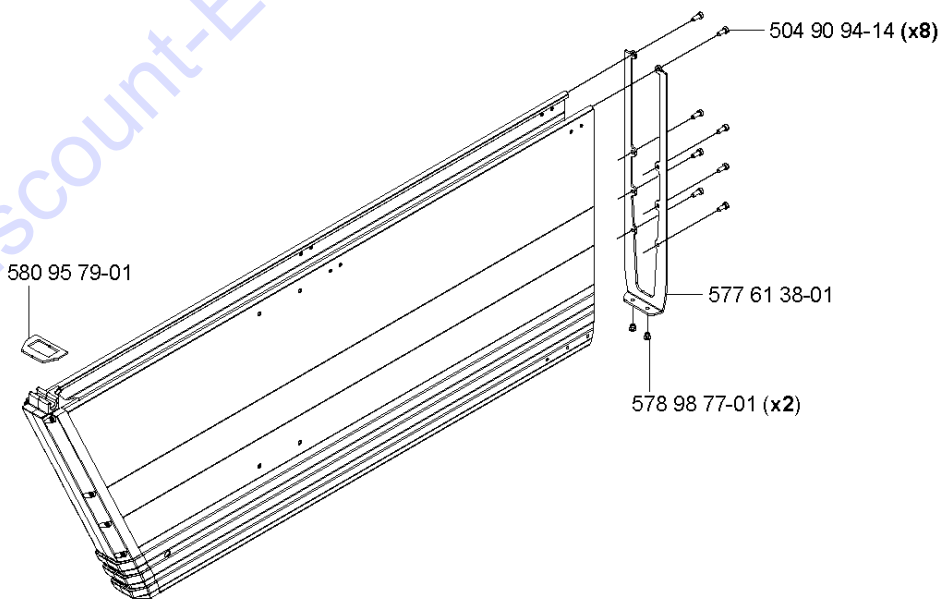

Part No	Description	Remark	QTY KIT
504 90 94-14	SCREW ITXSCT		
531 12 21-68	GUIDE		
531 12 21-69	GUIDE		
577 48 48-01	HITCH		
577 48 49-01	HITCH		
577 61 29-01	LINK		
577 61 30-01	LINK		
577 61 31-01	LINK		
577 61 38-01	COVER		
577 71 08-01	GUIDE BAR		
578 98 77-01	RIVET		1
579 56 60-01	SCREW		
580 95 79-01	GASKET		
581 28 51-01	RIVET		
725 63 70-51	SCREW IHCSFM		
732 25 16-01	HEXAGON LOCKING NUT		
734 11 52-01	WASHER		

Go to Discount-Equipment.com to order your parts

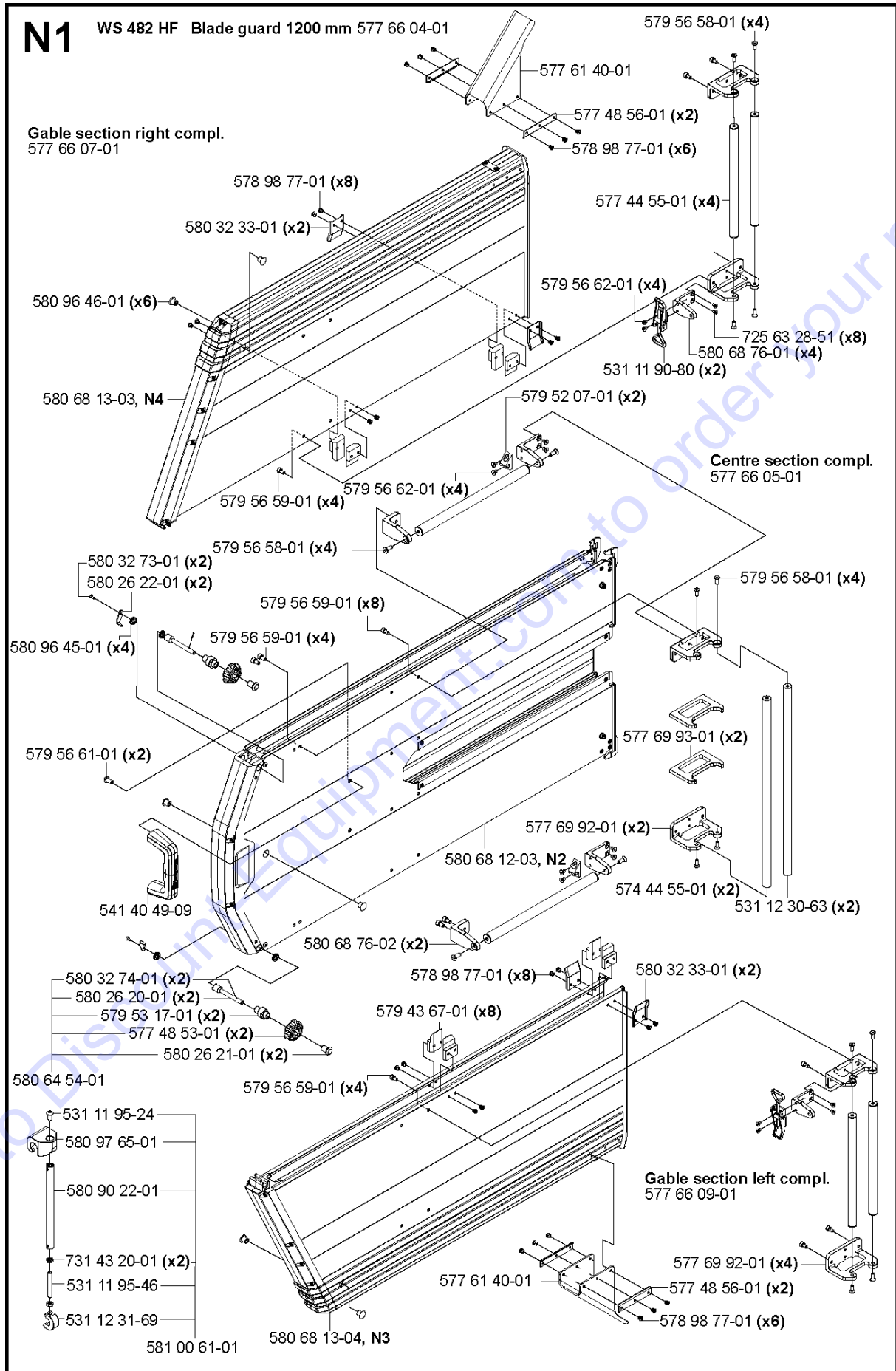

Part No	Description	Remark	QTY KIT
531 11 90-80	SNAP LOCKING		
531 11 95-24	SCREW		
531 11 95-46	PIN		
531 12 30-63	RAIL		
531 12 31-69	CLAMP		
541 40 49-09	HANDLE		
574445501	MUFFLER ASSY		1
577 44 55-01	GUIDE RAIL		
577 48 53-01	KNOB		
577 48 56-01	WASHER		
577 61 40-01	SPRAY GUARD		
577 66 04-01	BLADE GUARD		
577 66 04-01	BLADE GUARD		1
577 66 05-01	BLADE GUARD		
577 66 07-01	GABLE		
577 66 09-01	GABLE		
577 69 92-01	FIXTURE		
577 69 93-01	FIXTURE		
578 98 77-01	RIVET		
578 98 77-01	RIVET		1
579 43 67-01	GUIDE PLATE		
579 52 07-01	HOOK		
579 53 17-01	CONE		
579 56 58-01	SCREW		
579 56 59-01	SCREW		
579 56 61-01	SCREW		
579 56 62-01	SCREW		
580 26 20-01	SCREW		
580 26 21-01	NUT		
580 26 22-01	HOOK		
580 32 33-01	GUIDE		
580 32 73-01	SCREW		
580 32 74-01	PEN		
580 64 54-01	KNOB		
580 68 76-01	ANGLE BRACKET		
580 68 76-02	ANGLE BRACKET		
580 90 22-01	ARBOR SHAFT		
580 96 45-01	V-RING		
580 96 46-01	RUBBER PLUG		
580 97 65-01	HOOK		
581 00 61-01	STRUT		
725 63 28-51	SCREW IHCSFM		
731 43 20-01	HEXAGON THIN NUT		

Go to DiscountEquipment.com to order your parts

O2 WS 482 HF Blade guard centre section 1600 mm

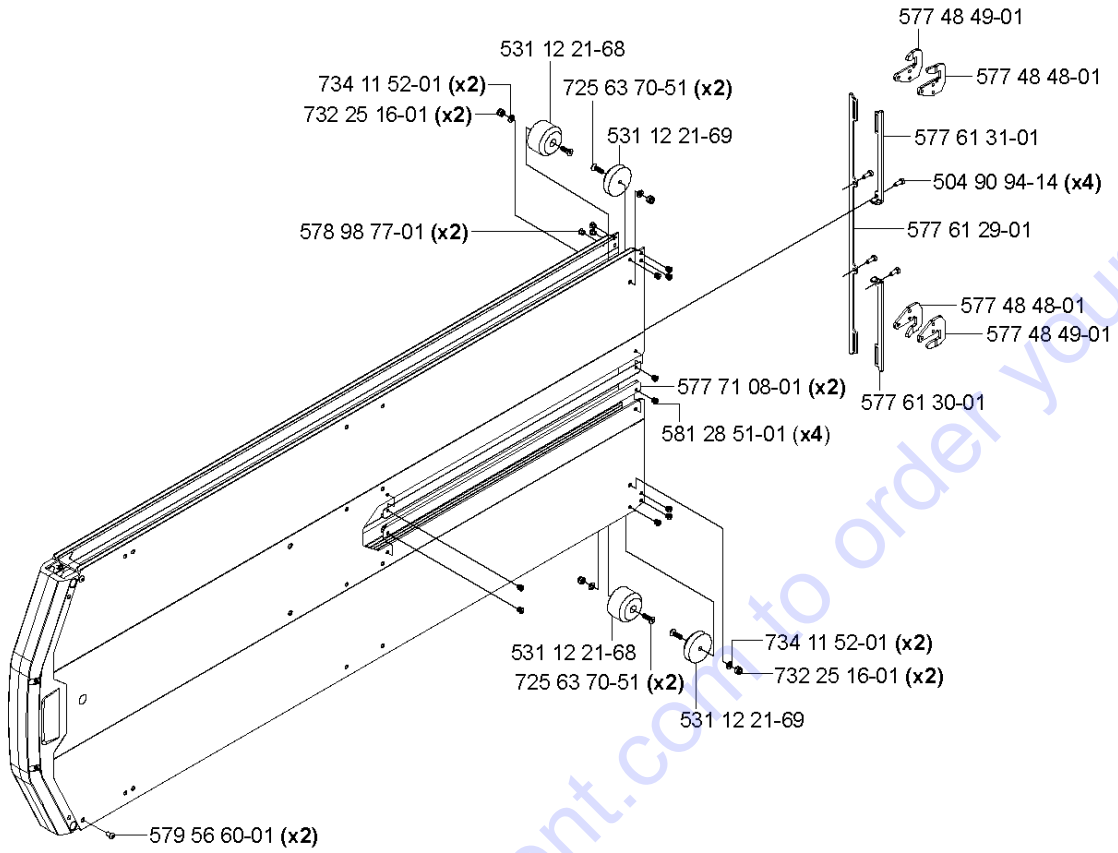

Blade guard gable section 1600 mm

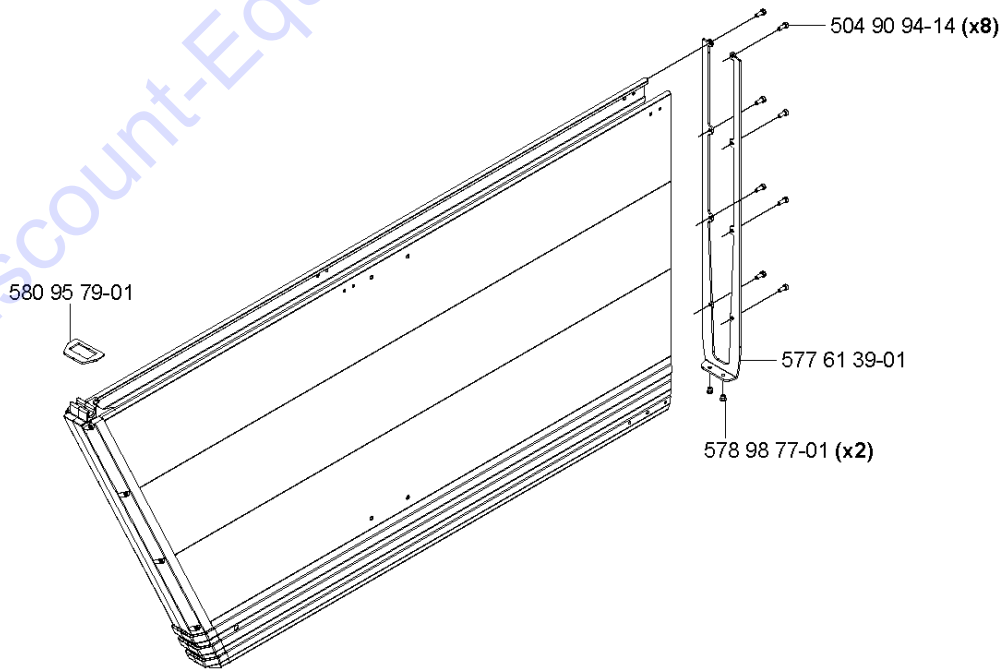

Part No	Description	Remark	QTY KIT
504 90 94-14	SCREW ITXSCT		
531 12 21-68	GUIDE		
531 12 21-69	GUIDE		
577 48 48-01	HITCH		
577 48 49-01	HITCH		
577 61 29-01	LINK		
577 61 30-01	LINK		
577 61 31-01	LINK		
577 61 39-01	COVER		
577 71 08-01	GUIDE BAR		
578 98 77-01	RIVET		1
579 56 60-01	SCREW		
580 95 79-01	GASKET		
581 28 51-01	RIVET		
725 63 70-51	SCREW IHCSFM		
732 25 16-01	HEXAGON LOCKING NUT		
734 11 52-01	WASHER		

Go to Discount-Equipment.com to order your parts

O3

WS 482 HF Flush blade guard 1600 mm 577 74 26-01

Gable section flush, RIGHT compl.
577 74 37-01

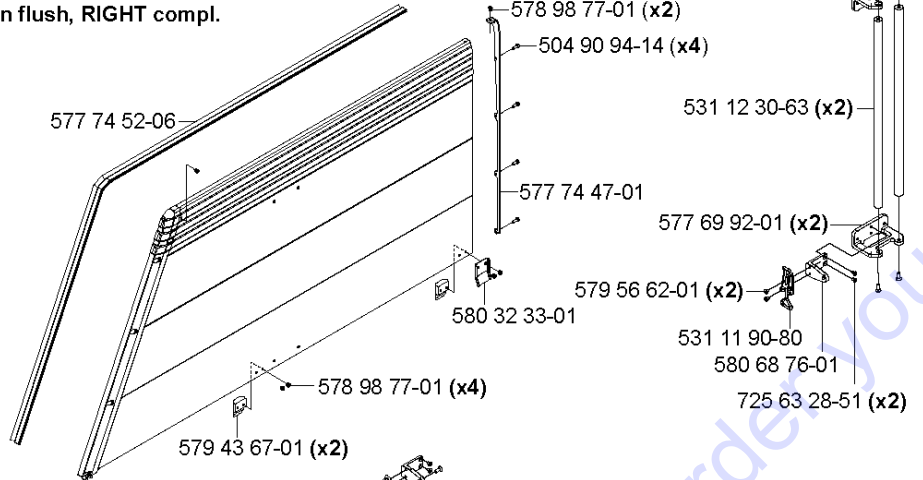

Centre section flush compl.
577 90 31-01

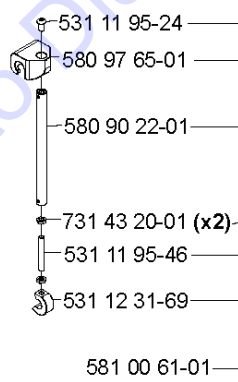
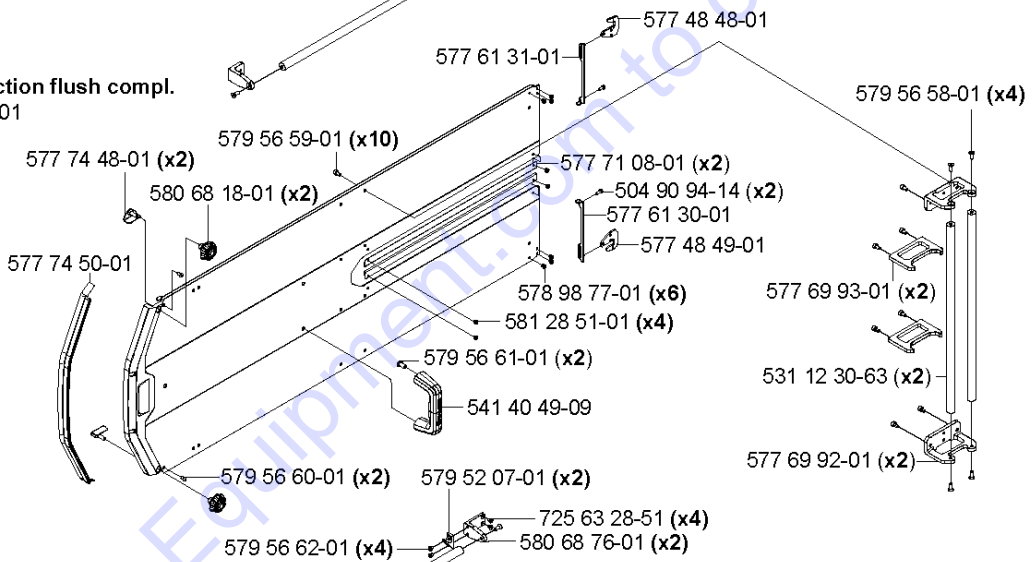

Gable section flush, LEFT compl.
577 74 36-01

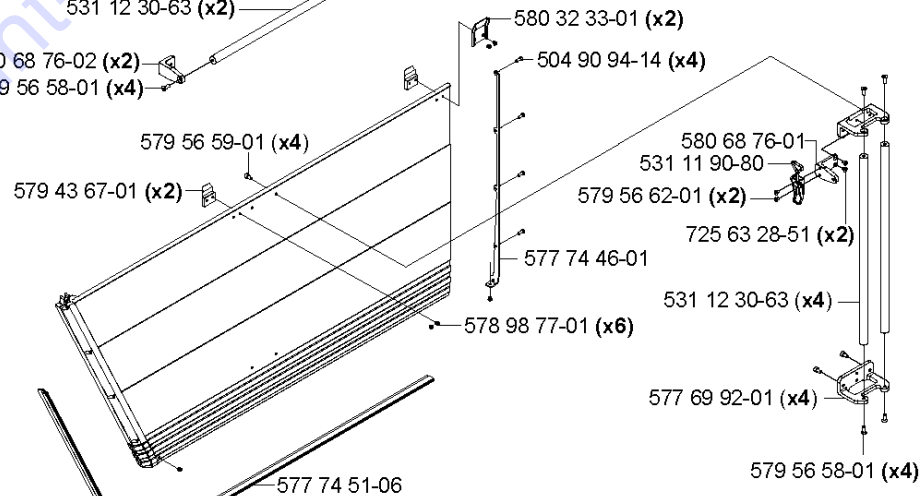

Part No	Description	Remark	QTY KIT
504 90 94-14	SCREW ITXSCT		
531 11 90-80	SNAP LOCKING		
531 11 95-24	SCREW		
531 11 95-46	PIN		
531 12 30-63	RAIL		
531 12 31-69	CLAMP		
541 40 49-09	HANDLE		
577 48 48-01	HITCH		
577 48 49-01	HITCH		
577 61 30-01	LINK		
577 61 31-01	LINK		
577 69 92-01	FIXTURE		
577 69 93-01	FIXTURE		
577 71 08-01	GUIDE BAR		
577 74 26-01	BLADE GUARD		
577 74 36-01	GABLE		
577 74 37-01	GABLE		
577 74 46-01	COVER		
577 74 47-01	COVER		
577 74 48-01	FRAME		
577 74 50-01	STRIP		
577 74 51-06	COVER		
577 74 52-06	COVER		
577 90 31-01	BLADE GUARD		
578 98 77-01	RIVET		
579 43 67-01	GUIDE PLATE		
579 52 07-01	HOOK		
579 56 58-01	SCREW		
579 56 59-01	SCREW		
579 56 60-01	SCREW		
579 56 61-01	SCREW		
579 56 62-01	SCREW		
580 32 33-01	GUIDE		
580 68 18-01	KNOB		
580 68 76-01	ANGLE BRACKET		
580 68 76-02	ANGLE BRACKET		
580 90 22-01	ARBOR SHAFT		
580 97 65-01	HOOK		
581 00 61-01	STRUT		
581 28 51-01	RIVET		
725 63 28-51	SCREW IHCSFM		
731 43 20-01	HEXAGON THIN NUT		

Go to DiscountEquipment.com to order your parts

01 WS 482 HF Blade guard 1600 mm 577 66 10-01

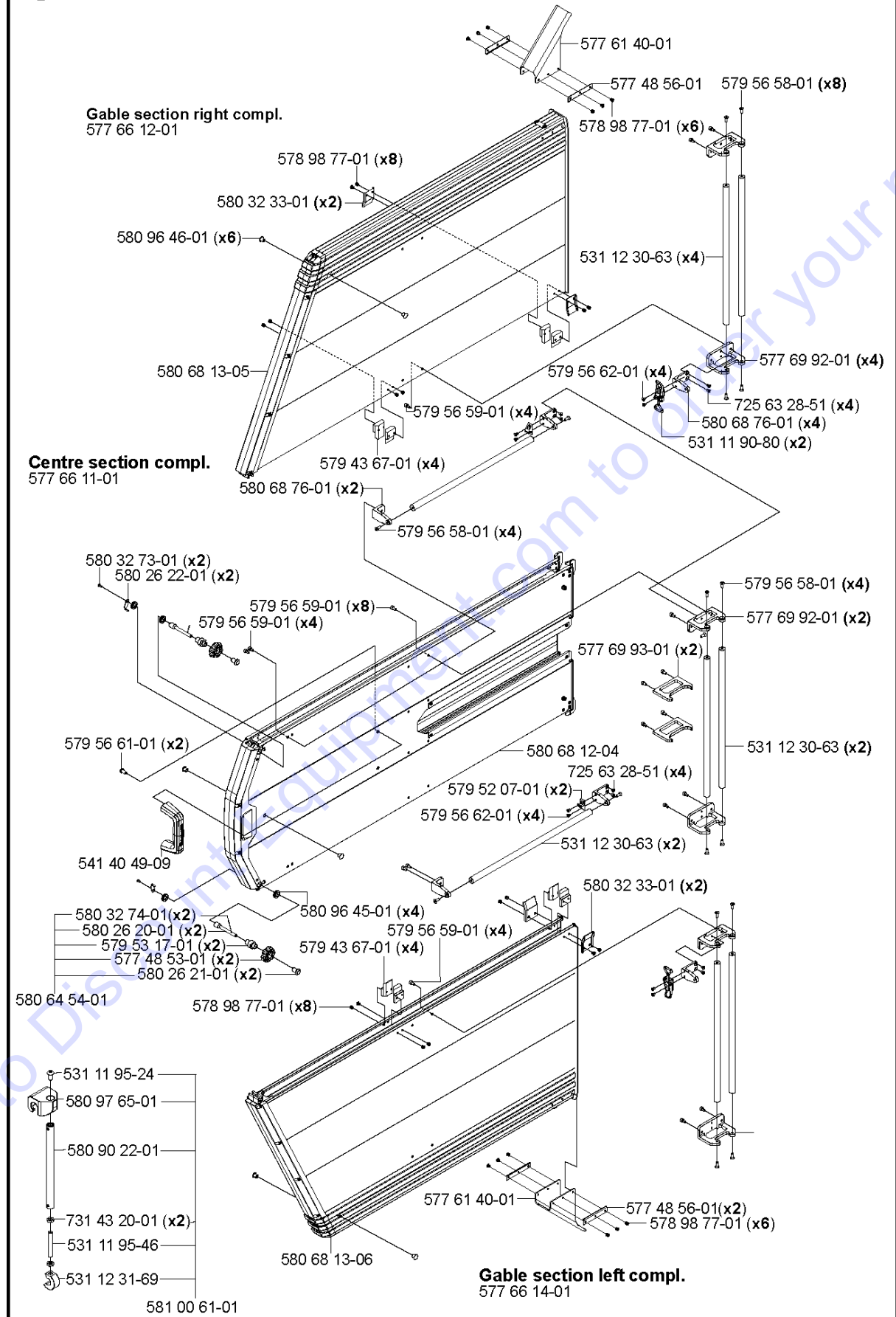

Part No	Description	Remark	QTY KIT
531 11 90-80	SNAP LOCKING		
531 11 95-24	SCREW		
531 11 95-46	PIN		
531 12 30-63	RAIL		
531 12 31-69	CLAMP		
541 40 49-09	HANDLE		
577 48 53-01	KNOB		
577 48 56-01	WASHER		
577 61 40-01	SPRAY GUARD		
577 66 10-01	BLADE GUARD		
577 66 11-01	BLADE GUARD		
577 66 12-01	GABLE		
577 66 14-01	GABLE		
577 69 92-01	FIXTURE		
577 69 93-01	FIXTURE		
578 98 77-01	RIVET		
579 43 67-01	GUIDE PLATE		
579 52 07-01	HOOK		
579 53 17-01	CONE		
579 56 58-01	SCREW		
579 56 59-01	SCREW		
579 56 59-01	SCREW		1
579 56 61-01	SCREW		
579 56 62-01	SCREW		
579 56 62-01	SCREW		1
580 26 20-01	SCREW		
580 26 21-01	NUT		
580 26 22-01	HOOK		
580 32 33-01	GUIDE		
580 32 73-01	SCREW		
580 32 74-01	PEN		
580 64 54-01	KNOB		
580 68 13-05	GUARD		
580 68 76-01	ANGLE BRACKET		
580 68 76-02	ANGLE BRACKET		
580 90 22-01	ARBOR SHAFT		
580 96 45-01	V-RING		
580 96 46-01	RUBBER PLUG		
580 97 65-01	HOOK		
581 00 61-01	STRUT		
725 63 28-51	SCREW IHCSFM		
731 43 20-01	HEXAGON THIN NUT		

Go to DiscountEquipment.com to order your parts

L2 WS 482 HF Flush blade guard 800mm complete 577 74 23-01

Gable section flush, RIGHT compl.
577 74 29-01

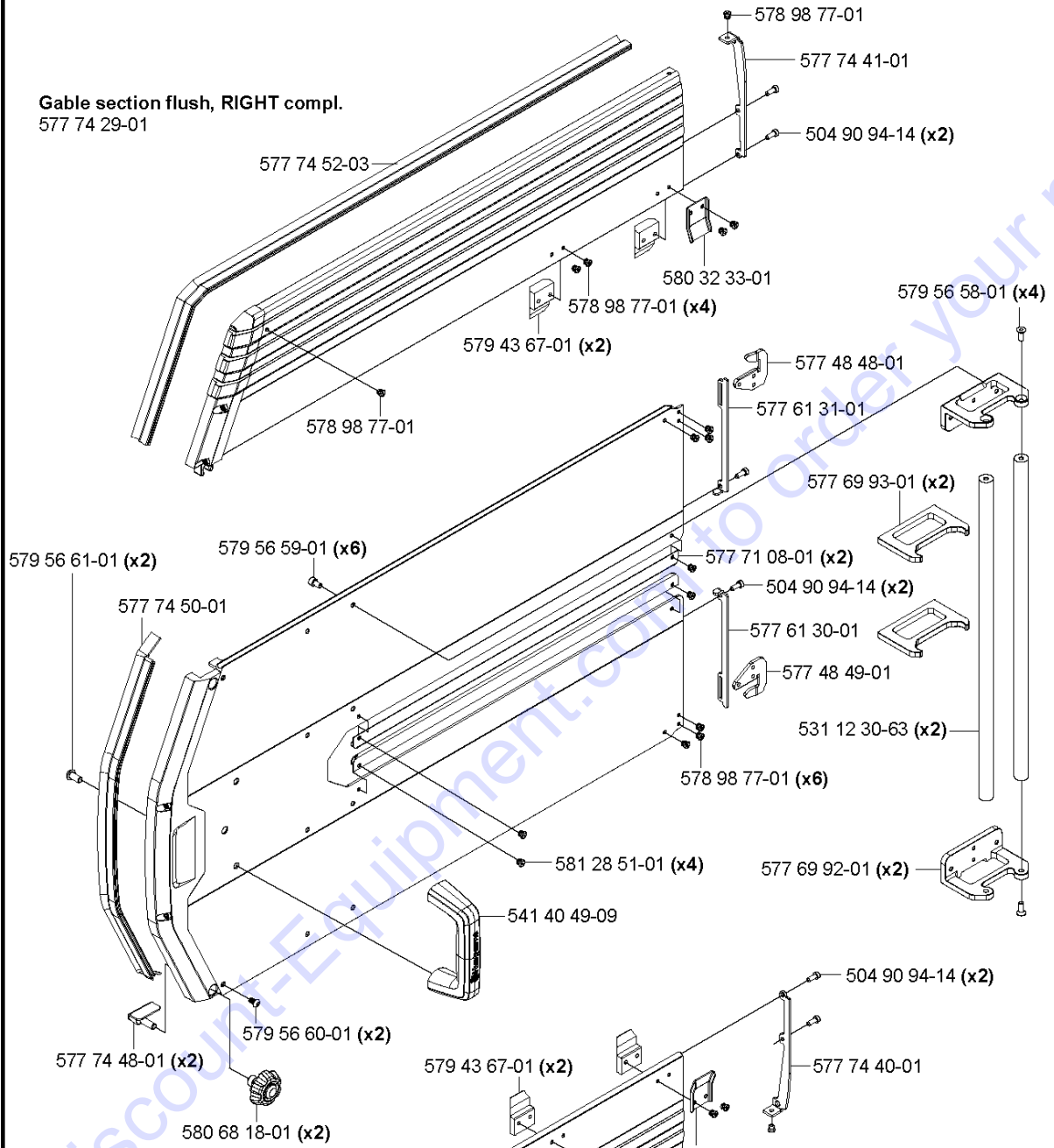

Centre section flush compl.
577 74 27-01

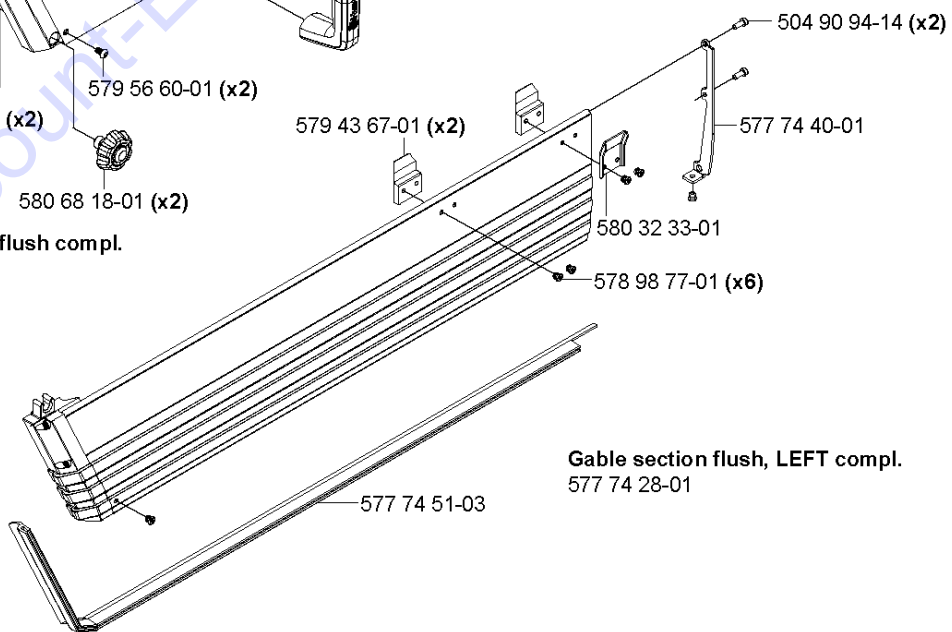

Gable section flush, LEFT compl.
577 74 28-01

Part No	Description	Remark	QTY KIT
504 90 94-14	SCREW ITXSCT		
531 12 30-63	RAIL		
541 40 49-09	HANDLE		
577 48 48-01	HITCH		
577 48 49-01	HITCH		
577 61 30-01	LINK		
577 61 31-01	LINK		
577 69 92-01	FIXTURE		
577 69 93-01	FIXTURE		
577 71 08-01	GUIDE BAR		
577 74 23-01	BLADE GUARD		
577 74 27-01	BLADE GUARD		
577 74 28-01	GABLE		
577 74 29-01	GABLE		
577 74 40-01	COVER		
577 74 41-01	COVER		
577 74 48-01	FRAME		
577 74 50-01	STRIP		
577 74 51-03	COVER		
577 74 52-03	COVER		
578 98 77-01	RIVET		
579 43 67-01	GUIDE PLATE		
579 56 58-01	SCREW		
579 56 59-01	SCREW		
579 56 60-01	SCREW		
579 56 61-01	SCREW		
580 32 33-01	GUIDE		
580 68 18-01	KNOB		
581 28 51-01	RIVET		

Go to Discount-Equipment.com to order your parts

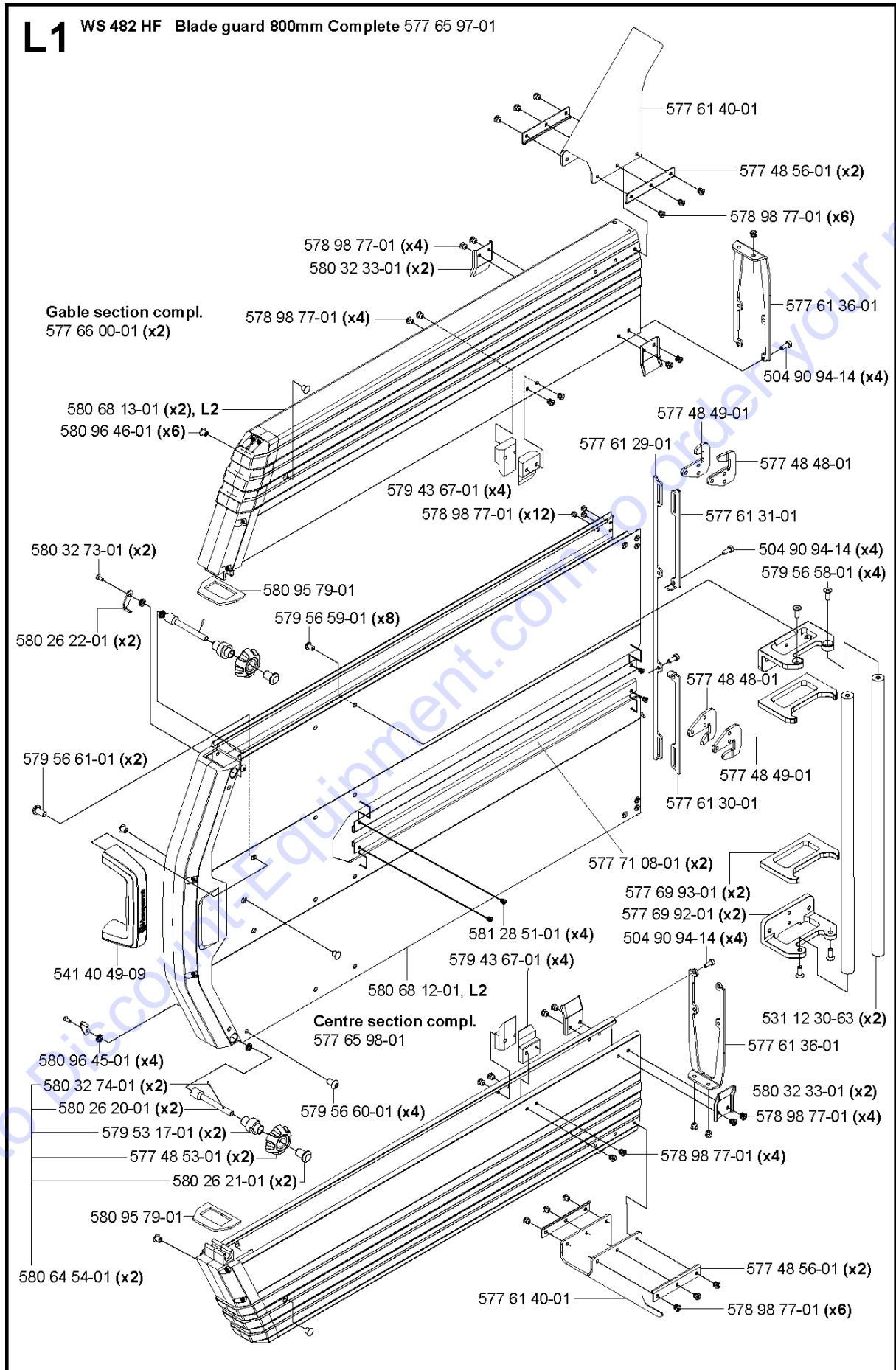

Part No	Description	Remark	QTY KIT
504 90 94-14	SCREW ITXSCT		
531 12 30-63	RAIL		
541 40 49-09	HANDLE		
577 48 48-01	HITCH		
577 48 49-01	HITCH		
577 48 53-01	KNOB		
577 48 56-01	WASHER		
577 61 29-01	LINK		
577 61 30-01	LINK		
577 61 31-01	LINK		
577 61 36-01	END COVER		
577 61 40-01	SPRAY GUARD		
577 65 97-01	BLADE GUARD		
577 65 98-01	BLADE GUARD		
577 66 00-01	GABLE		
577 69 92-01	FIXTURE		
577 69 93-01	FIXTURE		
577 71 08-01	GUIDE BAR		
578 98 77-01	RIVET		
579 43 67-01	GUIDE PLATE		
579 53 17-01	CONE		
579 56 58-01	SCREW		
579 56 59-01	SCREW		
579 56 60-01	SCREW		
579 56 61-01	SCREW		
580 26 20-01	SCREW		
580 26 21-01	NUT		
580 26 22-01	HOOK		
580 32 33-01	GUIDE		
580 32 73-01	SCREW		
580 32 74-01	PEN		
580 64 54-01	KNOB		
580 68 12-01	GUIDE BAR		
580 68 13-01	GUARD		
580 95 79-01	GASKET		
580 96 45-01	V-RING		
580 96 46-01	RUBBER PLUG		
581 28 51-01	RIVET		

Go to Discount-Equipment.com to order your parts

Q

WS 482 HF

Water hose 8m 505 11 53-01

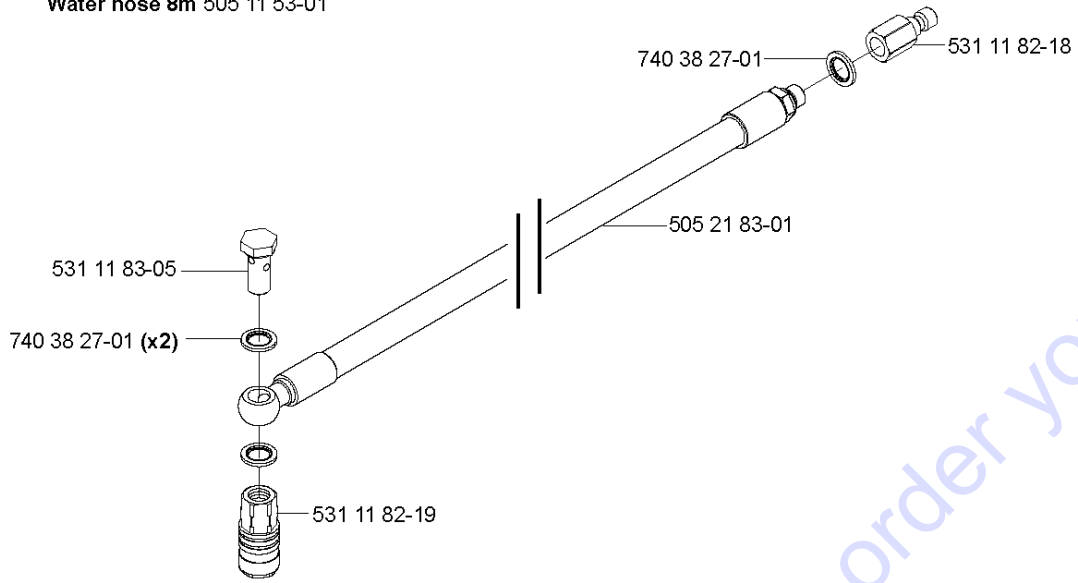

Water hose 1m 505 21 84-01

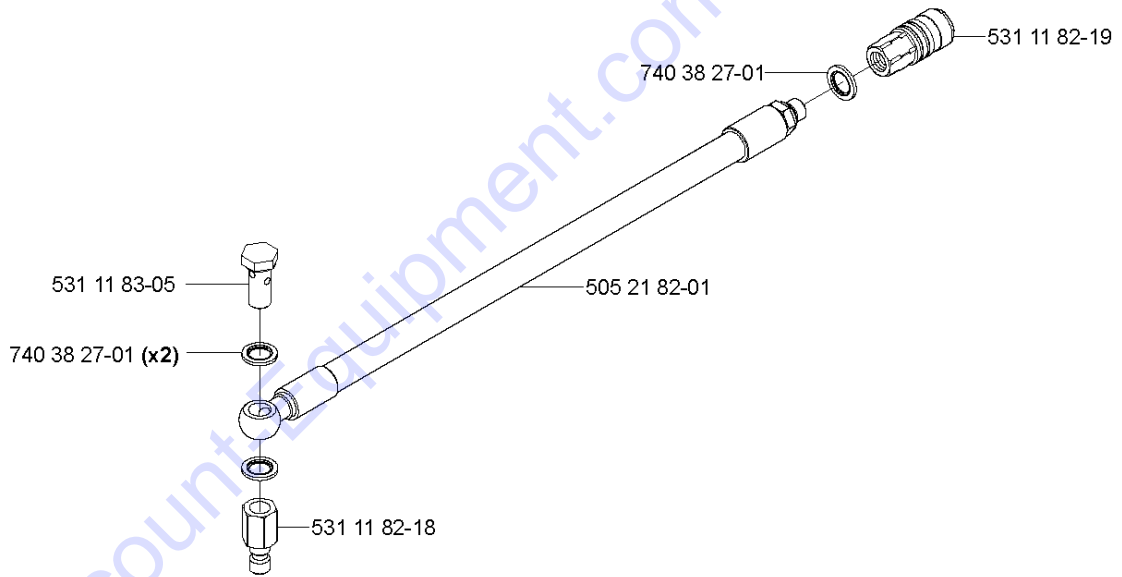

Cleaning brush complete 531 11 32-68

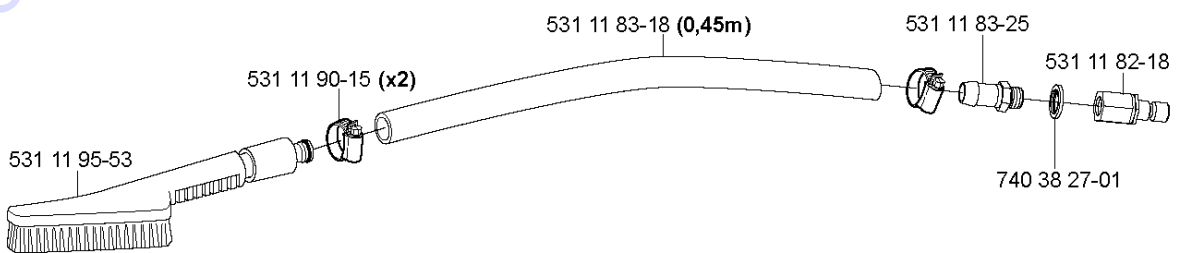

HOSE

WS482 HF, Valid from machine no. 1275, 2012-07

Part No	Description	Remark	QTY KIT
505 11 53-01	HOSE		
505 21 82-01	HOSE		
505 21 83-01	HOSE		
505 21 84-01	HOSE		
531 11 32-68	BRUSH		
531 11 82-18	QUICK COUPLING		
531 11 82-19	QUICK COUPLING		
531 11 83-05	SCREW		
531 11 83-18	HOSE KIT		
531 11 83-25	NIPPLE		
531 11 90-15	CLAMP		
531 11 95-53	BRUSH		
740 38 27-01	SEALING WASHER		

Go to Discount-Equipment.com to order your parts

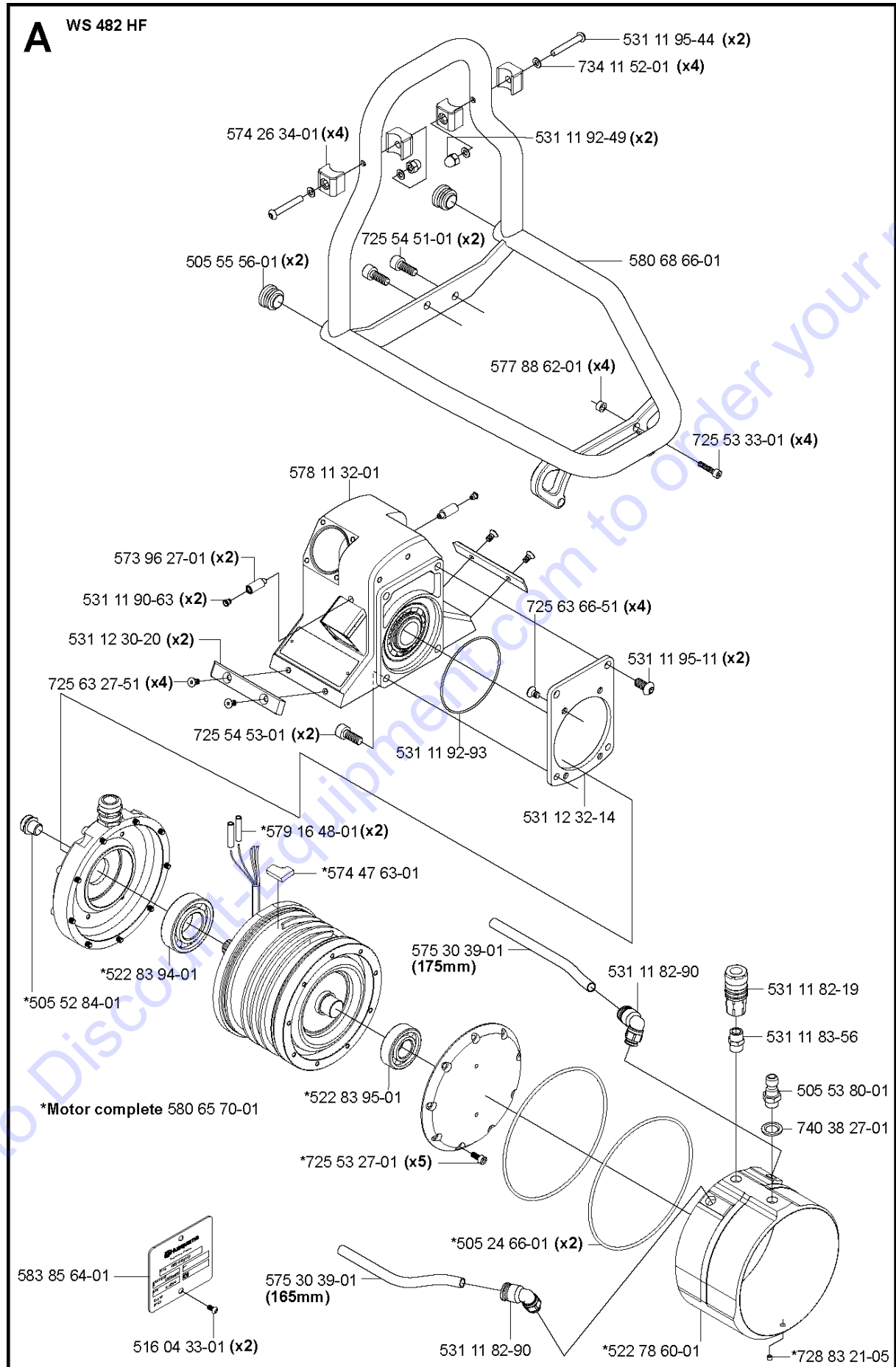

HOUSING

WS482 HF, Valid from machine no. 1275, 2012-07

Part No	Description	Remark	QTY KIT
505 24 66-01	O-RING		
505 52 84-01	VALVE		
505 53 80-01	QUICK COUPLING		
505 55 56-01	PLUG		
514 04 33-01	HANDLE		
516 04 33-01	SCREW		1
522 78 60-01	TUBE		
522 83 94-01	BEARING		
522 83 95-01	BEARING		
531 11 82-19	QUICK COUPLING		
531 11 82-90	COUPLING		
531 11 83-56	ADAPTER		
531 11 90-63	NIPPLE		
531 11 92-49	CAP NUT		
531 11 92-93	O-RING		
531 11 95-11	SCREW		
531 11 95-44	SCREW		
531 12 30-20	PLATE		
531 12 32-14	MOUNTING PLATE		
573 96 27-01	SPACING BLOCK		
574 26 34-01	BLOCK		
574 47 63-01	WATER SEPARATOR		
575 30 39-01	TUBE		
577 88 62-01	SPACER		
578 11 32-01	HOUSING		
579 16 48-01	CONNECTOR		
580 65 70-01	MOTOR ASSY		
580 68 66-01	HANDLE		
583 85 64-01	TYPE PLATE		
725 53 27-01	SCREW IHSCM		
725 53 33-01	SCREW IHSCM		
725 54 51-01	SCREW IHSCM		
725 54 53-01	SCREW IHSCM		
725 63 27-51	SCREW IHCSFM		
725 63 66-51	SCREW IHCSFM		
728 83 21-05	SCREW IHSETM		
734 11 52-01	WASHER		
740 38 27-01	SEALING WASHER		

Go to Discount-Equipment.com to order your parts

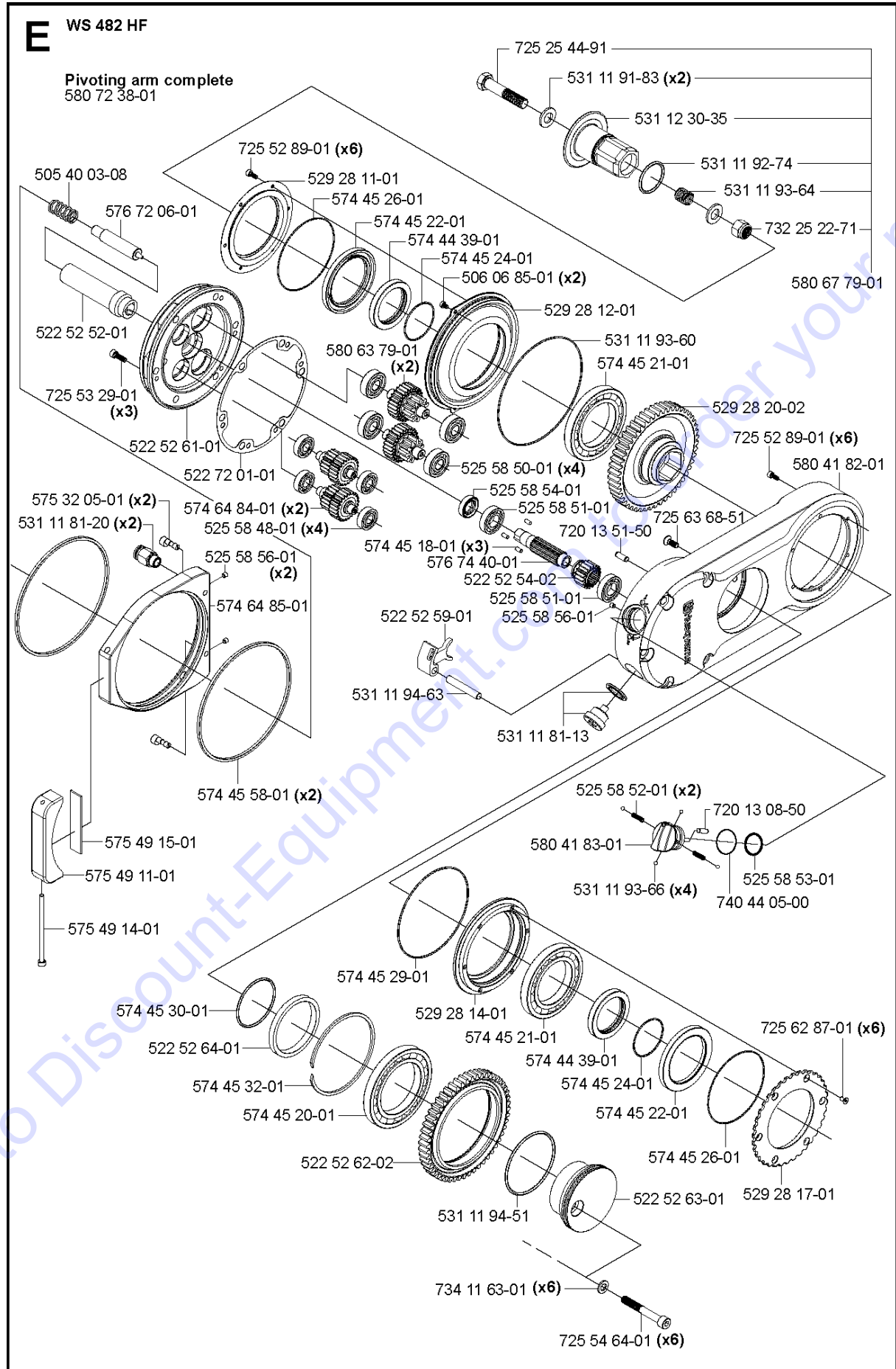

PIVOTING ARM

WS482 HF, Valid from machine no. 1275, 2012-07

Ref	Part No	Description	Remark	QTY KIT
505 40 03-08	505 40 03-08	CASE		
506 06 85-01	506 06 85-01	SCREW		
522 52 52-01	522 52 52-01	SHAFT ASSY		
522 52 54-02	522 52 54-01	GEAR WHEEL SHAFT		
522 52 59-01	522 52 59-01	GEARSHIFT LEVER		
522 52 61-01	522 52 61-01	GEAR		
522 52 62-02	522 52 62-02	DRIVER		
522 52 63-01	522 52 63-01	MANIFOLD		
522 52 64-01	522 52 64-01	INTERLAYER		
522 72 01-01	522 72 01-01	GASKET		
525 58 48-01	525 58 48-01	BEARING		
525 58 50-01	525 58 50-01	BEARING		
525 58 51-01	525 58 51-01	BEARING		
525 58 52-01	525 58 52-01	SPRING		
525 58 53-01	525 58 53-01	O-RING		
525 58 54-01	525 58 54-01	RADIAL SEAL		
525 58 56-01	525 58 56-01	SCREW		
529 28 11-01	529 28 11-01	REAR COVER		
529 28 12-01	529 28 12-01	BEARING COVER		
529 28 14-01	529 28 14-01	BEARING CAGE		
529 28 17-01	529 28 17-01	LID		
529 28 20-02	529 28 20-01	GEAR WHEEL		
531 11 81-13	531 11 81-13	PLUG		
531 11 81-20	531 11 81-20	COUPLING		
531 11 91-83	531 11 91-83	WASHER		
531 11 92-74	531 11 92-74	O-RING		
531 11 93-60	531 11 93-60	O-RING		
531 11 93-64	531 11 93-64	SPRING		
531 11 93-66	531 11 93-66	BALL		
531 11 94-51	531 11 94-51	O-RING		
531 11 94-63	531 11 94-63	PIN		
531 12 30-35	531 12 30-35	SHAFT		
574 44 39-01	574 44 39-01	RING		
574 45 18-01	574 45 18-01	PEN		
574 45 20-01	574 45 20-01	BEARING		
574 45 21-01	574 45 21-01	BEARING		
574 45 22-01	574 45 22-01	SEAL		
574 45 24-01	574 45 24-01	O-RING		
574 45 26-01	574 45 26-01	O-RING		
574 45 29-01	574 45 29-01	O-RING		
574 45 30-01	574 45 30-01	O-RING		
574 45 32-01	574 45 32-01	SNAP RING		
574 45 58-01	574 45 58-01	RADIAL SEAL		
574 64 84-01	574 64 84-01	GEAR ASSY		
574 64 85-01	574 64 85-01	COOLING AIR CONDUCTOR		
575 32 05-01	575 32 05-01	ADJUSTMENT DEVICE		
575 49 11-01	575 49 11-01	PROTECTOR BAR		
575 49 14-01	575 49 14-01	SCREW		
575 49 15-01	575 49 15-01	DAMPER		
576 72 06-01	576 72 06-01	SPACER		
576 74 40-01	576 74 40-01	GEAR WHEEL SHAFT		
580 41 82-01	580 41 82-01	PIVOTING ARM		
580 41 83-01	580 41 83-01	KNOB		
580 63 79-01	580 63 79-01	GEAR ASSY		
580 67 79-01	580 67 79-01	SHAFT ASSY		
580 72 38-01	580 72 38-01	PIVOTING ARM		
720 13 08-50	720 13 08-50	PARALLEL PIN		
720 13 51-50	720 13 51-50	PARALLEL PIN		
725 25 44-91	725 25 44-91	SCREW EHHM		
725 52 89-01	725 52 89-01	SCREW IHSCM		
725 53 29-01	725 53 29-01	SCREW IHSCM		
725 54 64-01	725 54 64-01	SCREW IHSCM		
725 62 87-01	725 62 87-01	SCREW IHCSFM		
725 63 68-51	725 63 68-51	SCREW IHCSFM		
732 25 22-71	732 25 22-71	HEXAGON LOCKING NUT		
734 11 63-01	734 11 63-01	WASHER		
740 44 05-00	740 44 05-00	O-RING		

G WS 482 HF Saw carriage 400 complete 505 22 69-03

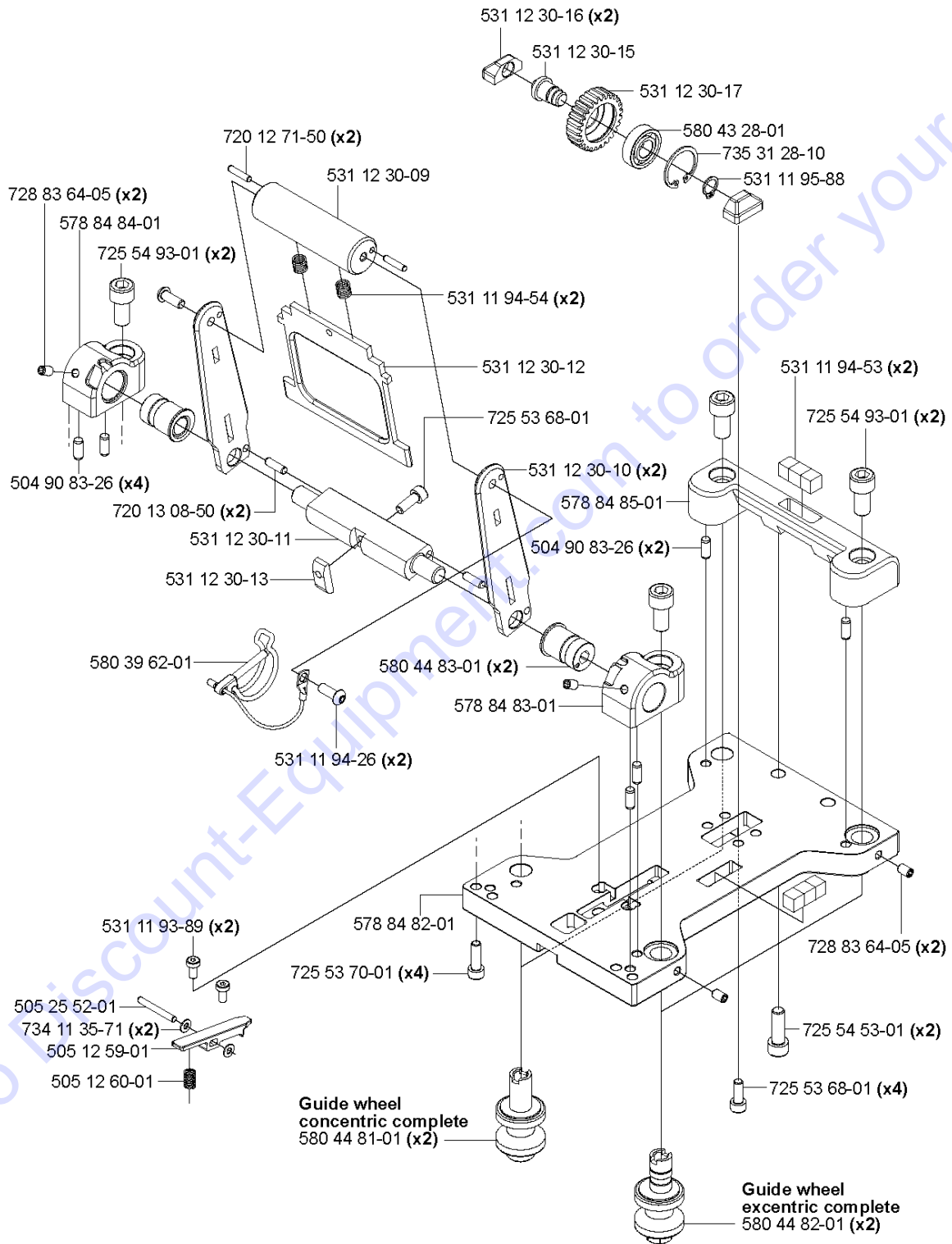

SAW CARRIAGE

WS482 HF, Valid from machine no. 1275, 2012-07

Part No	Description	Remark	QTY KIT
504 90 83-26	PIN		
505 12 59-01	ROCKER LEVER		
505 12 60-01	SPRING		
505 22 69-03	CARRIAGE		
505 25 52-01	PARALLEL PIN		
531 11 93-89	SCREW		
531 11 94-26	SCREW		
531 11 94-53	BLOCK		
531 11 94-54	SPRING		
531 11 95-88	CLIP		
531 12 30-09	HANDLE		
531 12 30-10	BAR		
531 12 30-11	SHAFT		
531 12 30-12	HANDLE		
531 12 30-13	COTTER		
531 12 30-15	AUTOMATIC FEEDING SYSTEM		
531 12 30-16	SHAFT		
531 12 30-17	GEAR WHEEL		
578 84 82-01	PLATE		
578 84 83-01	HOLDER		
578 84 84-01	HOLDER		
578 84 85-01	SOCKET		
580 39 62-01	LOCKING PIN		
580 43 28-01	BEARING		
580 44 81-01	WHEEL		
580 44 82-01	WHEEL		
580 44 83-01	SLEEVE		
720 12 71-50	PARALLEL PIN		
720 13 08-50	PARALLEL PIN		
725 53 68-01	SCREW IHSCM		
725 53 70-01	SCREW IHSCM		
725 54 53-01	SCREW IHSCM		
725 54 93-01	SCREW IHSCM		
728 83 64-05	SCREW IHSETM		
734 11 35-71	WASHER		
735 31 28-10	CIRCLIP		

Go to Discount-Equipment.com to order your parts

P WS 482 HF
Toolkit compl 501 37 52-01

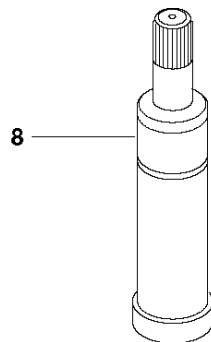
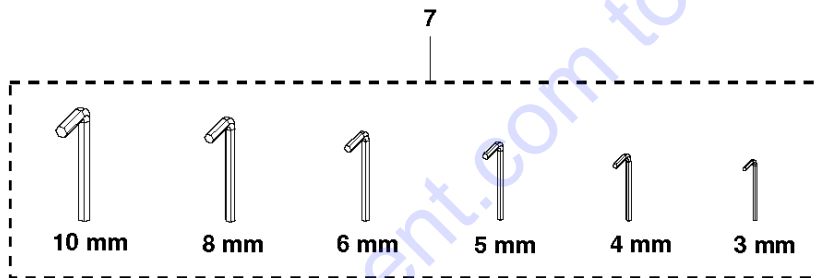
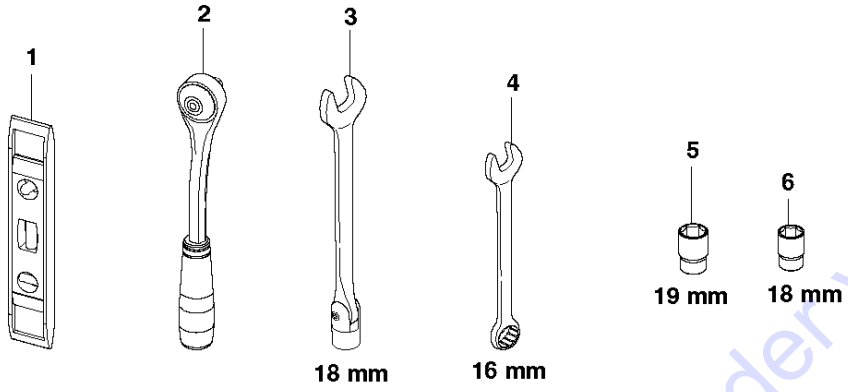

Go to Discount-Equipment.com to order your parts

TOOLS

WS482 HF, Valid from machine no. 1275, 2012-07

Ref	Part No	Description	Remark	QTY KIT
1	531 11 95-31	TOOL		
2	531 11 95-32	TOOL		
3	531 11 90-65	WRENCH		
4	531 11 95-33	TOOL		
5	531 11 95-41	SOCKET		
6	531 11 95-34	SERVICE TOOLS		
7	525 45 52-01	HEX KEY		
8	531 11 91-08	GREASE GUN		

Go to Discount-Equipment.com to order your parts

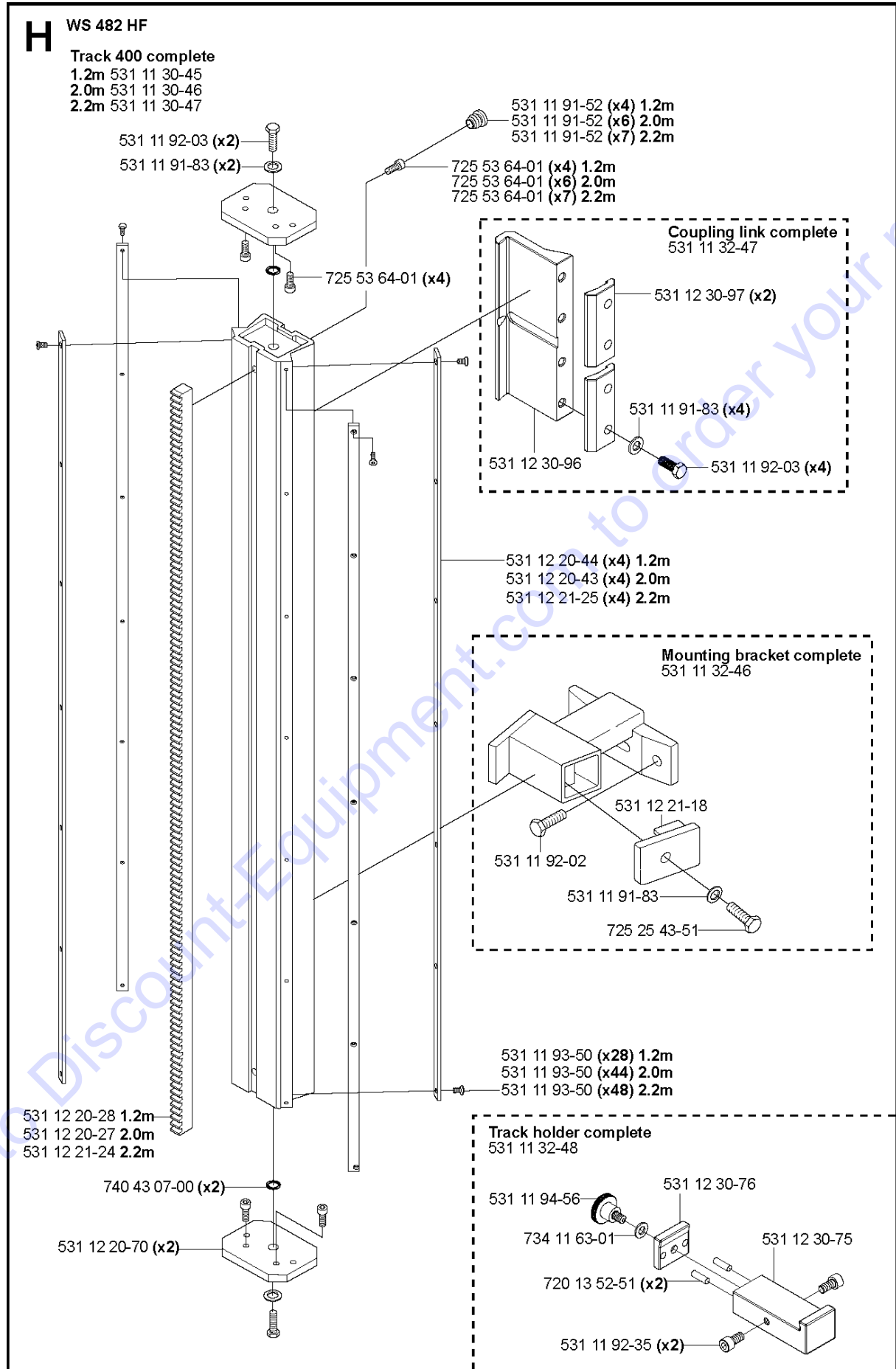

TRACK SYSTEM

WS482 HF, Valid from machine no. 1275, 2012-07

Part No	Description	Remark	QTY KIT
531 11 30-45	TRACK		
531 11 30-46	TRACK		
531 11 30-47	TRACK		
531 11 32-46	BRACKET		
531 11 32-47	COUPLING		
531 11 32-48	HOLDER ASSY		
531 11 91-52	RUBBER PLUG		
531 11 91-83	WASHER		
531 11 92-02	SCREW		
531 11 92-03	SCREW		
531 11 92-35	SCREW		
531 11 93-50	SCREW		
531 11 94-56	SCREW		
531 12 20-27	GEAR		
531 12 20-28	GEAR		
531 12 20-43	GUIDE RAIL		
531 12 20-44	GUIDE		
531 12 20-70	PLATE		
531 12 21-18	WASHER		
531 12 21-24	GEAR		
531 12 21-25	GUIDE		
531 12 30-75	BRACKET		
531 12 30-76	PLATE		
531 12 30-96	COUPLING		
531 12 30-97	PLATE		
720 13 52-51	PARALLEL PIN		
725 25 43-51	SCREW EHHM		
725 53 64-01	SCREW IHSCM		
734 11 63-01	WASHER		
740 43 07-00	O-RING		

Go to Discount-Equipment.com to order your parts

PARTS FINDER

**Search Website
by Part Number**



**Search Manual
Library For Parts
Manual & Lookup Part
Numbers – Purchase
or Request Quote**

Search Manuals

Enter your information to help us find the right parts manual for your machine.

* Brand:

* Model:

* Serial:

* Part Number:

SEARCH

**Can't Find Part or
Manual? Request Help
by Manufacturer,
Model & Description**

Parts Order Form

Please fill in the following information to help us find the right part for your machine.

Manufacturer:	<input type="text"/>
Model:	<input type="text"/>
Description:	<input type="text"/>
Part Number:	<input type="text"/>
Quantity:	<input type="text"/>
Notes:	<input type="text"/>

Submit

Discount-Equipment.com is your online resource for quality parts & equipment.

Florida: **561-964-4949** Outside Florida TOLL FREE: **877-690-3101**

Need parts?

Click on this link: <http://www.discount-equipment.com/category/5443-parts/> and choose one of the options to help get the right parts and equipment you are looking for. Please have the machine model and serial number available in order to help us get you the correct parts. If you don't find the part on the website or on one of the online manuals, please fill out the request form and one of our experienced staff members will get back to you with a quote for the right part that your machine needs.

We sell worldwide for the brands: Genie, Terex, JLG, MultiQuip, Mikasa, Essick, Whiteman, Mayco, Toro Stone, Diamond Products, Generac Magnum, Airman, Haulotte, Barreto, Power Blanket, Nifty Lift, Atlas Copco, Chicago Pneumatic, Allmand, Miller Curber, Skyjack, Lull, Skytrak, Tsurumi, Husquvarna Target, Stow, Wacker, Sakai, Mi-T-M, Sullair, Basic, Dynapac, MBW, Weber, Bartell, Bennar Newman, Haulotte, Ditch Runner, Menegotti, Morrison, Contec, Buddy, Crown, Edco, Wyco, Bomag, Laymor, EZ Trench, Bil-Jax, F.S. Curtis, Gehl Pavers, Heli, Honda, ICS/PowerGrit, IHI, Partner, Imer, Clipper, MMD, Koshin, Rice, CH&E, General Equipment, Amida, Coleman, NAC, Gradall, Square Shooter, Kent, Stanley, Tamco, Toku, Hatz, Kohler, Robin, Wisconsin, Northrock, Oztec, Toker TK, Rol-Air, APT, Wylie, Ingersoll Rand / Doosan, Innovatech, Con X, Ammann, Mecalac, Makinex, Smith Surface Prep, Small Line, Wanco, Yanmar