



QP2TE, QP2TH and QP2TZ Trash Pumps

MULTIQUIP Impeller Replacement Kit

The following instructions are intended to assist the user in the removal of the old style impeller and installing a new easily removable impeller. Please read all assembly instructions before installing the kit.

REQUIRED TOOLS

- 3/8" Ratchet
- 12 MM Socket
- Drill Motor
- 7/32-Inch Drill Bit
- Chemsearch™ (Rust Lubricant)
- 1/4-Inch Tap

PARTS

Verify that all parts are accounted for. See Table 1.

Table 1. Impeller Kit Parts				
Item	Qty.	Part No.	Description	Remarks
1	1	1890040031ASSY	KIT, IMPELLER (QP2TH and QP2TE)	INCLUDES ITEMS 3 THRU 7
2	1	2258040031ASSY	KIT, IMPELLER (QP2TZ)	INCLUDES ITEMS 3 THRU 7
3	1	1889040031	IMPELLER	QP2TE/QP2TH
3	1	2258040031	IMPELLER	QP2TZ
4	1	0191190544	BOLT	
5	1	0458220080	WASHER, LOCK	
6	1	0482200180	O-RING	
7	1	0520030310	KEY, SHAFT	

WORK SAFELY!

Only a **qualified service technician** with proper training should perform this installation. Follow all shop safety rules when performing this installation.

OLD STYLE IMPELLER REMOVAL

1. Place the pump on level secure surface that is free of dirt and debris.
2. Remove drain cover (Figure A). Set drain cover aside in a safe place.
3. Using a 3/8 ratchet with a 12 mm socket (Figure B), remove the impeller bolt from the engine shaft. **Discard the impeller bolt.** It will not be used again.
4. Attached to the impeller bolt (Figure C) are two impeller washers. Discard the **smaller impeller lock washer**; it will not be used again. **Retain the larger impeller flat washer.**

5. Using a can of Chemsearch™ (Figure D) or equivalent, a moly-lubricant, spray the area around the shaft key.
6. To break loose the impeller, drill two 7/32-inch holes into the impeller as shown in Figure D. Next, use a 1/4-inch tap on the pre-drilled holes.
7. Insert a 1/4 bolt (Figure D) into each side of a steering wheel type puller. Align the two bolts on the puller with the pre-tapped holes and tighten. Insert a 70 MM bolt into the center opening of the puller. Using a 12 MM socket, turn the bolt clockwise until the impeller breaks free.
8. Remove the **impeller and shaft key**. They will not be used again.

NEW STYLE IMPELLER INSTALLATION

1. Install new impeller and shaft key onto the engine shaft as shown in Figure E.
2. Place new o-ring into impeller groove as shown in Figure F.
3. Using new impeller bolt, place new impeller lock washer onto the bolt as shown in Figure G. Next, place the large impeller flat washer onto the impeller bolt.
4. Insert impeller bolt along with associated hardware (Figure G) into engine shaft. Tighten impeller bolt to 22 ft-lb (30 N·m).
5. Reinstall drain cover (Figure H) back onto pump casing. Turn locking knobs clockwise to secure drain cover.

NEW STYLE IMPELLER REMOVAL

1. Using a 3/8 ratchet with a 12 mm socket remove the impeller bolt, lock washer and flat washer from the engine shaft. Retain these items.
2. Insert a M12 bolt (70 mm) into the engine shaft hole. Using a ratchet, tighten bolt.
3. Continue to turn the ratchet in a clockwise direction, notice as the bolt turns the impeller will begin to slide off the engine shaft. Remove impeller.

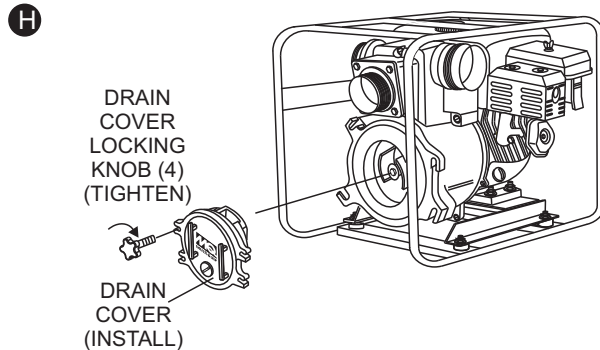
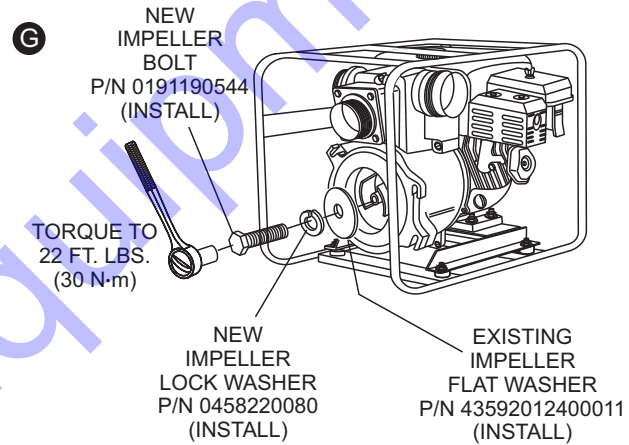
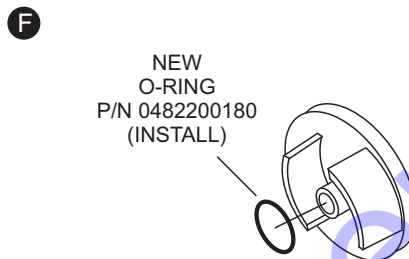
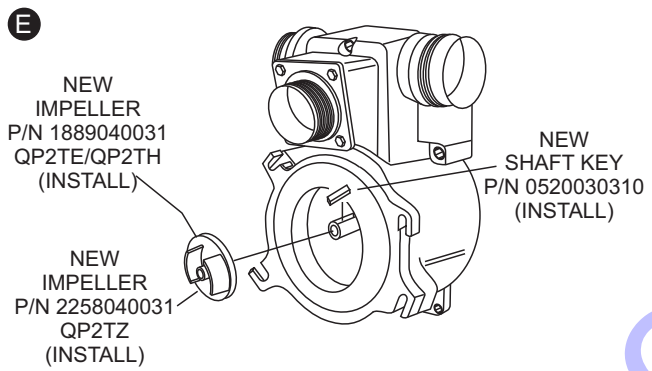
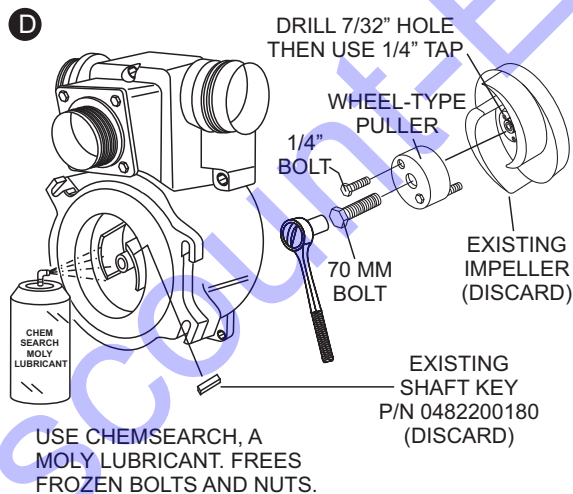
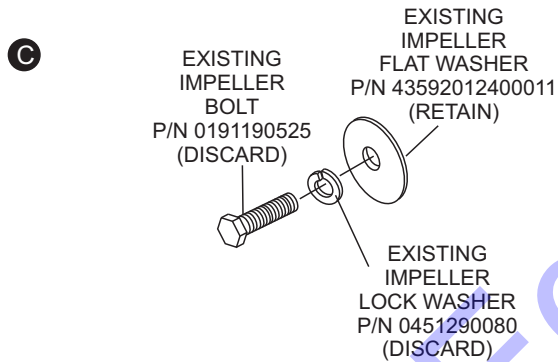
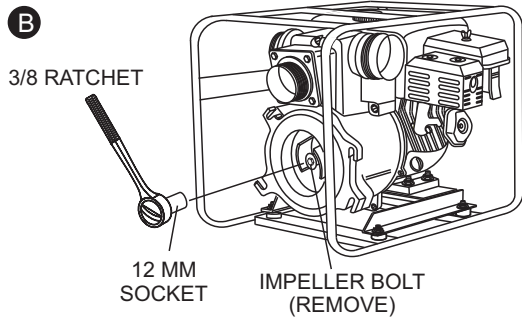
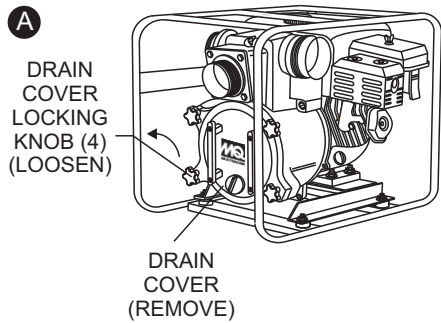

Figure 1. Impeller Replacement



www.Discount-Equipment.com

