



# American Pneumatic Tools

## CHIPPING HAMMERS ACCESSORIES, SERVICE AND REPAIR KITS



### M260

- 18836 WHIP HOSE ASSEMBLY WITH OILER (1/2 NPT TOOL CONNECTION)
- 18833 WHIP HOSE ASSEMBLY WITHOUT OILER (1/2 NPT TOOL CONNECTION)
- 18835 WHIP HOSE ASSEMBLY WITH OILER (7/8-24 TOOL CONNECTION)
- 18832 WHIP HOSE ASSEMBLY WITHOUT OILER (7/8-24 TOOL CONNECTION)
- 18786 O RING AND SEAL KIT
- 18795 BOLT REPLACEMENT KIT
- 3486 AIR INLET SWIVEL WITH 1/2" HOSE BARB (1/2 NPT TOOL CONNECTION)
- 3389 AIR INLET SWIVEL WITH 3/8" MALE NPT (1/2 NPT TOOL CONNECTION)
- 3388 AIR INLET SWIVEL WITH 1/2" HOSE BARB (7/8-24 TOOL CONNECTION)
- 2698 AIR INLET SWIVEL WITH 3/8" MALE NPT (7/8-24 TOOL CONNECTION)

### M650

- 18836 WHIP HOSE ASSEMBLY WITH OILER (1/2 NPT TOOL CONNECTION)
- 18833 WHIP HOSE ASSEMBLY WITHOUT OILER (1/2 NPT TOOL CONNECTION)
- 18835 WHIP HOSE ASSEMBLY WITH OILER (7/8-24 TOOL CONNECTION)
- 18832 WHIP HOSE ASSEMBLY WITHOUT OILER (7/8-24 TOOL CONNECTION)
- 18787 O RING AND SEAL KIT
- 3486 AIR INLET SWIVEL WITH 1/2" HOSE BARB (1/2 NPT TOOL CONNECTION)
- 3389 AIR INLET SWIVEL WITH 3/8" MALE NPT (1/2 NPT TOOL CONNECTION)
- 3388 AIR INLET SWIVEL WITH 1/2" HOSE BARB (7/8-24 TOOL CONNECTION)
- 2698 AIR INLET SWIVEL WITH 3/8" MALE NPT (7/8-24 TOOL CONNECTION)

### 4 BOLT (7/8-24 CONNECTION ONLY)

- 18835 WHIP HOSE ASSEMBLY WITH OILER
- 18832 WHIP HOSE ASSEMBLY WITHOUT OILER
- 3388 AIR INLET SWIVEL WITH 1/2" HOSE BARB (7/8-24 TOOL CONNECTION)
- 2698 AIR INLET SWIVEL WITH 3/8" MALE NPT (7/8-24 TOOL CONNECTION)

### ALL MODELS

- 1941 RETAINER SPRING
- 9431 STANDARD RETAINER + SPRING
- 5550 QUICK CHANGE RETAINER + SPRING
- 18290 QUICK CHANGE RETAINER - BOLT ON STYLE
- 18754 SAFETY CABLE, HOSE TO HOSE
- 18755 SAFETY CABLE, HOSE TO TOOL

For assistance in any sales, technical, maintenance or repair questions, please Contact Discount-equipment





# American Pneumatic Tools

**BOLT-ON  
“QUICK CHANGE”**

**SAFETY  
RETAINER**

PART # 18290

- **LIGHTWEIGHT** Accessory tool changes are quick and easy-retainer stays mounted on the tool.
- **NO LOOSE PARTS** Locks firmly onto APT 260, 450 and 650 Series chippers without the need for typical retaining springs that are often lost or need to be replaced due to wear.
- **SECURE** Six points of contact (6 hardened steel balls) to retain all available round collar (hex or round shank) or oval collar steel types.
- **RENTAL FRIENDLY** No need to be concerned about different accessory steel; it accepts all types.
- **SAFE** Eliminates concern over retainer not being used when proper retaining spring is not available, or falling retainers and steel due to worn out springs.

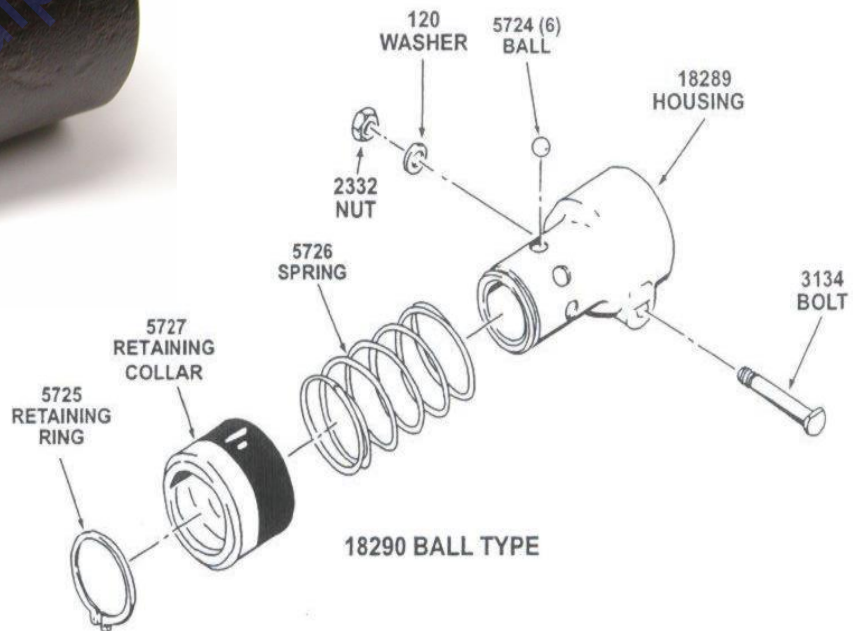

For assistance in any sales, technical, maintenance or repair questions, please Contact Discount-equipment

# PARTS FINDER

**Search Website  
by Part Number**



**Search Manual  
Library For Parts  
Manual & Lookup Part  
Numbers – Purchase  
or Request Quote**

**Search Manuals**

Enter the serial number or part number to search for parts.

\* Find:

\* Model:

\* Serial:

Search

**Can't Find Part or  
Manual? Request Help  
by Manufacturer,  
Model & Description**

**Parts Order Form**

Please fill in the following information:

Manufacturer:

Model:

Serial:

Part Number:

Part Description:

Quantity:

Unit Price:

Total Price:

Customer Name:

Company Name:

Address:

City:

State:

Zip:

Phone:

Fax:

Email:

Comments:

Discount-Equipment.com is your online resource for quality parts & equipment.

Florida: **561-964-4949** Outside Florida TOLL FREE: **877-690-3101**

**Need parts?**

Click on this link: <http://www.discount-equipment.com/category/5443-parts/> and choose one of the options to help get the right parts and equipment you are looking for. Please have the machine model and serial number available in order to help us get you the correct parts. If you don't find the part on the website or on one of the online manuals, please fill out the request form and one of our experienced staff members will get back to you with a quote for the right part that your machine needs.

We sell worldwide for the brands: Genie, Terex, JLG, MultiQuip, Mikasa, Essick, Whiteman, Mayco, Toro Stone, Diamond Products, Generac Magnum, Airman, Haulotte, Barreto, Power Blanket, Nifty Lift, Atlas Copco, Chicago Pneumatic, Allmand, Miller Curber, Skyjack, Lull, Skytrak, Tsurumi, Husquvarna Target, Stow, Wacker, Sakai, Mi-T-M, Sullair, Basic, Dynapac, MBW, Weber, Bartell, Bennar Newman, Haulotte, Ditch Runner, Menegotti, Morrison, Contec, Buddy, Crown, Edco, Wyco, Bomag, Laymor, EZ Trench, Bil-Jax, F.S. Curtis, Gehl Pavers, Heli, Honda, ICS/PowerGrit, IHI, Partner, Imer, Clipper, MMD, Koshin, Rice, CH&E, General Equipment, Amida, Coleman, NAC, Gradall, Square Shooter, Kent, Stanley, Tamco, Toku, Hatz, Kohler, Robin, Wisconsin, Northrock, Oztec, Toker TK, Rol-Air, APT, Wylie, Ingersoll Rand / Doosan, Innovatech, Con X, Ammann, Mecalac, Makinex, Smith Surface Prep, Small Line, Wanco, Yanmar