



PARTS BREAKDOWN FOR MODEL TRD-2/TRH-2  
RICE HYDRO, INC.

PART NUMBER..	DESCRIPTION..	QTY REQ'D
UD04-0006.09	BEARING	1
UD04-0007.18	SEAL	3
UD02-0007.24	SEAL	1
UD04-0009.09	RETAINER CLIP	1
UD04-0014.20	PLUNGER ROD	3
UD04-0023.22	SUPPORT RING	3
UD04-0031.49	CRANKSHAFT	1
UD04-0103.41	CONNECTING ROD	3
UD04-0208.70	BEARING COVER	1
UD04-0208.72	BACK COVER	1
UD04-0209.56	CRANKCASE	1
UD04-0214.21	BEARING	1
UD04-0301.42	SLINGER RING	3
UD04-0303.18	PLUNGER NUT	3
UD04-0517.07	FLANGE	1
UD04-0602.76	GASKET	1
UD02-0605.09	GASKET	2
UD04-0605.33	PLUNGER WASHER	3
UD04-0605.49	WASHER	1
UD04-1101.A2	O-RING	6
UD04-1101.A3	VALVE O-RING	6
UD04-1101.A4	O-RING	3
UD04-1101.A6	O-RING	1
UD04-1101.A7	O-RING	3
UD04-1205.35	PLUNGER 15 MM	3
UD04-1212.10	END PLATE	1
UD04-1411.01	WASHER	12
UD04-1502.15	CONNECTING ROD PIN	3
UD04-1506.26	SNAP RING	1
UD04-1603.64	DISCHARGE PLUG 3/8	2
UD02-1603.67	DRAIN PLUG	1
UD04-1603.69	SIGHT GLASS	1
UD04-1603.72	VALVE CAP	6
UD04-1604.59	MANIFOLD	1
UD04-1805.19	BOLT	4
UD04-1805.20	BOLT	8
UD04-1805.39	BOLT	8
UD04-6058.26	OIL VENT CAP	1

MISCELLANEOUS PARTS..

HONDA-GX200UT2-QX2	196 CC FLANGE MOUNT HONDA	1
DIESEL-1B20XRS-9901	232 CC DIESEL ENGINE	1
DIESEL-1B20-PTO	3/4" SHAFT 3.4KW 232 CC	1
SPEC-PNL3.0/20-T	TRIPLEX PLUNGER PUMP	1
GAUGE-3000	LIQUID FILLED GAUGE	1
BALLVALVE-3/8HP	OUTLET BALLVALVE	1
NEEDLEVALVE-1/4	BLEED VALVE	1
HOSEWIVEL-1/2	SWIVEL HOSE INLET	1
LINESTRAINER-1/2	INLET LINE STRAINER	1
KING-LARGE	LARGE SHIPPING BOX	1
LABEL-KIT-TR	INSTRUCTION AND CAUTION STICKERS	1

**\*\* Prior to s/n #45985 \*\***

UNLOADER-500/4000PSI	PRESSURE REGULATOR	1
----------------------	--------------------	---

**\*\* After s/n #45985 \*\***

VALVE-RELIEF-2000PSI	PRESSURE REGULATOR	1
----------------------	--------------------	---

PARTS BREAKDOWN FOR MODEL TRD-2/TRH-2  
RICE HYDRO, INC.

OUTLET HOSE..

HOSE-3/8X8-RH	8' FOOT OUTLET HOSE - STANDARD	1
COUPLERPLUG-3/8M	MALE PUMP OUTLET - PIPING	1
COUPLERBODY-BR-3/8F	FEMALE PUMP OUTLET - HOSE	1
HOSE-3/8-3000XFT	SPECIFY LENGTH OF HOSE	
FITTING-3/8-MPIPE	FITTING FOR HOSE - RIGID	1
FITTING-3/8-MPX	FITTING FOR HOSE - SWIVEL	1

KITS:

UD04-KIT-UD1	VALVE KIT P-SERIES	1
UD04-KIT-UD7	SEAL KIT P 15MM	1
UD04-KIT-UD13	BRASS KIT P 15MM	1
UD04-KIT-UD20	PLUNGER O-RING KIT P 15MM	1

Go to [Discount-Equipment.com](http://Discount-Equipment.com) to order your parts

Revised 10-1-2005

# PNL 2.5/20-T & PNL 3.0/20-T

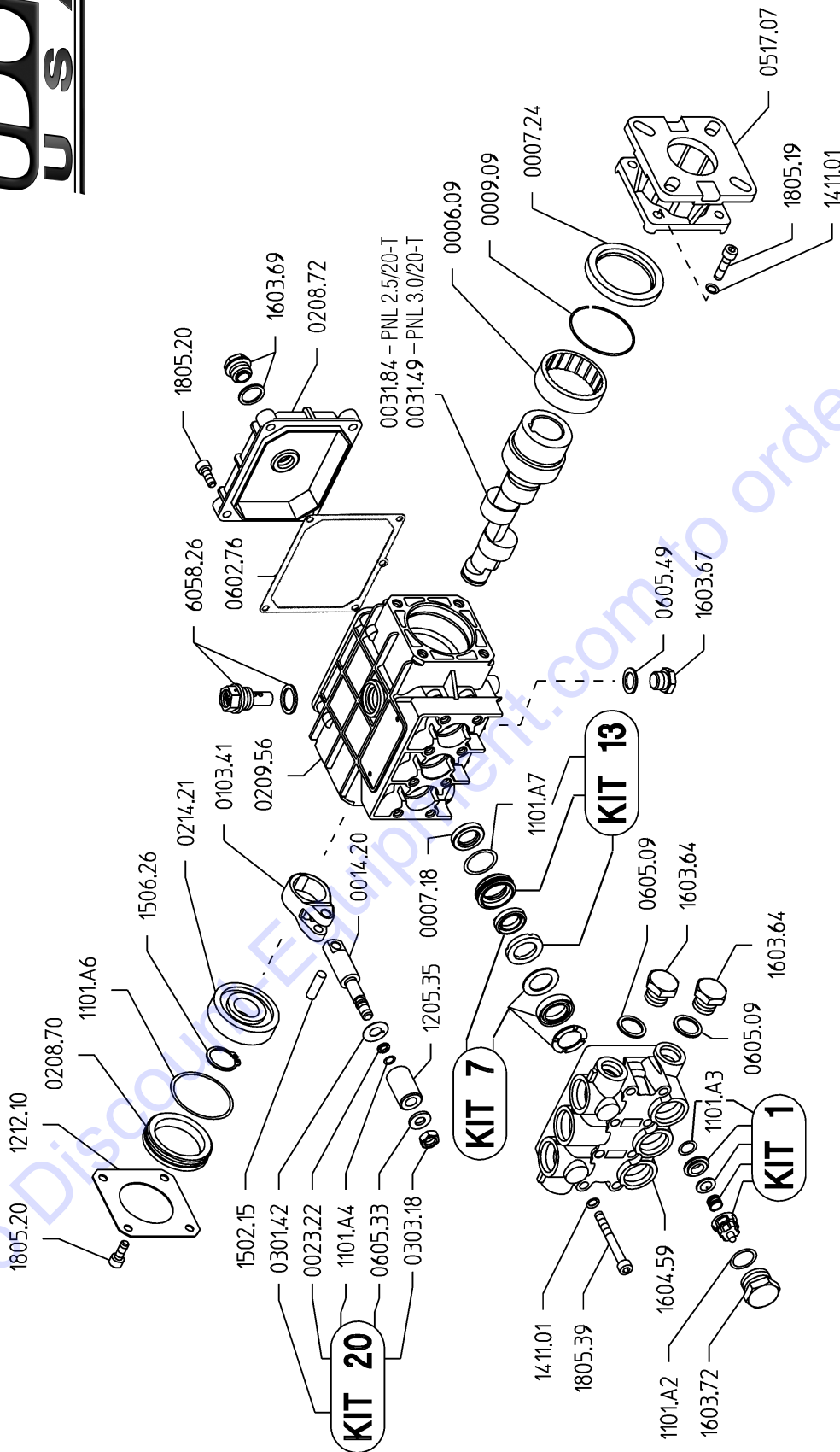

## PNL 2.5/20-T & PNL 3.0/20-T Quick Reference

Max. Flow	PNL 2.5/20-T .....2.5 GPM	Valve Kit .....	04-KIT UD-1
	PNL 3.0/20-T .....3.0 GPM	Seal Kit.....	04-KIT UD-7
Maximum Pressure	.....2000 PSI	Brass Kit .....	04-KIT UD-13
Rated Pump Speed	.....3400 RPM	Plunger Bolt Kit .....	04-KIT UD-20
Oil Capacity	.....12 oz. UDOR LUBE	Plunger Part # .....	04-1205.35
	or SAE 30W Non-Detergent Oil	Plunger Diameter.....	15 MM

**PNL 2.5/20-T**  
**PNL 3.0/20-T**

# PARTS FINDER

**Search Website  
by Part Number**



**Search Manual  
Library For Parts  
Manual & Lookup Part  
Numbers – Purchase  
or Request Quote**

**Search Manuals**

Enter your information to help us find the right parts manual for your machine.

\* Brand:

\* Model:

\* Serial:

\* Part Number:

SEARCH

**Can't Find Part or  
Manual? Request Help  
by Manufacturer,  
Model & Description**

**Parts Order Form**

Please fill in the following information to help us find the right part for your machine.

Manufacturer:	<input type="text"/>
Model:	<input type="text"/>
Description:	<input type="text"/>
Part Number:	<input type="text"/>
Quantity:	<input type="text"/>
Notes:	<input type="text"/>

Submit

Discount-Equipment.com is your online resource for quality parts & equipment.

Florida: **561-964-4949** Outside Florida TOLL FREE: **877-690-3101**

**Need parts?**

Click on this link: <http://www.discount-equipment.com/category/5443-parts/> and choose one of the options to help get the right parts and equipment you are looking for. Please have the machine model and serial number available in order to help us get you the correct parts. If you don't find the part on the website or on one of the online manuals, please fill out the request form and one of our experienced staff members will get back to you with a quote for the right part that your machine needs.

We sell worldwide for the brands: Genie, Terex, JLG, MultiQuip, Mikasa, Essick, Whiteman, Mayco, Toro Stone, Diamond Products, Generac Magnum, Airman, Haulotte, Barreto, Power Blanket, Nifty Lift, Atlas Copco, Chicago Pneumatic, Allmand, Miller Curber, Skyjack, Lull, Skytrak, Tsurumi, Husquvarna Target, Stow, Wacker, Sakai, Mi-T-M, Sullair, Basic, Dynapac, MBW, Weber, Bartell, Bennar Newman, Haulotte, Ditch Runner, Menegotti, Morrison, Contec, Buddy, Crown, Edco, Wyco, Bomag, Laymor, EZ Trench, Bil-Jax, F.S. Curtis, Gehl Pavers, Heli, Honda, ICS/PowerGrit, IHI, Partner, Imer, Clipper, MMD, Koshin, Rice, CH&E, General Equipment, Amida, Coleman, NAC, Gradall, Square Shooter, Kent, Stanley, Tamco, Toku, Hatz, Kohler, Robin, Wisconsin, Northrock, Oztec, Toker TK, Rol-Air, APT, Wylie, Ingersoll Rand / Doosan, Innovatech, Con X, Ammann, Mecalac, Makinex, Smith Surface Prep, Small Line, Wanco, Yanmar