



PARTS BREAKDOWN FOR MODELS: EL1, EL1A, EL2, EL3
RICE HYDRO INC.

EL1 serial numbers #55263 & previous

PART NUMBER..	DESCRIPTION..	QTY REQ'D
UD04-0006.09	BEARING	1
UD04-0007.18	SEAL	3
UD04-0007.24	SEAL	1
UD04-0009.09	RETAINER CLIP	1
UD04-0014.20	PLUNGER ROD	3
UD04-0023.22	SUPPORT RING	1
UD04-0031.42	CRANKSHAFT - EL2/EL3	1
UD04-0031.45	CRANKSHAFT - EL1/EL1A	1
UD04-0103.41	ALUMINUM CONNECTING ROD	3
UD04-0208.70	BACK COVER	1
UD04-0208.72	CRANKCASE COVER	1
UD04-0209.56	CRANKCASE	1
UD04-0214.21	BEARING	1
UD04-0301.42	SLINGER RING	1
UD04-0303.18	PLUNGER NUT	1
UD04-0517.08	ELECTRIC FLANGE	1
UD04-0602.76	GASKET - CRANKCASE COVER	1
UD02-0605.09	ALUMINUM WASHER	1
UD04-0605.33	PLUNGER WASHER	1
UD04-0605.49	O-RING	1
UD04-1101.A2	O-RING	6
UD04-1101.A3	VALVE O-RING	6
UD04-1101.A4	O-RING	1
UD04-1101.A6	O-RING	1
UD04-1101.A7	O-RING - EL2/EL3	3
UD04-1101.D7	O-RING - EL1/EL1A	3
UD04-1205.35	PLUNGER - 15 MM	3
UD04-1212.10	SIDE PLATE	1
UD04-1411.01	WASHER	12
UD04-1502.15	CONNECTING ROD PIN	3
UD04-1506.26	SNAP RING	1
UD04-1603.64	3/8" PLUG	1
UD02-1603.67	DRAIN PLUG	1
UD04-1603.69	SIGHT GLASS	1
UD04-1603.72	VALVE CAP	6
UD04-1604.C7	ALUMINUM MANIFOLD EL1/EL1A	1
UD04-1604.59	BRASS MANIFOLD EL2/EL3	1
UD04-1805.19	BOLT	4
UD04-1805.20	BOLT	8
UD04-1805.39	BOLT	8
UD04-6058.26	OIL VENT CAP	1

OUTLET HOSES:

HOSE-1/2X8-RH (EL1/1A)	8' FOOT OUTLET HOSE - STANDARD	1
COUPLERBODY-1/2 (EL1/1A)	FEMALE PUMP OUTLET - HOSE	1
COUPLERPLUG-1/2 (EL1/1A)	MALE PUMP OUTLET - PIPING	1
FITTING-1/2-MPIPE (EL1/1A)	FITTING FOR HOSE - RIGID	1
FITTING-1/2-MPX (EL1/1A)	FITTING FOR HOSE - SWIVEL	1
HOSE-1/2-2500XFT (EL1/1A)	SPECIFY LENGTH OF HOSE	
HOSE-3/8X8-RH (EL2/3)	8' FOOT OUTLET HOSE - STANDARD	1
COUPLERBODY-BR-3/8F (EL2/3)	FEMALE PUMP OUTLET - HOSE	1
COUPLERPLUG-3/8M (EL2/3)	MALE PUMP OUTLET - PIPING	1
FITTING-3/8-MPIPE (EL2/3)	FITTING FOR HOSE - RIGID	1
FITTING-3/8-MPX (EL2/3)	FITTING FOR HOSE - SWIVEL	1
HOSE-3/8-3000XFT (EL2/3)	SPECIFY LENGTH OF HOSE	

RICE HYDRO INC.

EL1 serial numbers #55263 & previous

PART NUMBER..	DESCRIPTION..	QTY REQ'D
MOTORS & PUMPS:		
MOTOR-1/2HP-EL1 - L (EL1)	1/2HP 110/220V 1 PHASE 60HZ	1
MOTOR-1HP-CFACE (EL1A/2)	1HP 110/220V 1 PHASE 50/60HZ	1
MOTOR-1.5HP-50/60HZ (EL3)	1.5HP 110/220V 1 PHASE 50/60HZ	1
SPEC-PND-3.0/15-ZA (EL1/1A)	TRIPLEX PLUNGER PUMP	1
SPEC-PNL3.0/20-Z (EL2/3)	TRIPLEX PLUNGER PUMP	1
MISCELLANEOUS PARTS:		
HOESWIVEL-1/2	HOSE SWIVEL INLET	1
HOESCREEN&WASHER	INLET HOSE SCREEN	1
BALLVALVE-1/2 (EL1/1A)	OUTLET BALLVALVE	1
BALLVALVE-3/8HP (EL2/3)	OUTLET BALLVALVE	1
VALVE-RELIEF-500PSI (EL1/1A) BLUE SPRING 50-500 PSI	PRESSURE REGULATOR	1
VALVE-RELIEF-900PSI (EL2) RED SPRING 100-900 PSI	PRESSURE REGULATOR	1
VALVE-RELIEF-2000PSI (EL3) YELLOW SPRING 200-2000 PSI	PRESSURE REGULATOR	1
GAUGE-600 (EL1/1A)	0-600 PSI LIQUID GAUGE	1
GAUGE-1500 (EL2)	0-1500 PSI LIQUID GAUGE	1
GAUGE-2000 (EL3)	0-2000 PSI LIQUID GAUGE	1
NEEDLEVALVE-1/4	AIR BLEED VALVE	1
KING-EL1A	SHIPPING BOX	1
LABEL-KIT-EL	INSTRUCTION AND CAUTION STICKERS	1
KITS:		
	*Kits are all inclusive for PND/PNL pumps	
UD04-KIT-UD1	VALVE KIT	
UD04-KIT-UD7	SEAL KIT	
UD04-KIT-UD13	BRASS KIT 15MM	
UD04-KIT-UD20	PLUNGER O-RING KIT 15MM	

Revised 10-31-2018

PND 3.0/15-ZA

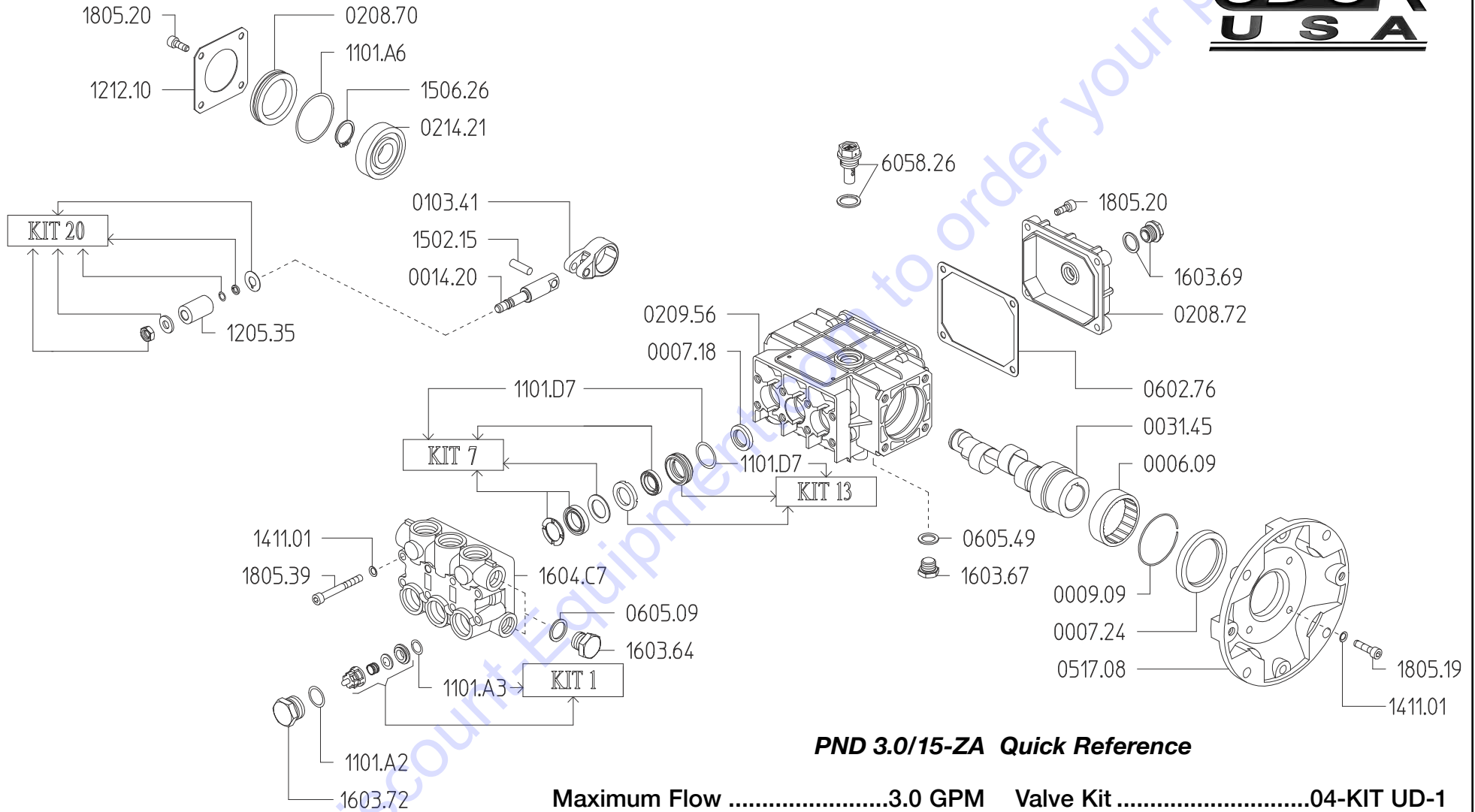

PND 3.0/15-ZA Quick Reference

Maximum Flow3.0 GPM
 Maximum Pressure1500 PSI
 Rated Pump Speed1750 RPM
 Oil Capacity12 oz. UDOR LUBE
 or SAE 30W
 Non-Detergent Oil

Valve Kit04-KIT UD-1
 Seal Kit.....04-KIT UD-7
 Brass Kit.....04-KIT UD-13
 Plunger Bolt Kit04-KIT UD-20
 Plunger Part #.....1205.35
 Plunger Diameter15 MM

PARTS FINDER

**Search Website
by Part Number**



**Search Manual
Library For Parts
Manual & Lookup Part
Numbers – Purchase
or Request Quote**

Search Manuals

Enter your information to help us find the right parts manual for your machine.

* Brand:

* Model:

* Serial:

* Part Number:

SEARCH

**Can't Find Part or
Manual? Request Help
by Manufacturer,
Model & Description**

Parts Order Form

Please fill in the following information to help us find the right part for your machine.

MANUFACTURER:

MODEL:

DESCRIPTION:

DATE:

NAME:

PHONE:

EMAIL:

ADDRESS:

CITY:

STATE:

ZIP:

REQUEST FOR QUOTE

Discount-Equipment.com is your online resource for quality parts & equipment.

Florida: **561-964-4949** Outside Florida TOLL FREE: **877-690-3101**

Need parts?

Click on this link: <http://www.discount-equipment.com/category/5443-parts/> and choose one of the options to help get the right parts and equipment you are looking for. Please have the machine model and serial number available in order to help us get you the correct parts. If you don't find the part on the website or on one of the online manuals, please fill out the request form and one of our experienced staff members will get back to you with a quote for the right part that your machine needs.

We sell worldwide for the brands: Genie, Terex, JLG, MultiQuip, Mikasa, Essick, Whiteman, Mayco, Toro Stone, Diamond Products, Generac Magnum, Airman, Haulotte, Barreto, Power Blanket, Nifty Lift, Atlas Copco, Chicago Pneumatic, Allmand, Miller Curber, Skyjack, Lull, Skytrak, Tsurumi, Husquvarna Target, Stow, Wacker, Sakai, Mi-T-M, Sullair, Basic, Dynapac, MBW, Weber, Bartell, Bennar Newman, Haulotte, Ditch Runner, Menegotti, Morrison, Contec, Buddy, Crown, Edco, Wyco, Bomag, Laymor, EZ Trench, Bil-Jax, F.S. Curtis, Gehl Pavers, Heli, Honda, ICS/PowerGrit, IHI, Partner, Imer, Clipper, MMD, Koshin, Rice, CH&E, General Equipment, Amida, Coleman, NAC, Gradall, Square Shooter, Kent, Stanley, Tamco, Toku, Hatz, Kohler, Robin, Wisconsin, Northrock, Oztec, Toker TK, Rol-Air, APT, Wylie, Ingersoll Rand / Doosan, Innovatech, Con X, Ammann, Mecalac, Makinex, Smith Surface Prep, Small Line, Wanco, Yanmar