

# YANMAR

CONSTRUCTION / TRUE ZERO TAIL SWING MINI-EXCAVATOR

www.discount-equipment.com



## QUICK SPECS

Weight	11,530 lbs
Horsepower	38.7 hp
Digging Depth	13'8"

## Power, flexibility and stability in a nice compact package.

For more than 100 years, Yanmar has built some of the world's most powerful and fuel-efficient engines. They've also pioneered some of the most innovative new construction technology. This includes the true zero tail swing technology that makes the ViO55 one of the most flexible machines you can buy. You can work effectively and efficiently in extremely tight spaces that other excavators simply can't get to. Add to that the stability of a conventional excavator and you've got one of the best values around.

## INNOVATIVE FEATURES



### True Zero Tail Swing

Yanmar pioneered the first zero tail swing excavator in 1993. Today, our true zero tail swing technology means no part of the housing extends beyond the tracks. Since the entire machine operates within its tracks, you can work efficiently almost anywhere with less damage to the machine and the worksite.

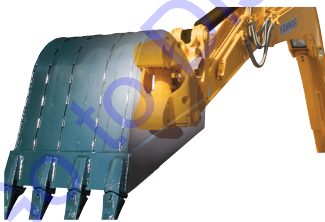

### Hydraulic Quick Coupler Comes Standard

The standard hydraulic quick coupler makes changing buckets fast and easy. With the exception of fitting and removing the safety lock pin, the entire operation is performed electronically while you're seated in the comfort of the cab. Less hassle. Less downtime. More productivity.



### The Stability Of A Conventional Excavator

The ViO55-5B comes standard with ViO Crawler Technology for Advanced Stability (VICTAS). This innovative offset track technology provides increased stability without increasing the undercarriage width. You get the balance and stability of a conventional, standard-sized machine in a mini-excavator.



## ViO55-5B

POWERFUL, EFFICIENT  
38.7-HP INTERIM TIER 4  
YANMAR DIESEL ENGINE

VIPPS (VIO PROGRESSIVE  
3-PUMP HYDRAULIC  
SYSTEM)

EASY-TO-OPERATE  
JOYSTICK CONTROLS  
WITH ARMRESTS REDUCE  
OPERATOR FATIGUE

SPRING STEEL CYLINDER  
ROD GUARDS AND HOSE  
PROTECTION

4-PILLAR ROPS/FOPS  
CANOPY FOR SAFETY

INTEGRATED BOOM  
LIGHT PROTECTED  
FROM DAMAGE

EASY MAINTENANCE  
ACCESS TO EVERY MAJOR  
COMPONENT

ANGLED CRAWLER FRAME  
REDUCES FOREIGN  
MATTER BUILD-UP

TRAVELING ALARM  
SIGNALS WHEN MACHINE  
IS MOVED

OPTIONAL ENCLOSED  
CAB WITH HEAT & A/C

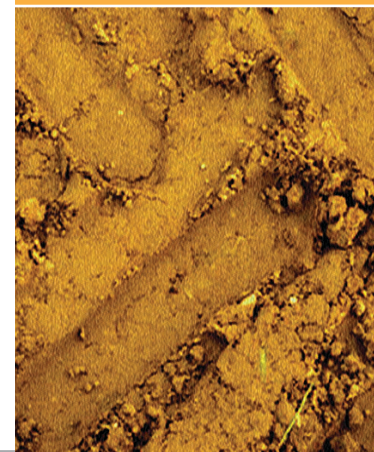

# Vi055-5B

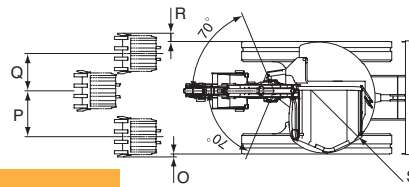

## Dimensions - Vi055-5B

<b>A</b> 13'1" (3980 mm)	<b>K</b> 1'8" (500 mm)
<b>B</b> 13'8" (4160 mm)	<b>L</b> 6'6" (1990 mm)
<b>C</b> 9'6" (2900 mm)	<b>M</b> 1'4" (400 mm)
<b>D</b> 20'4" (6200 mm)	<b>N</b> 1'2" (350 mm)
<b>E</b> 18'3" (5560 mm)	<b>O</b> 2" (45 mm)
<b>F</b> 8'7" (2620mm)	<b>P</b> 2'7" (795 mm)
<b>G</b> 21'2" (6440 mm)	<b>Q</b> 2'2" (650 mm)
<b>H</b> 14'5" (4400 mm)	<b>R</b> 5" (135 mm)
<b>I</b> 7'7" (2320 mm)	<b>S</b> R3' 3" (R995 mm)
<b>J</b> 8'7" (2620 mm)	

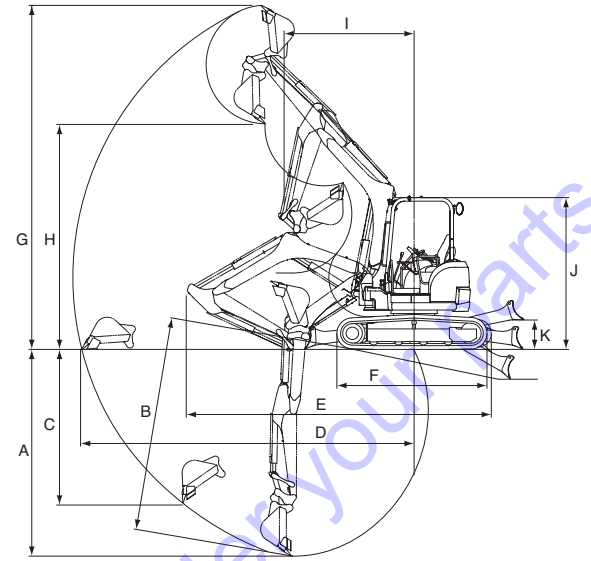
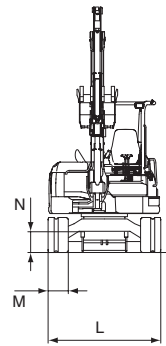

## Specifications

Model			Vi055-5B	
Type			Canopy	Cabin
<b>Operating Weight</b>	Rubber Track	lbs (kg)	11530 (5230)	11817 (5360)
	Steel Track	(kg)	11574 (5250)	11861 (5380)
<b>Engine</b>	Type	-	Water-cooled 4-cycle diesel	
	Model	-	YANMAR 4TNV88-BXBV	
	Output	HP (kW)/rpm	38.7 (28.8) / 2400	
<b>Performance</b>	Max Digging Force, Bucket / Arm	lbs (kN)	8207 (36.5) / 5062 (22.5)	
	Traveling Speed, High / Low	MPH (km / h)	2.73 / 1.43 (4.4 / 2.3)	
	Swing Speed	RPM	10	
	Boom Swing Angle, (L / R)	degrees	70° / 70°	
<b>Ground Contact Pressure</b>	Rubber Track	PSI (kPa)	3.96 (27.3)	4.12 (28.4)
	Steel Track	PSI (kPa)	4.02 (27.7)	4.18 (28.8)
<b>Hydraulic System</b>	Pump Capacity	GPM (L / min)	10.6 + 10.6 + 10.6 + 3.1 (40.3 + 40.3 + 40.3 + 11.7)	
	Main Relief Set Pressure	PSI (MPa)	3555 (24.5) x 3	
<b>Undercarriage</b>	Track Type	-	Rubber or Steel	
<b>Blade Dimensions</b>	Width x Height	ft-in (mm)	6'6" x 14" (1970 x 400)	
<b>Fuel tank capacity</b>		Gals (L)	16.9 (64)	

## Standard Equipment

- Blade
- Boom Swing
- Rubber or Steel Tracks
- Hydraulic Quick Coupler
- 2-way Control Pattern Change
- Auxiliary Valve and Piping (arm end)
- Cylinder Cover (boom, arm, bucket, blade)
- ROPS / FOPS Cabin or Canopy
- Windshield Washer (cabin spec)
- Defroster (cabin spec)
- Joystick Pilot Controls
- Arm Rests (adjustable)
- Suspension and Reclining Seat
- Seat Belt
- Traveling Levers and Pedals
- Traveling Alarm Built-in Type
- Boom Light
- Exterior Canopy or Cabin Work Light
- Operation Manual

## Hydraulic PTO

Model		Vi055-5B		
Specification	Output	PSI (MPa)	GPM (L / min)	
			2400RPM	1200RPM
<b>Combined Flow, Double Actions</b>		3553 (24.5)	21.3 (80.6)	10.6 (40.3)

Please note that the standard equipment may vary from this list. Consult your Yanmar dealer for confirmation.

## Lifting Capacity

LIFT POINT HEIGHT h:in (mm)	r:REACH in (mm)											
	RATED LIFT CAPACITY OVER END BLADE DOWN lbs (kg)				RATED LIFT CAPACITY OVER END BLADE UP lbs (kg)				RATED LIFT CAPACITY OVER SIDE BLADE DOWN lbs (kg)			
	MAX	13'1" (4000)	9'10" (3000)	8'3" (2500)	MAX	13'1" (4000)	9'10" (3000)	8'3" (2500)	MAX	13'1" (4000)	9'10" (3000)	8'3" (2500)
13'1" (4000)	*2075 (941)	*1969 (893)			*2018 (915)	*1923 (872)			*2055 (932)	*1969 (893)		
9'10" (3000)	*2055 (932)	*2046 (928)			1475 (669)	*2057 (933)			1409 (639)	*2057 (933)		
6'7" (2000)	*2095 (950)	*2441 (1107)	*3246 (1472)	*4051 (1837)	1327 (602)	2029 (920)	*3226 (1463)	*3993 (1811)	1244 (564)	1956 (867)	3246 (1472)	3993 (1811)
3'3" (1000)	*2152 (976)	*2822 (1280)	*4051 (1837)	*5528 (2507)	1277 (579)	2004 (909)	2915 (1322)	4055 (1839)	1211 (549)	1824 (827)	2717 (1232)	3658 (1659)
Ground (0)	*2209 (1002)	*3111 (1411)	*4494 (2038)	*5585 (2533)	1327 (602)	1905 (864)	2930 (1329)	3808 (1727)	1252 (568)	1824 (827)	2699 (1224)	3435 (1558)
-3'3" (-1000)	*2267 (1028)	*2900 (1315)	*4120 (1959)	*5221 (2368)	1484 (673)	1839 (834)	2831 (1284)	3709 (1682)	1409 (639)	1749 (793)	2683 (1217)	3468 (1543)
-6'7" (-2000)	*2209 (1002)			*4242 (1924)	1923 (872)			3658 (1659)	1824 (827)			3625 (1644)

\* Rated Hydraulic lift capacity

**TO PURCHASE THIS PRODUCT PLEASE CONTACT US**



**Equipment Financing and  
Extended Warranties Available**



**Discount-Equipment.com is your online resource for  
commercial and industrial quality parts and equipment sales.**

**561-964-4949**

**visit us on line @ [www.discount-equipment.com](http://www.discount-equipment.com)**

Select an option below to find your Equipment

**Search by Manufacturer**

**Search by Product Type**

**Request a Quote**

We sell worldwide for the brands: Genie, Terex, JLG, MultiQuip, Mikasa, Essick, Whiteman, Mayco, Toro Stone, Diamond Products, Generac Magnum, Airman, Haulotte, Barreto, Power Blanket, Nifty Lift, Atlas Copco, Chicago Pneumatic, Allmand, Miller Curber, Skyjack, Lull, Skytrak, Tsurumi, Husquvarna Target, Stow, Wacker, Sakai, Mi-T-M, Sullair, Basic, Dynapac, MBW, Weber, Bartell, Bennar Newman, Haulotte, Ditch Runner, Menegotti, Morrison, Contec, Buddy, Crown, Edco, Wyco, Bomag, Laymor, EZ Trench, Bil-Jax, F.S. Curtis, Gehl Pavers, Heli, Honda, ICS/PowerGrit, IHI, Partner, Imer, Clipper, MMD, Koshin, Rice, CH&E, General Equipment, Amida, Coleman, NAC, Gradall, Square Shooter, Kent, Stanley, Tamco, Toku, Hatz, Kohler, Robin, Wisconsin, Northrock, Oztec, Toker TK, Rol-Air, APT, Wylie, Ingersoll Rand / Doosan, Innovatech, Con X, Ammann, Mecalac, Makinex, Smith Surface Prep, Small Line, Wanco, Yanmar