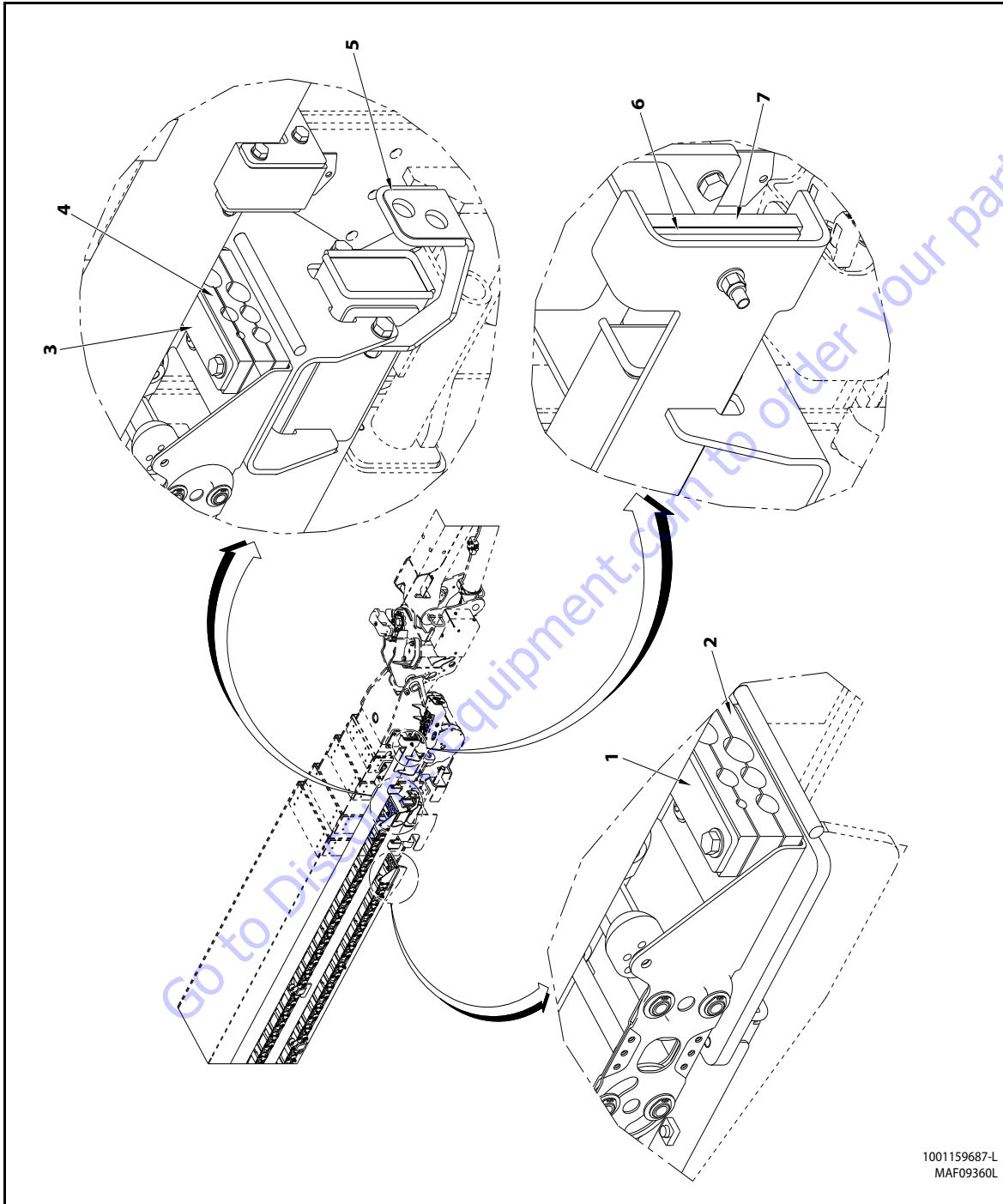
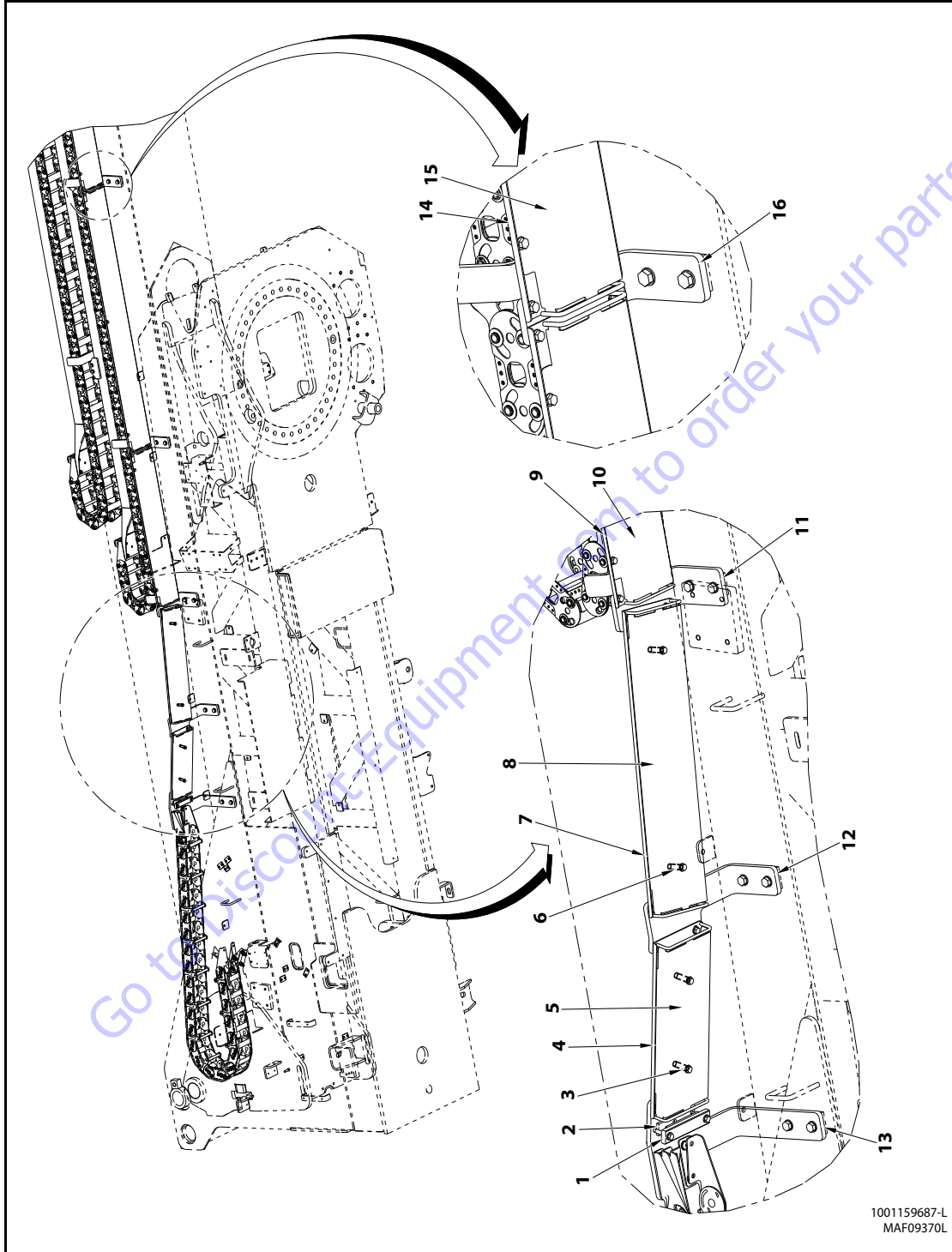

Figure 4-46. Powertrack Installation - Sheet 1 of 4



- 1. Clamp Plate
- 2. Rubber Pad
- 3. Clamp Plate
- 4. Rubber Pad
- 5. Bracket
- 6. Clamp Plate
- 7. Rubber Pad

Figure 4-47. Powertrack Installation - Sheet 2 of 4



- 1. Clamp Bar
- 2. Rubber Pad
- 3. Spacer Tube
- 4. PowerTrackSupport
- 5. TrackSupportCover
- 6. SpacerTube
- 7. PowerTrackSupport
- 8. TrackSupportCover
- 9. PowerTrackSupport
- 10. TrackSupportCover
- 11. SupportBracket
- 12. SupportBracket
- 13. SupportBracket
- 14. Hose Cover
- 15. TrackSupportCover
- 16. SupportBracket

Figure 4-48. Powertrack Installation - Sheet 3 of 4

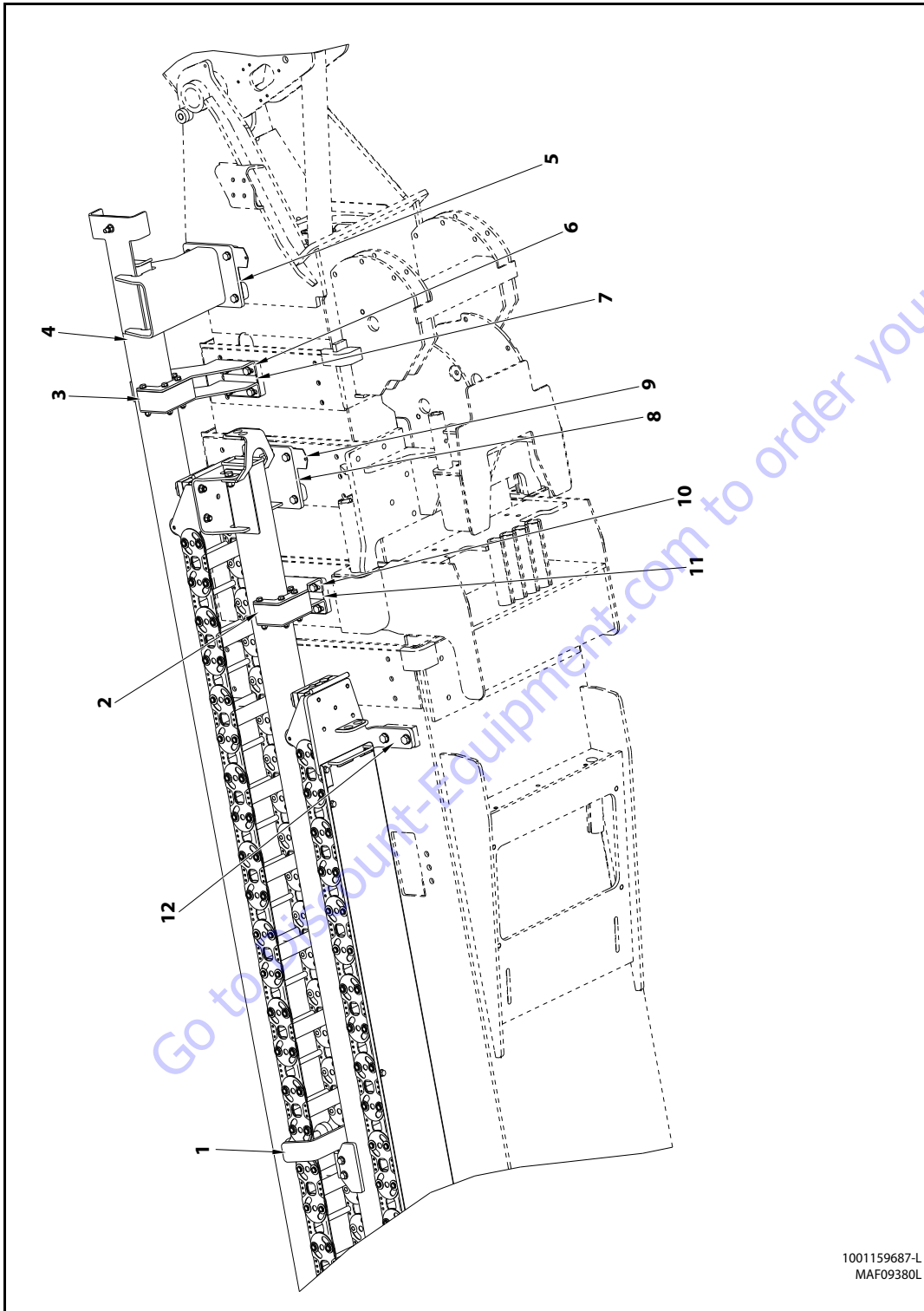

1001159687-L
MAF09380L

- 1. Support Bracket
- 2. Push Tube Pad
- 3. Push Tube Pad
- 4. Upper Push Tube Assembly
- 5. Adjusting Shims
- 6. Mounting Plate
- 7. Adjusting Shims
- 8. Lower Push Tube Assembly
- 9. Adjusting Shims
- 10. Mounting Plate
- 11. Adjusting Shims
- 12. Support Bracket

Figure 4-49. Powertrack Installation - Sheet 4 of 4

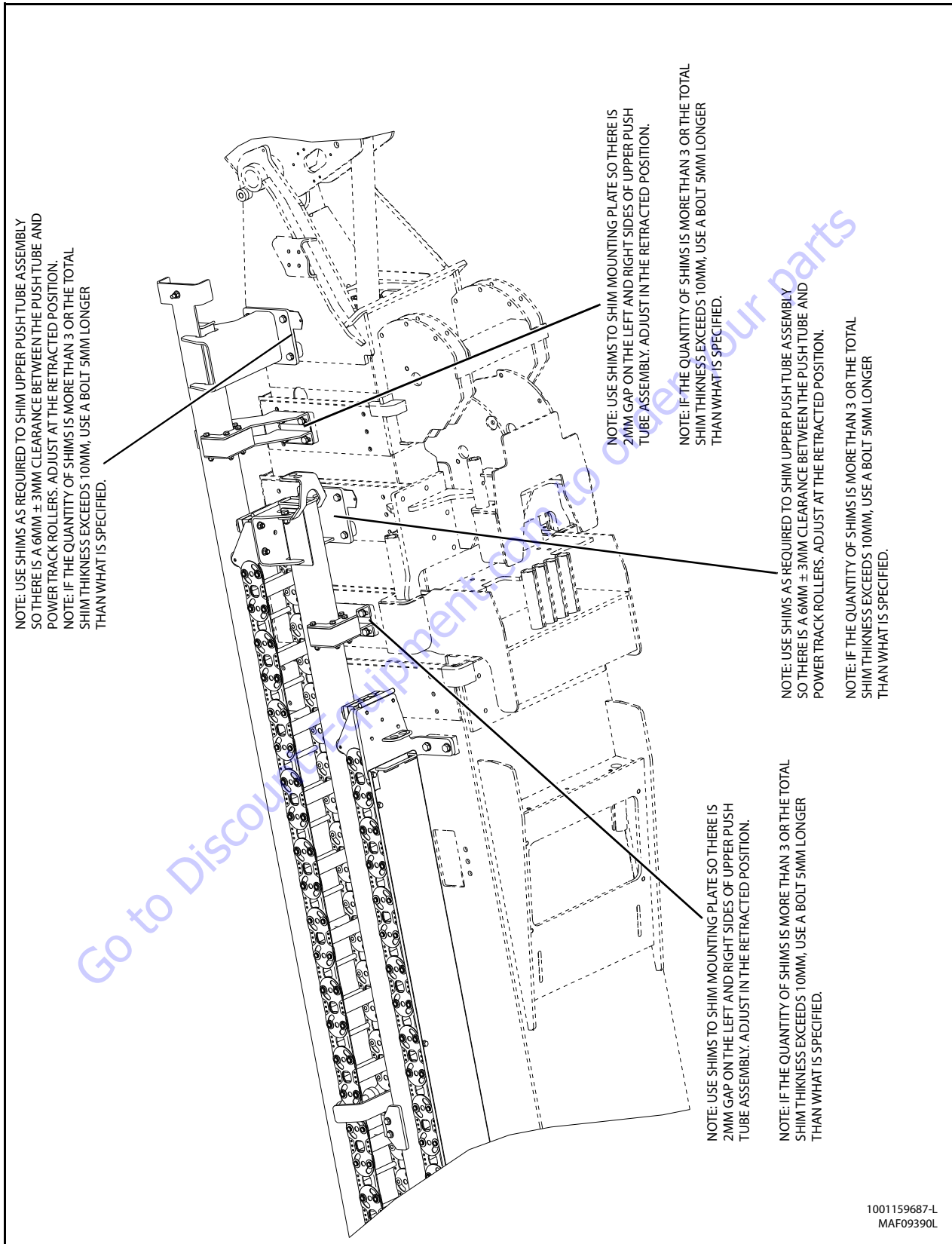

Figure 4-50. Powertrack Shimming Instructions

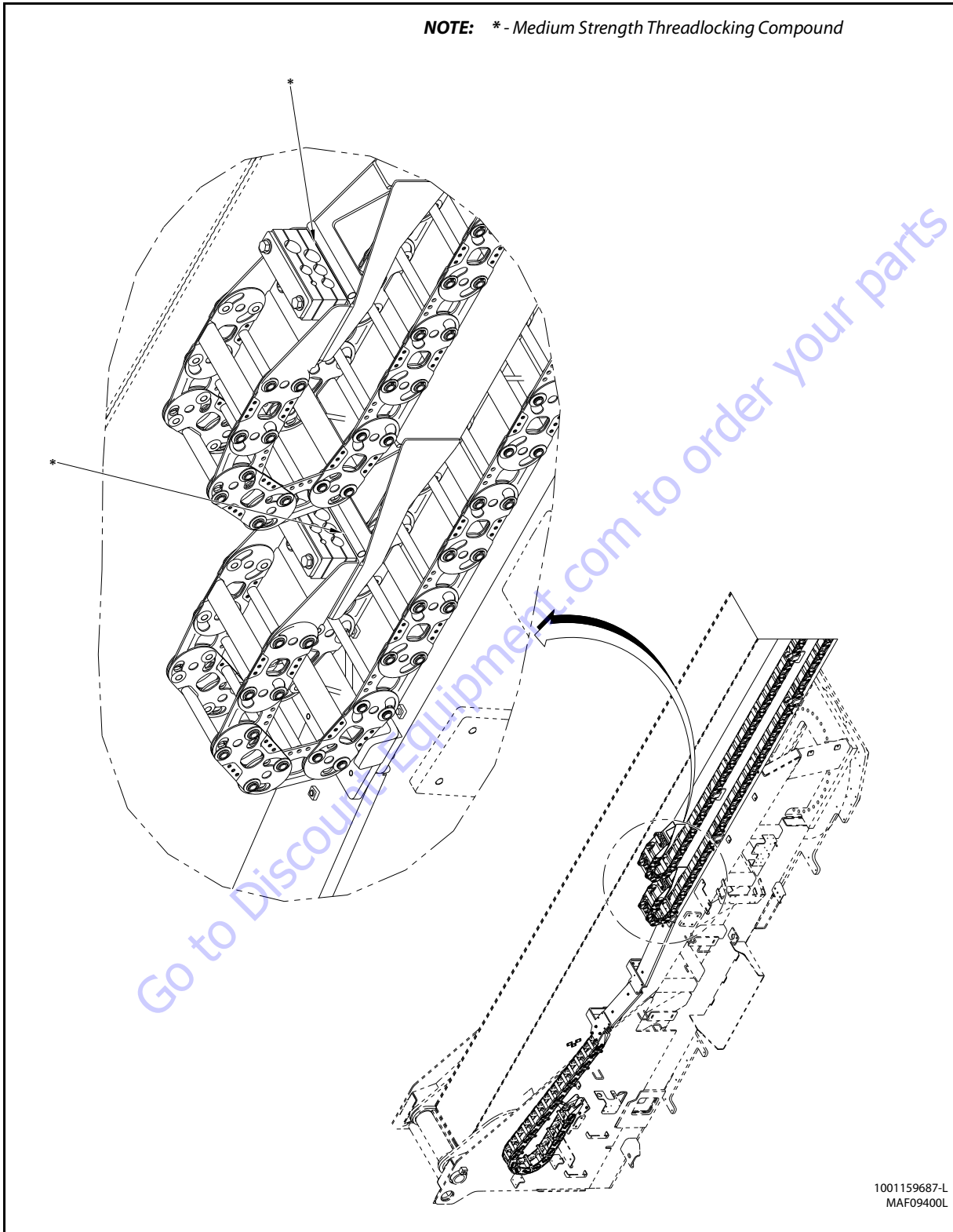

Figure 4-51. Powertrack Locations for Threadlocker Application and Torque - Sheet 1 of 4

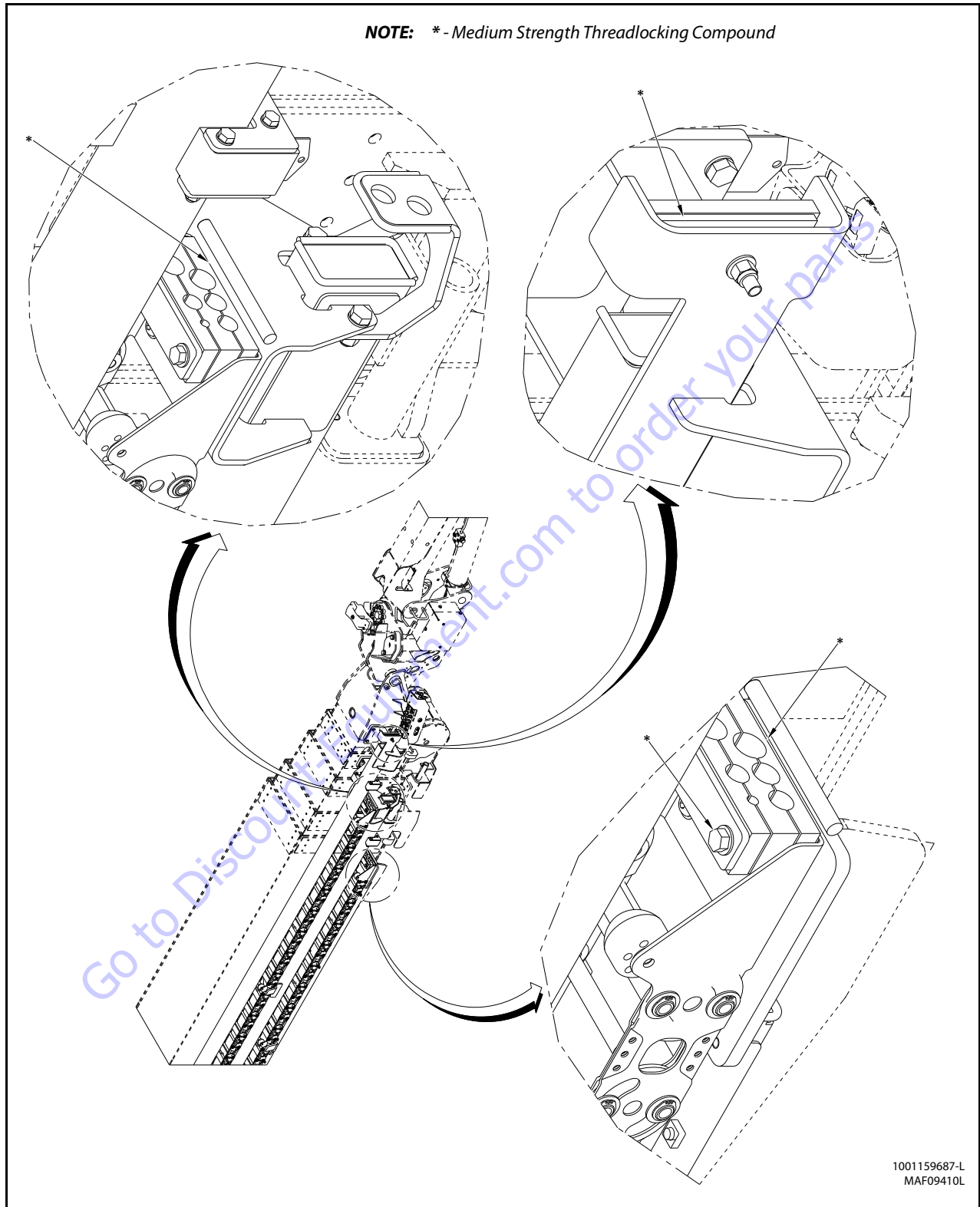

Figure 4-52. Powertrack Locations for Threadlocker Application and Torque - Sheet 2 of 4

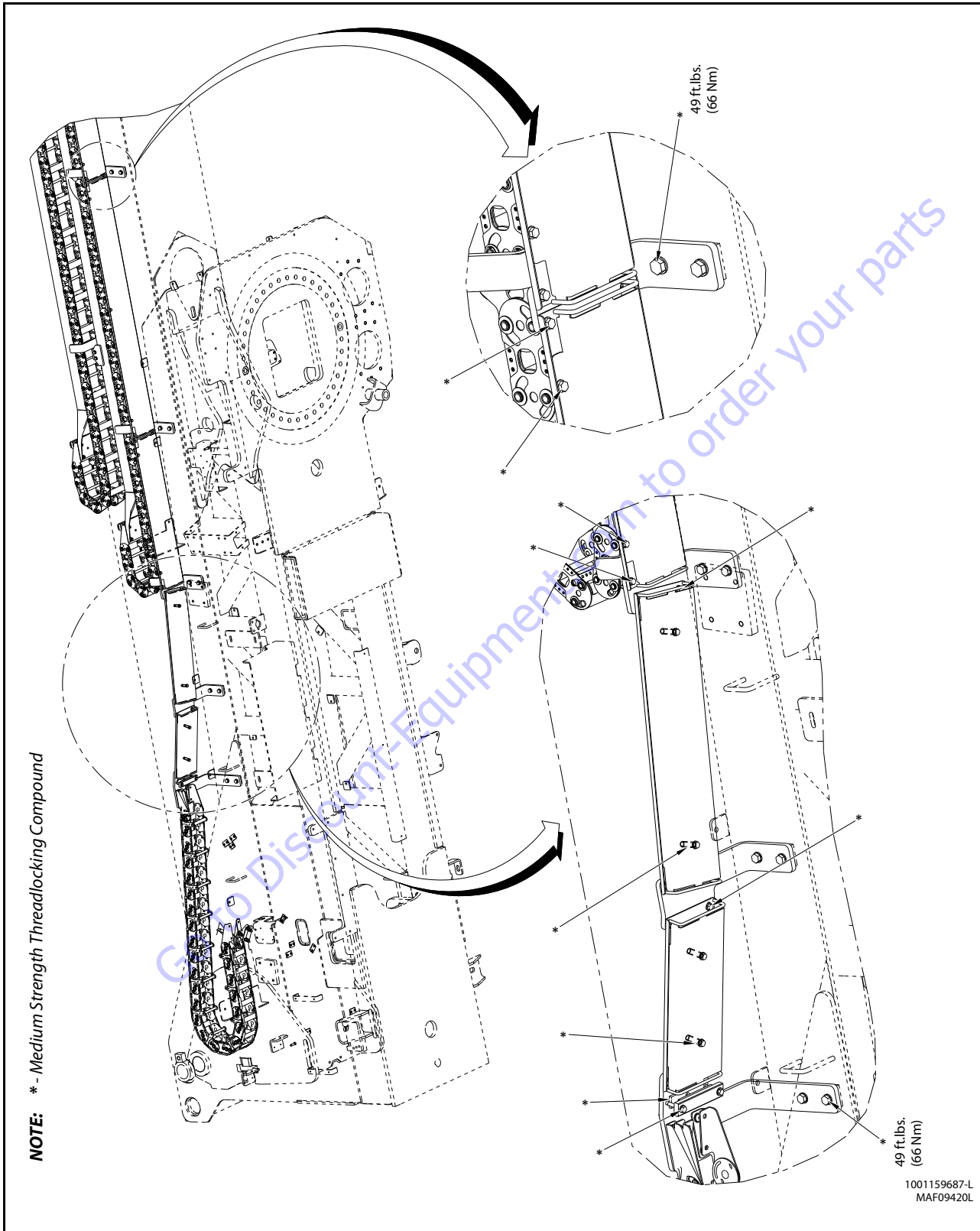

Figure 4-53. Powertrack Locations for Threadlocker Application and Torque - Sheet 3 of 4

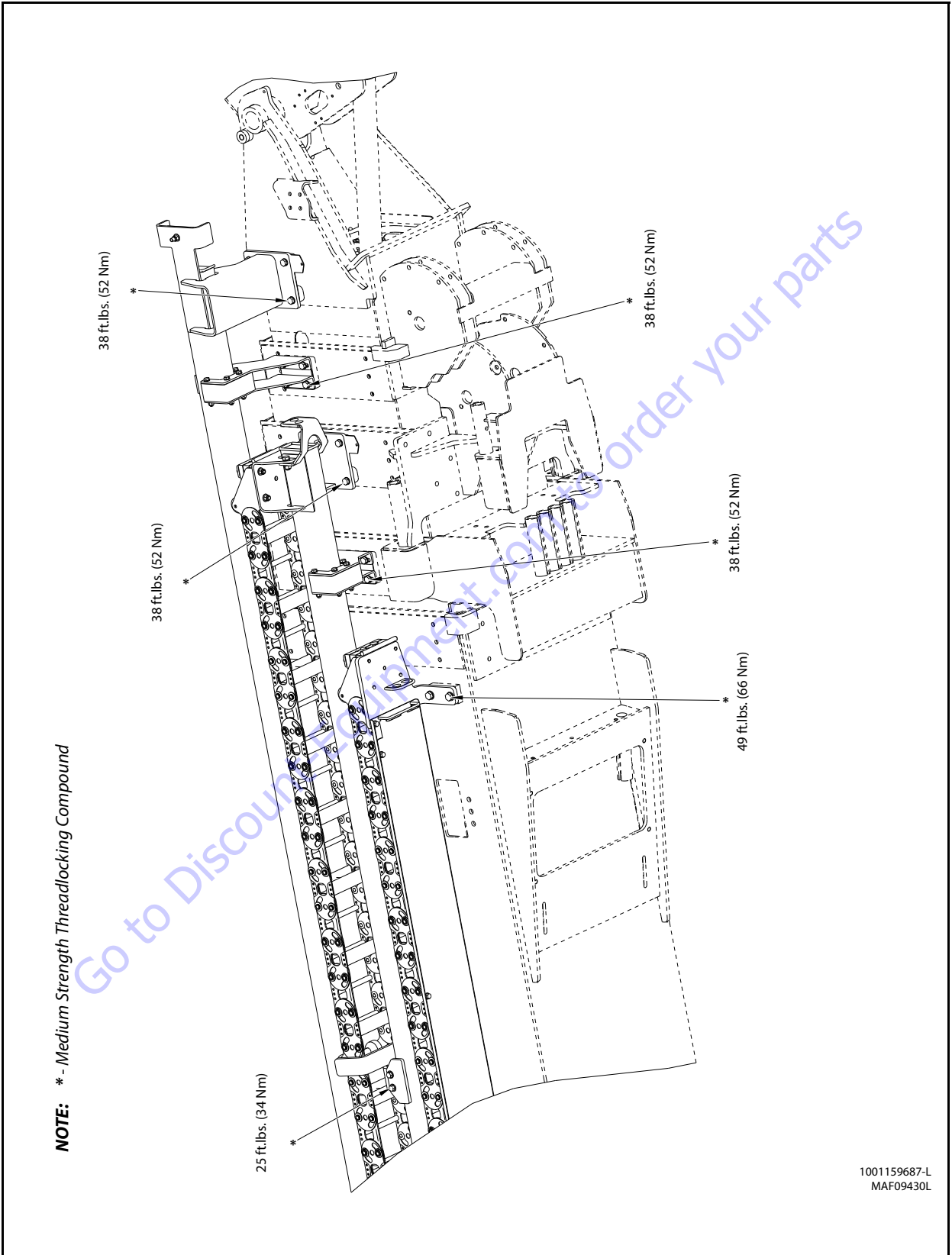

Figure 4-54. Powertrack Locations for Threadlocker Application and Torque - Sheet 4 of 4

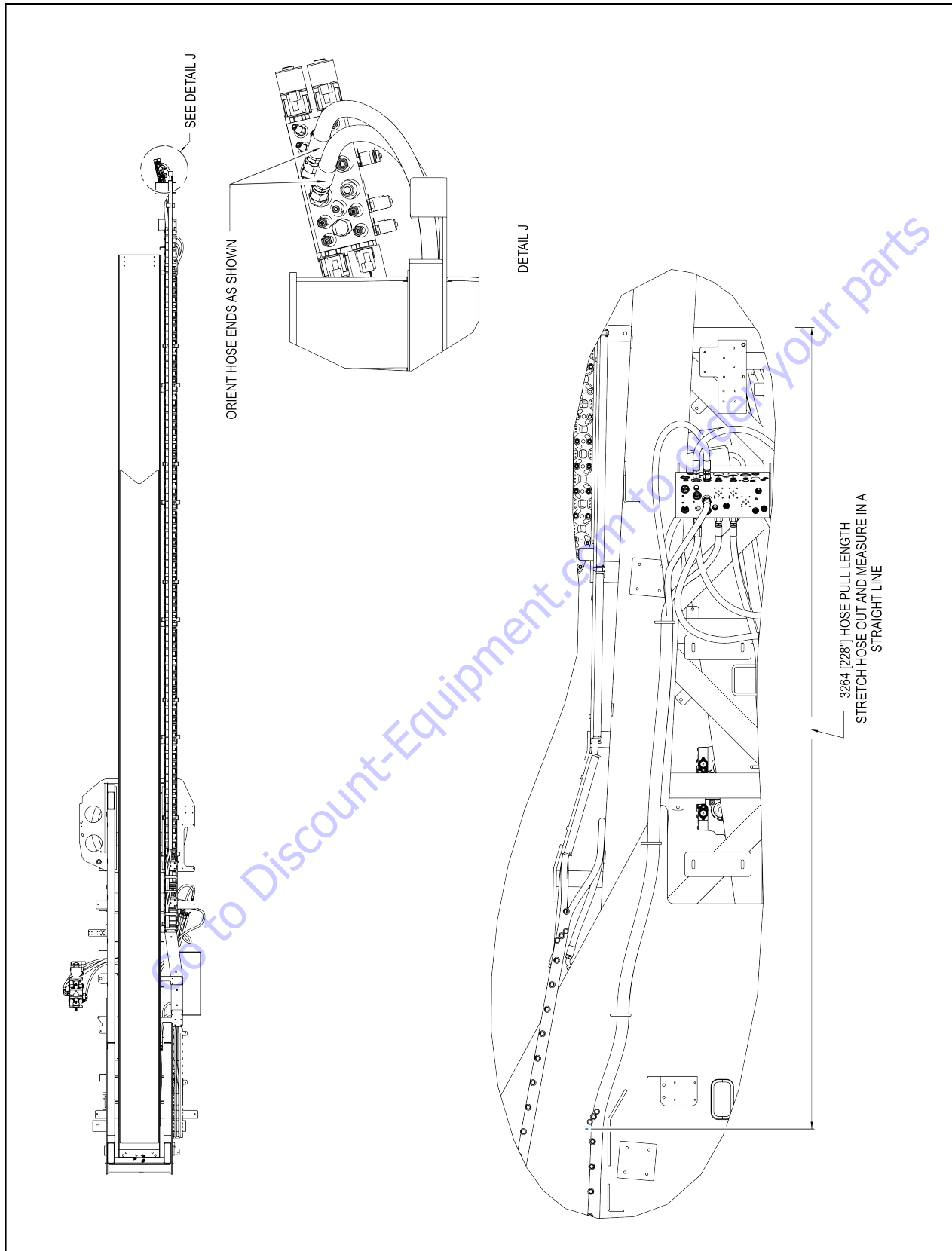

Figure 4-55. Powertrack Hose Installation - Sheet 1 of 4

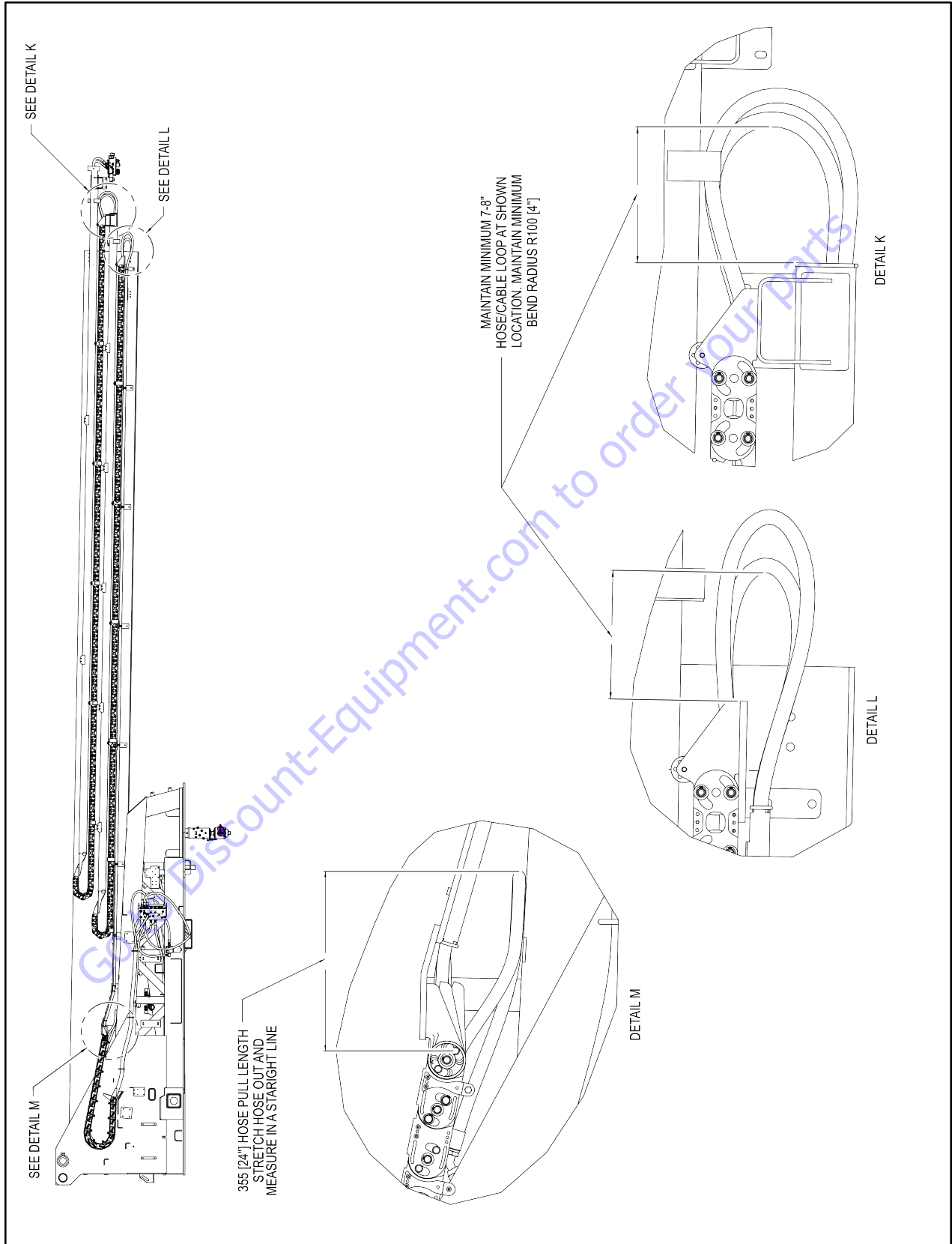

Figure 4-56. Powertrack Hose Installation - Sheet 2 of 4

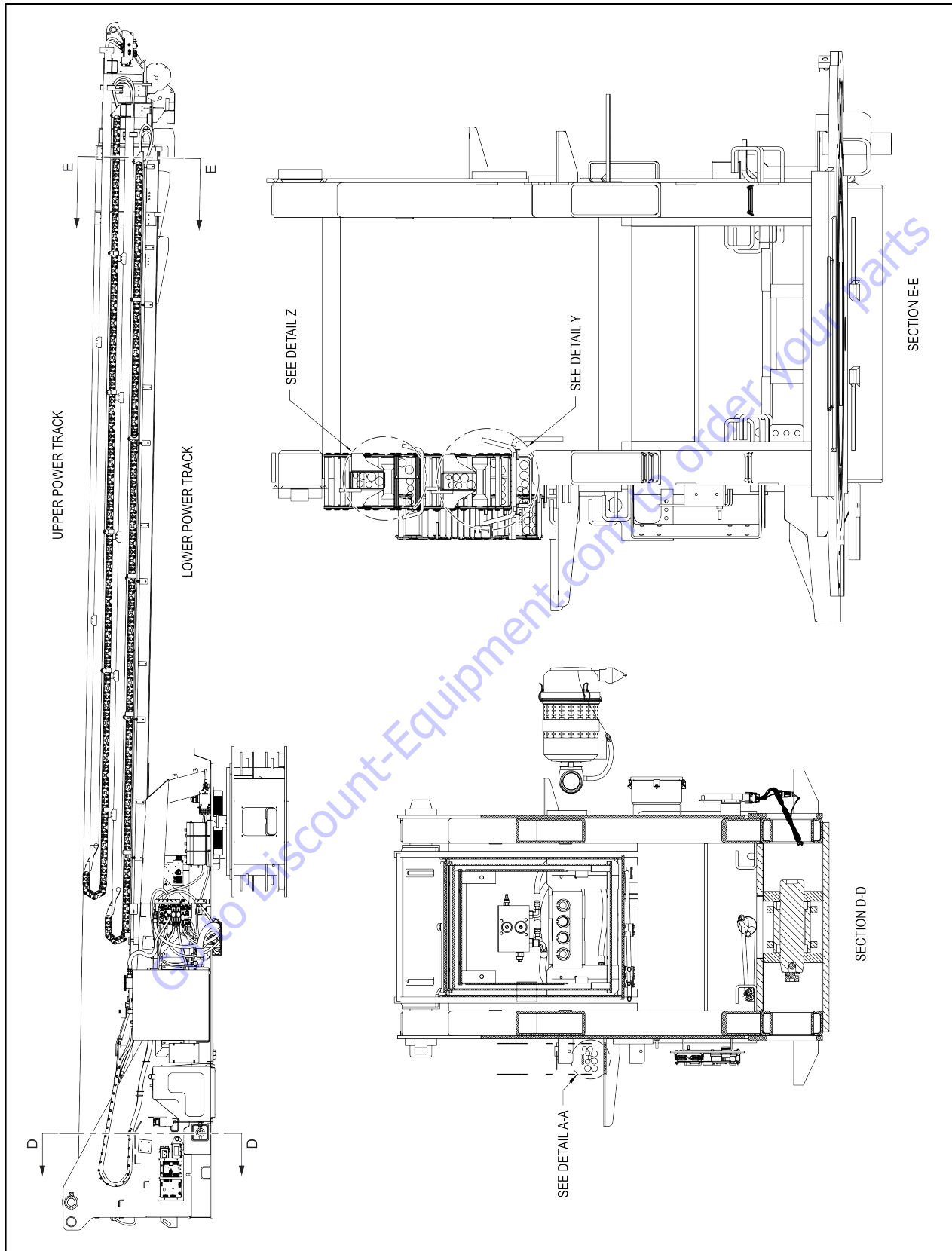

Figure 4-57. Powertrack Hose Installation - Sheet 3 of 4

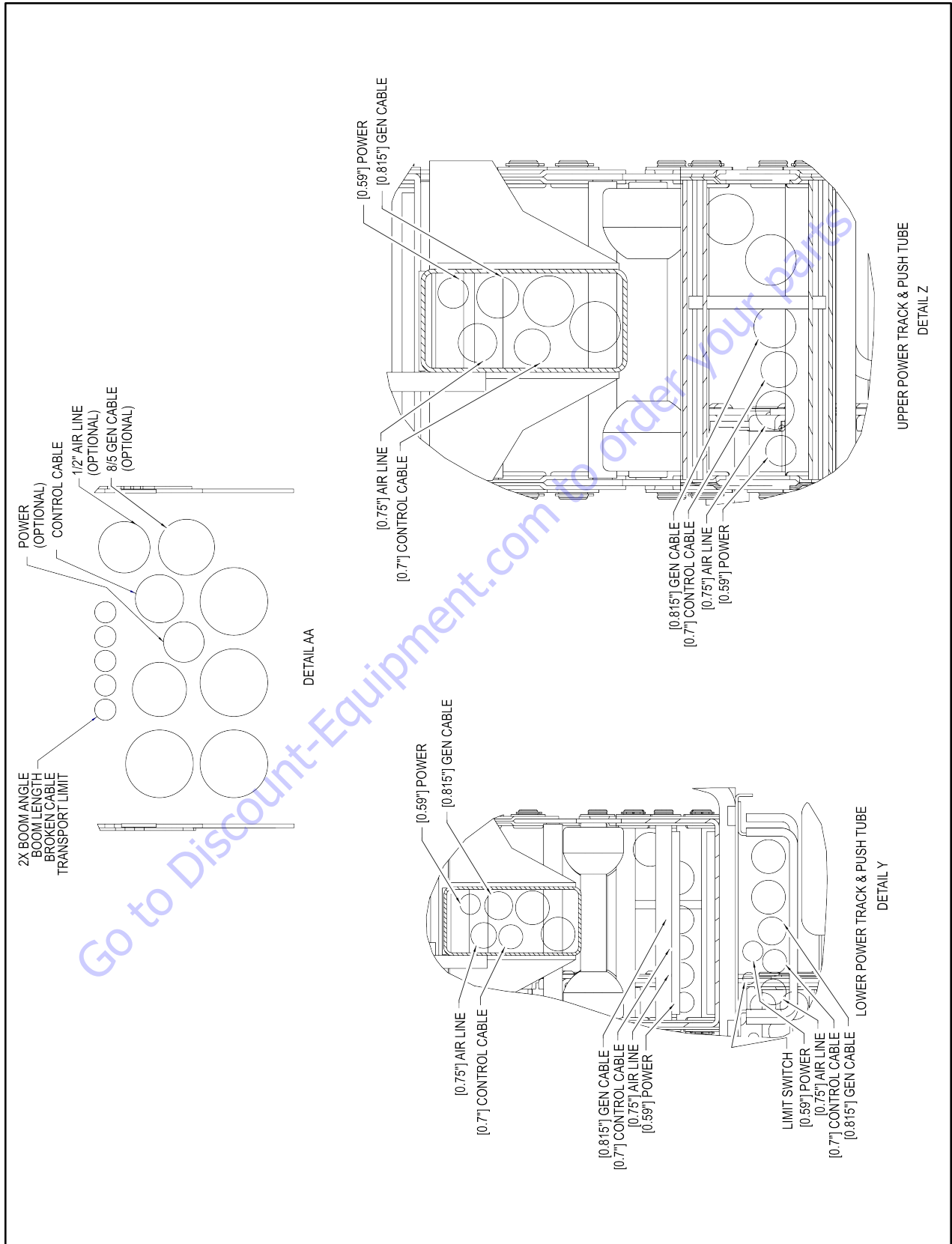
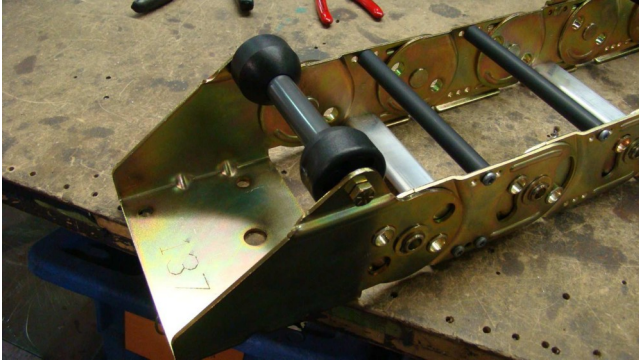

Figure 4-58. Powertrack Hose Installation - Sheet 4 of 4

4.16 POWERTRACK MAINTENANCE

One Piece Bracket Maintenance

1. Place the powertrack on a workbench.



2. Remove the screws from the bars on one side of the powertrack on the first link.



3. Remove the screws from the flat bar on the other side of the powertrack.



4. Pull up on the loose side of the round bar to allow the poly roller to slide off.



- 5.** Slide the poly roller off of the round bar.



- 7.** Slide the flat bar out.

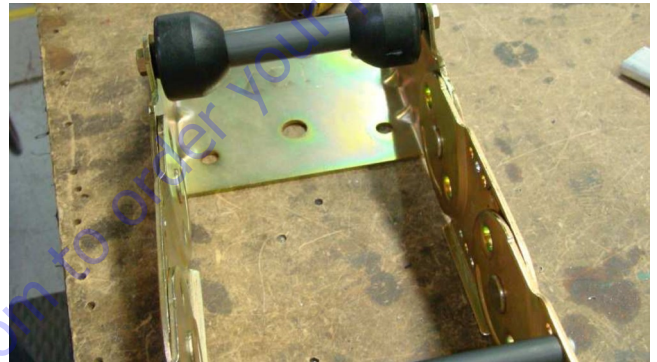
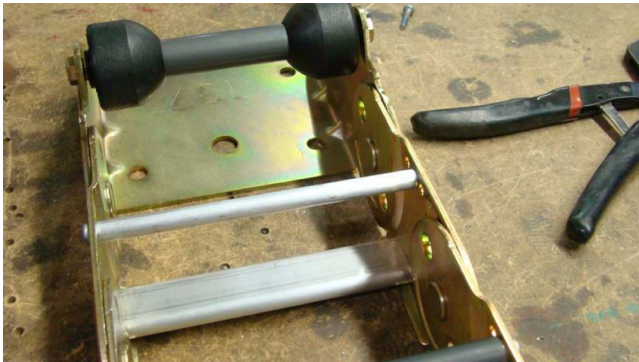
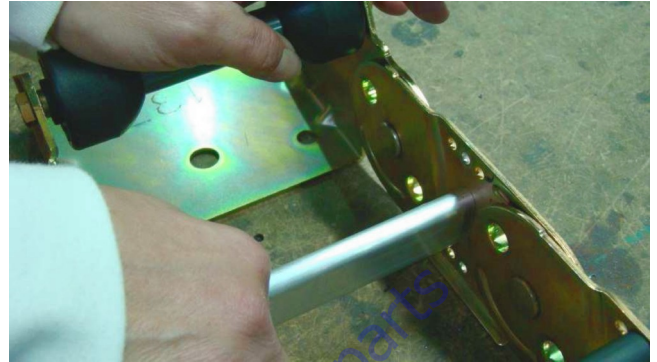

- 6.** Hold the round bar to remove the other screw.

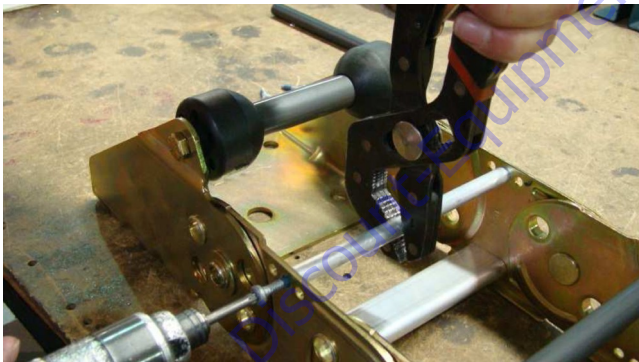

- 8.** Remove the snap ring from one side of the bracket.



- 9.** Remove the snap ring from the other side of the bracket.

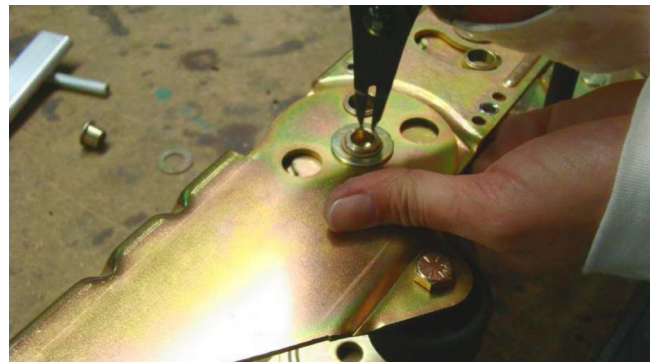

10. Push down with slight pressure on the link and slide the bracket side up and over the extrusion on the link.

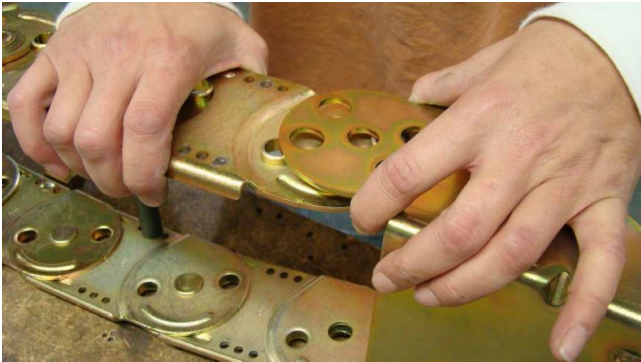

11. Repeat the previous step on the other side.



12. Slide the bracket off of the powertrack.



Two Piece Bracket Maintenance

1. Loosen the screw.

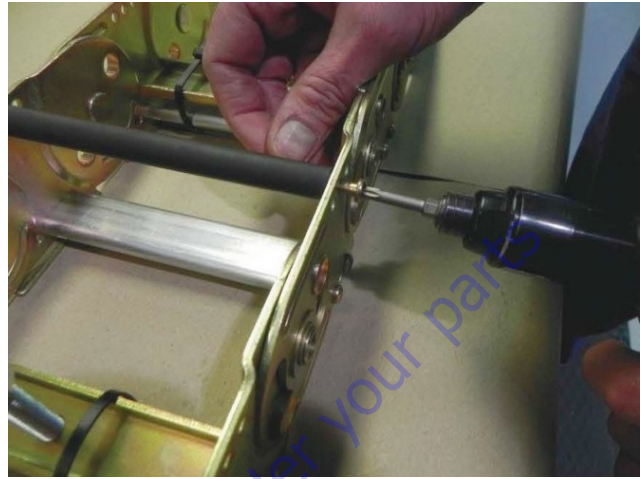

2. Slide the roller off the bar.



3. Hold the bar tightly and remove the other screw.



4. Hold the flat bar and remove the screws.

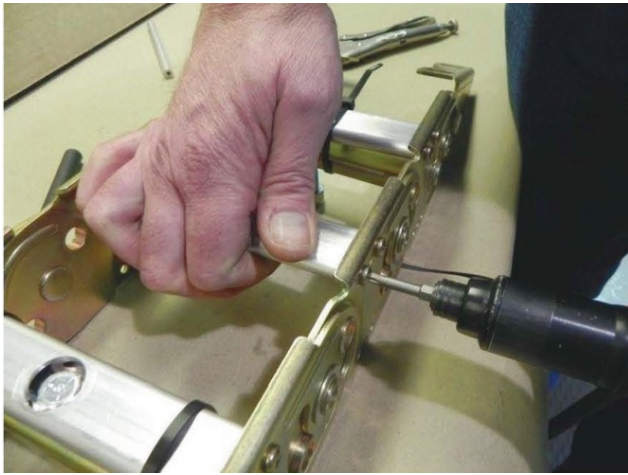

7. Slide the link out.



5. Remove the snap rings and pins.



Snap Rings and Screws

NOTICE

WHEN PERFORMING MAINTENANCE ON THE POWERTRACK, MAKE SURE TO DISCARD AND REPLACE ALL OLD SCREWS.

Make sure screws are tight and installed properly.

6. Remove the screws from the bar. Remove the snap ring and pin.

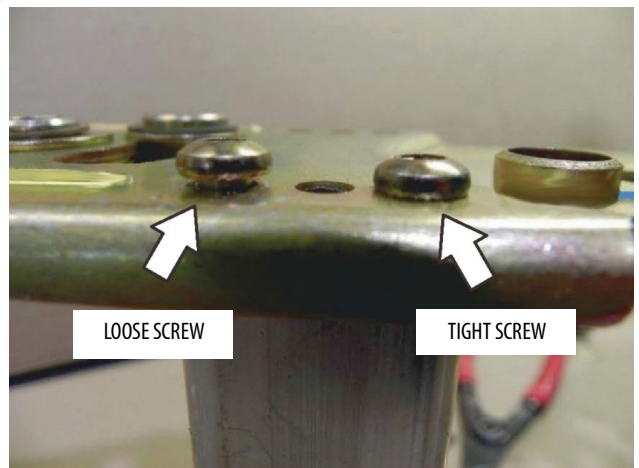

SECTION 4 - BOOM & PLATFORM

Make sure that all snap rings are closed and seated.

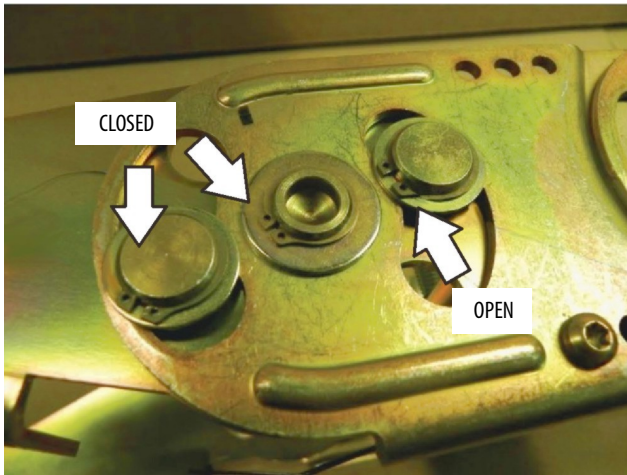

An open snap ring is shown below.



A snap ring that is not seated is shown below.

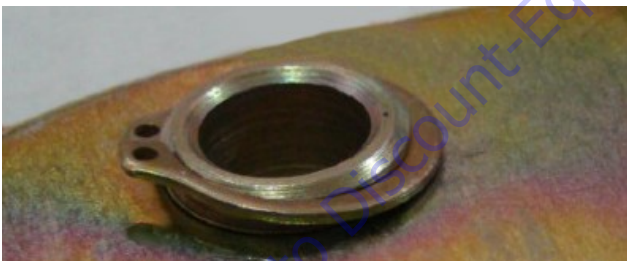

A seated and closed snap ring is shown below.



10-24 x 0.812 button torx socket head with blue locking patch:

- Tighten to 45-50 in.lbs. (5-5.6 Nm).
- Use T-25 torx bit.
- Do not reuse this screw. After removing replace with a new one.

4.17 SKYGUARD®

Operation

SkyGuard provides enhanced control panel protection. When the SkyGuard sensor is activated, functions in use at the time of actuation will reverse or cutout. The SkyGuard Function Table provides more details on these functions.

Consult the following illustrations to determine which type of SkyGuard the machine is equipped with. Regardless of the type, SkyGuard function according to the SkyGuard Function Table does not change.

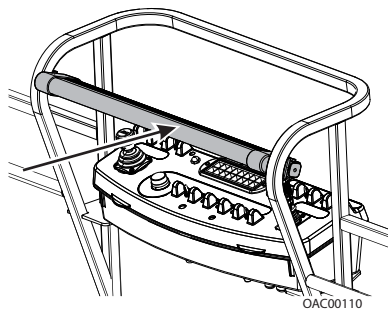

SkyGuard

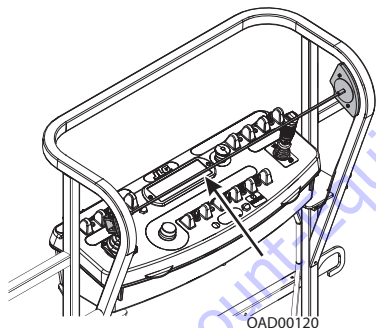

SkyGuard SkyLine™

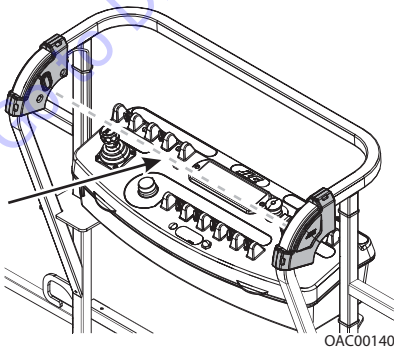

SkyGuard SkyEye™

⚠ WARNING

THE MACHINE OPERATOR IS REQUIRED TO PERFORM A DAILY FUNCTION TEST TO ENSURE PROPER OPERATION OF THE SKYGUARD SYSTEM.

Function Test

SKYGUARD ONLY

Perform this function test if **SkyGuard only** is selected in machine setup (refer to Table 6-2).

From the Platform Control Console in an area free from obstructions:

1. Operate the telescope out function, then activate SkyGuard sensor.
2. Once sensor has been activated, ensure telescope out function stops then telescope in function operates for a short duration. Additionally, verify Soft Touch/SkyGuard indicator light flashes and horn sounds. If machine is equipped with SkyGuard beacon, ensure it flashes when sensor activates.
3. With SkyGuard sensor still engaged, press and hold yellow Soft Touch/SkyGuard override button. Operate a function to verify operation can be resumed.
4. Disengage SkyGuard sensor, release controls, and recycle footswitch. Ensure normal operation available.

In Ground Mode:

1. Operation is allowed regardless of SkyGuard activation.

BOTH SKYGUARD AND SOFT TOUCH

Perform this procedure **if both SkyGuard and Soft Touch** are selected in machine setup (refer to Table 6-2).

From the Platform Control Console in an area free from obstructions:

NOTE: Machine will treat Soft Touch/SkyGuard override switch as if it is a Soft Touch and SkyGuard switch.

1. Operate the telescope out function, then activate SkyGuard sensor.
2. Once sensor has been activated, ensure telescope out function stops. Additionally, verify Soft Touch/SkyGuard indicator light flashes and horn sounds. If machine is equipped with SkyGuard beacon, ensure it flashes when sensor activates.
3. With SkyGuard sensor still engaged, press and hold yellow Soft Touch/SkyGuard override button. Operate a function to verify operation can be resumed.
4. Disengage SkyGuard sensor, release controls, and recycle footswitch. Ensure sure normal operation is available.

In Ground Mode:

1. Operation is allowed regardless of SkyGuard activation.

SOFT TOUCH ONLY

If **Soft Touch only** is selected in machine setup (refer to Table 6-2), machine will treat the Soft Touch/SkyGuard override switch as if it is a Soft Touch switch.

SKYGUARD NOT SELECTED IN MACHINE SETUP

If the SkyGuard system is installed on the machine, but no option is selected in the machine setup (refer to Table 6-2), SkyGuard sensor status will be ignored. No function cutout or reversal will be implemented.

Diagnostics & Troubleshooting

If SkyGuard does not function when the sensor is engaged, first verify the configuration under the MACHINE SETUP: SKYGUARD OPTION menu using the hand-held Analyzer. Ensure the selected configuration matches the actual system installed on the machine. If not, select the correct configuration, then verify operation.

Additionally, use the handheld analyzer to navigate to the DIAGNOSTICS: FEATURES → SKYGUARD INPUTS menu to determine additional SkyGuard fault information.

Engage the SkyGuard sensor and observe the Analyzer to determine if the switch/relay closes.

If the status of the switch/relay remains OPEN while the SkyGuard sensor is actively engaged, it is possible the sensor has failed and should be replaced immediately.

If the status of the switch/relay remains CLOSED while the SkyGuard sensor is actively engaged, a power or ground wire may not be making good contact or may be loose or broken. Additionally, there is a low probability that both relays may have failed.

If the switch/relay status is in disagreement, then one may have failed or is not installed correctly. In this case, the machine will be inoperable.

FAULT CODES

Refer to Table 6-12 for more fault code information

- **0039** - SkyGuard switch activation fault
- **2563** - switch disagreement fault

Table 4-1. SkyGuard Function Table

Drive Forward	Drive Reverse	Steer	Swing	Boom Lift Up	Boom Lift Down	Boom Tele Out	Boom Tele In	Jib Lift	Jib Swing	Jib Tele	Basket Level	Basket Rotate
R*/C**	R	C	R	R	R	R	C	C	C	C	C	C
R= Indicates Reversal is Activated												
C= Indicates Cutout is Activated												
* DOS (Drive Orientation System) Enabled												
** DOS Not Enabled, machine is driving straight without steering, and any other hydraulic function is active												
NOTE: If SkyGuard is enabled with the Soft Touch system, functions will cut out instead of reversing.												

4.18 BOLT-ON EXTERNAL FALL ARREST

The bolt-on external fall arrest system is designed to provide a lanyard attach point while allowing the operator to access areas outside the platform. Exit/Enter the platform through the gate area only. The system is designed for use by one person.

Personnel must use fall protection at all times. A full body harness is required with lanyard not to exceed 6 ft. (1.8 M) in length, that limits the maximum arrest force to 900 lb (408 kg).

The bolt-on external fall arrest System capacity is 310 lb (140 kg) - one (1) person maximum.

Do not move the platform during use of the bolt-on external fall arrest system.

⚠ WARNING

DO NOT OPERATE ANY MACHINE FUNCTIONS WHILE OUTSIDE OF PLATFORM. BE CAREFUL WHEN ENTERING/EXITING THE PLATFORM AT ELEVATION.

⚠ WARNING

IF THE BOLT-ON EXTERNAL FALL ARREST SYSTEM IS USED TO ARREST A FALL OR IS OTHERWISE DAMAGED, THE ENTIRE SYSTEM MUST BE REPLACED AND THE PLATFORM FULLY INSPECTED BEFORE RETURNING TO SERVICE. REFER TO THE SERVICE MANUAL FOR REMOVAL AND INSTALLATION PROCEDURES.

THE BOLT-ON EXTERNAL FALL ARREST SYSTEM REQUIRES AN ANNUAL INSPECTION AND CERTIFICATION. THE ANNUAL INSPECTION AND CERTIFICATION MUST BE PERFORMED BY A QUALIFIED PERSON OTHER THAN THE USER.

Inspection Before Use

The bolt-on external fall arrest system must be inspected before each use of the Mobile elevating work platform. Replace components if there are any signs of wear or damage.

Before each use, perform a visual inspection of the following components:

- Cable: Inspect cable for proper tension, broken strands, kinks, or any signs of corrosion.

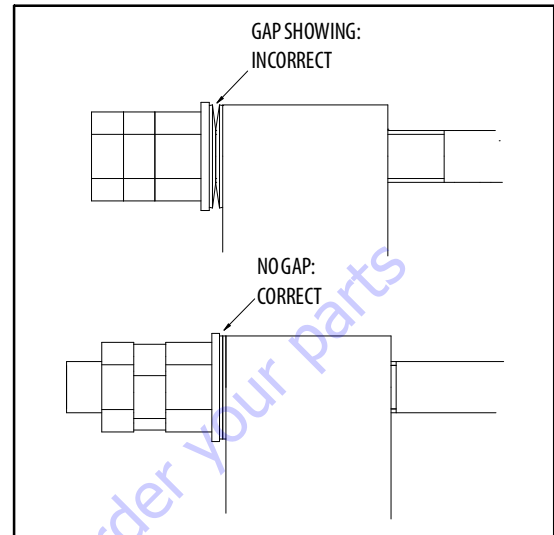
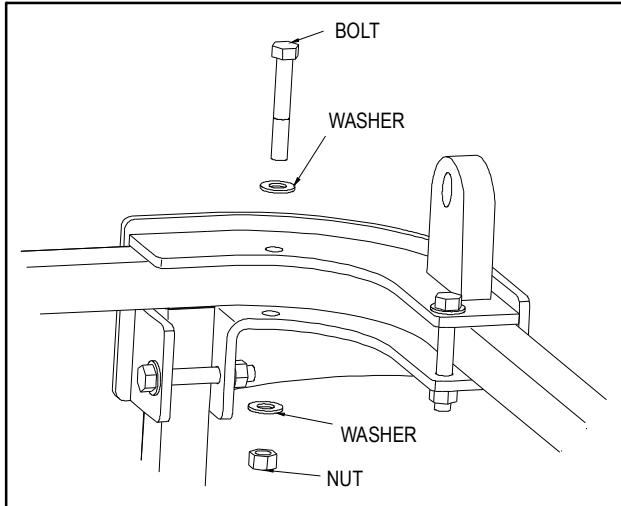

Figure 4-59. Bolt-On External Fall Arrest Cable Tension

- Fittings & Brackets: Ensure all fittings are tight and there are no signs of fractures. Inspect brackets for any damage.
- Attachment Ring: No cracks or signs of wear are acceptable. Any signs of corrosion requires replacement.
- Attaching Hardware: Inspect all attaching hardware to ensure there are no missing components and hardware is properly tightened.
- Platform Rails: No visible damage is acceptable.

Installation

1. Install the retaining hardware (bolts, nuts, and washers) and secure the brackets to the platform rail. Tighten the nuts but do not torque them yet.



2. Attach the fall arrest cable to the right hand bracket Using the attaching bolt and nut. Orient the bolt as shown below. Do not tighten the nut so cable can still rotate.

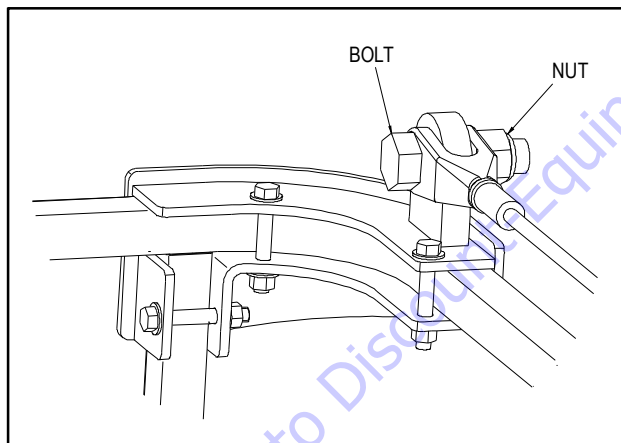

3. Install the Attachment Ring onto the cable.
4. Without twisting the fall arrest cable, pull it thru the left hand bracket and mark the top of the swaged cable end. Install the fall arrest cable through the left hand bracket and secure it using the belleville washers, washer, retaining nut, and jam nuts. Orient the hardware as shown below and with the belleville washers so the gap is present at the outside diameter of the washers. install the

nuts onto the cable finger tight so the mark on the cable does not move.

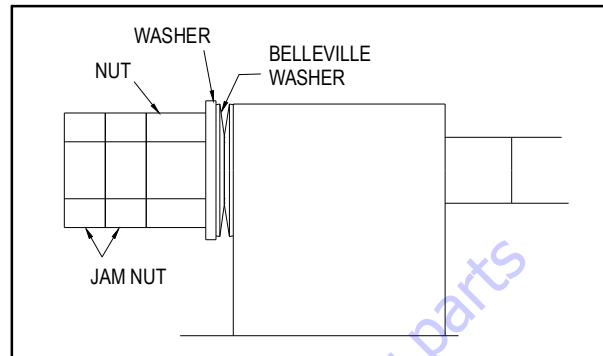

5. Use the two jam nuts to prevent the cable from rotating while the nut is tightened. Tighten the nut until the belleville washers are fully compressed and no gap is present at the outside diameter of the washers. Ensure the cable has not rotated during tightening.

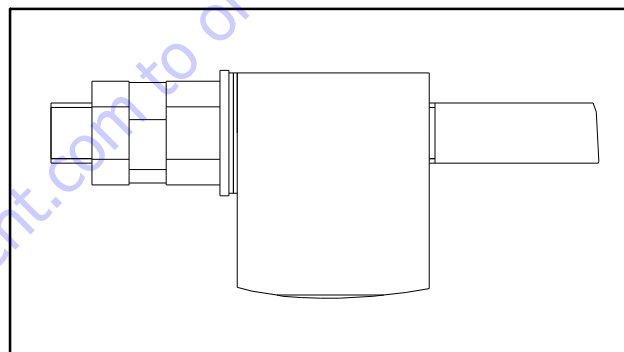

6. Tighten the first jam nut against the retaining nut to keep the nut from loosening. Tighten the remaining jam nut against the first jam nut.
7. Torque the nuts and bolts securing the brackets to 15 ft.lbs. (20 Nm).

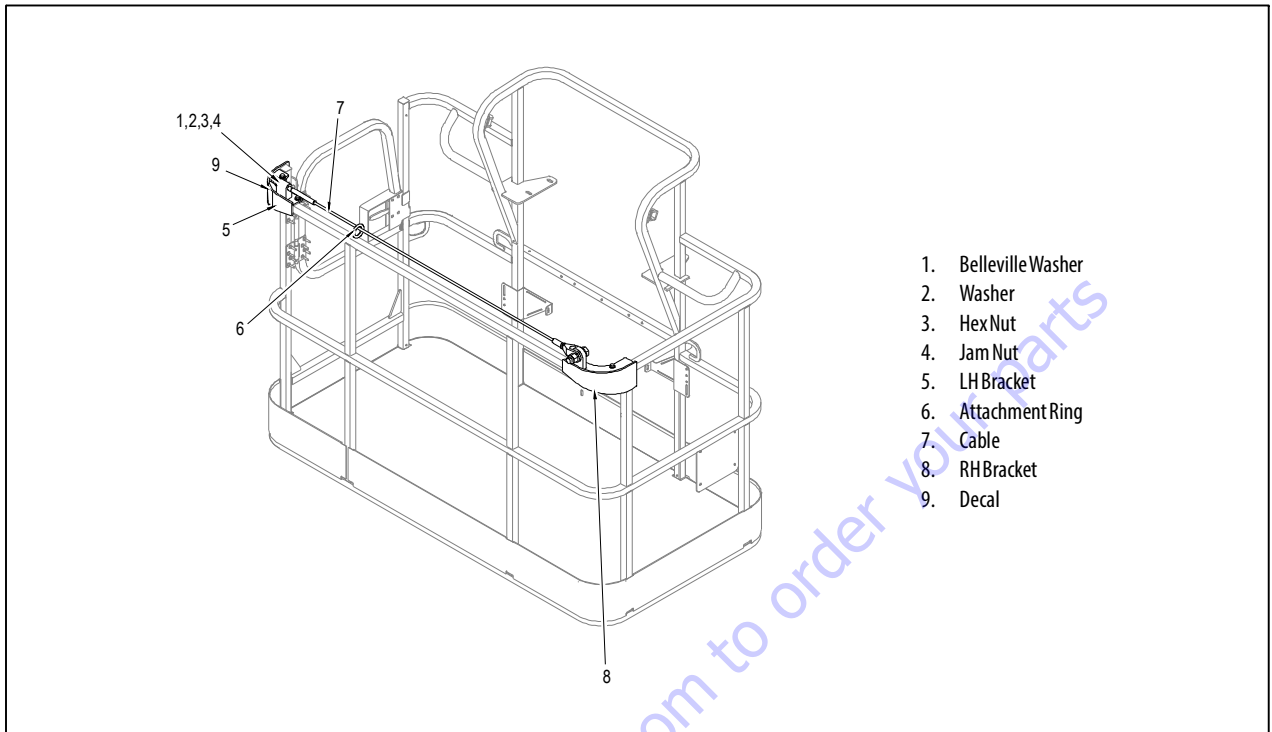

Figure 4-60. Bolt-On External Fall Arrest System

PARTS FINDER

**Search Website
by Part Number**



**Search Manual
Library For Parts
Manual & Lookup Part
Numbers – Purchase
or Request Quote**

Search Manuals

Enter your information to search for manuals and parts.

* Brand:

* Model:

* Serial:

* Part Number:

SEARCH

**Can't Find Part or
Manual? Request Help
by Manufacturer,
Model & Description**

Parts Order Form

Please fill in the following information:

Manufacturer:

Model:

Description:

Quantity:

Part Number:

Part Name:

Part Description:

Part Location:

Part Condition:

Part Status:

Part Price:

Part Weight:

Part Dimensions:

Part Material:

Part Color:

Part Finish:

Part Notes:

Part Images:

Part Attachments:

Part Specifications:

Part Certifications:

Part Compliance:

Part Safety:

Part Environmental:

Part Other:

Submit

Discount-Equipment.com is your online resource for quality parts & equipment.

Florida: **561-964-4949** Outside Florida TOLL FREE: **877-690-3101**

Need parts?

Click on this link: <http://www.discount-equipment.com/category/5443-parts/> and choose one of the options to help get the right parts and equipment you are looking for. Please have the machine model and serial number available in order to help us get you the correct parts. If you don't find the part on the website or on once of the online manuals, please fill out the request form and one of our experienced staff members will get back to you with a quote for the right part that your machine needs.

We sell worldwide for the brands: Genie, Terex, JLG, MultiQuip, Mikasa, Essick, Whiteman, Mayco, Toro Stone, Diamond Products, Generac Magnum, Airman, Haulotte, Barreto, Power Blanket, Nifty Lift, Atlas Copco, Chicago Pneumatic, Allmand, Miller Curber, Skyjack, Lull, Skytrak, Tsurumi, Husquvarna Target, , Stow, Wacker, Sakai, Mi-T- M, Sullair, Basic, Dynapac, MBW, Weber, Bartell, Bennar Newman, Haulotte, Ditch Runner, Menegotti, Morrison, Contec, Buddy, Crown, Edco, Wyco, Bomag, Laymor, Barreto, EZ Trench, Bil-Jax, F.S. Curtis, Gehl Pavers, Heli, Honda, ICS/PowerGrit, IHI, Partner, Imer, Clipper, MMD, Koshin, Rice, CH&E, General Equipment, ,AMida, Coleman, NAC, Gradall, Square Shooter, Kent, Stanley, Tamco, Toku, Hatz, Kohler, Robin, Wisconsin, Northrock, Oztec, Toker TK, Rol-Air, Small Line, Wanco, Yanmar

SECTION 5. BASIC HYDRAULIC INFORMATION & HYDRAULIC SCHEMATICS

5.1 LUBRICATING O-RINGS IN THE HYDRAULIC SYSTEM

When assembling connectors in the hydraulic that use o-ring fittings, it is necessary to lubricate all fittings with hydraulic oil prior to assembly. To lubricate the fittings, use one of the following procedures.

NOTE: All O-ring fittings must be pre-lubricated with hydraulic oil prior to assembly.

Cup and Brush

The following is needed to correctly oil the o-ring in this manner:

- A small container for hydraulic oil
- Small paint brush



1. Hold the fitting in one hand while using the brush with the other hand to dip into the container. Remove excess hydraulic oil from the brush so an even film of oil is applied on the o-ring.



2. Holding the fitting over the hydraulic oil container, brush an even film of oil around the entire o-ring in the fitting, making sure the entire o-ring is completely saturated.



3. Turn the o-ring on the other side of the fitting and repeat the previous step, ensuring the entire o-ring is coated with hydraulic oil.



Dip Method

NOTE: This method works best with Face Seal o-rings, but will work for all o-ring fitting types.

The following is needed to correctly oil the o-ring in this manner:

- A small leak proof container
 - Sponge cut to fit inside the container
 - A small amount of hydraulic oil to saturate the sponge.
1. Place the sponge inside the container and add hydraulic oil to the sponge until it is fully saturated.
 2. Dip the fitting into the sponge using firm pressure. Upon lifting the fitting, a small droplet will form and drip from the bottom of the fitting. This should signify an even coating of oil on the fitting.



3. O-ring Boss type fittings will require more pressure in able to immerse more of the fitting into the saturated sponge. This will also cause more oil to be dispersed from the sponge.

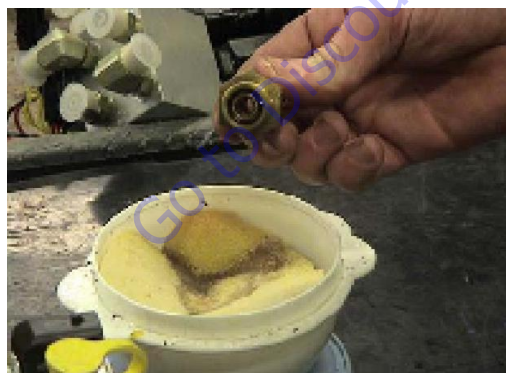

Spray Method

This method requires a pump or trigger spray bottle.

1. Fill the spray bottle with hydraulic oil.
2. Hold the fitting over a suitable catch can.
3. Spray the entire o-ring surface with a medium coat of oil.



Brush-on Method

This method requires a sealed bottle brush.

1. Fill the bottle with hydraulic oil.
2. Using slight pressure to the body of the spray bottle, invert the bottle so the brush end is in the downward position.
3. Brush hydraulic oil on the entire o-ring, applying an even coat of oil.



5.2 HYDRAULIC CONNECTION ASSEMBLY AND TORQUE SPECIFICATION

Tapered Thread Types

NPTF = national tapered fuel (Dry Seal) per SAE J476/J512

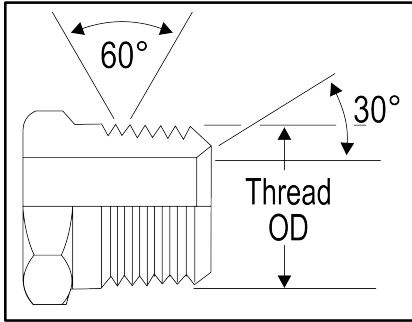

Figure 5-1. NPTF Thread

BSPT = British standard pipe tapered per ISO7-1

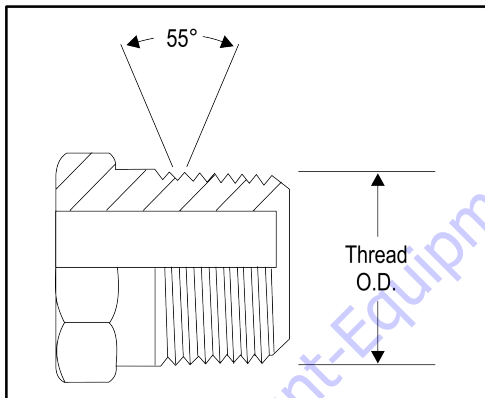

Figure 5-2. BSPT Thread

Straight Thread Types, Tube and Hose Connections

JIC = 37° flare per SAE J514

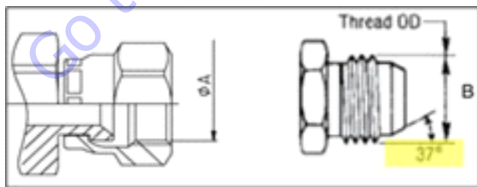

Figure 5-3. JIC Thread

SAE = 45° flare per SAE J512

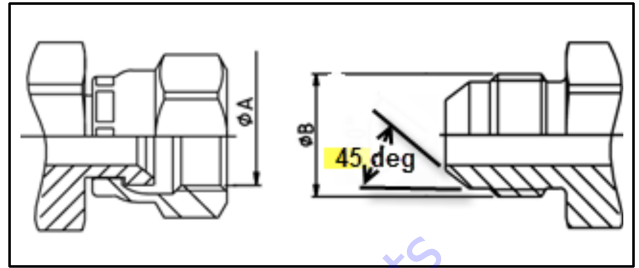

Figure 5-4. SAE Thread

ORFS = o-ring face seal per SAE J1453

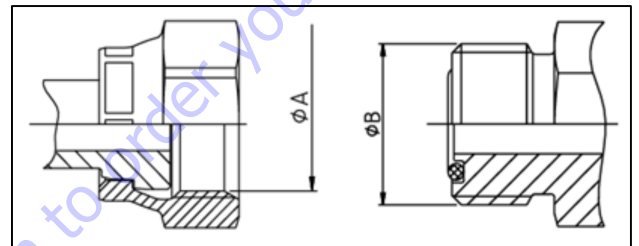

Figure 5-5. ORFS Thread

MBTL = metric flareless bite type fitting, pressure rating L (medium) per ISO 8434, DIN 2353

MBTS = metric flareless bite type fitting, pressure rating S (high) per ISO 8434, DIN 2353

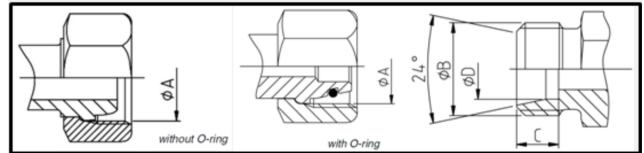

Figure 5-6. MTBL-MBTS Thread

BH = bulkhead connection – JIC, ORFS, MBTL, or MBTS types

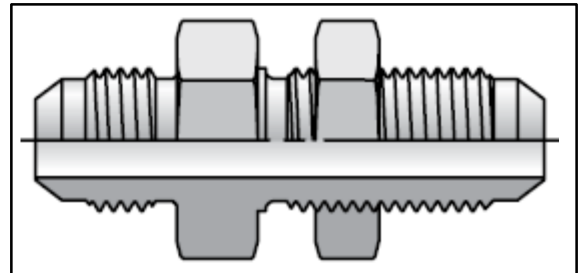

Figure 5-7. Bulkhead Thread

Straight Thread Types, Port Connections

ORB = o-ring boss per SAE J1926, ISO 11926

MPP = metric pipe parallel o-ring boss per SAE J2244, ISO 6149, DIN 3852

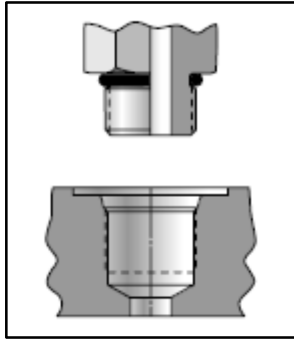

Figure 5-8. ORB-MPP Thread

MFF = metric flat face port per ISO 9974-1

BSPP = British standard parallel pipe per ISO 1179-1, DIN 3852-2

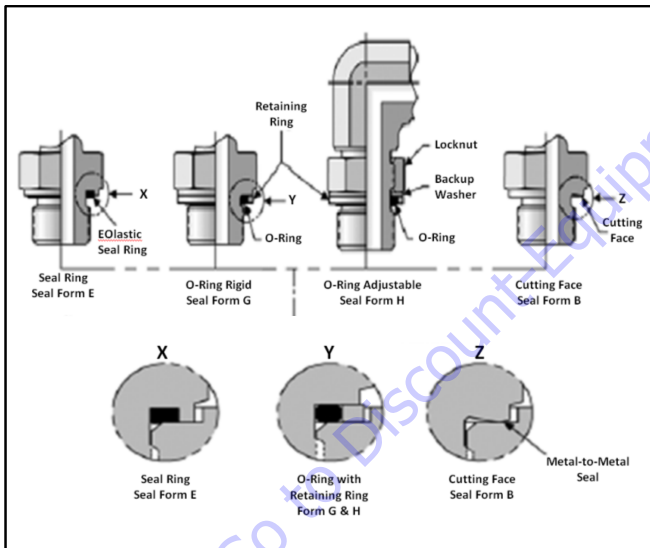

Figure 5-9. MFF-BSPP Thread

Flange Connection Types

FL61 = code 61 flange per SAE J518, ISO 6162

FL62 = code 62 flange per SAE J518, ISO 6162

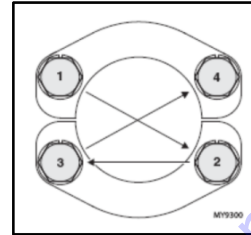

Figure 5-10. ORB-MPP Thread

Tightening Methods

Torque = Application of a twisting force to the applicable connection by use of a precise measurement instrument (i.e. torque wrench).

Finger Tight = The point where the connector will no longer thread onto the mating part when tightened by hand or fingers. Finger Tight is relative to user strength and will have some variance. The average torque applied by this method is 3 ft-lbs [4 N-m] Also referred to as 'Hand Tight.'

TFFT = Turns From Finger Tight; Application of a preload to a connection by first tightening the connection by hand (fingers) and applying an additional rotation counted by a defined number of turns by use of a tool.

FFWR = Flats from Wrench Resistance; Application of a preload to a connection by tightening to the point of initial wrench resistance and turning the nut a described number of 'flats'. A 'flat' is one side of the hexagonal tube nut and equates to 1/6 of a turn. Also referred to as the 'Flats Method.'

Assembly And Torque Specifications

Prior to selecting the appropriate torque from the tables within this section, it is necessary to properly identify the connector being installed. Refer to the Figures and Tables in this section.

GENERAL TUBE TYPE FITTING ASSEMBLY INSTRUCTIONS

1. Take precautions to ensure that fittings and mating components are not damaged during storage, handling or assembly. Nicks and scratches in sealing surfaces can create a path for leaks which could lead to component contamination and/or failure.
2. When making a connection to tubing, compression or flare, inspect the tube in the area of the fitting attachment to ensure that the tube has not been damaged.
3. The assembly process is one of the leading causes for contamination in air and hydraulic systems. Contamination can prevent proper tightening of fittings and adapters from occurring.
 - a. Avoid using dirty or oily rags when handling fittings.
 - b. If fittings are disassembled, they should be cleaned and inspected for damage. Replace fittings as necessary before re-installing.
 - c. Sealing compounds should be applied where specified; however, care should be taken not to introduce sealant into the system.
 - d. Avoid applying sealant to the area of the threads where the sealant will be forced into the system. This is generally the first two threads of a fitting.
 - e. Sealant should only be applied to the male threads.
 - f. Straight thread fittings do not require sealants. O-rings or washers are provided for sealing.
 - g. When replacing or installing an O-ring, care is to be taken while transferring the O-ring over the threads as it may become nicked or torn. When replacing an O-ring on a fitting, the use of a thread protector is recommended.
 - h. When installing fittings with O-rings, lubrication shall be used to prevent scuffing or tearing of the O-ring. See O-ring Installation (Replacement) in this section.
4. Take care to identify the material of parts to apply the correct torque values.
 - a. Verify the material designation in the table headings.
 - b. If specifications are given only for steel fittings and components, the values for alternate materials shall be as follows: Aluminum and Brass- reduce steel values by 35%; Stainless Steel- Use the upper limit for steel.
5. To achieve the specified torque, the torque wrench is to be held perpendicular to the axis of rotation.
6. Refer to the appropriate section in this manual for more specific instructions and procedures for each type of fitting connection

Assembly Instructions for American Standard Pipe Thread Tapered (NPTF) Connections.

1. Inspect components to ensure male and female port threads are free of rust, splits, dirt, foreign matter, or burrs.
2. Apply a suitable thread sealant, such as JLG Threadlocking Compound, to the male pipe threads if not already applied. Ensure the first 1 to 2 threads are uncovered to prevent system contamination.
3. Assemble connection hand tight.
4. Mark fittings, male and female.

CAUTION

OVER TIGHTENING MAY CAUSE DEFORMATION OF THE PIPE FITTING AND DAMAGE TO THE JOINING FITTING, FLANGE OR COMPONENT MAY OCCUR.

NEVER BACK OFF (LOOSEN) PIPE THREADED CONNECTORS TO ACHIEVE ALIGNMENT. MEET THE MINIMUM REQUIRED TURNS AND USE THE LAST TURN FOR ALIGNMENT.

5. Rotate male fitting the number of turns per Table 5-1, NPTF Pipe Thread. See FFWR and TFFT Methods for TFFT procedure requirements.

NOTE: TFFT values provided in Table 5-1, NPTF Pipe Thread are applicable for the following material configurations:

- STEEL fittings with STEEL mating components
- STEEL fittings with ALUMINUM or BRASS mating components
- ALUMINUM or BRASS fittings with STEEL mating components
- ALUMINUM or BRASS fittings with ALUMINUM or BRASS mating components.

Table 5-1. NPTF Pipe Thread

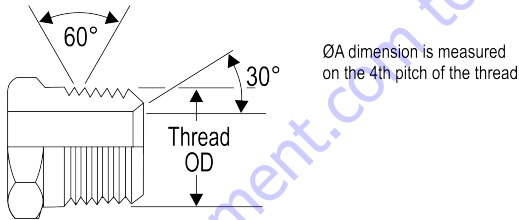

TYPE/FITTING IDENTIFICATION					
Material	Dash Size	Thread Size (UNF)	ØA*		Turns From Finger Tight (TFFT)**
			(in)	(mm)	
STEEL, ALUMINUM, OR BRASS FITTINGS WITH STEEL, ALUMINUM, OR BRASS MATING COMPONENTS	2	1/8-27	0.40	10.24	2 to 3
	4	1/4-18	0.54	13.61	2 to 3
	6	3/8-18	0.67	17.05	2 to 3
	8	1/2-14	0.84	21.22	2 to 3
	12	3/4-14	1.05	26.56	2 to 3
	16	1-11 1/2	1.31	33.22	1.5 to 2.5
	20	1 1/4-11 1/2	1.65	41.98	1.5 to 2.5
	24	1 1/2-11 1/2	1.89	48.05	1.5 to 2.5
	32	2-11 1/2	2.37	60.09	1.5 to 2.5

* ØA thread dimension for reference only.

** See FFWR and TFFT Methods subsection for TFFT procedure requirements.

Assembly Instructions for British Standard Pipe Thread Tapered (BSPT) Connections

1. Inspect components to ensure male and female port threads are free of rust, splits, dirt, foreign matter, or burrs.
2. Apply a suitable thread sealant, such as JLG Threadlocking compound, to the male pipe threads if not already applied. Ensure the first 1 to 2 threads are uncovered to prevent system contamination.
3. Assemble connection hand tight.
4. Mark fittings, male and female.

5. Rotate male fitting the number of turns per Table 5-2, BSPT Pipe Thread. See FFWR and TFFT Methods for TFFT procedure requirements.

NOTE: TFFT values provided in Table 5-2, BSPT Pipe Thread are applicable for the following material configurations:

- STEEL fittings with STEEL mating components
- STEEL fittings with ALUMINUM or BRASS mating components
- ALUMINUM or BRASS fittings with STEEL mating components
- ALUMINUM or BRASS fittings with ALUMINUM or BRASS mating components.

⚠ CAUTION

OVER TIGHTENING MAY CAUSE DEFORMATION OF THE PIPE FITTING AND DAMAGE TO THE JOINING FITTING, FLANGE OR COMPONENT MAY OCCUR.

NEVER BACK OFF (LOOSEN) PIPE THREADED CONNECTORS TO ACHIEVE ALIGNMENT. MEET THE MINIMUM REQUIRED TURNS AND USE THE LAST TURN FOR ALIGNMENT.

Table 5-2. BSPT Pipe Thread

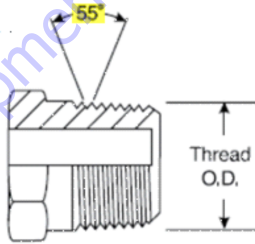

TYPE/FITTING IDENTIFICATION					Turns From Finger Tight (TFFT)**
MATERIAL	Dash Size	Thread Size	ØA*		
		(BSPT)	(in)	(mm)	
STEEL, ALUMINUM, OR BRASS FITTINGS WITH STEEL, ALUMINUM, OR BRASS MATING COMPONENTS	2	1/8-28	0.38	9.73	2 to 3
	4	1/4-19	0.52	13.16	2 to 3
	6	3/8-19	0.66	16.66	2 to 3
	8	1/2-14	0.83	20.96	2 to 3
	12	3/4-14	1.04	26.44	2 to 3
	16	1-11	1.31	33.25	1.5 to 2.5
	20	1 1/4-11	1.65	41.91	1.5 to 2.5
	24	1 1/2-11	1.88	47.80	1.5 to 2.5
32	2-11	2.35	59.61	1.5 to 2.5	

*ØA thread dimension for reference only.

** See Appendix B for TFFT procedure requirements.

Assembly Instructions for 37° (JIC) Flare Fittings

1. Inspect the flare for obvious visual squareness and concentricity issues with the tube OD. Ensure surface is smooth, free of rust, weld and brazing splatter, splits, dirt, foreign matter, or burrs. If necessary replace fitting or adapter.

⚠ CAUTION

DO NOT FORCE A MISALIGNED OR SHORT HOSE/TUBE INTO ALIGNMENT. IT PUTS UNDESIRABLE STRAIN ONTO THE JOINT EVENTUALLY LEADING TO LEAKAGE.

2. Align tube to fitting and start threads by hand.

⚠ CAUTION

THE TORQUE METHOD SHOULD NOT BE USED ON LUBRICATED OR OILY FITTINGS. NO LUBRICATION OR SEALANT IS REQUIRED. THE LUBRICATION WOULD CAUSE INCREASED CLAMPING FORCE AND CAUSE FITTING DAMAGE.

3. Torque assembly to value listed in Table 5-3, 37° Flare (JIC)Thread - Steel or Table 5-4, 37° Flare (JIC)Thread - Aluminum/Brass while using the Double Wrench Method per Double Wrench Method. Refer to FFWR and TFFT Methods for procedure requirements if using the FFWR method.

NOTE: Torque values provided in Table 5-3, 37° Flare (JIC)Thread - Steel and Table 5-4, 37° Flare (JIC)Thread - Aluminum/Brass are segregated based on the material configuration of the connection.

ALUMINUM/BRASS FITTINGS OR ALUMINUM/BRASS MATING COMPONENTS' indicate either the following material configurations:

- STEEL fittings with ALUMINUM or BRASS mating components
- ALUMINUM or BRASS fittings with STEEL mating components
- ALUMINUM or BRASS fittings with ALUMINUM or BRASS mating components.

Table 5-3. 37° Flare (JIC) Thread - Steel

Type/Fitting Identification							Torque						Flats from Wrench Resistance (F.F.W.R)**
MATERIAL	Dash Size	Thread Size	ØA*		ØB*		[Ft-Lb]			[N-m]			
		(UNF)	(in)	(mm)	(in)	(mm)	Min	Nom	Max	Min	Nom	Max	
STEEL FITTINGS WITH STEEL MATING COMPONENTS; UN-LUBRICATED THREADS	2	5/16-24	0.28	7.00	0.31	7.75	6	7	7	8	9	10	--
	3	3/8-24	0.34	8.60	0.37	9.50	8	9	10	11	12	14	--
	4	7/16-20	0.39	10.00	0.44	11.10	13	14	14	18	19	19	1-1/2 to 1-3/4
	5	1/2-20	0.46	11.60	0.50	12.70	14	15	15	19	20	21	1 to 1-1/2
	6	9/16-18	0.51	13.00	0.56	14.30	22	23	24	30	31	33	1 to 1-1/2
	8	3/4-16	0.69	17.60	0.75	19.10	42	44	46	57	60	63	1-1/2 to 1-3/4
	10	7/8-14	0.81	20.50	0.87	22.20	60	63	66	81	85	89	1 to 1-1/2
	12	1 1/16-12	0.97	24.60	1.06	27.00	84	88	92	114	120	125	1 to 1-1/2
	14	1 3/16-12	1.11	28.30	1.19	30.10	100	105	110	136	142	149	1 to 1-1/2
	16	1 5/16-12	1.23	31.30	1.31	33.30	118	124	130	160	168	176	3/4 to 1
	20	1 5/8-12	1.54	39.20	1.63	41.30	168	176	185	228	239	251	3/4 to 1
	24	1 7/8-12	1.80	45.60	1.87	47.60	195	205	215	264	278	291	3/4 to 1
32	2 1/2-12	2.42	61.50	2.50	63.50	265	278	292	359	377	395	3/4 to 1	

* ØA and ØB thread dimensions for reference only.

** See Appendix B for FFWR procedure requirements.

SECTION 5 - BASIC HYDRAULIC INFORMATION & HYDRAULIC SCHEMATICS

Table 5-4. 37° Flare (JIC) Thread - Aluminum/Brass

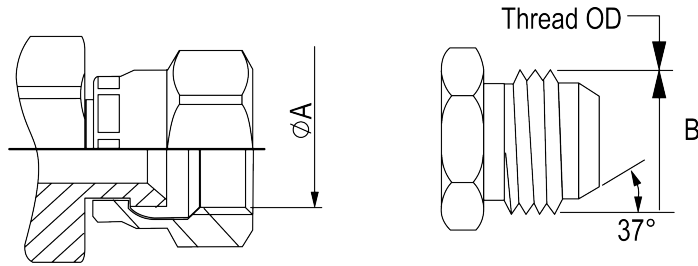

TYPE/FITTING IDENTIFICATION							Torque						Flats from Wrench Resistance (F.F.W.R)**
MATERIAL	Dash Size	Thread Size (UNF)	ØA*		ØB*		[Ft-Lb]			[N-m]			
			(in)	(mm)	(in)	(mm)	Min	Nom	Max	Min	Nom	Max	
ALUMINUM/BRASS FITTINGS OR ALUMINUM/BRASS MATING COMPONENTS; UN-LUBRICATED THREADS	2	5/16-24	0.28	7.00	0.31	7.75	4	4	5	5	6	7	--
	3	3/8-24	0.34	8.60	0.37	9.50	5	6	7	7	8	9	--
	4	7/16-20	0.39	10.00	0.44	11.10	8	9	9	11	12	13	1-1/2 to 1-3/4
	5	1/2-20	0.46	11.60	0.50	12.70	9	10	10	12	13	14	1 to 1-1/2
	6	9/16-18	0.51	13.00	0.56	14.30	14	15	16	19	20	21	1 to 1-1/2
	8	3/4-16	0.69	17.60	0.75	19.10	27	29	30	37	39	41	1-1/2 to 1-3/4
	10	7/8-14	0.81	20.50	0.87	22.20	39	41	43	53	56	58	1 to 1-1/2
	12	1 1/16-12	0.97	24.60	1.06	27.00	55	57	60	74	78	81	1 to 1-1/2
	14	1 3/16-12	1.11	28.30	1.19	30.10	65	68	72	88	93	97	1 to 1-1/2
	16	1 5/16-12	1.23	31.30	1.31	33.30	77	81	84	104	109	114	3/4 to 1
	20	1 5/8-12	1.54	39.20	1.63	41.30	109	115	120	148	155	163	3/4 to 1
	24	1 7/8-12	1.80	45.60	1.87	47.60	127	133	139	172	180	189	3/4 to 1
32	2 1/2-12	2.42	61.50	2.50	63.50	172	181	189	234	245	257	3/4 to 1	

* ØA and ØB thread dimensions for reference only.

** See FFWR and TFFT Methods for FFWR procedure requirements.

Assembly Instructions for 45° SAE Flare Fittings

1. Inspect the flare for obvious visual squareness and concentricity issues with the tube OD. Ensure surface is smooth, free of rust, weld and brazing splatter, splits, dirt, foreign matter, or burrs. If necessary replace fitting or adapter.

⚠ CAUTION

DO NOT FORCE A MISALIGNED OR SHORT HOSE/TUBE INTO ALIGNMENT. IT PUTS UNDESIRABLE STRAIN ONTO THE JOINT EVENTUALLY LEADING TO LEAKAGE.

2. Align tube to fitting.
3. Tighten fitting by hand until hand tight.

⚠ CAUTION

THE TORQUE METHOD SHOULD NOT BE USED ON LUBRICATED OR OILY FITTINGS. NO LUBRICATION OR SEALANT IS REQUIRED. THE LUBRICATION WOULD CAUSE INCREASED CLAMPING FORCE AND CAUSE FITTING DAMAGE.

Torque fitting to value listed in Table 5-5, 45° Flare (SAE) - Steel and Table 5-6, 45° Flare (SAE) - Aluminum/Brass while using the Double Wrench Method outlined in this section. Refer to FFWR and TFFT Methods for procedure requirements if using the TFFT method.

NOTE: *Torque values provided in Table 5-5, 45° Flare (SAE) - Steel and Table 5-6, 45° Flare (SAE) - Aluminum/Brass are segregated based on the material configuration of the connection.*

ALUMINUM/BRASS FITTINGS OR ALUMINUM/BRASS MATING COMPONENTS' indicate either the following material configurations:

- STEEL fittings with ALUMINUM or BRASS mating components
- ALUMINUM or BRASS fittings with STEEL mating components
- ALUMINUM or BRASS fittings with ALUMINUM or BRASS mating components.

Go to Discount-Equipment.com to order your parts

SECTION 5 - BASIC HYDRAULIC INFORMATION & HYDRAULIC SCHEMATICS

Table 5-5. 45° Flare (SAE) - Steel

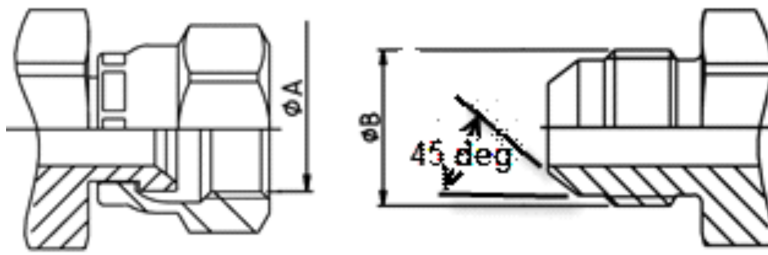

TYPE/FITTING IDENTIFICATION							Torque					
MATERIAL	Dash Size	Thread Size	ØA*		ØB*		[Ft-Lb]			[N-m]		
			(UNF)	(in)	(mm)	(in)	(mm)	Min	Nom	Max	Min	Nom
STEEL FITTINGS WITH STEEL MATING COMPONENTS; UN-LUBRICATED THREADS	4	7/16-20	0.39	9.90	0.44	11.10	13	14	14	18	19	19
	6	5/8-18	0.56	14.30	0.63	15.90	22	23	24	30	31	33
	8	3/4-16	0.69	17.50	0.75	19.10	42	44	46	57	60	62
	10	7/8-14	0.81	20.60	0.87	22.20	60	63	66	81	85	89
	12	1 1/16-14	0.98	25.00	1.06	27.00	84	88	92	114	119	125

* ØA and ØB thread dimensions for reference only.

** See FFWR and TFFT Methods for FFWR procedure requirements.

Table 5-6. 45° Flare (SAE) - Aluminum/Brass

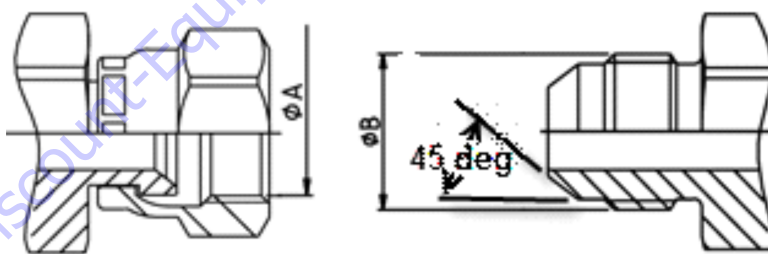

TYPE/FITTING IDENTIFICATION							Torque					
MATERIAL	Dash Size	Thread Size	ØA*		ØB*		[Ft-Lb]			[N-m]		
			(UNF)	(in)	(mm)	(in)	(mm)	Min	Nom	Max	Min	Nom
ALUMINUM/BRASS FITTINGS OR ALUMINUM/BRASS MATING COMPONENTS; UN-LUBRICATED THREADS	4	7/16-20	0.39	9.90	0.44	11.10	8	9	9	11	12	12
	6	5/8-18	0.56	14.30	0.63	15.90	14	15	15	19	20	20
	8	3/4-16	0.69	17.50	0.75	19.10	27	29	30	37	39	41
	10	7/8-14	0.81	20.60	0.87	22.20	39	41	43	53	56	58
	12	1 1/16-14	0.98	25.00	1.06	27.00	55	58	61	75	79	83

* ØA and ØB thread dimensions for reference only.

** See FFWR and TFFT Methods for TFFT procedure requirements.

SECTION 5 - BASIC HYDRAULIC INFORMATION & HYDRAULIC SCHEMATICS

Assembly Instructions for O-Ring Face Seal (ORFS)

Fittings

1. Ensure proper O-ring is installed. If O-ring is missing install per O-ring Installation (Replacement).
2. Ensure surface is smooth, free of rust, weld and brazing splatter, splits, dirt, foreign matter, or burrs. If necessary replace fitting or adapter.

CAUTION

CARE TO BE TAKEN WHEN LUBRICATING O-RING. AVOID ADDING OIL TO THE THREADED CONNECTION OF THE FITTING. THE LUBRICATION WOULD CAUSE INCREASED CLAMPING FORCE AND CAUSE FITTING DAMAGE.

3. Pre-lubricate the O-ring with Hydraulic Oil.
4. Place the tube assembly against the fitting body so that the flat face comes in contact with the O-ring. Hand thread the nut onto the fitting body.

5. Torque nut to value listed in Table 5-7, O-ring Face Seal (ORFS) - Steel or Table 5-8, O-ring Face Seal (ORFS) - Aluminum/Brass while using the Double Wrench Method. Refer to FFWR and TFFT Methods for procedure requirements if using the FFWR method.

NOTE: Torque values provided in Table 5-7, O-ring Face Seal (ORFS) - Steel and Table 5-8, O-ring Face Seal (ORFS) - Aluminum/Brass are segregated based on the material configuration of the connection.

ALUMINUM/BRASS FITTINGS OR ALUMINUM/BRASS MATING COMPONENTS' indicate either the following material configurations:

- STEEL fittings with ALUMINUM or BRASS mating components
- ALUMINUM or BRASS fittings with STEEL mating components
- ALUMINUM or BRASS fittings with ALUMINUM or BRASS mating components

Table 5-7. O-ring Face Seal (ORFS) - Steel

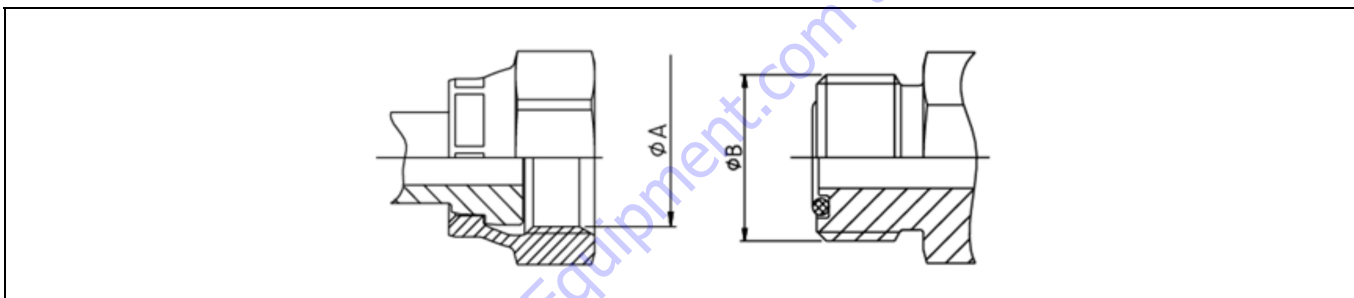

TYPE/FITTING IDENTIFICATION						Torque						Flats from Wrench Resistance (F.F.W.R)**		
MATERIAL	Dash Size	Thread Size	ϕA^*		ϕB^*		[Ft-Lb]			[N-m]			Tube Nuts	Swivel & Hose Ends
		(UNF)	(in)	(mm)	(in)	(mm)	Min	Nom	Max	Min	Nom	Max		
STEEL FITTINGS WITH STEEL MATING COMPONENTS; UN-LUBRICATED THREADS	4	9/16-18	0.51	13.00	0.56	14.20	18	19	20	25	26	27	1/4 to 1/2	1/2 to 3/4
	6	11/16-16	0.63	15.90	0.69	17.50	30	32	33	40	43	45	1/4 to 1/2	1/2 to 3/4
	8	13/16-16	0.75	19.10	0.81	20.60	40	42	44	55	57	60	1/4 to 1/2	1/2 to 3/4
	10	1-14	0.94	23.80	1.00	25.40	60	63	66	81	85	89	1/4 to 1/2	1/2 to 3/4
	12	13/16-12	1.11	28.20	1.19	30.10	85	90	94	115	122	127	1/4 to 1/2	1/2 to 3/4
	16	17/16-12	1.34	34.15	1.44	36.50	110	116	121	149	157	164	1/4 to 1/2	1/2 to 3/4
	20	1 1/16-12	1.59	40.50	1.69	42.90	150	158	165	203	214	224	1/4 to 1/2	1/2 to 3/4
	24	2-12	1.92	48.80	2.00	50.80	230	242	253	312	328	343	1/4 to 1/2	1/2 to 3/4
	32	2 1/2-12	2.43	61.67	2.50	63.50	375	394	413	508	534	560	1/4 to 1/2	1/2 to 3/4

* ϕA and ϕB thread dimensions for reference only.

** See FFWR and TFFT Methods for FFWR procedure requirements.

SECTION 5 - BASIC HYDRAULIC INFORMATION & HYDRAULIC SCHEMATICS

Table 5-8. O-ring Face Seal (ORFS) - Aluminum/Brass

TYPE/FITTING IDENTIFICATION							Torque						Flats from Wrench Resistance (F.F.W.R)**	
MATERIAL	Dash Size	Thread Size (UNF)	ØA*		ØB*		[Ft-Lb]			[N-m]			Tube Nuts	Swivel & Hose Ends
			(in)	(mm)	(in)	(mm)	Min	Nom	Max	Min	Nom	Max		
ALUMINUM/BRASS FITTINGS OR ALUMINUM/BRASS MATING COMPONENTS; UN-LUBRICATED THREADS	4	9/16-18	0.51	13.00	0.56	14.20	12	13	13	16	18	18	1/4 to 1/2	1/2 to 3/4
	6	11/16-16	0.63	15.90	0.69	17.50	20	21	22	27	28	30	1/4 to 1/2	1/2 to 3/4
	8	13/16-16	0.75	19.10	0.81	20.60	26	28	29	35	38	39	1/4 to 1/2	1/2 to 3/4
	10	1-14	0.94	23.80	1.00	25.40	39	41	43	53	56	58	1/4 to 1/2	1/2 to 3/4
	12	13/16-12	1.11	28.20	1.19	30.10	55	58	61	75	79	83	1/4 to 1/2	1/2 to 3/4
	16	17/16-12	1.34	34.15	1.44	36.50	72	76	79	98	103	107	1/4 to 1/2	1/2 to 3/4
	20	1 1/16-12	1.59	40.50	1.69	42.90	98	103	108	133	140	146	1/4 to 1/2	1/2 to 3/4
	24	2-12	1.92	48.80	2.00	50.80	12	13	13	16	18	18	1/4 to 1/2	1/2 to 3/4
	32	2 1/2-12	2.43	61.67	2.50	63.50	20	21	22	27	28	30	1/4 to 1/2	1/2 to 3/4

* ØA and ØB thread dimensions for reference only.

** See FFWR and TFFT Methods for FFWR procedure requirements.

Assembly Instructions for DIN 24° Flare Bite Type Fittings (MBTL and MBTS)

⚠ CAUTION

A NON-SQUARE TUBE END CAN CAUSE IMPROPERLY SEATED FITTINGS AND LEAKAGE.

1. Inspect the components to ensure free of contamination, external damage, rust, splits, dirt, foreign matter, or burrs. Ensure tube end is visibly square. If necessary replace fitting or tube.
2. Lubricate thread and cone of fitting body or hardened pre-assembly tool, as well as the progressive ring and nut threads.
3. Slip nut and progressive ring over tube, assuring that they are in the proper orientation.
4. Push the tube end into the coupling body.
5. Slide collet into position and tighten until finger tight. Mark nut and tube in the finger-tight position. Tighten nut to the number of flats listed in Table Table 5-9, DIN 24°Cone (MBTL & MBTS) while using the Double Wrench Method. The tube must not turn with the nut.

Go to Discount-Equipment.com to order your parts

Table 5-9. DIN 24° Cone (MBTL & MBTS)

TYPE/FITTING IDENTIFICATION								DIN 24° CONE FLARELESS BITE FITTING (With or Without O-Ring)									
MATERIAL	TYPE	Tube O.D.	Thread M Size	ØA*	ØB*	C*	ØD*	Torque						Flats from Wrench Resistance (F.F.W.R)**			
		(mm)	(Metric)	(mm)	(mm)	(mm)	(mm)	[Ft-Lb]			[N-m]						
								Min	Nom	Max	Min	Nom	Max				
STEEL FITTINGS WITH STEEL MATING COMPONENTS	DIN 24° CONE FLARELESS BITE (MBTL) FITTING	6	M12x1.5	10.50	12.00	7.00	6.20	FFWR is the recommended method of fitting assembly. Torque values are application specific due to variability in the fitting supplier, coating, lubrication, and other physical characteristics of the connection. Refer to the specific procedure in the						1.5 to 1.75			
		8	M14x1.5	12.50	14.00	7.00	8.20							1.5 to 1.75			
		10	M16x1.5	14.50	16.00	7.00	10.20							1.5 to 1.75			
		12	M18x1.5	16.50	18.00	7.00	12.20							1.5 to 1.75			
		15	M22x1.5	20.50	22.00	7.00	15.20							1.5 to 1.75			
		18	M26x1.5	24.50	26.00	7.50	18.20							1.5 to 1.75			
		22	M30x2	27.90	30.00	7.50	22.20							1.5 to 1.75			
		28	M36x2	33.90	36.00	7.50	28.20							1.5 to 1.75			
		35	M45x2	42.90	45.00	10.50	35.30							1.5 to 1.75			
	42	M52x2	49.90	52.00	11.00	42.30	1.5 to 1.75										
	DIN 24° CONE FLARELESS BITE (MBTS) FITTING	TYPE	Tube O.D.	Thread M Size	ØA*	ØB*	C*	ØD*	Torque						Flats from Wrench Resistance (F.F.W.R)**		
			(mm)	(Metric)	(mm)	(mm)	(mm)	(mm)	[Ft-Lb]			[N-m]					
									Min	Nom	Max	Min	Nom	Max			
					6	M14x1.5	12.50	14.00	7.00	6.20	FFWR is the recommended method of fitting assembly. Torque values are application specific due to variability in the fitting supplier, coating, lubrication, and other physical characteristics of the connection. Refer to the specific procedure in the						1.5 to 1.75
					8	M16x1.5	14.50	16.00	7.00	8.20							1.5 to 1.75
					10	M18x1.5	16.50	18.00	7.50	10.20							1.5 to 1.75
					12	M20x1.5	18.50	20.00	7.50	12.20							1.5 to 1.75
					14	M22x1.5	20.50	22.00	8.00	14.20							1.5 to 1.75
16					M24x1.5	22.50	24.00	8.50	16.20	1.5 to 1.75							
20	M30x2	27.90			30.00	10.50	20.20	1.5 to 1.75									
25	M36x2	33.90			36.00	12.00	25.20	1.5 to 1.75									
30	M42x2	39.90			42.00	13.50	30.20	1.5 to 1.75									
38	M52x2	49.90	52.00	16.00	38.30	1.5 to 1.75											

* ØA, ØB, C, & ØD thread dimensions for reference only.

** See Appendix B for FFWR procedure requirements.

Assembly Instructions for Bulkhead (BH) Fittings

1. Ensure threads and surface are free of rust, weld and brazing splatter, splits, burrs or other foreign material. If necessary replace fitting or adapter.
2. Remove the locknut from the bulkhead assembly.
3. Insert the bulkhead side of the fitting into the panel or bulkhead bracket opening.
4. Hand thread the locknut onto the bulkhead end of the fitting body.
5. Torque nut onto fitting per Table 5-10 and Table 5-11 while using the Double Wrench Method.

Go to Discount-Equipment.com to order your parts

SECTION 5 - BASIC HYDRAULIC INFORMATION & HYDRAULIC SCHEMATICS

Table 5-10. Bulkhead Fittings (BH) - INCH

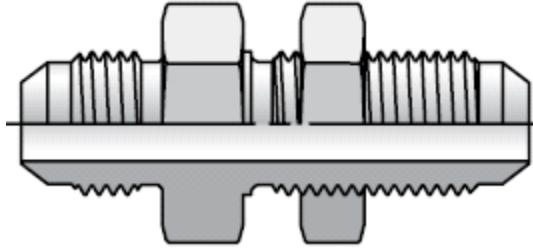

TYPE/FITTING IDENTIFICATION				FASTENING JAM NUT for Bulkhead Connectors						
MATERIAL	TYPE	Dash Size	Thread Size	Torque						
				[Ft-Lb]			[N-m]			
			(UNF)	Min	Nom	Max	Min	Nom	Max	
STEEL FITTINGS	O-RING FACE SEAL (ORFS) BULKHEAD FITTING	4	9/16-18	15	16	17	20	22	23	
		6	11/16-16	25	27	28	34	37	38	
		8	13/16-16	55	58	61	75	79	83	
		10	1-14	85	90	94	115	122	127	
		12	13/16-12	135	142	149	183	193	202	
		14	15/16-12	170	179	187	230	243	254	
		16	17/16-12	200	210	220	271	285	298	
		20	1 1/16-12	245	258	270	332	350	366	
		24	2-12	270	284	297	366	385	403	
	37° FLARE (JIC) BULKHEAD FITTING	TYPE	Dash Size	Thread Size	Torque					
					[Ft-Lb]			[N-m]		
		(UNF)	Min	Nom	Max	Min	Nom	Max		
		3	3/8-24	8	9	9	11	12	12	
		4	7/16-20	13	14	14	18	19	19	
		5	1/2-20	20	21	22	27	28	30	
		6	9/16-18	25	27	28	34	37	38	
		8	3/4-16	50	53	55	68	72	75	
		10	7/8-14	85	90	94	115	122	127	
		12	1 1/16-12	135	142	149	183	193	202	
		14	1 3/16-12	170	179	187	230	243	254	
		16	1 5/16-12	200	210	220	271	285	298	
		20	1 5/8-12	245	258	270	332	350	366	
24	1 7/8-12	270	284	297	366	385	403			
32	2 1/2-12	310	326	341	420	442	462			

Table 5-11. Bulkhead Fittings (BH) - METRIC

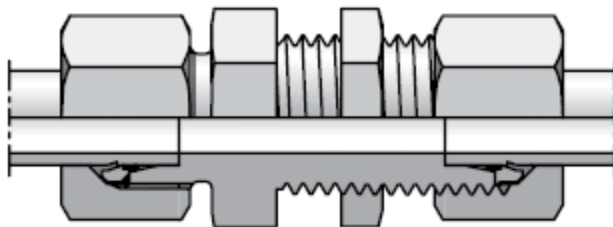

TYPE/FITTING IDENTIFICATION				FASTENING JAM NUT for Bulkhead Connectors					
MATERIAL	TYPE	Connecting Tube O.D.	Thread M Size	Torque					
				[Ft-Lb]			[N-m]		
		(mm)	(metric)	Min	Nom	Max	Min	Nom	Max
STEEL FITTINGS	DIN 24° CONE FLARELESS BITE (MBTL) BULKHEAD FITTING	6	M12x1.5	14	15	16	19	20	22
		8	M14x1.5	17	18	19	23	24	26
		10	M16x1.5	22	23	24	30	31	33
		12	M18x1.5	35	37	39	47	50	53
		15	M22x1.5	44	47	50	60	64	68
		18	M26x1.5	70	75	80	95	102	108
		22	M30x2	115	120	125	156	163	169
		28	M36x2	150	157	164	203	213	222
		35	M45x2	155	162	169	210	220	229
		42	M52x2	220	230	240	298	312	325
	DIN 24° CONE FLARELESS BITE (MBTS) BULKHEAD FITTING	Connecting Tube O.D.	Thread M Size	Torque					
		(mm)	(metric)	[Ft-Lb]			[N-m]		
				Min	Nom	Max	Min	Nom	Max
		6	M14x1.5	17	15	16	23	20	22
		8	M16x1.5	22	18	19	30	24	26
		10	M18x1.5	35	23	24	47	31	33
		12	M20x1.5	40	35	37	54	47	50
		14	M22x1.5	44	47	50	60	64	68
		16	M24x1.5	70	75	80	95	102	108
		20	M30x2	115	120	125	156	163	169
25	M36x2	150	157	164	203	213	222		
30	M42x2	155	162	169	210	220	229		
38	M52x2	220	230	240	298	312	325		

Assembly Instructions for O-Ring Boss (ORB)

Fittings

1. Inspect components to ensure that male and female port threads are free of rust, splits, dirt, foreign matter, or burrs.
2. Ensure proper O-ring is installed. If O-ring is missing install per O-ring Installation (Replacement).

⚠ CAUTION

CARE TO BE TAKEN WHEN LUBRICATING O-RING. AVOID ADDING OIL TO THE THREADED CONNECTION OF THE FITTING. THE LUBRICATION WOULD CAUSE INCREASED CLAMPING FORCE AND CAUSE FITTING DAMAGE.

3. Pre-lubricate the O-ring with Hydraulic Oil.
4. For Non-Adjustable and Plugs, thread the fitting by hand until contact.
5. For Adjustable fittings, refer to Adjustable Stud End Assembly for proper assembly.

6. Torque the fitting or nut to value listed in Table 5-12 thru Table 5-17 while using the Double Wrench Method.
 - a. The table headings identify the straight thread O-ring port and the type on the other side of the fitting. The torque will be applied to the straight thread O-ring port.
 - b. Torque values provided in Table 5-12 thru Table 5-17 are segregated based on the material configuration of the connection. 'ALUMINUM/BRASS FITTINGS OR ALUMINUM/BRASS MATING COMPONENTS' indicate either the following material configurations:
 - STEEL fittings with ALUMINUM or BRASS mating components
 - ALUMINUM or BRASS fittings with STEEL mating components
 - ALUMINUM or BRASS fittings with ALUMINUM or BRASS mating components.
7. Inspect to ensure the O-ring is not pinched and the washer is seated flat on the counterbore of the port.

SECTION 5 - BASIC HYDRAULIC INFORMATION & HYDRAULIC SCHEMATICS

Table 5-12. O-ring Boss (ORB) - Table 1 of 6

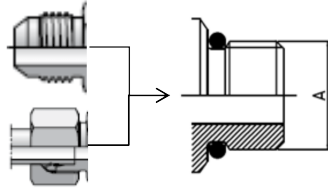

TYPE/FITTING IDENTIFICATION					HEX TYPE PLUGS & STUD ENDS with 37° (JIC) or L series DIN (MBTL) opposite end					
MATERIAL	Dash Size	Thread Size	ØA*		Torque					
		(UNF)	(in)	(mm)	Min	Nom	Max	Min	Nom	Max
STEEL FITTINGS WITH STEEL MATING COMPONENTS; UN-LUBRICATED THREADS	2	5/16-24	0.31	7.93	(85)	(90)	(94)	10	10	11
	3	3/8-24	0.37	9.52	(155)	(163)	(171)	18	18	19
	4	7/16-20	0.44	11.11	22	23	24	29	31	33
	5	1/2-20	0.50	12.70	23	25	26	32	34	35
	6	9/16-18	0.56	14.28	29	31	32	40	42	43
	8	3/4-16	0.75	19.10	52	55	57	70	75	77
	10	7/8-14	0.87	22.22	85	90	94	115	122	127
	12	1 1/16-12	1.06	27.00	135	142	149	185	193	202
	14	1 3/16-12	1.19	30.10	175	184	193	235	249	262
	16	1 5/16-12	1.31	33.30	200	210	220	270	285	298
	20	1 5/8-12	1.63	41.30	250	263	275	340	357	373
	24	1 7/8-12	1.87	47.60	305	321	336	415	435	456
32	2 1/2-12	2.50	63.50	375	394	413	510	534	560	
TYPE/FITTING IDENTIFICATION					HEX TYPE PLUGS & STUD ENDS with 37° (JIC) or L series DIN (MBTL) opposite end					
MATERIAL	Dash Size	Thread Size	ØA*		Torque					
		(UNF)	(in)	(mm)	Min	Nom	Max	Min	Nom	Max
ALUMINUM/BRASS FITTINGS OR ALUMINUM/BRASS MATING COMPONENTS; UN-LUBRICATED THREADS	2	5/16-24	0.31	7.93	(55)	(58)	(61)	6	7	7
	3	3/8-24	0.37	9.52	(101)	(106)	(111)	11	12	13
	4	7/16-20	0.44	11.11	14	15	16	19	20	22
	5	1/2-20	0.50	12.70	15	16	17	20	22	23
	6	9/16-18	0.56	14.28	19	20	21	26	27	28
	8	3/4-16	0.75	19.10	34	36	37	46	49	50
	10	7/8-14	0.87	22.22	55	58	61	75	79	83
	12	1 1/16-12	1.06	27.00	88	93	97	119	126	132
	14	1 3/16-12	1.19	30.10	114	120	126	155	163	171
	16	1 5/16-12	1.31	33.30	130	137	143	176	186	194
	20	1 5/8-12	1.63	41.30	163	171	179	221	232	243
	24	1 7/8-12	1.87	47.60	198	208	218	268	282	296
32	2 1/2-12	2.50	63.50	244	256	268	331	347	363	

*ØA Thread OD dimension for reference only.

**Removal Torque for Zero Leak Gold® Hollow Hex Plugs is significantly higher than install torque, typically 1.5-3.5X install torque.

SECTION 5 - BASIC HYDRAULIC INFORMATION & HYDRAULIC SCHEMATICS

Table 5-13. O-ring Boss (ORB) - Table 2 of 6

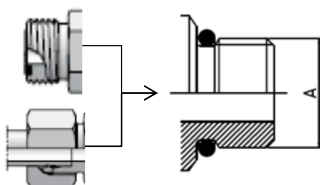

TYPE/FITTING IDENTIFICATION					STUD ENDS with (ORFS) or S series DIN (MBTS) opposite end					
MATERIAL	Dash Size	Thread Size	ØA*		Torque					
		(UNF)	(in)	(mm)	Min	Nom	Max	Min	Nom	Max
STEEL FITTINGS WITH STEEL MATING COMPONENTS; UN-LUBRICATED THREADS	2	5/16-24	0.31	7.93	--	--	--	--	--	--
	3	3/8-24	0.37	9.52	--	--	--	--	--	--
	4	7/16-20	0.44	11.11	26	27	28	35	37	38
	5	1/2-20	0.50	12.70	30	32	33	40	43	45
	6	9/16-18	0.56	14.28	35	37	39	46	50	53
	8	3/4-16	0.75	19.10	60	63	66	80	85	89
	10	7/8-14	0.87	22.22	100	105	110	135	142	149
	12	1 1/16-12	1.06	27.00	135	142	149	185	193	202
	14	1 3/16-12	1.19	30.10	175	184	193	235	249	262
	16	1 5/16-12	1.31	33.30	200	210	220	270	285	298
	20	1 5/8-12	1.63	41.30	250	263	275	340	357	373
	24	1 7/8-12	1.87	47.60	305	321	336	415	435	456
32	2 1/2-12	2.50	63.50	375	394	413	510	534	560	
TYPE/FITTING IDENTIFICATION					STUD ENDS with (ORFS) or S series DIN (MBTS) opposite end					
MATERIAL	Dash Size	Thread Size	ØA*		Torque					
		(UNF)	(in)	(mm)	Min	Nom	Max	Min	Nom	Max
ALUMINUM/BRASS FITTINGS OR ALUMINUM/BRASS MATING COMPONENTS; UN-LUBRICATED THREADS	2	5/16-24	0.31	7.93	--	--	--	--	--	--
	3	3/8-24	0.37	9.52	--	--	--	--	--	--
	4	7/16-20	0.44	11.11	17	18	18	23	24	24
	5	1/2-20	0.50	12.70	20	21	21	27	28	28
	6	9/16-18	0.56	14.28	23	24	24	31	33	33
	8	3/4-16	0.75	19.10	39	41	43	53	56	58
	10	7/8-14	0.87	22.22	65	69	72	88	94	98
	12	1 1/16-12	1.06	27.00	88	93	97	119	126	132
	14	1 3/16-12	1.19	30.10	114	120	126	155	163	171
	16	1 5/16-12	1.31	33.30	130	137	143	176	186	194
	20	1 5/8-12	1.63	41.30	163	171	179	221	232	243
	24	1 7/8-12	1.87	47.60	198	208	218	268	282	296
32	2 1/2-12	2.50	63.50	244	256	268	331	347	363	

* ØA Thread OD dimension for reference only.

** Removal Torque for Zero Leak Gold® Hollow Hex Plugs is significantly higher than install torque, typically 1.5-3.5X install torque.