



An Oshkosh Corporation Company



www.Discount-Equipment.com

Operation and Safety Manual

Original Instructions - Keep this manual with the machine at all times.

Models

EcoLift 50

SN P900004791 to Present

EcoLift 70

SN P900004841 to Present



ANSI

31215860

October 3, 2019 - Rev A

TO PURCHASE THIS PRODUCT PLEASE CONTACT US



**Equipment Financing and
Extended Warranties Available**



**Discount-Equipment.com is your online resource for
commercial and industrial quality parts and equipment sales.**

561-964-4949

visit us on line @ www.discount-equipment.com

Select an option below to find your Equipment

Search by Manufacturer

Search by Product Type

Request a Quote

We sell worldwide for the brands: Genie, Terex, JLG, MultiQuip, Mikasa, Essick, Whiteman, Mayco, Toro Stone, Diamond Products, Generac Magnum, Airman, Haulotte, Barreto, Power Blanket, Nifty Lift, Atlas Copco, Chicago Pneumatic, Allmand, Miller Curber, Skyjack, Lull, Skytrak, Tsurumi, Husquvarna Target, Stow, Wacker, Sakai, Mi-T-M, Sullair, Basic, Dynapac, MBW, Weber, Bartell, Bennar Newman, Haulotte, Ditch Runner, Menegotti, Morrison, Contec, Buddy, Crown, Edco, Wyco, Bomag, Laymor, EZ Trench, Bil-Jax, F.S. Curtis, Gehl Pavers, Heli, Honda, ICS/PowerGrit, IHI, Partner, Imer, Clipper, MMD, Koshin, Rice, CH&E, General Equipment, Amida, Coleman, NAC, Gradall, Square Shooter, Kent, Stanley, Tamco, Toku, Hatz, Kohler, Robin, Wisconsin, Northrock, Oztec, Toker TK, Rol-Air, APT, Wylie, Ingersoll Rand / Doosan, Innovatech, Con X, Ammann, Mecalac, Makinex, Smith Surface Prep, Small Line, Wanco, Yanmar



WARNING

Operating, servicing and maintaining this vehicle or equipment can expose you to chemicals including engine exhaust, carbon monoxide, phthalates, and lead, which are known to the State of California to cause cancer and birth defects or other reproductive harm. To minimize exposure, avoid breathing exhaust, do not idle the engine except as necessary, service your vehicle or equipment in a well-ventilated area and wear gloves or wash your hands frequently when servicing. For more information go to www.P65Warnings.ca.gov.

FOREWORD

The Mobile Elevating Work Platform (MEWP) models covered in this manual are designed and tested to meet or exceed various compliance standards. Please refer to the manufacturer's nameplate affixed to the subject MEWP for specific standard compliance information.

This manual is a very important tool! Keep it with the machine at all times.

The purpose of this manual is to provide owners, users, operators, lessors, and lessees with the precautions and operating procedures essential for the safe and proper machine operation for its intended purpose.

Due to continuous product improvements, JLG Industries, Inc. reserves the right to make specification changes without prior notification. Contact JLG Industries, Inc. for updated information.

Refer to www.JLG.com for Warranty, Product Registration, and other machine-related documentation.

SAFETY ALERT SYMBOLS AND SAFETY SIGNAL WORDS



This is the Safety Alert Symbol. It is used to alert you to the potential personal injury hazards. Obey all safety messages that follow this symbol to avoid possible injury or death

DANGER

INDICATES AN IMMINENTLY HAZARDOUS SITUATION. IF NOT AVOIDED, WILL RESULT IN SERIOUS INJURY OR DEATH. THIS DECAL WILL HAVE A RED BACKGROUND.

WARNING

INDICATES A POTENTIALITY HAZARDOUS SITUATION. IF NOT AVOIDED, COULD RESULT IN SERIOUS INJURY OR DEATH. THIS DECAL WILL HAVE AN ORANGE BACKGROUND.

CAUTION

INDICATES A POTENTIALITY HAZARDOUS SITUATION. IF NOT AVOIDED, MAY RESULT IN MINOR OR MODERATE INJURY. IT MAY ALSO ALERT AGAINST UNSAFE PRACTICES. THIS DECAL WILL HAVE A YELLOW BACKGROUND.

NOTICE

INDICATES INFORMATION OR A COMPANY POLICY THAT RELATES DIRECTLY OR INDIRECTLY TO THE SAFETY OF PERSONNEL OR PROTECTION OF PROPERTY.

⚠ WARNING

THIS PRODUCT MUST COMPLY WITH ALL SAFETY RELATED BULLETINS. CONTACT JLG INDUSTRIES, INC. OR THE LOCAL AUTHORIZED JLG REPRESENTATIVE FOR INFORMATION REGARDING SAFETY RELATED BULLETINS WHICH MAY HAVE BEEN ISSUED FOR THIS PRODUCT.

NOTICE

JLG INDUSTRIES, INC. SENDS SAFETY RELATED BULLETINS TO THE OWNER OF RECORD OF THIS MACHINE. CONTACT JLG INDUSTRIES, INC. TO ENSURE THAT THE CURRENT OWNER RECORDS ARE UPDATED AND ACCURATE.

NOTICE

JLG INDUSTRIES, INC. MUST BE NOTIFIED IMMEDIATELY IN ALL INSTANCES WHERE JLG PRODUCTS HAVE BEEN INVOLVED IN AN ACCIDENT INVOLVING BODILY INJURY OR DEATH OR WHEN SUBSTANTIAL DAMAGE HAS OCCURRED TO PERSONAL PROPERTY OR THE JLG PRODUCT.

For:

- Accident Reporting
- Product Safety Publications
- Current Owner Updates
- Questions Regarding Product Safety
- Standards and Regulations Compliance Information
- Questions Regarding Special Product Applications
- Questions Regarding Product Modifications

Contact:

Product Safety and Reliability Department
JLG Industries, Inc.
1 JLG Drive
McConnellsburg, PA 17233

or Your Local JLG Office
(See addresses on manual rear cover)

In USA:

Toll Free: 877-JLG-SAFE (877-554-7233)

Outside USA:

Phone: 717-485-5161
E-mail: ProductSafety@JLG.com

REVISION LOG

Original Issue

A - October 3, 2019

To order go to Discount-Equipment.com

SECTION - 1 - SAFETY PRECAUTIONS

1.1 GENERAL 1-1

1.2 PRE-OPERATION 1-1

 Operator Training and Knowledge 1-1

 Workplace Inspection 1-2

 Machine Inspection 1-2

1.3 OPERATION 1-3

 General 1-3

 Trip and Fall Hazard 1-3

 Electrocution Hazard 1-4

 Tipping Hazards 1-5

 Crushing and Collision Hazards 1-7

1.4 TRANSPORTING 1-8

 Tipping Hazards 1-8

1.5 MOVING, LIFTING, AND REPOSITIONING 1-10

 General 1-10

 Additional Safety Information 1-10

1.6 MAINTENANCE 1-10

 Maintenance Hazards 1-10

SECTION - 2 - PREPARATION AND INSPECTION

2.1 PERSONNEL TRAINING 2-1

 Operator Training 2-1

 Training Supervision 2-1

 Operator Responsibility 2-1

 Machine Familiarization 2-2

2.2 PREPARATION, INSPECTION, AND MAINTENANCE 2-2

 Inspection and Maintenance Table 2-3

2.3 PRE-START INSPECTION 2-4

2.4 WALK-AROUND INSPECTION 2-6

 General 2-6

 Inspection Diagram (EcoLift 50) 2-7

 Inspection Diagram (EcoLift 70) 2-8

2.5 FUNCTION CHECK 2-9

SECTION - 3 - MACHINE OPERATION

3.1 GENERAL 3-1

3.2 MACHINE DESCRIPTION 3-1

3.3 OPERATING CHARACTERISTICS AND LIMITATIONS 3-2

 Placards 3-2

 Capacities 3-2

 Stability 3-2

3.4 PLATFORM LOADING 3-2

3.5 MACHINE COMPONENT LOCATIONS 3-3

 EcoLift 50 3-3

 EcoLift 70 3-4

3.6 MACHINE OPERATION 3-5

 Positioning and Leveling Machine 3-5

 Entering/Exiting the Platform 3-6

 Elevating/Lowering Platform 3-7

3.7 TRANSPORTING, LIFTING, AND TIE-DOWN PROCEDURES .. 3-7

 Loading 3-7

TABLE OF CONTENTS

Storage	3-8
Vehicle Transport	3-8
Transportation Diagram	3-9
3.8 DECAL INSTALLATION (ECOLIFT 50)	3-10
3.9 DECAL INSTALLATION (ECOLIFT 70)	3-12

SECTION - 4 - EMERGENCY PROCEDURES

4.1 GENERAL INFORMATION	4-1
4.2 EMERGENCY OPERATION	4-1
Operator Unable to Control Machine	4-1
Platform Caught Overhead	4-1
Righting of Tipped Machine	4-1
4.3 INCIDENT NOTIFICATION	4-2
4.4 EMERGENCY LOWERING OPERATION	4-2

SECTION - 5 - GENERAL SPECIFICATIONS

Other Publications Available Specific to this Machine ...	5-1
Serial Number Identification	5-1
5.1 GENERAL SPECIFICATIONS	5-2
Machine Specifications	5-2
Machine Dimensions	5-2

SECTION - 6 - INSPECTION AND REPAIR LOG

LIST OF FIGURES

5-1. Operating Specifications (EcoLift 50)	5-3
5-2. Operating Specifications (EcoLift 70)	5-3

LIST OF TABLES

1-1 Minimum Approach Distances (M.A.D.)	1-5
---	-----

SECTION 1. SAFETY PRECAUTIONS

1.1 GENERAL

This section outlines the necessary precautions for proper and safe machine usage and maintenance. In order to promote proper machine usage, it is mandatory that a daily routine is established based on the content of this manual. A maintenance program, using the information provided in the Service and Maintenance section, must also be established by a qualified person and must be followed to ensure that the machine is safe to operate.

The owner/user/operator/lessor/lessee of the machine must not accept operating responsibility until this manual has been read, training is accomplished, and operation of the machine has been completed under the supervision of an experienced and qualified operator.

These sections contain the responsibilities of the owner, user, operator, lessor, and lessee concerning safety, training, inspection, maintenance, application, and operation. If there are any questions with regard to safety, training, inspection, maintenance, application, and operation, please contact JLG Industries, Inc. ("JLG").

⚠ WARNING

FAILURE TO COMPLY WITH THE SAFETY PRECAUTIONS LISTED IN THIS MANUAL COULD RESULT IN MACHINE DAMAGE, PROPERTY DAMAGE, PERSONAL INJURY OR DEATH.

1.2 PRE-OPERATION

Operator Training and Knowledge

- Read, understand, and study the Operation and Safety Manual in its entirety before operating the machine. For clarification, questions, or additional information regarding any portions of this manual, contact JLG Industries, Inc.

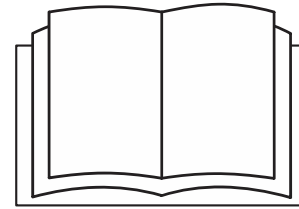

- Only personnel who have received proper training regarding the inspection, application and operation of MEWPs (including recognition and avoiding hazards associated with their operation) shall be authorized to operate a MEWP.
- Only properly trained personnel who have received unit-specific familiarization shall operate a MEWP. The user shall determine if personnel are qualified to operate the MEWP prior to operation.
- Read, understand, and obey all DANGERS, WARNINGS, CAUTIONS, and operating instructions on the machine and in this manual.
- Ensure that the machine is to be used in a manner which is within the scope of its intended application as determined by JLG.

SECTION 1 - SAFETY PRECAUTIONS

- All operating personnel must have a thorough understanding of the intended purpose and function of the MEWP controls, including platform, ground and emergency descent controls.
- Read, understand, and obey all applicable employer, local, and governmental regulations as they pertain to your utilization and application of the machine.

Workplace Inspection

- Precautions to avoid all hazards in the work area must be taken by the user before and during operation of the machine.
- Do not operate or raise the platform from a position on trucks, trailers, railway cars, floating vessels, scaffolds or other equipment unless the application is approved in writing by JLG.
- Before operation, check work area for overhead hazards such as electric lines, bridge cranes, and other potential overhead obstructions.
- Check operating surfaces for holes, bumps, drop-offs, obstructions, debris, concealed holes, and other potential hazards.
- Check the work area for hazardous locations. Do not operate the machine in hazardous environments unless approved for that purpose by JLG.
- Ensure that the ground conditions are adequate to support the maximum tire load indicated on the tire load decals located on the chassis adjacent to each wheel.

Machine Inspection

- Do not operate this machine until the inspections and functional checks have been performed as specified in Section 2 of this manual.
- Do not operate this machine until it has been serviced and maintained according to the maintenance and inspection requirements as specified in the Service and Maintenance section of this manual.
- Ensure all safety devices are operating properly. Modification of these devices is a safety violation.

WARNING

MODIFICATION OR ALTERATION OF A MEWP SHALL BE MADE ONLY WITH PRIOR WRITTEN PERMISSION FROM THE MANUFACTURER.

- Do not operate any machine on which the safety or instruction placards or decals are missing or illegible.
- Check the machine for modifications to original components. Ensure that any modifications have been approved by JLG.
- Avoid accumulation of debris on platform floor. Keep mud, oil, grease, and other slippery substances from footwear and platform floor.

1.3 OPERATION

General

- Machine operation requires your full attention. Bring the machine to a full stop before using any device, i.e. cell phones, two-way radios, etc. that will distract your attention from safely operating the machine.
- Do not use the machine for any purpose other than positioning personnel, their tools, and equipment.
- Before operation, the user must be familiar with the machine capabilities and operating characteristics of all functions.
- Never operate a malfunctioning machine. If a malfunction occurs, shut down the machine. Remove the unit from service and notify the proper authorities.
- Do not remove, modify, or disable any safety devices.
- Do not allow personnel to tamper with or operate the machine from the ground with personnel in the platform, except in an emergency.
- Do not carry materials directly on platform railing unless approved by JLG.
- Always ensure that power tools are properly stowed and never left hanging by their cord from the platform work area.
- Fully lower platform before leaving machine.
- Remove all rings, watches, and jewelry when operating machine. Do not wear loose fitting clothing or long hair unrestrained which may become caught or entangled in equipment.
- Persons under the influence of drugs or alcohol or who are subject to seizures, dizziness, or loss of physical control must not operate this machine.

Trip and Fall Hazard

- Prior to operation, ensure all gates and rails are fastened and secured in their proper position.

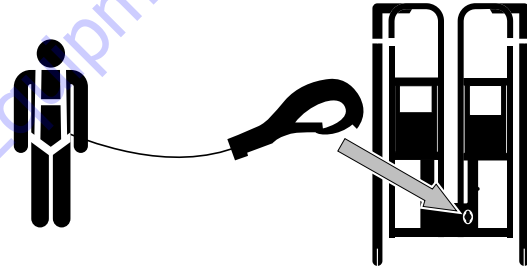

- JLG Industries, Inc. recommends all personnel in the platform wear a fall/travel restraint system in the platform with a lanyard attached to an authorized lanyard anchorage point while operating this machine. For further information regarding fall protection requirements on JLG products, contact JLG Industries, Inc.
- Identify the designated lanyard anchorage point at the platform and securely attach the lanyard. Attach only one (1) lanyard per lanyard anchorage point.
- Enter and exit only through gate area. Use extreme caution when entering or leaving platform. Ensure that the platform assembly is fully lowered. Face the platform when entering or leaving the platform. Always maintain "three point contact" with the machine, using two hands and one foot or two feet and one hand at all times during entry and exit.

SECTION 1 - SAFETY PRECAUTIONS

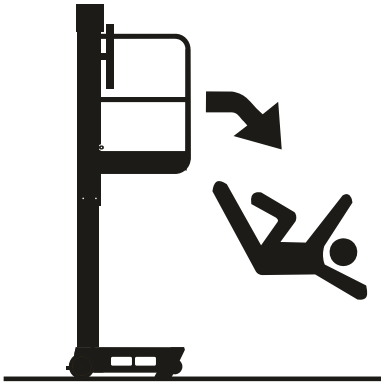

- Keep both feet firmly positioned on the platform floor at all times. Never position ladders, boxes, steps, planks, or similar items on unit to provide additional reach for any purpose.
- Never use the mast assembly to gain access to or leave the platform.
- Keep oil, mud, and slippery substances cleaned from footwear and the platform floor.

Electrocution Hazard

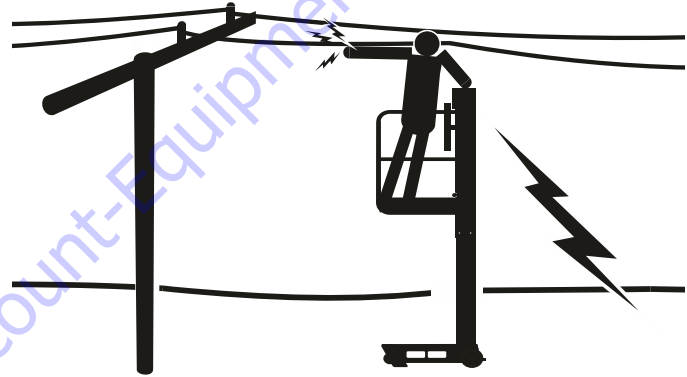

- This machine is not insulated and does not provide protection from contact or proximity to electrical current.
- Maintain distance from electrical lines, apparatus, or any energized (exposed or insulated) parts according to the Minimum Approach Distance (MAD) as shown in Table 1-1.
- Allow for machine movement and electrical line swaying.
- Maintain a clearance of at least 10 ft (3 m) between any part of the machine and its occupants, their tools, and their equipment from any electrical line or apparatus carrying up to 50,000 volts. One foot additional clearance is required for every additional 30,000 volts or less.

Table 1-1. Minimum Approach Distances (M.A.D.)

VOLTAGE RANGE (Phase to Phase)	MINIMUM APPROACH DISTANCE in Feet (Meters)
0 to 50 KV	10 (3)
Over 50KV to 200 KV	15 (5)
Over 200 KV to 350 KV	20 (6)
Over 350 KV to 500 KV	25 (8)
Over 500 KV to 750 KV	35 (11)
Over 750 KV to 1000 KV	45 (14)

NOTE: This requirement shall apply except where employer, local or governmental regulations are more stringent.

- The minimum approach distance may be reduced if insulating barriers are installed to prevent contact, and the barriers are rated for the voltage of the line being guarded. These barriers shall not be part of (or attached to) the machine. The minimum approach distance shall be reduced to a distance within the designed working dimensions of the insulating barrier. This determination shall be made by a qualified person in accordance with the employer, local, or governmental requirements for work practices near energized equipment.

⚠ DANGER

DO NOT MANEUVER MACHINE OR PERSONNEL INSIDE PROHIBITED ZONE (MAD). ASSUME ALL ELECTRICAL PARTS AND WIRING ARE ENERGIZED UNLESS KNOWN OTHERWISE.

Tipping Hazards

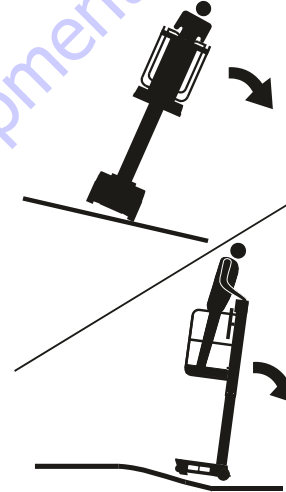

- Ensure that the ground conditions are adequate to support the maximum tire load indicated on the tire load decals located on the chassis adjacent to each wheel. Do not operate machine on unsupported surfaces.
- The user must be familiar with the operating surface. Do not exceed the allowable sideslope and grade.

SECTION 1 - SAFETY PRECAUTIONS

- Do not elevate platform while on or near a sloping, uneven, or soft surface. Ensure machine is positioned on a smooth, firm surface within the limits of the maximum operating slope before elevating platform.
- Before operating on floors, bridges, trucks, and other surfaces, check allowable capacity of the surfaces.
- Never exceed the maximum platform capacity as specified on the platform. Keep all loads within the confines of the platform, unless authorized by JLG.
- Keep the chassis of the machine a minimum of 2 ft (0.6 m) from holes, bumps, drop-offs, obstructions, debris, concealed holes, and other potential hazards at the ground level.
- Do not operate the machine when wind conditions exceed specifications shown in Section 5 or as shown on the capacity placard on the platform billboard. Factors affecting wind speed are; platform elevation, surrounding structures, local weather events, and approaching storms.
- Wind speed can be significantly greater at height than at ground level.
- Wind speed can change rapidly. Always consider approaching weather events, the time required to lower the platform, and methods to monitor current and potential wind conditions.
- Do not cover or increase surface area of the platform or the load. Do not carry large surface area items in the platform when operating outdoors. The addition of such items increases the exposed wind area of the machine. Increased areas exposed to wind will decrease stability.
- Never operate machine in high wind, rain, or snow.
- Do not perform work that will subject unit to a horizontal force or create a swaying motion of the platform.
- Never attempt to use the machine as a crane. Do not tie-off machine to any adjacent structure. Never attach wire, cable, or any similar items to platform.
- If the mast assembly or platform is caught so that one or more wheels are off the ground, platform personnel must be removed before attempting to free the machine. Use cranes, forklift trucks, or other appropriate equipment to stabilize machine.

Crushing and Collision Hazards

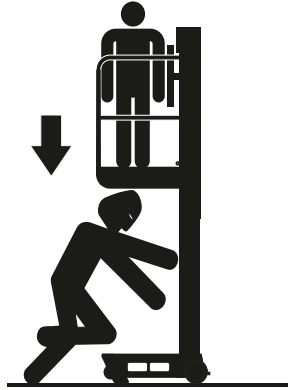

- Approved head gear must be worn by all operating and ground personnel.
- Check clearances above, on sides, and bottom of platform when lifting or lowering platform.

- During operation, keep all body parts inside platform railing.
- Keep non-operating personnel at least 6 ft (1.8 m) away from machine during all operations.
- When moving the machine, the operator must limit travel speed according to conditions of ground surface, congestion, visibility, slope, location of personnel, and other factors.
- Exercise extreme caution at all times to prevent obstacles from striking or interfering with operating controls and persons in the platform.
- Ensure that operators of other overhead and floor level machines are aware of the MEWP's presence. Disconnect power to overhead cranes. Barricade floor area if necessary.
- Do not operate over ground personnel. Warn personnel not to work, stand, or walk under a raised platform. Position barricades on floor as necessary.

SECTION 1 - SAFETY PRECAUTIONS

1.4 TRANSPORTING

Tipping Hazards

⚠ WARNING

FAILURE TO COMPLY WITH THE FOLLOWING TIPPING HAZARD INSTRUCTIONS COULD CAUSE THE UNIT TO TIP OVER OR BE HARD TO CONTROL WHEN BEING MOVED, WHICH COULD RESULT IN SERIOUS INJURY OR DEATH.



- Check travel path for personnel, holes, bumps, drop-offs, obstructions, debris, and coverings that may conceal other hazards.
- Before placing machine on floors, trucks and other surfaces, check allowable capacity of surfaces.

- On a smooth, firm surface within the limits of the maximum operating slope, always push machine from the platform end with the mast end leading the way.
- Watch for obstructions around machine and overhead.



- Two persons are required on slopes up to 5°. A forklift must be used when moving units on slopes greater than 5°.
- Always travel up or down a slope with the platform end of the machine positioned towards the low side of the slope. The operator and assistant must walk side by side to guide the machine.



- Never position the unit sideways on a slope.
- Do not elevate the platform or move the machine on a soft surface.
- Use caution and check clearances when moving machine in restricted or close quarters.
- Always use an assistant when moving machine in areas where vision is obstructed.
- Keep non-operating personnel at least 6 ft (1.8 m) away from machine during moving operations.

SECTION 1 - SAFETY PRECAUTIONS

1.5 MOVING, LIFTING, AND REPOSITIONING

General

- Never allow personnel in platform while moving, lifting, or repositioning the machine.
- This machine shall not be towed by a vehicle.
- Do not move assembled unit on wheels over soft or uneven surfaces, or over obstructions, bumps, debris, etc.
- Disassemble unit to transport over uneven or sloped ground, or in a vehicle.
- Ensure platform is fully retracted and completely empty of tools prior to disassembly, lifting or hauling.
- Refer to Section 3.7 section for manual for lifting information.

Additional Safety Information

- Do not use machine as ground for welding.

1.6 MAINTENANCE

This sub-section contains general safety precautions which must be observed during maintenance of this machine. It is of utmost importance that maintenance personnel pay strict attention to these precautions to avoid possible injury to personnel or damage to the machine or property. A maintenance program must be established by a qualified person and must be followed to ensure that the machine is safe.

Maintenance Hazards

- Ensure that all moving parts are secured from inadvertent motion prior to performing any adjustments or repairs.
- Never work under an elevated platform until it has been fully lowered to the full down position, if possible, or otherwise supported and restrained from movement with appropriate safety props, blocking, or overhead supports.
- Use only replacement parts or components that are approved by JLG. To be considered approved, replacement parts or components must be identical or equivalent to original parts or components.
- Never attempt to move heavy parts without the aid of a mechanical device. Do not allow heavy objects to rest in an unstable position. Ensure adequate support is provided when raising components of the machine.
- Use only approved non-flammable cleaning solvents.
- Do not replace items critical to stability, with items of different weight or specification. Do not modify unit in any way to affect stability.
- Refer to the Service and Maintenance manual for the weights of critical stability items.



WARNING

MODIFICATION OR ALTERATION OF A MEWP SHALL BE MADE ONLY WITH PRIOR WRITTEN PERMISSION FROM THE MANUFACTURER.

SECTION 2. PREPARATION AND INSPECTION

2.1 PERSONNEL TRAINING

The Mobile Elevating Work Platform (MEWP) is a personnel handling device, so it is necessary that it be operated and maintained only by trained personnel.

Operator Training

Operator training must cover:

1. Reading and understanding the Operation and Safety Manual.
2. Thorough understanding of the intended purpose and function of the MEWP controls, including platform, ground, and emergency descent controls.
3. Control labels, instructions, and warnings on the machine.
4. Applicable regulations, standards, and safety rules.
5. Use of approved fall protection equipment.
6. Enough knowledge of the mechanical operation of the machine to recognize a malfunction or potential malfunction.
7. The safest means to operate the machine where overhead obstructions, other moving equipment, and obstacles, depressions, holes, and drop-offs exist.
8. Means to avoid the hazards of unprotected electrical conductors.

9. Selection of the appropriate MEWPs and available options for the work to be performed considering specific job requirements, with involvement from the MEWP owner, user, and/or supervisor.
10. The responsibility of the operator to ensure all platform occupants have a basic level of knowledge to work safely on the MEWP, and to inform them of applicable regulations, standards, and safety rules.
11. The requirement for familiarization in addition to training.

Training Supervision

Training must be done under the supervision of a qualified person in an open area free of obstructions until the trainee has developed the ability to safely control and operate the machine.

Operator Responsibility

The operator must be instructed that they have the responsibility and authority to shut down the machine in case of a malfunction or other unsafe condition of either the machine or the job site.

SECTION 2 - PREPARATION AND INSPECTION

Machine Familiarization

NOTE: Responsibilities for familiarization may vary by region.

Only properly trained personnel who have received unit-specific familiarization shall operate a MEWP. The user shall determine if personnel are qualified to operate the MEWP prior to operation. The user shall ensure that after familiarization, the operator operates the MEWP for a sufficient period of time to achieve proficiency. When authorized by the user, self-familiarization can be achieved, if authorized, by a properly trained operator reading, understanding and following the manufacturer's operator's manual.

Prior to users authorization of an operator to use a specific model of MEWP, the user shall ensure the operator is familiarized on the following:

1. Location of the manual storage compartment and the requirement to ensure the required manual(s) are present on the MEWP;
2. Purpose and function of the machine controls and indicators at the platform and ground control stations;
3. Purpose, location, and function of the emergency controls;
4. Operating characteristics and limitations;
5. Features and devices;
6. Accessories and optional equipment.

2.2 PREPARATION, INSPECTION, AND MAINTENANCE

The following table covers the machine inspections and maintenance recommended by JLG Industries, Inc. Consult local regulations for further requirements for MEWPs. The frequency of inspections and maintenance must be increased as necessary when the machine is used in a harsh or hostile environment, if the machine is used with increased frequency, or if the machine is used in a severe manner.

Inspection and Maintenance Table

TYPE	FREQUENCY	PRIMARY RESPONSIBILITY	SERVICE QUALIFICATION	REFERENCE
Pre-Start Inspection	Before using each day; or whenever there's an Operator change.	User or Operator	User or Operator	Operation and Safety Manual
Pre-Delivery Inspection <i>(See Note)</i>	Before each sale, lease, or rental delivery.	Owner, Dealer, or User	Qualified JLG Mechanic	Service and Maintenance Manual and applicable JLG inspection form
Frequent Inspection	In service for 3 months or 150 hours, whichever comes first; or; Out of service for a period of more than 3 months; or Purchased used.	Owner, Dealer, or User	Qualified JLG Mechanic	Service and Maintenance Manual and applicable JLG inspection form
Annual Machine Inspection	Annually, no later than 13 months from the date of prior inspection.	Owner, Dealer, or User	Factory-Trained Service Technician <i>(Recommended)</i>	Service and Maintenance Manual and applicable JLG inspection form
Preventative Maintenance	At intervals as specified in the Service and Maintenance Manual.	Owner, Dealer, or User	Qualified JLG Mechanic	Service and Maintenance Manual

NOTE: Inspection forms are available from JLG. Use the Service and Maintenance Manual to perform inspections.

NOTICE

JLG INDUSTRIES, INC. RECOGNIZES A FACTORY-TRAINED SERVICE TECHNICIAN AS A PERSON WHO HAS SUCCESSFULLY COMPLETED THE JLG SERVICE TRAINING SCHOOL FOR THE SPECIFIC JLG PRODUCT MODEL.

SECTION 2 - PREPARATION AND INSPECTION

2.3 PRE-START INSPECTION

The Pre-Start Inspection should include each of the following:

1. **Cleanliness** – Check all surfaces for debris or foreign objects.
2. **Structure** – Inspect the machine structure for dents, damage, weld or parent metal cracks or other discrepancies. Report this to the proper maintenance personnel.

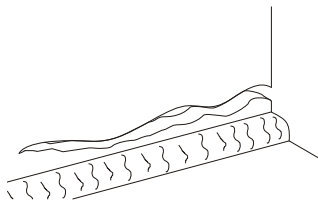

Parent Metal Crack

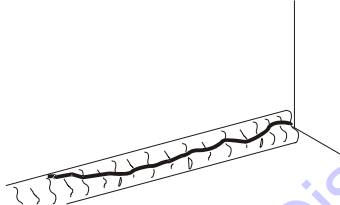

Weld Crack

3. **Decals and Placards** – Check all for cleanliness and legibility. Ensure none of the decals and placards are missing. Make sure all illegible decals and placards are cleaned or replaced (refer to Section 3.8 and Section 3.9 for more information).
4. **Operation and Safety Manual** – Ensure a copy of the Operation and Safety Manual, AEM Safety Manual, and ANSI Manual of Responsibilities is enclosed in the weather resistant manual storage container.
5. **Walk-Around Inspection** – Refer to Section 2.4.

6. **Function Check** – Once the Walk-Around Inspection is complete, perform a function check of all systems in an area free of overhead and ground level obstructions. Refer to Section 2.5 for more specific instructions.
7. **Platform Gate** – Keep gate and surrounding area clean and unobstructed. Verify the gate closes properly and is not bent or damaged. Keep gate closed at all times except when entering/exiting the platform and loading/unloading materials.
8. **Lanyard Attach Points** – JLG Industries, Inc. recommends personnel in the platform wear a fall/travel restraint system with a lanyard attached to an authorized lanyard attach point.

WARNING

IF THE MACHINE DOES NOT OPERATE PROPERLY, REPORT THE PROBLEM TO THE PROPER MAINTENANCE PERSONNEL. DO NOT OPERATE THE MACHINE UNTIL IT IS DECLARED SAFE FOR OPERATION.

SECTION 2 - PREPARATION AND INSPECTION

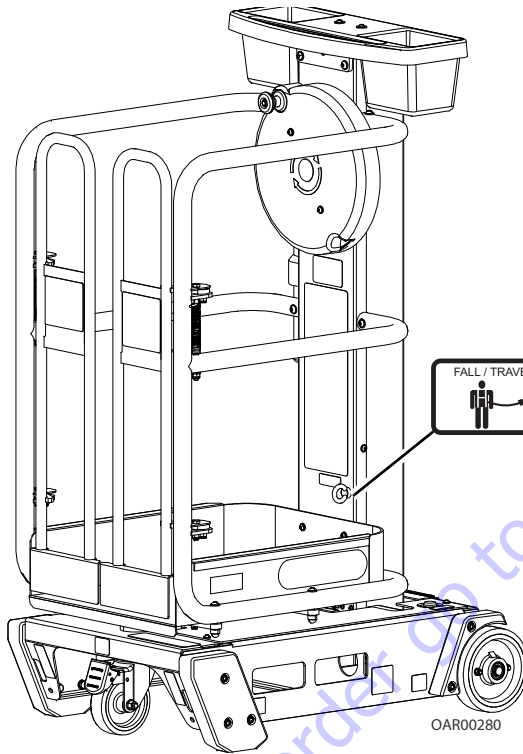

EcoLift 50 (Fall/Travel Restraint Only)

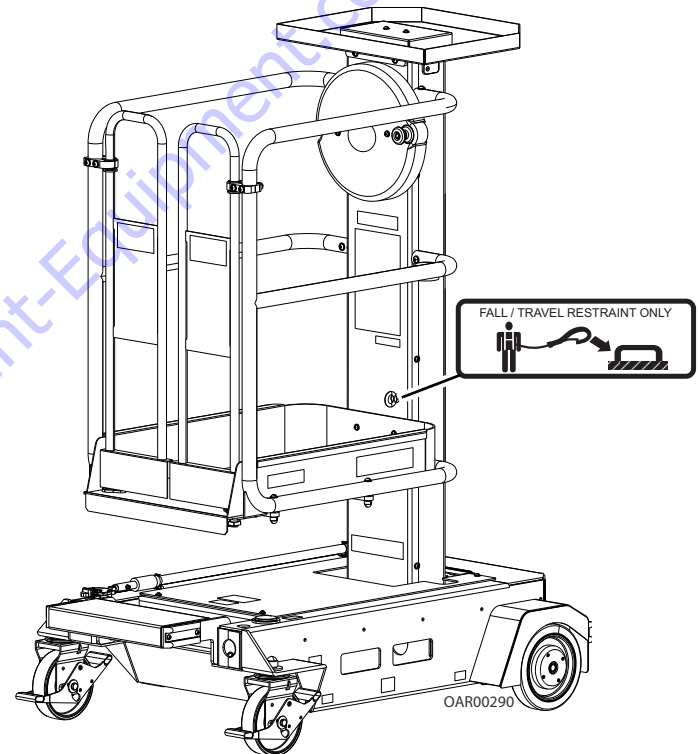

EcoLift 70 (Fall/Travel Restraint Only)

SECTION 2 - PREPARATION AND INSPECTION

2.4 WALK-AROUND INSPECTION

General

Begin the Walk-Around Inspection at item 1 as noted on the Inspection Diagram. Continue checking each item in sequence for the conditions listed in the following checklist.

NOTICE

DO NOT OVERLOOK VISUAL INSPECTION OF THE BASE FRAME UNDERSIDE. CHECKING THIS AREA MAY RESULT IN DISCOVERY OF CONDITIONS WHICH COULD CAUSE EXTENSIVE MACHINE DAMAGE.

INSPECTION NOTE: *On all components, make sure there are no loose or missing parts, they are securely fastened, and no visible damage or excessive wear exists in addition to any other criteria mentioned.*

1. **Front Swivel Castor Wheels** – Properly secured, undamaged, wheels and castors turn freely.
2. **Platform** – Refer to Inspection Note.
3. **Auto-Lock Rear Wheel Brakes** – Check for any debris stuck to or around wheels. Look under the brush strip at the rear of the chassis. Check brake cam plates are undamaged and that the two attaching screws are tight. Check that the brake pins are not bent or broken.

4. **Gates** – Platform railings; entry gate in proper working order, closing properly.
5. **Tool Tray** – Refer to Inspection Note.
6. **Flywheel Handle** – Refer to Inspection Note.
7. **Flywheel** – Refer to Inspection Note.
8. **Emergency Lowering Tool** – Verify emergency lowering tool is secured to the chassis.
9. **Bubble Level Indicator** – Check bubble level Indicator is clean, secure and responds to movement.
10. **Mast Assembly** – Refer to Inspection Note.
11. **Lanyard Attach Point** – Refer to Inspection Note.
12. **Rubber Foot (Pad) (EcoLift 50)** – Check that the front rubber chassis feet (pads) are undamaged and secured.
13. **Fold-Down Platform Step (EcoLift 70)** – Refer to Inspection Note.

Inspection Diagram (EcoLift 50)

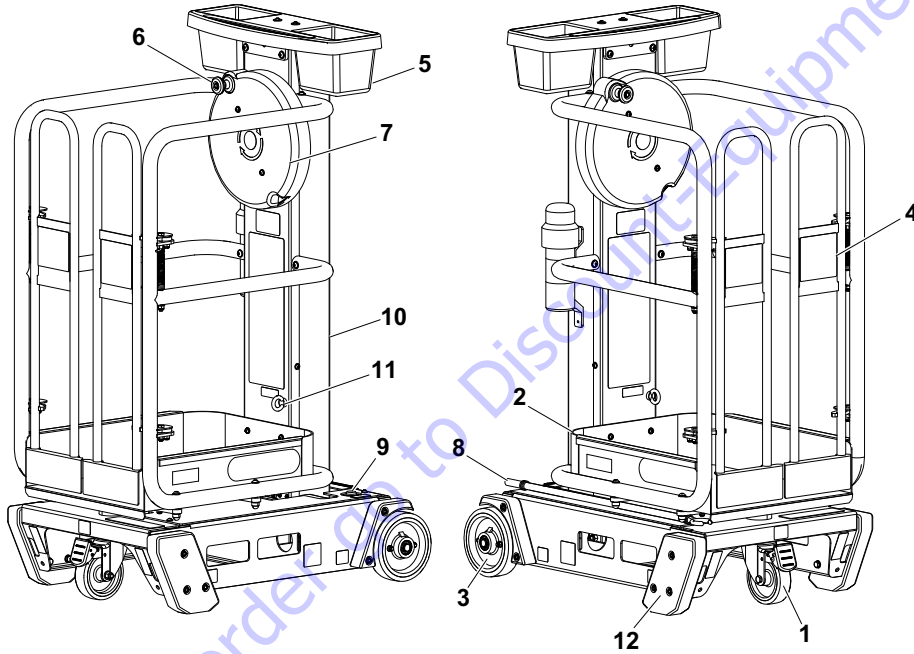

- 1. Swivel Castor
- 2. Platform
- 3. Auto-Lock Braked Wheels
- 4. Gates
- 5. Tool Tray
- 6. Flywheel Handle
- 7. Flywheel
- 8. Emergency Lowering Tool
- 9. Bubble Level Indicator
- 10. Mast Assembly
- 11. Lanyard Attach Point
- 12. Rubber Foot (Pad)

SECTION 2 - PREPARATION AND INSPECTION

Inspection Diagram (EcoLift 70)

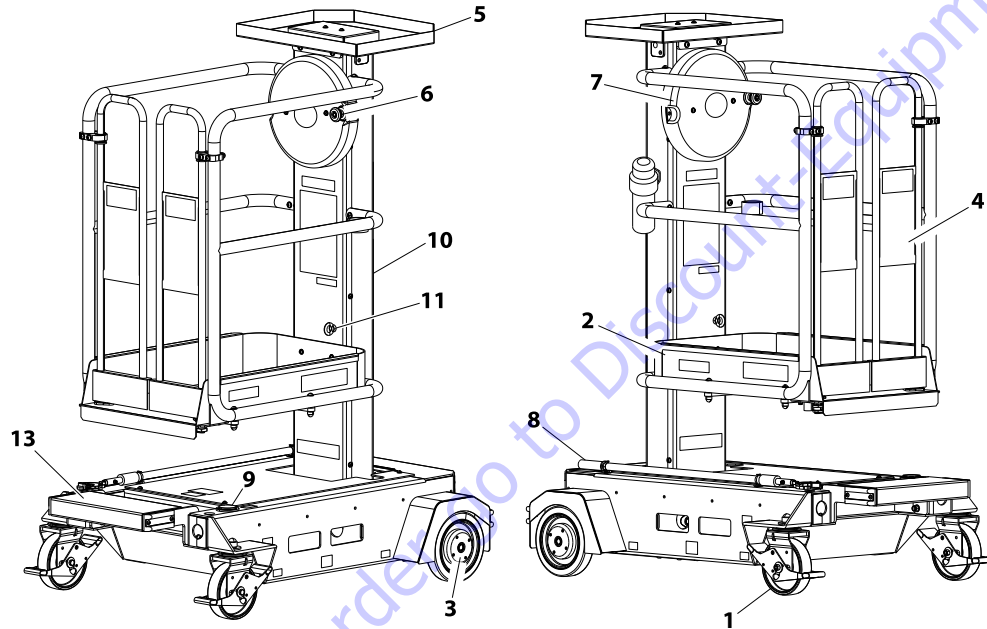

1. Swivel Castor
2. Platform
3. Auto-Lock Braked Wheels
4. Gates
5. Tool Tray
6. Flywheel Handle
7. Flywheel
8. Emergency Lowering Tool
9. Bubble Level Indicator
10. Mast Assembly
11. Lanyard Attach Point
12. Not Used
13. Fold-Down Platform Step

2.5 FUNCTION CHECK

The function check of all systems should be performed in an area free of overhead and ground level obstructions. Perform a function check as follows:

1. Set up machine for operation according to instructions in Section 3.
2. **EcoLift 70** - Check front caster wheels lock when engaged and keep machine from rolling.
3. **Enter platform:** Check that platform entry gates automatically close completely while in platform.
4. **EcoLift 50** - Upon stepping into the platform, the front caster wheel should retract and machine should be resting on the front foot pads.
5. Check 'fly-wheel' operating handle works correctly. Hold handle firmly and pull operating knob towards you, release, knob should spring back to lock wheel.
6. While in platform, raise and lower platform 2 ft to 3 ft (0.61 m to 0.92 m) several times. Check for smooth elevation and lowering of platform.
7. With the aid of an assistant, check the operation of the rear wheel auto locking brake mechanism. When the platform is elevated and the mast is clear of the chassis, observe the action of the brake cams and movement of the brake pins, ensure the pins fully engage the rear wheel brake disks when the platform is elevated and release when the platform is fully lowered.

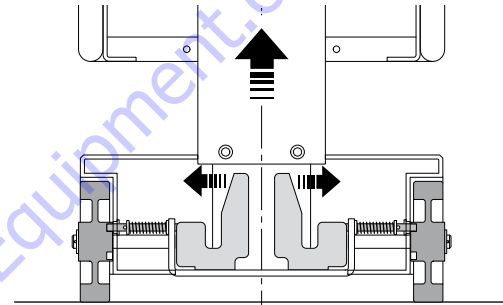

Rear Wheel Auto Locking Brake - Engaged

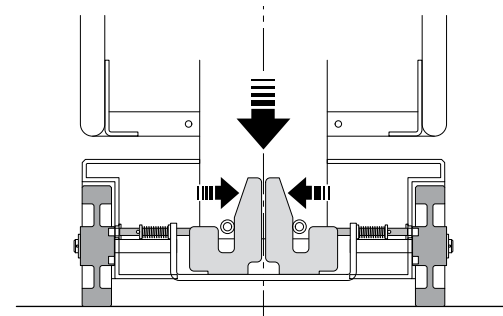

Rear Wheel Auto Locking Brake - Disengaged

TO PURCHASE THIS PRODUCT PLEASE CONTACT US



**Equipment Financing and
Extended Warranties Available**



**Discount-Equipment.com is your online resource for
commercial and industrial quality parts and equipment sales.**

561-964-4949

visit us on line @ www.discount-equipment.com

Select an option below to find your Equipment

Search by Manufacturer

Search by Product Type

Request a Quote

We sell worldwide for the brands: Genie, Terex, JLG, MultiQuip, Mikasa, Essick, Whiteman, Mayco, Toro Stone, Diamond Products, Generac Magnum, Airman, Haulotte, Barreto, Power Blanket, Nifty Lift, Atlas Copco, Chicago Pneumatic, Allmand, Miller Curber, Skyjack, Lull, Skytrak, Tsurumi, Husquvarna Target, Stow, Wacker, Sakai, Mi-T-M, Sullair, Basic, Dynapac, MBW, Weber, Bartell, Bennar Newman, Haulotte, Ditch Runner, Menegotti, Morrison, Contec, Buddy, Crown, Edco, Wyco, Bomag, Laymor, EZ Trench, Bil-Jax, F.S. Curtis, Gehl Pavers, Heli, Honda, ICS/PowerGrit, IHI, Partner, Imer, Clipper, MMD, Koshin, Rice, CH&E, General Equipment, Amida, Coleman, NAC, Gradall, Square Shooter, Kent, Stanley, Tamco, Toku, Hatz, Kohler, Robin, Wisconsin, Northrock, Oztec, Toker TK, Rol-Air, APT, Wylie, Ingersoll Rand / Doosan, Innovatech, Con X, Ammann, Mecalac, Makinex, Smith Surface Prep, Small Line, Wanco, Yanmar

SECTION 2 - PREPARATION AND INSPECTION



NOTES:

Two columns of horizontal lines for taking notes.

To order go to Discount-Equipment.com

SECTION 3. MACHINE OPERATION

3.1 GENERAL

NOTICE

THE MANUFACTURER HAS NO DIRECT CONTROL OVER MACHINE APPLICATION AND OPERATION. THE USER AND OPERATOR ARE RESPONSIBLE FOR CONFORMING WITH GOOD SAFETY PRACTICES.

This section provides the necessary information needed to understand control function and operation.

⚠ WARNING

DO NOT RAISE PLATFORM UNLESS THE MACHINE IS ON A SMOOTH, FIRM SURFACE, WITHIN THE LIMITS OF THE MAXIMUM OPERATING SLOPE, FREE OF OBSTRUCTIONS AND HOLES.

3.2 MACHINE DESCRIPTION

This machine is a Mobile Elevating Work Platform (MEWP) used to position personnel along with their necessary tools and materials at work locations.

This MEWP is manually propelled push-a-round machine with a work platform mounted to an elevating mast mechanism. The personnel lift's intended purpose is to provide personnel (with their tools and materials) access to areas above ground level.

When the platform is fully lowered, the machine can be pushed on its wheels between work areas on a smooth, firm surface within the limits of the maximum operating slope. It can also be transported by forklift truck or loaded onto a suitable vehicle.

From the platform the operator can manually raise and lower the platform using the flywheel cranking mechanism mounted on the front of the mast. The mast is belt-driven and extended with the help of an internal pressurized gas cylinder. Only elevate the platform when the machine is on a smooth, firm surface within the limits of the maximum operating slope.

3.3 OPERATING CHARACTERISTICS AND LIMITATIONS

Placards

Important points to remember during operation are provided at the control stations by DANGER, WARNING, CAUTION, NOTICE, and INSTRUCTION placards. This information is placed at various locations for the express purpose of alerting personnel of potential hazards constituted by the operating characteristics and limitations of the machine. Refer to the Foreword for definitions of placard safety signal words.

Capacities

Raising platform above horizontal with or without any load in platform is based on the following criteria:

1. Machine is positioned on a smooth, firm surface within the limits of the maximum operating slope.
2. Load is within manufacturer's rated capacity.
3. All machine systems are functioning properly.

Stability

This machine, as originally manufactured by JLG and operated within its rated capacity on a smooth, firm surface, within the limits of the maximum operating slope, provides a stable aerial platform for all platform positions.

3.4 PLATFORM LOADING

The platform maximum rated load capacity is shown on a placard located on the platform billboard and is based upon the machine positioned on a smooth, firm surface, within the limits of the maximum operating slope. Refer to Section 5.1 for the maximum platform capacity.

The platform is entered through an entry gate at the rear of the platform. Keep entry gate closed at all times except when entering/exiting the platform and loading/unloading materials.

NOTE: *It is important to remember that the load should be evenly distributed on the platform. The load should be placed near the center of the platform when possible.*

3.5 MACHINE COMPONENT LOCATIONS

EcoLift 50

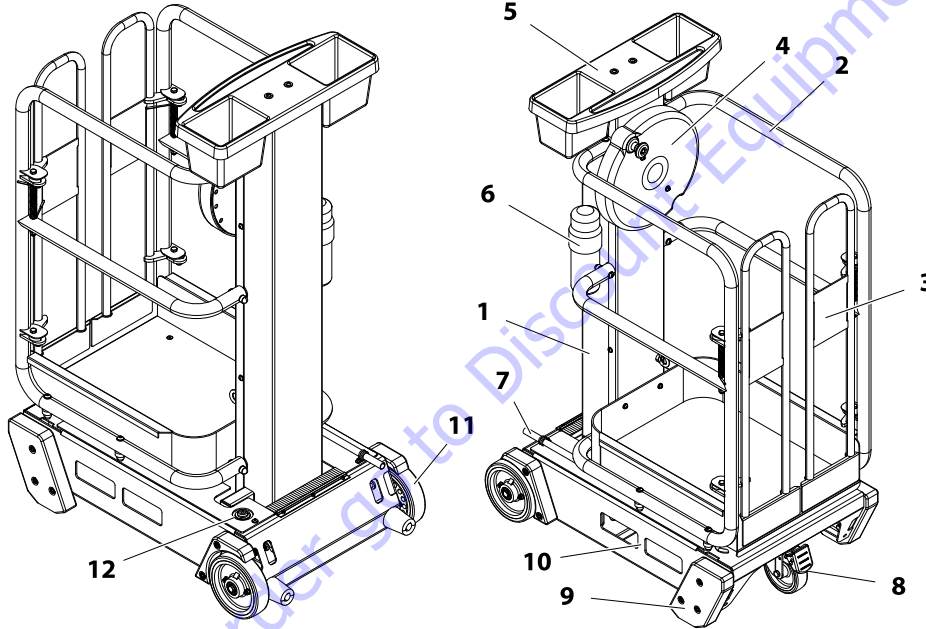

1. Mast Assembly
2. Platform
3. Platform Entry Gates
4. Flywheel and Handle
5. Tool Tray
6. Manual Holder
7. Emergency Lowering Tool
8. Front Caster
9. Front Foot Pads
10. Fork Lift Pockets
11. Rear Wheels (Auto-Locking)
12. Indicator Bubble Level

SECTION 3 - MACHINE OPERATION

EcoLift 70

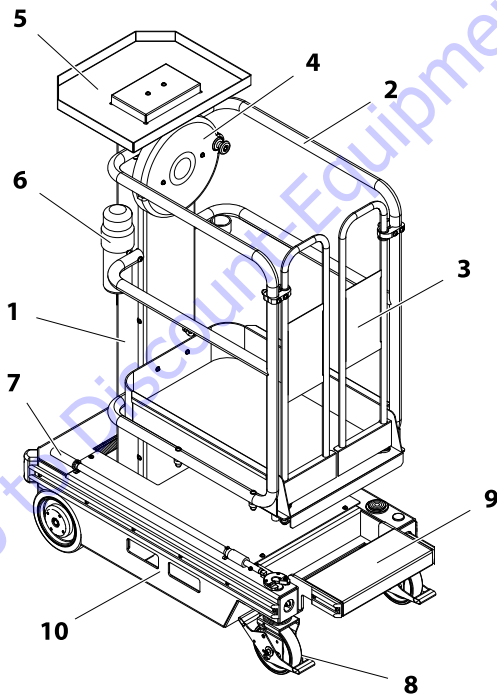
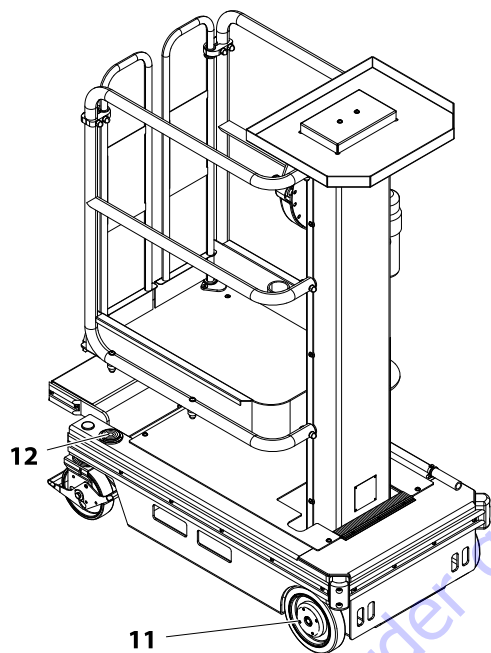

1. Mast
2. Platform
3. Platform Entry Gates
4. Flywheel and Handle
5. Tool Tray
6. Manual Holder
7. Emergency Lowering Tool
8. Front Casters with Manual Brake
9. Fold-Down Platform Step
10. Fork Lift Pockets
11. Rear Wheels (Auto-Locking)
12. Indicator Bubble Level

3.6 MACHINE OPERATION

⚠ CAUTION

NEVER ATTEMPT TO USE THE FLYWHEEL HANDLE TO RAISE OR LOWER THE PLATFORM WHILE STANDING NEXT TO THE MACHINE, OR WITH AN EMPTY PLATFORM.

The following control conditions must be met before elevating the platform:

- Make sure the Pre-Start Inspection (Section 2) has been completed and the machine is safe to use.
- Check that machine base is level and is set up properly for operation.
- Both platform swing-in entry gates must be closed once the operator is in the platform.

NOTICE

JLG RECOMMENDS THAT THE OPERATOR UTILIZES A FALL/TRAVEL RESTRAINT SYSTEM IN THE PLATFORM WITH A LANYARD ATTACHED TO THE AUTHORIZED LANYARD ANCHORAGE POINT IN THE PLATFORM.

Positioning and Leveling Machine

1. Position machine under work area on a smooth, firm surface within the limits of the maximum operating slope.
2. Verify all wheels/support pads at the front and rear of machine are resting on the supporting surface.

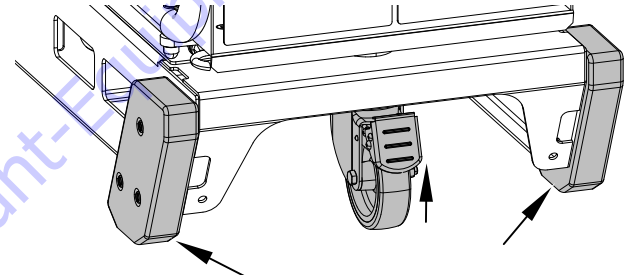

EcoLift 50 - Swivel Castor and Rubber Foot Pads

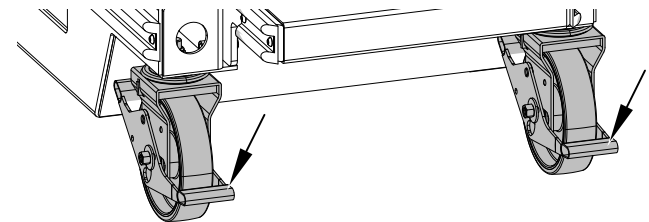

EcoLift 70 - Lock Castor Brakes

SECTION 3 - MACHINE OPERATION

- a. **EcoLift 50** - After entering the platform, verify the front castor has retracted and machine is resting on the front rubber foot pads.
 - b. **EcoLift 70** - Lock each of the front castor wheels before entering the platform.
3. Ensure the level indicator is centered and machine is level.

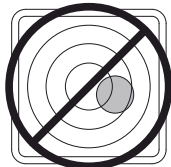
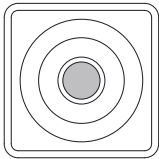

OAR00160

4. Ensure the bubble level indicator is centered and machine is level.

Entering/Exiting the Platform

⚠ WARNING

DO NOT EXCEED MAXIMUM PLATFORM CAPACITY. MAXIMUM CAPACITY INCLUDES PERSONNEL IN PLATFORM PLUS WEIGHT IN TOOL TRAY OR ANY OTHER WEIGHT PLACED IN PLATFORM.

1. Always maintain “three point contact” with the machine, using two hands and one foot or two feet and one hand at all times during entry and exit.
2. Attach lanyard to the lanyard attachment point in the lower right hand corner of the mast.
3. Ensure entry gates are fully closed after entering.
4. Once in the platform and the entry gates have fully closed the platform is ready for operation.

⚠ WARNING

BEFORE OPERATING PLATFORM, CHECK AROUND AND OVERHEAD FOR ANY OBSTACLES OR PERSONNEL THAT MAY COME INTO CONTACT WITH MACHINE WHILE ELEVATING OR LOWERING THE PLATFORM. IF NECESSARY, EXIT MACHINE AND REPOSITION BEFORE PROCEEDING.

5. Fully lower the platform before exiting through the gates.

Elevating/Lowering Platform

1. Check for overhead obstructions.
2. To elevate the platform, pull out on the flywheel handle and turn flywheel clockwise.
3. To lower the platform, pull out on the flywheel handle and turn flywheel counterclockwise.
4. To stop elevating and lowering operation, stop turning the flywheel and release the handle. Continue to turn flywheel slightly to lock handle in place when released.

 WARNING

CRUSHING HAZARD - BE AWARE OF DESCENDING PLATFORM WHEN LOWERING THE PLATFORM. KEEP HANDS OR FEET OFF THE MAST ASSEMBLY AND FROM BENEATH PLATFORM.

3.7 TRANSPORTING, LIFTING, AND TIE-DOWN PROCEDURES

Loading

If loading machine up a ramp onto a trailer with the aid of a winch, connect the winch cable to the castor/gate end of the chassis using the tie-down holes provided. First run a strap through the holes and then connect the winch cable to the strap.

Ensure the castors are rolling freely and the platform is fully lowered to the transport position. Before disconnecting the machine from the winch cable, engage each castor brake.

SECTION 3 - MACHINE OPERATION

Storage

If the machine is due to be stored for periods in excess of one month, take the following precautions:

- Fully lower the platform.
- Place a cover over the machine.
- Store or transport the machine in an upright position only.
- Upon removal from storage and prior to returning to use, ensure machine pre-operation checks are carried out.

Vehicle Transport

The machine must always be transported in the upright position. Do not lay the machine flat.

The machine can be loaded onto a transport vehicle via a forklift, tail-lift, or winch. Never push the machine up a slope greater than 5° without the aid of a winch or forklift. Ensure the transport vehicle is parked on a level surface.

If using a forklift to transport the machine, engage all castor wheel locks. Adjust the width of the forklift tines to fit the machine's forklift pockets, then fully slide in the tines and lift machine.

If tying down the machine using straps or chains, the platform must be fully lowered to the stowed position with the machine securely tied down to the truck or trailer deck.

NOTICE

NEVER PLACE A STRAP THROUGH THE PLATFORM OR HANDRAILS, WHICH MAY RESULT IN MACHINE DAMAGE. DO NOT USE EXCESSIVE FORCE WHEN TIGHTENING STRAPS OR CHAINS.

Transportation Diagram

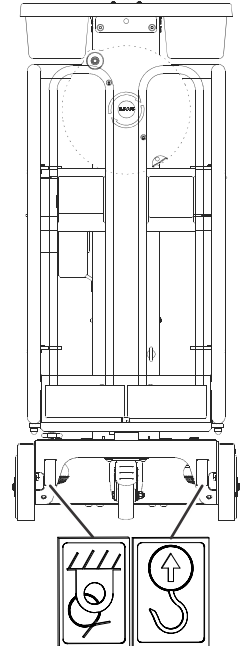
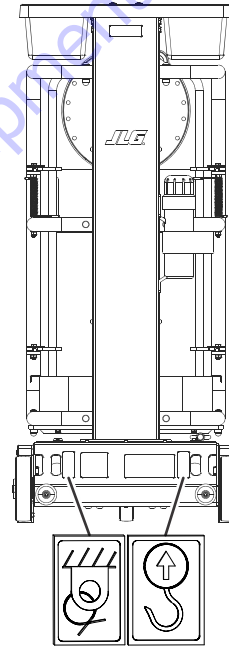
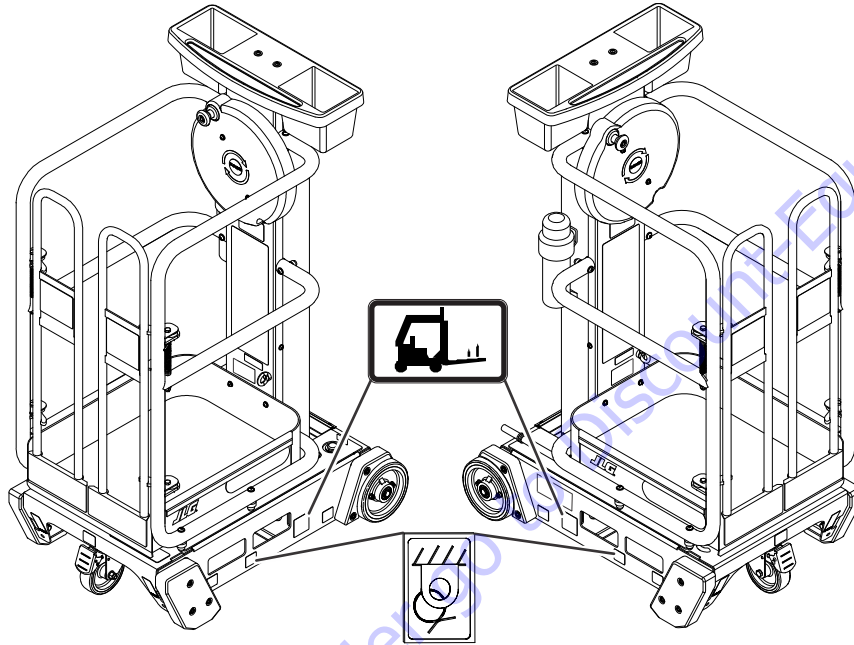

OAR00431

SECTION 3 - MACHINE OPERATION

3.8 DECAL INSTALLATION (ECOLIFT 50)

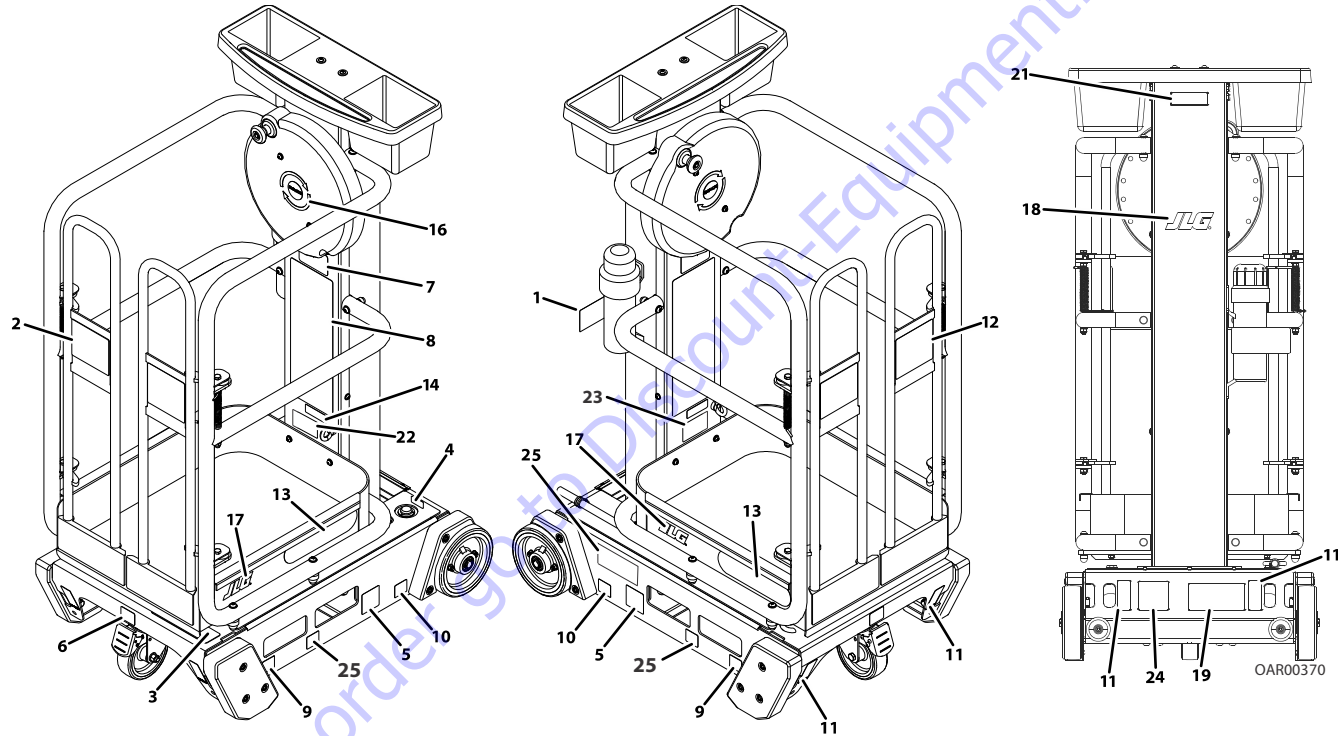

SECTION 3 - MACHINE OPERATION

EcoLift 50				
Item	ANSI - English (1001251174-B)	CSA - French (1001251175-B)	ANSI -Spanish (1001251176-B)	ANSI-Portuguese (1001251177-B)
1	1701509			
2	1703781	1704795	1704029	1704021
3	1703786	1704039	1704032	1704024
4	1001245238	1001245239	1001245240	1001245241
5	1703817			
6	1001213208			
7	1001213279			
8	1001251158	1001251159	1001251160	1001251161
9	1001213439			
10	1001213440			
11	1001213442			
12	1001213545	1001215010	1001241791	1001241801
13	1001213548			
14	1001213582	1001215009	1001241792	1001241802
15	-	-	-	-
16	1001213997	1001215005	1001241793	1001241803
17	1001214108			

EcoLift 50				
Item	ANSI - English (1001251174-B)	CSA - French (1001251175-B)	ANSI -Spanish (1001251176-B)	ANSI-Portuguese (1001251177-B)
18	1001214109			
19	1001214125			
20	-	-	-	-
21	1001215043	1001215049	1001241794	1001241804
22	1001231801	-	-	-
23	-	-	-	-
24	1001223055	1001245181	1001245183	1001245185
25	1706832	1001256551	1001256552	1706833
26	1001212290			

SECTION 3 - MACHINE OPERATION

3.9 DECAL INSTALLATION (ECOLIFT 70)

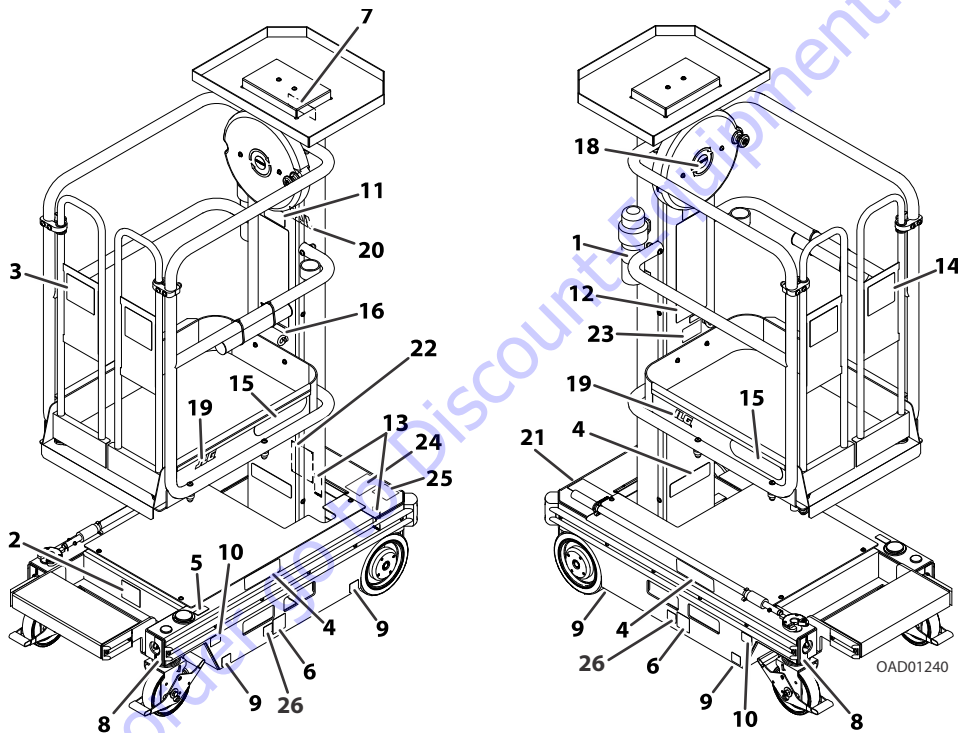

SECTION 3 - MACHINE OPERATION

EcoLift 70				
Item	ANSI - English (1001251182-B)	CSA - French (1001251183-B)	ANSI - Spanish (1001251184-B)	ANSI - Portuguese (1001251185-B)
1	1701509			
2	1702391	1001215113	1001241795	1001241805
3	1703781	1704795	1704029	1704021
4	1703786	1704039	1704032	1704024
5	1703789	1704041	1704034	1704026
6	1703817			
7	1001215043	1001214049	1001241794	1001241804
8	1001213202			
9	1001213205			
10	1001213208			
11	1001213279			
12	1001251158	1001251159	1001251160	1001251161
13	1001213442			
14	1001213545	1001215010	1001241791	1001241801
15	1001213549			
16	1001213582	1001215009	1001241792	1001241802
17	—			

EcoLift 70				
Item	ANSI - English (1001251182-B)	CSA - French (1001251183-B)	ANSI - Spanish (1001251184-B)	ANSI - Portuguese (1001251185-B)
18	1001213997	1001215005	1001241793	1001241803
19	1001214108			
20	1001214109			
21	1001214125			
22	—			
23	1001231801	—		
24	1001223055	1001245181	1001245183	1001245185
25	1706832	1001256551	1001256552	1706833
26	1001212290			

SECTION 3 - MACHINE OPERATION



NOTES:

Two columns of horizontal lines for writing notes, separated by a vertical line. The lines are evenly spaced and extend across the width of each column.

To order go to Discount-Equipment.com

SECTION 4 - EMERGENCY PROCEDURES

4.3 INCIDENT NOTIFICATION

JLG Industries, Inc. must be notified immediately of any incident involving a JLG product. Even if no injury or property damage is evident, JLG must be contacted by telephone and provided with all necessary details.

- USA: 877-JLG-SAFE (554-7233)
- EUROPE: (32) 0 89 84 82 20
- AUSTRALIA: (61) 2 65 81 11 11
- E-mail: productsafety@jlg.com

Failure to notify the manufacturer of an incident involving a JLG Industries product within 48 hours of such an occurrence may void any warranty consideration on that particular machine.

NOTICE

FOLLOWING ANY INCIDENT, THOROUGHLY INSPECT THE MACHINE. DO NOT ELEVATE THE PLATFORM UNTIL IT IS CERTAIN THAT ALL DAMAGE HAS BEEN REPAIRED AND THAT ALL CONTROLS ARE OPERATING CORRECTLY. TEST ALL FUNCTIONS FIRST FROM THE GROUND CONTROL STATION THEN FROM THE PLATFORM CONTROL CONSOLE.

4.4 EMERGENCY LOWERING OPERATION

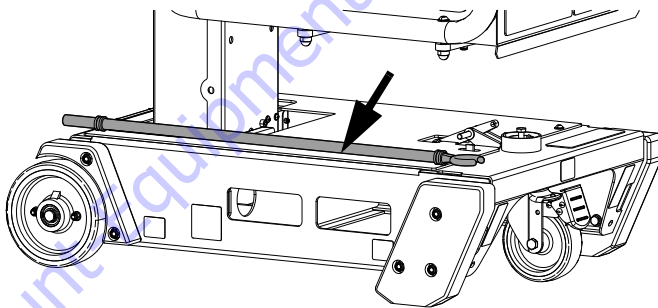

Emergency Lowering Tool (EcoLift 50)

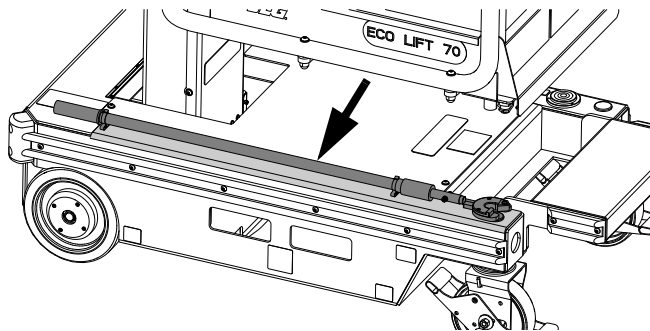

Emergency Lowering Tool (EcoLift 70)

WARNING

DO NOT CLIMB OUT OF THE PLATFORM WHILE ELEVATED. THIS MAY AFFECT THE MACHINE'S BALANCE, CAUSING IT TO TIP OVER. ONLY EXIT THE PLATFORM VIA THE PLATFORM GATES. DO NOT ATTEMPT TO CLIMB DOWN MAST.

CAUTION

THE MAST IS PRE-LOADED FOR UPWARD MOVEMENT BY THE INTERNAL PRESSURIZED GAS CYLINDER. NEVER ATTEMPT TO ENGAGE THE EMERGENCY LOWERING TOOL WITHOUT AN OCCUPANT IN THE PLATFORM.

To lower the platform in the event of the operator being incapacitated (unable to operate the flywheel handle in the basket):

1. Locate emergency lowering tool on chassis, remove from machine.
2. Stand to side of machine (1), attach 'hook' end of emergency lowering tool to flywheel handle in platform (2), releasing handle (3) turn the flywheel counter-clockwise (4), to bring platform down.
3. Keep clear of platform as it descends.
4. Depending on the height of the elevated platform, it may be necessary to extend the shaft of the lowering tool.
5. Turn the shaft lock counter-clockwise to extend and retract the lowering tool shaft, and clockwise to lock to the desired position.

NOTE: *Step 4 & 5 are applicable only for EcoLift 70.*

SECTION 4 - EMERGENCY PROCEDURES

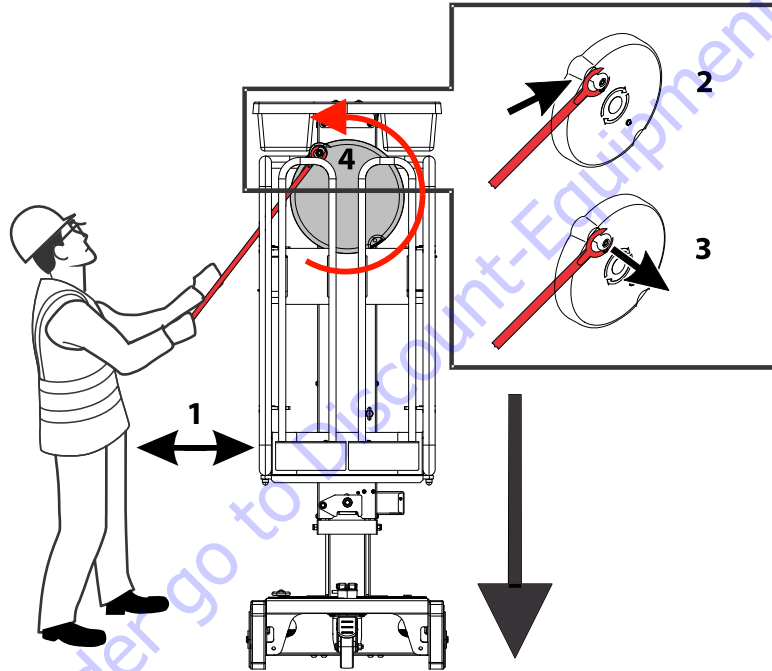

Emergency Lowering (EcoLift 50 and EcoLift 70)

SECTION 5. GENERAL SPECIFICATIONS

Other Publications Available Specific to this Machine

Illustrated Parts Manual..... 31215864
Service and Maintenance Manual 31215861

Serial Number Identification

The serial number plate is fixed to the mast frame on the front of the machine.

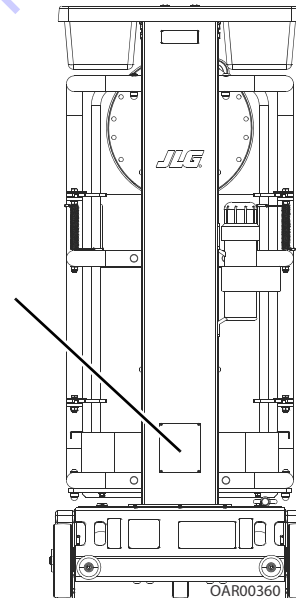

SECTION 5 - GENERAL SPECIFICATIONS

5.1 GENERAL SPECIFICATIONS

Machine Specifications

DESCRIPTION	EcoLift50	EcoLift70
Maximum Working Height	10.9 ft (3.32 m)	13.21 ft (4.03 m)
Maximum Platform Height	4.9 ft (1.50 m)	7.21 ft (2.20 m)
Platform Dimensions	28.3 in (L) x 23.6 in (W) (720 mm (L) x 600 mm (W))	33.4 in (L) x 25.3 in (W) (850 mm (L) x 644 mm (W))
Working Footprint	38.8 in x 28.3 in (985 mm x 700 mm)	50.3 in x 29.1 in (1280 mm x 740 mm)
Max. Platform Capacity (Platform and Tool Tray Combined)	330 lb (150 kg) (1 person + tools)	
Max. Tool Tray Capacity	33 lb (15 kg)	
Maximum Manual Side Force	45 lb (200 N)	
Maximum Allowable Operating Slope	0°	
Maximum Grade for Pushing	5°	
Maximum Wind Force	Indoor use only	

DESCRIPTION	EcoLift50	EcoLift70
Maximum Wheel Load	260 lb (118 kg)	320 lb (145 kg)
Maximum Ground Bearing Pressure	168 psi (11.81 kg/cm ²)	171 psi (12 kg/cm ²)

NOTE: *INDOOR USE is use of a MEWP in areas shielded from wind so that there is no wind. OUTDOOR USE is use of a MEWP in an environment that can be exposed to wind.*

Machine Dimensions

DESCRIPTION	EcoLift50	EcoLift70
Length	38.8 in (985 mm)	50.3 in (1280 mm)
Width	28.3 in (700 mm)	29.1 in (740 mm)
Height	61 in (1550 mm)	76.77 in (1950 mm)
Weight	397 lb (180 kg)	672 lb (305 kg)

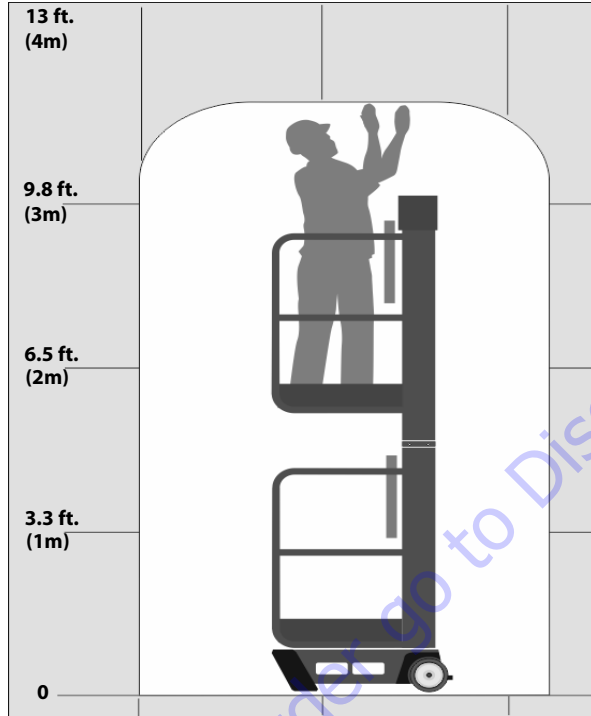

Figure 5-1. Operating Specifications (EcoLift 50)

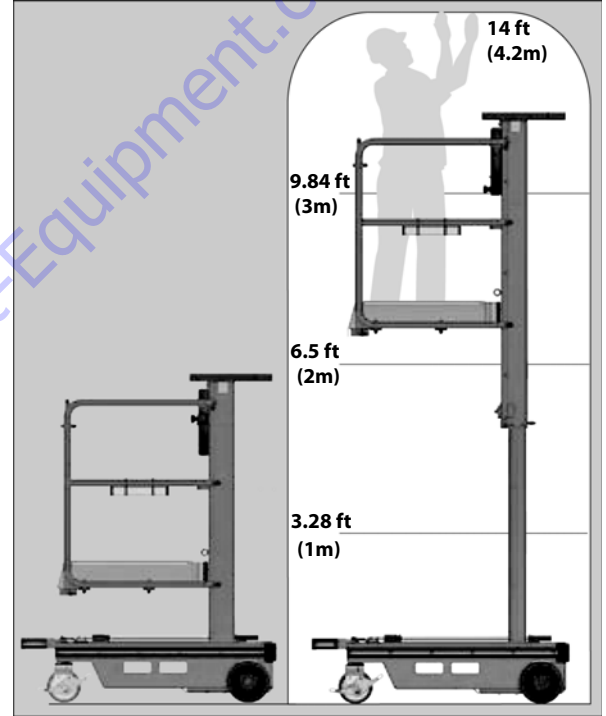

Figure 5-2. Operating Specifications (EcoLift 70)

SECTION 5 - GENERAL SPECIFICATIONS



NOTES:

Two columns of horizontal lines for writing notes, separated by a vertical line down the center of the page.

To order go to Discount-Equipment.com

TO PURCHASE THIS PRODUCT PLEASE CONTACT US



**Equipment Financing and
Extended Warranties Available**



**Discount-Equipment.com is your online resource for
commercial and industrial quality parts and equipment sales.**

561-964-4949

visit us on line @ www.discount-equipment.com

Select an option below to find your Equipment

Search by Manufacturer

Search by Product Type

Request a Quote

We sell worldwide for the brands: Genie, Terex, JLG, MultiQuip, Mikasa, Essick, Whiteman, Mayco, Toro Stone, Diamond Products, Generac Magnum, Airman, Haulotte, Barreto, Power Blanket, Nifty Lift, Atlas Copco, Chicago Pneumatic, Allmand, Miller Curber, Skyjack, Lull, Skytrak, Tsurumi, Husquvarna Target, Stow, Wacker, Sakai, Mi-T-M, Sullair, Basic, Dynapac, MBW, Weber, Bartell, Bennar Newman, Haulotte, Ditch Runner, Menegotti, Morrison, Contec, Buddy, Crown, Edco, Wyco, Bomag, Laymor, EZ Trench, Bil-Jax, F.S. Curtis, Gehl Pavers, Heli, Honda, ICS/PowerGrit, IHI, Partner, Imer, Clipper, MMD, Koshin, Rice, CH&E, General Equipment, Amida, Coleman, NAC, Gradall, Square Shooter, Kent, Stanley, Tamco, Toku, Hatz, Kohler, Robin, Wisconsin, Northrock, Oztec, Toker TK, Rol-Air, APT, Wylie, Ingersoll Rand / Doosan, Innovatech, Con X, Ammann, Mecalac, Makinex, Smith Surface Prep, Small Line, Wanco, Yanmar

JLG[®]

An Oshkosh Corporation Company

**Discount
Equipment**

www.Discount-Equipment.com

To order go to www.Discount-Equipment.com